

FILED

2009 MAR 18 AM 10:23
CLERK U.S. DISTRICT COURT
CENTRAL DIST. OF CALIF.
LOS ANGELES

Robert C. Weiss (State Bar No. 39,929)
rcweiss@jonesday.com
Charles A. Kertell (State Bar No. 181,214)
cakertell@jonesday.com
JONES DAY
555 South Flower Street, 50th Floor
Los Angeles, CA 90071
Telephone: (213) 489-3939
Facsimile: (213) 243-2539

Attorneys for Plaintiff
MAG INSTRUMENT, INC.

UNITED STATES DISTRICT COURT
CENTRAL DISTRICT OF CALIFORNIA

CV 09-01842

PA

VBKx

MAG INSTRUMENT, INC., a
California corporation,

Case No.

Plaintiff,

**COMPLAINT FOR PATENT
INFRINGEMENT**

v.

DEMAND FOR JURY TRIAL

THE COLEMAN COMPANY,
INC., a Delaware corporation, and
DOES 1-10,

Defendants.

COPY

1 Plaintiff, Mag Instrument, Inc. ("Mag Instrument"), files this Complaint
2 against defendants, The Coleman Company, Inc. ("Coleman") and DOES 1-10, and
3 demanding a trial by jury, alleges as follows:

4 **JURISDICTION AND VENUE**

5 1. The cause of action is for patent infringement, which arises under the
6 patent laws of the United States, Title 35, United States Code. This Court has
7 original jurisdiction over the subject matter of this cause of action pursuant to the
8 provisions of 28 U.S.C. §§1331 and 1338(a).

9 2. Upon information and belief, venue is proper under 28 U.S.C.
10 §§1391(b) and 1391(c), as well as 28 U.S.C. §1400(b).

11 **THE PARTIES**

12 3. Mag Instrument is a corporation incorporated under the laws of the
13 State of California and has its principal place of business at 2001 South Hellman
14 Avenue, Ontario, California 91761.

15 4. Upon information and belief, Coleman is a corporation incorporated
16 under the laws of the State of Delaware and has its principal place of business at
17 3600 North Hydraulic, Wichita, Kansas 67219.

18 5. Upon information and belief, Coleman resides in this district under 28
19 U.S.C. §1391. In particular, Coleman does business in this district and a substantial
20 part of the events giving rise to the claims in this case occurred in this district.

21 6. Mag Instrument is not fully informed regarding the involvement of the
22 defendants sued herein under the fictitious names DOES 1-10, inclusive (the "Doe
23 Defendants"). Upon information and belief, the Doe Defendants are involved with
24 Coleman and/or the activities alleged herein. Mag Instrument has thus sued the
25 Doe Defendants by their fictitious names. Mag Instrument will seek leave to
26 amend this Complaint to allege the true names, capacities, and residences of the
27 Doe Defendants when their involvement is ascertained. Coleman and the Doe
28 Defendants are hereinafter collectively referred to as the "Defendants."

1 is entitled to preliminary and permanent injunctions enjoining Defendants from
2 engaging in further acts of infringement.

3 13. As a direct and proximate result of the foregoing acts of Defendants,
4 Mag Instrument has suffered, and is entitled to, monetary damages in an amount
5 not yet determined. Mag Instrument is also entitled to its costs of suit and interest.

6 14. Upon information and belief, Defendants' acts were in conscious and
7 willful disregard for Mag Instrument's rights, and the resulting damage to Mag
8 Instrument is such as to warrant the trebling of damages to provide just
9 compensation.

10 **PRAYER FOR RELIEF**

11 WHEREFORE, Mag Instrument respectfully demands judgment:

12 1. That Defendants, their officers, directors, agents, servants, employees,
13 attorneys, confederates, and all persons and/or entities acting for, with, by, through,
14 or in concert with them, or any of them, be enjoined preliminarily and permanently:

15 (a) from infringing the '272 patent, either directly or contributorily;
16 and

17 (b) from inducing others to infringe the '272 patent.

18 2. That Defendants be required to deliver up to the Court any and all
19 products in their possession, custody, and/or control that infringe the '272 patent.

20 3. That Defendants be required to prepare and deliver to the Court a
21 complete list of entities from whom Defendants purchased, and to whom they
22 distributed and/or sold, products that infringe the '272 patent.

23 4. That Defendants be required to deliver to the Court any and all
24 documents reflecting or relating to the purchase, sale, and/or distribution of any
25 products that infringe the the '272 patent.

26 5. That Defendants, within thirty (30) days after service of judgment with
27 notice of entry thereof upon them, be required to file with the Court and serve upon
28

1 Mag Instrument's attorneys a written report, under oath, setting forth in detail the
2 manner in which Defendants have complied with paragraphs 1-4, above.

3 6. That Defendants be required to account for and pay over to Mag
4 Instrument cumulative damages sustained by Mag Instrument by reason of
5 Defendants' unlawful acts of patent infringement herein alleged, that the amount of
6 recovery be increased as provided by law, up to three times, and that interest and
7 costs be awarded to Mag Instrument.

8 7. That Mag Instrument be awarded its reasonable costs and attorneys'
9 fees.

10 8. That the present case be found exceptional and that attorneys' fees be
11 awarded to Mag Instrument under 35 U.S.C. §285.

12 9. That Mag Instrument have such other and further relief as the Court
13 may deem equitable.

14
15 Dated: March 18, 2009

JONES DAY

16
17
18 By: 
Charles A. Kertell

19 Attorneys for Plaintiff
20 MAG INSTRUMENT, INC.
21
22
23
24
25
26
27
28

DEMAND FOR JURY TRIAL

Pursuant to Federal Rule of Civil Procedure 38(b) and Local Rule 38-1, Mag
Instrument, Inc. hereby demands a trial by jury on all issues triable in this action.

Dated: March 18, 2009

JONES DAY

By: 
Charles A. Kertell

Attorneys for Plaintiff
MAG INSTRUMENT, INC.

EXHIBIT 1

US007410272B2

(12) **United States Patent**
Halasz

(10) **Patent No.:** **US 7,410,272 B2**
(45) **Date of Patent:** ***Aug. 12, 2008**

(54) **LIGHTING DEVICE**

(75) **Inventor:** **Christopher Lee Halasz**, Parker, CO (US)

(73) **Assignee:** **Mag Instrument, Inc.**, Ontario, CA (US)

(*) **Notice:** Subject to any disclaimer, the term of this patent is extended or adjusted under 35 U.S.C. 154(b) by 0 days.

This patent is subject to a terminal disclaimer.

(Continued)

FOREIGN PATENT DOCUMENTS

(21) **Appl. No.:** **11/607,259**

AU 114558 1/1942

(22) **Filed:** **Dec. 1, 2006**

(65) **Prior Publication Data**

US 2007/0076410 A1 Apr. 5, 2007

(Continued)

Related U.S. Application Data

(63) Continuation of application No. 11/137,214, filed on May 24, 2005, now abandoned, which is a continuation of application No. 09/927,484, filed on Aug. 10, 2001, now Pat. No. 6,905,223.

(60) Provisional application No. 60/224,313, filed on Aug. 10, 2000.

(51) **Int. Cl.**
F21L 4/04 (2006.01)

(52) **U.S. Cl.** 362/296; 362/197; 362/287

(58) **Field of Classification Search** 362/197, 362/287, 427

See application file for complete search history.

(56) **References Cited**

U.S. PATENT DOCUMENTS

555,183 A 2/1896 Rhind
577,156 A 2/1897 Bragger
926,114 A 6/1909 Hall
1,186,428 A 6/1916 Newman

Primary Examiner—Anabel M Ton
(74) *Attorney, Agent, or Firm*—Jones Day

(57) **ABSTRACT**

A portable, battery-operated flashlight having improved pivoting, switching and focusing features is disclosed. In one aspect of the invention, the flashlight takes the form of an attachment to a head gear for hands free use. In another aspect of the invention, the flashlight takes the form of a head lamp held in place on an user's head by an elastic band. The pivot connection between the body and the base, as well as the serrations on an exterior surface of the body, allows a user to adjust any angular direction of the light as desired. In another aspect of the invention, the flashlight takes the form of a long-handled flashlight having improved switching and focusing capabilities, such that axial movement of the switching assembly turns the flashlight "on" or "off," as well as causing a position of the lamp to vary in order to focus or defocus the light.

7 Claims, 12 Drawing Sheets

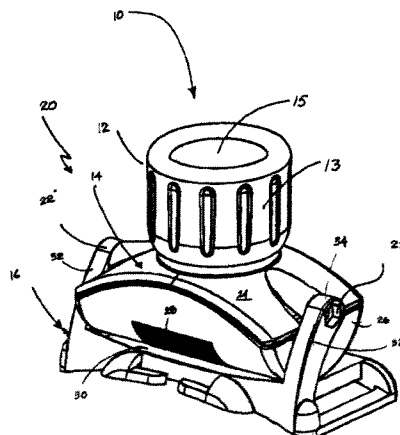

US 7,410,272 B2

Page 2

U.S. PATENT DOCUMENTS

1,722,773 A 7/1929 Stewart
 1,758,835 A 5/1930 Hime
 1,823,762 A 9/1931 Rathmann
 1,851,503 A 3/1932 Flamm
 2,016,819 A 10/1935 Meginniss 240/10.66
 2,097,222 A 10/1937 Tompkins et al. 240/10.66
 2,173,650 A 9/1939 Fullmer 240/10.66
 2,176,301 A 10/1939 Haas 240/10.66
 2,212,103 A 8/1940 Rothenberg et al. 240/10.66
 2,259,106 A 10/1941 Hager 200/60
 2,272,907 A 2/1942 Deibel 240/10.61
 2,338,078 A 12/1943 Wood 240/10.66
 2,339,356 A 1/1944 Sachs 240/10.69
 2,396,046 A 3/1946 Hipwell et al. 240/10.66
 2,442,736 A 6/1948 Valentine 248/124
 2,490,830 A 12/1949 Norton 240/10.68
 2,530,913 A 11/1950 Shackel 240/10.6
 2,599,295 A 6/1952 Thomas 200/60
 2,915,621 A 12/1959 Garland 240/10.66
 2,931,005 A 3/1960 Saurwein et al. 339/182
 2,945,944 A 7/1960 Gillespie 240/10.68
 3,014,125 A 12/1961 Draudt 240/10.66
 3,076,891 A 2/1963 Moore 240/10.66
 3,652,846 A 3/1972 Starck, II 240/10.63
 4,114,187 A 9/1978 Uke 362/158
 4,151,583 A 4/1979 Miller 362/205
 4,170,337 A 10/1979 Davis 248/475
 4,220,985 A 9/1980 Hukuba 362/203
 4,286,311 A 8/1981 Maglica 362/205
 4,388,673 A 6/1983 Maglica 362/183
 4,398,238 A 8/1983 Nelson 362/187
 4,399,498 A 8/1983 Bacevius 362/396
 4,429,351 A 1/1984 Petz et al. 362/187
 4,472,766 A 9/1984 Hung 362/158
 4,495,551 A 1/1985 Foltz 362/205
 4,506,317 A 3/1985 Duddy 362/396
 4,527,223 A 7/1985 Maglica 362/187
 4,531,178 A 7/1985 Uke 362/158
 4,570,208 A 2/1986 Sassmannshausen 362/188
 4,577,263 A 3/1986 Maglica 362/187
 4,581,686 A 4/1986 Nelson 362/204
 4,618,081 A 10/1986 Miree 224/41
 4,656,565 A 4/1987 Maglica 362/187
 4,658,336 A 4/1987 Maglica 362/197
 4,725,932 A 2/1988 Gammache 362/202
 4,733,337 A 3/1988 Bieberstein 362/206
 4,777,572 A 10/1988 Ambasz 362/197
 4,777,582 A 10/1988 Sharrah 362/205
 4,819,141 A 4/1989 Maglica et al. 362/207
 4,823,242 A 4/1989 Maglica et al. 362/187
 4,841,417 A 6/1989 Maglica et al. 362/206
 4,843,526 A 6/1989 Price, III 362/187
 4,851,974 A 7/1989 Maglica 362/187

4,864,474 A 9/1989 Maglica 362/203
 4,870,550 A 9/1989 Uke 362/158
 4,888,670 A 12/1989 Sharrah 362/205
 4,899,265 A 2/1990 Maglica 362/187
 4,907,141 A 3/1990 Wang 362/205
 4,914,555 A 4/1990 Gammache 362/183
 4,942,505 A 7/1990 Maglica 362/187
 4,951,183 A 8/1990 Wang 362/187
 4,956,755 A 9/1990 Maglica et al. 362/206
 4,967,325 A 10/1990 Shiau 362/188
 4,980,805 A 12/1990 Maglica et al. 362/72
 4,999,750 A 3/1991 Gammache 362/203
 5,043,854 A 8/1991 Gammache 362/197
 5,062,026 A 10/1991 Maglica et al. 362/72
 5,109,321 A 4/1992 Maglica et al. 362/72
 5,113,326 A 5/1992 Maglica 362/158
 5,122,938 A 6/1992 Pastusek 362/203
 5,124,894 A 6/1992 Shiau 362/187
 5,126,927 A * 6/1992 Reeves et al. 362/187
 5,128,841 A 7/1992 Maglica et al. 362/72
 5,138,537 A 8/1992 Wang 362/187
 5,143,441 A 9/1992 Maglica 362/263
 5,158,358 A 10/1992 Maglica et al. 362/206
 5,161,095 A 11/1992 Gammache 362/197
 5,184,884 A 2/1993 Maglica et al. 362/72
 5,213,408 A 5/1993 Shiau 362/187
 5,260,858 A 11/1993 Maglica 362/205
 5,270,911 A 12/1993 Maglica et al. 362/396
 5,293,307 A 3/1994 Maglica 362/203
 5,309,337 A 5/1994 Groben 362/206
 5,345,370 A 9/1994 Murray et al. 362/205
 5,400,227 A 3/1995 Maglica et al. 362/206
 5,515,246 A 5/1996 Maglica 362/72
 5,541,822 A 7/1996 Bamber 362/190
 5,605,394 A * 2/1997 Chen 362/197
 5,660,363 A 8/1997 Maglica 248/288.31
 5,667,185 A 9/1997 Maglica 248/541
 5,806,964 A 9/1998 Maglica 362/203
 5,816,684 A 10/1998 Yu 326/191
 5,860,728 A 1/1999 Maglica 362/191
 6,004,008 A 12/1999 Lai 362/280
 6,045,236 A 4/2000 Cheng et al. 362/188
 6,170,960 B1 1/2001 Maglica 362/205
 6,186,638 B1 2/2001 Chang 362/119
 6,193,388 B1 2/2001 Halasz et al. 362/205
 6,457,838 B1 10/2002 Dungmore et al. 362/106
 6,905,223 B2 * 6/2005 Halasz 362/197

FOREIGN PATENT DOCUMENTS

GB 549104 11/1942
 GB 90 30 6589 8/1990
 GB 2 091 863 A 8/1992
 GB 2 263 162 B 7/1993

* cited by examiner

U.S. Patent

Aug. 12, 2008

Sheet 1 of 12

US 7,410,272 B2

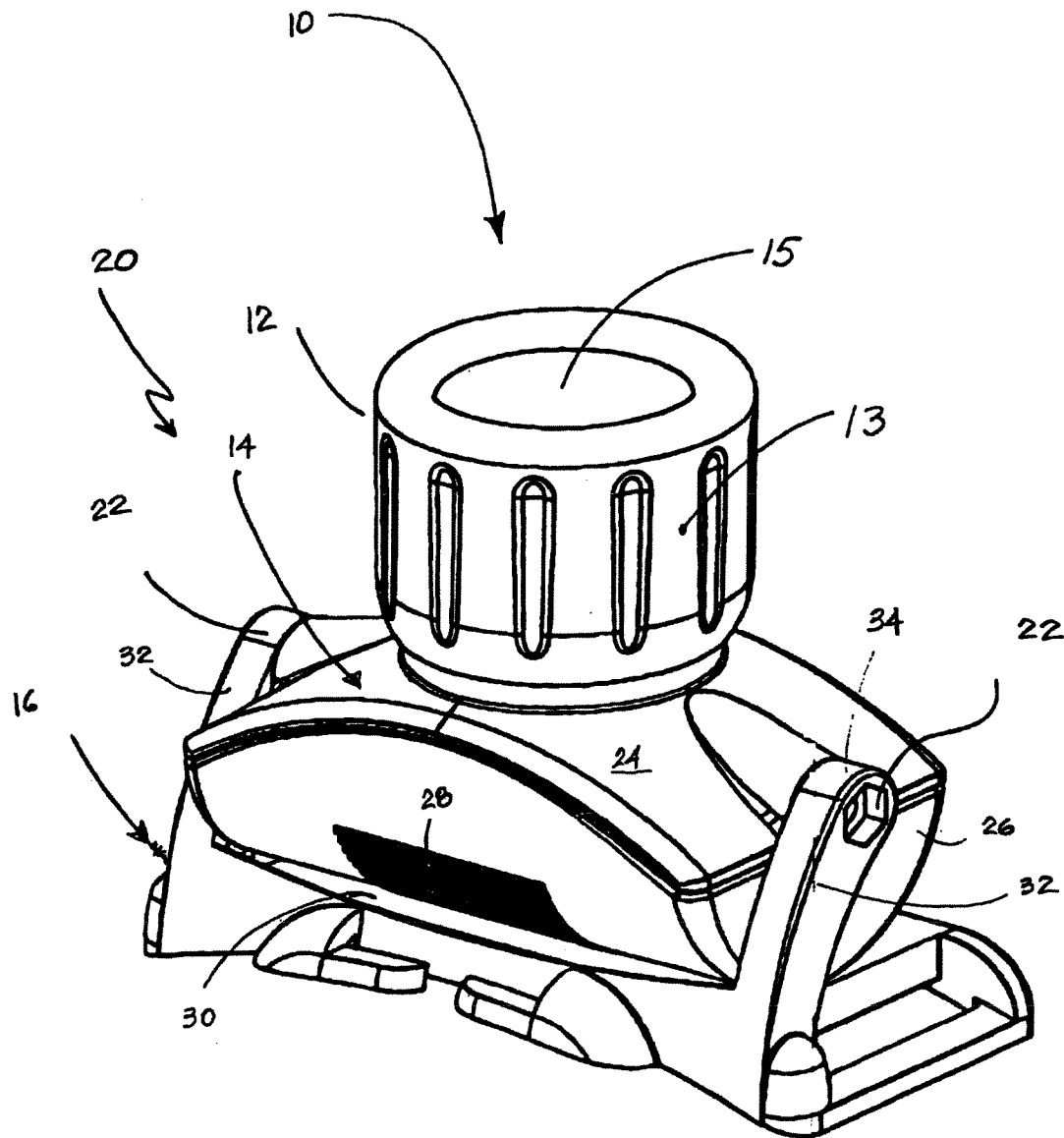

Fig. 1

U.S. Patent

Aug. 12, 2008

Sheet 2 of 12

US 7,410,272 B2

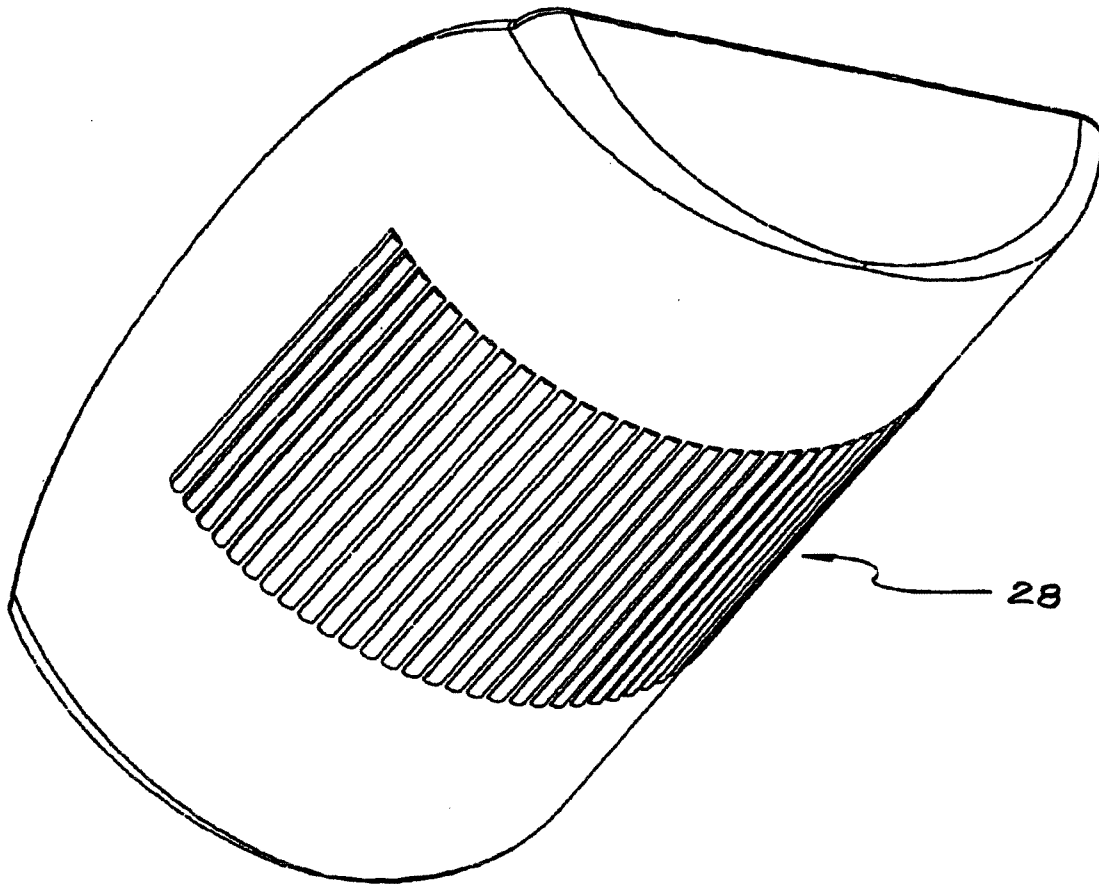

Fig. 2

U.S. Patent

Aug. 12, 2008

Sheet 3 of 12

US 7,410,272 B2

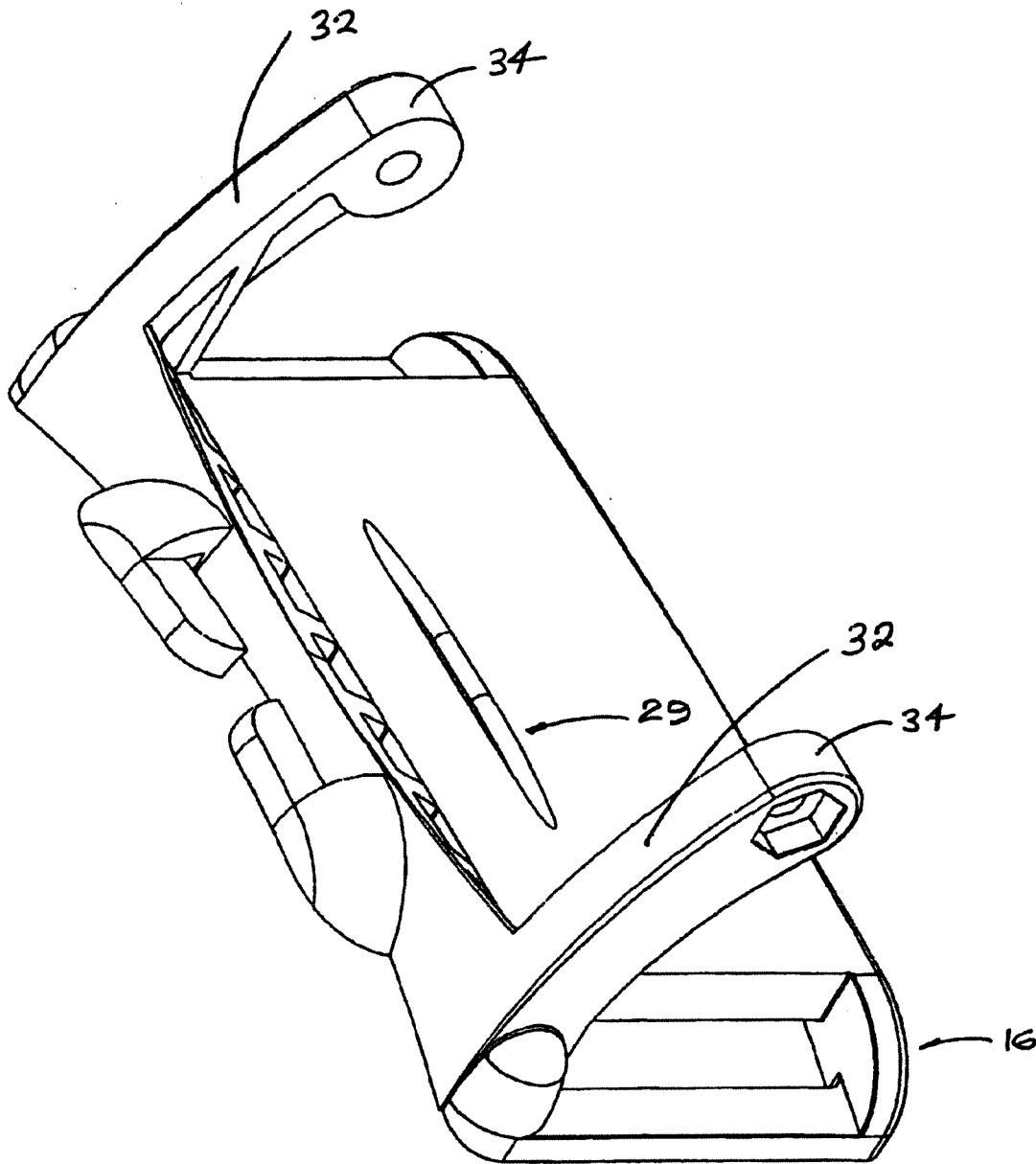

Fig. 3

U.S. Patent

Aug. 12, 2008

Sheet 4 of 12

US 7,410,272 B2

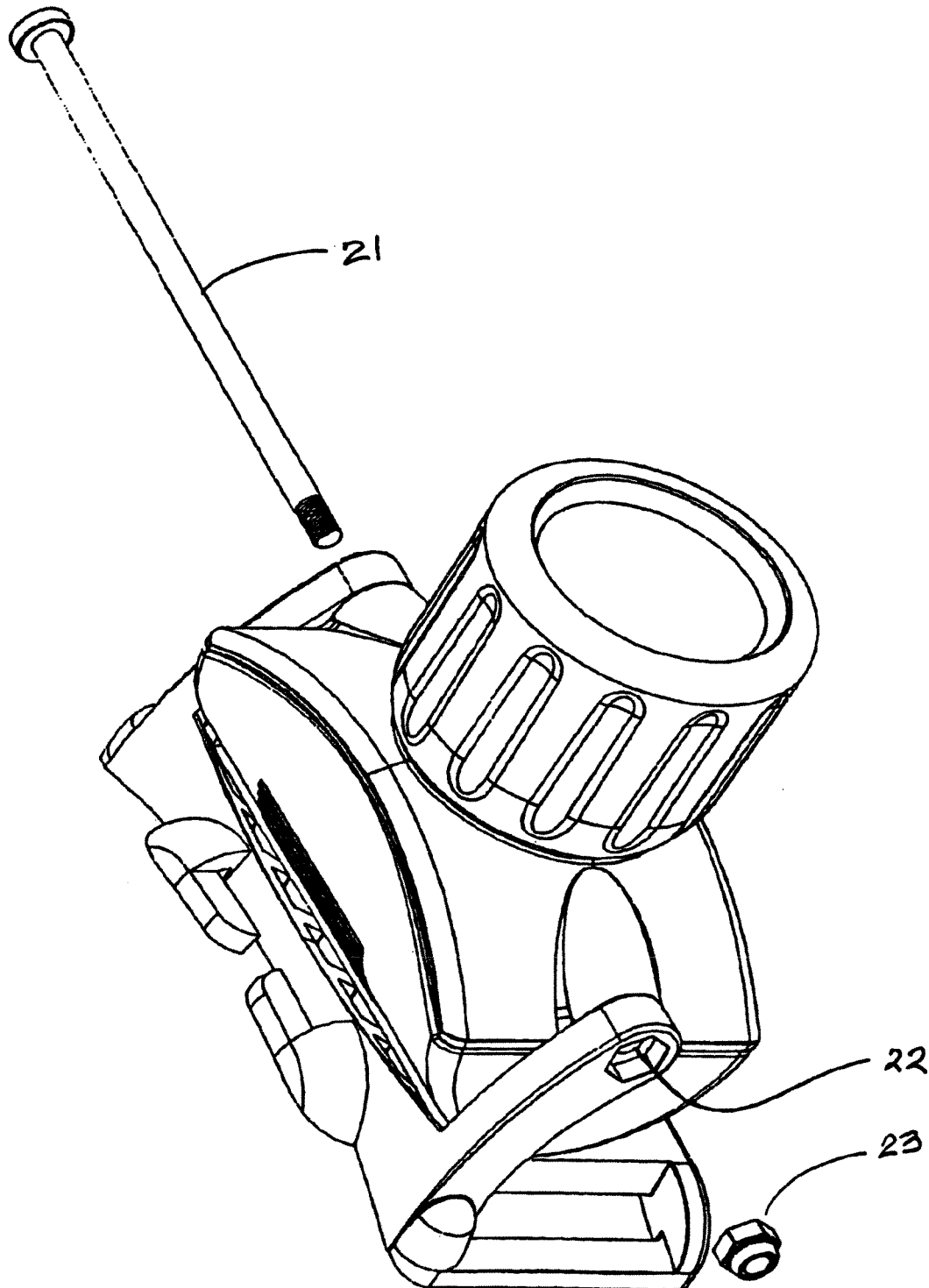

Fig. 4

U.S. Patent

Aug. 12, 2008

Sheet 5 of 12

US 7,410,272 B2

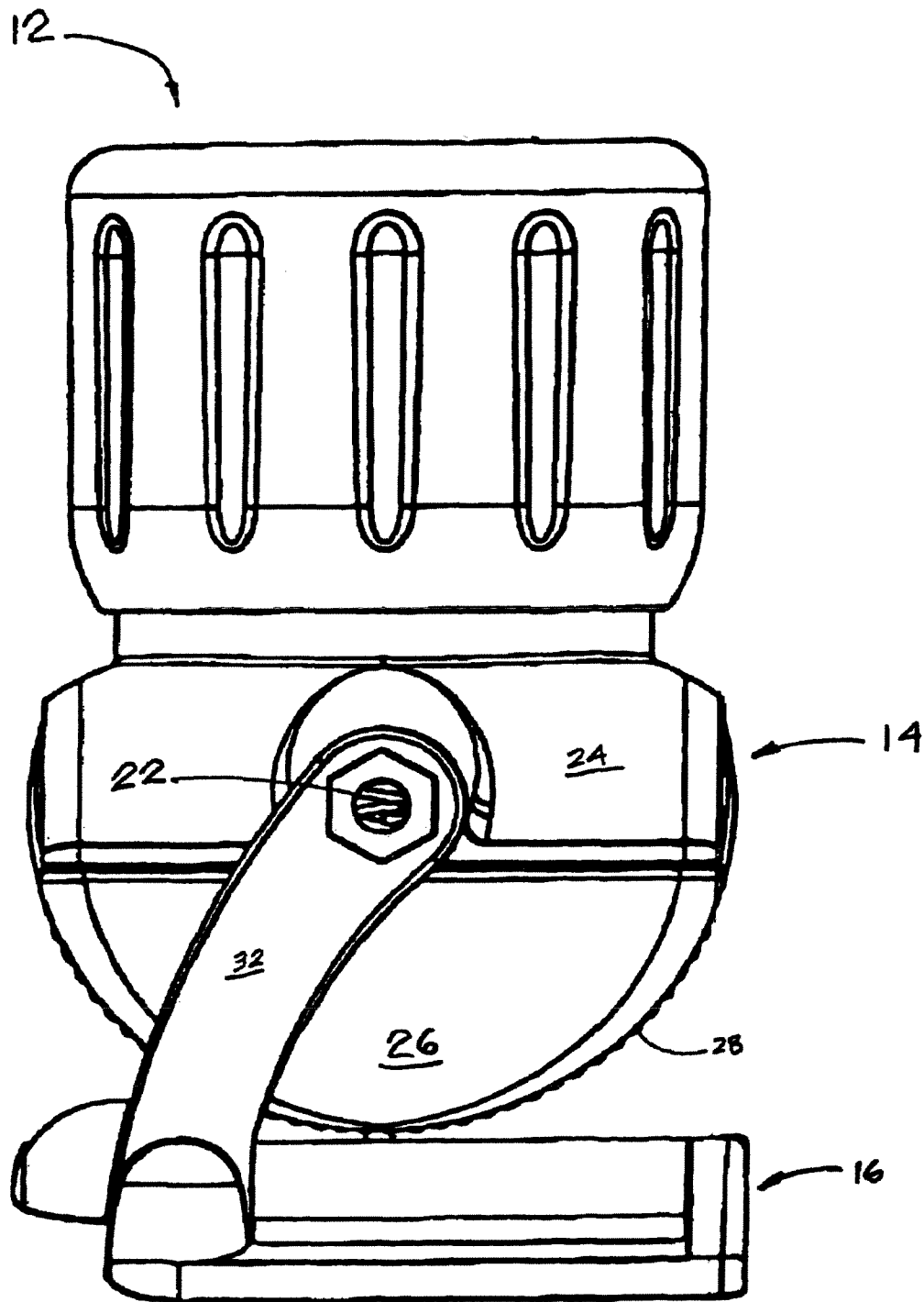

Fig. 5

U.S. Patent

Aug. 12, 2008

Sheet 6 of 12

US 7,410,272 B2

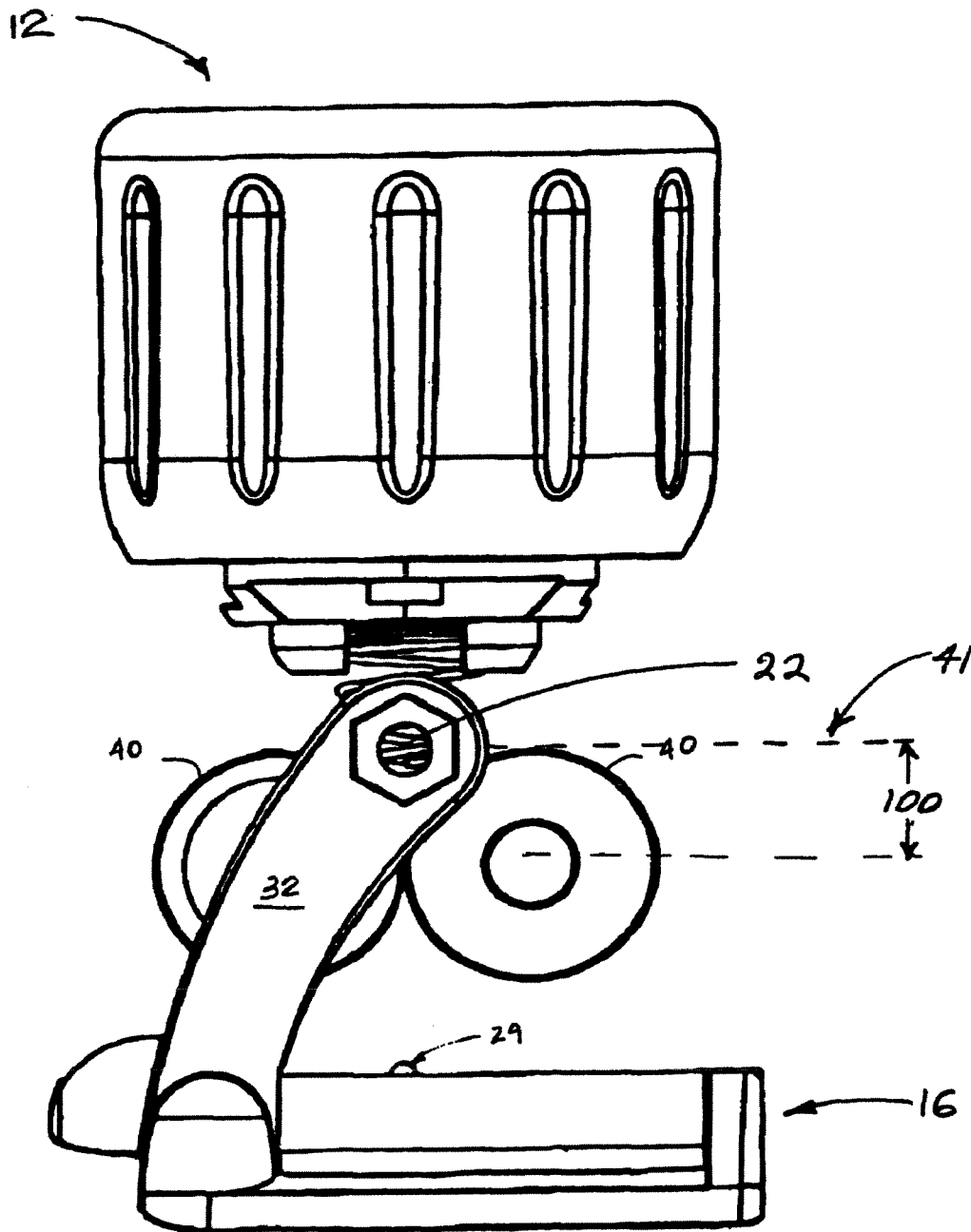

Fig. 6

U.S. Patent

Aug. 12, 2008

Sheet 7 of 12

US 7,410,272 B2

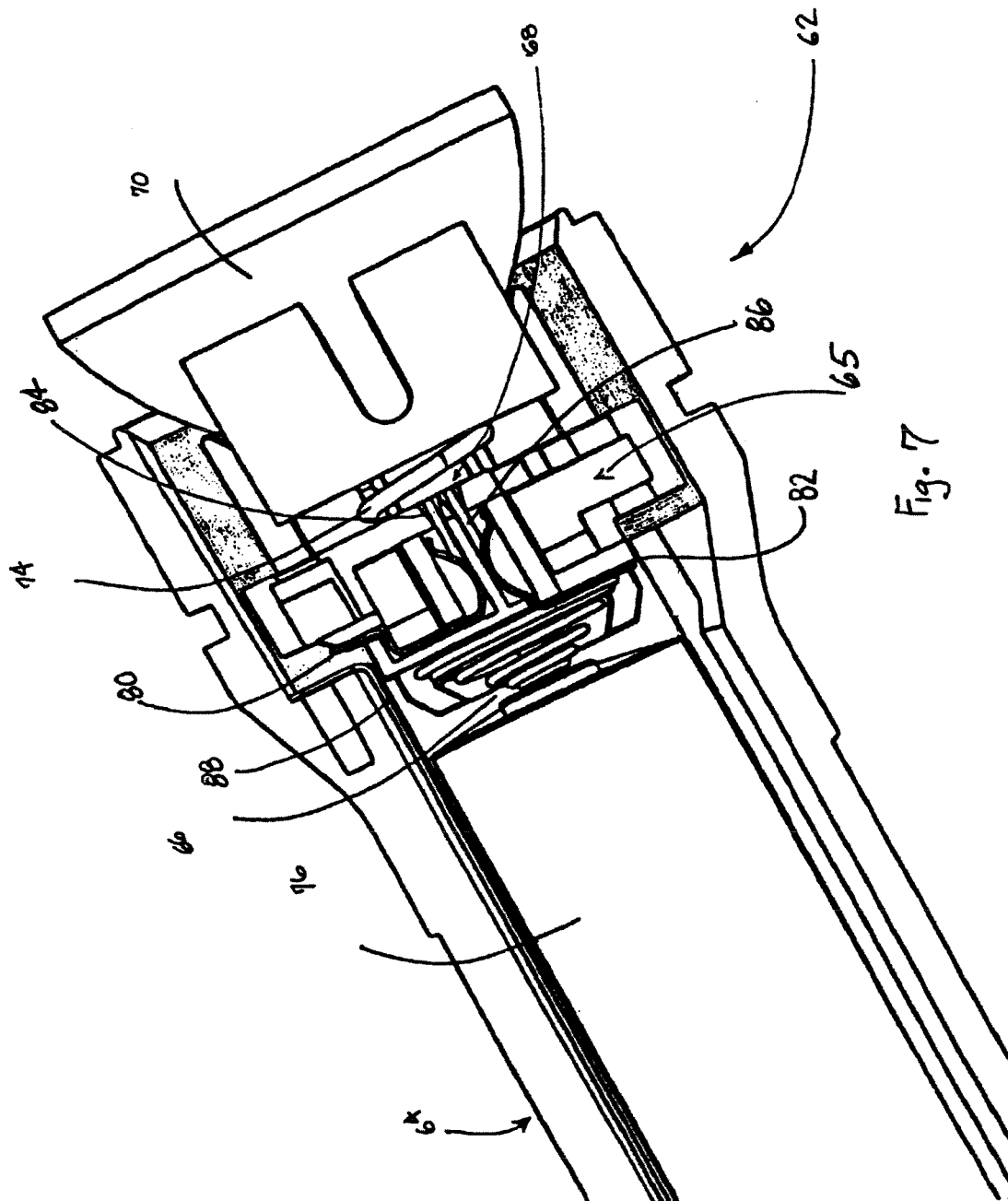

U.S. Patent

Aug. 12, 2008

Sheet 8 of 12

US 7,410,272 B2

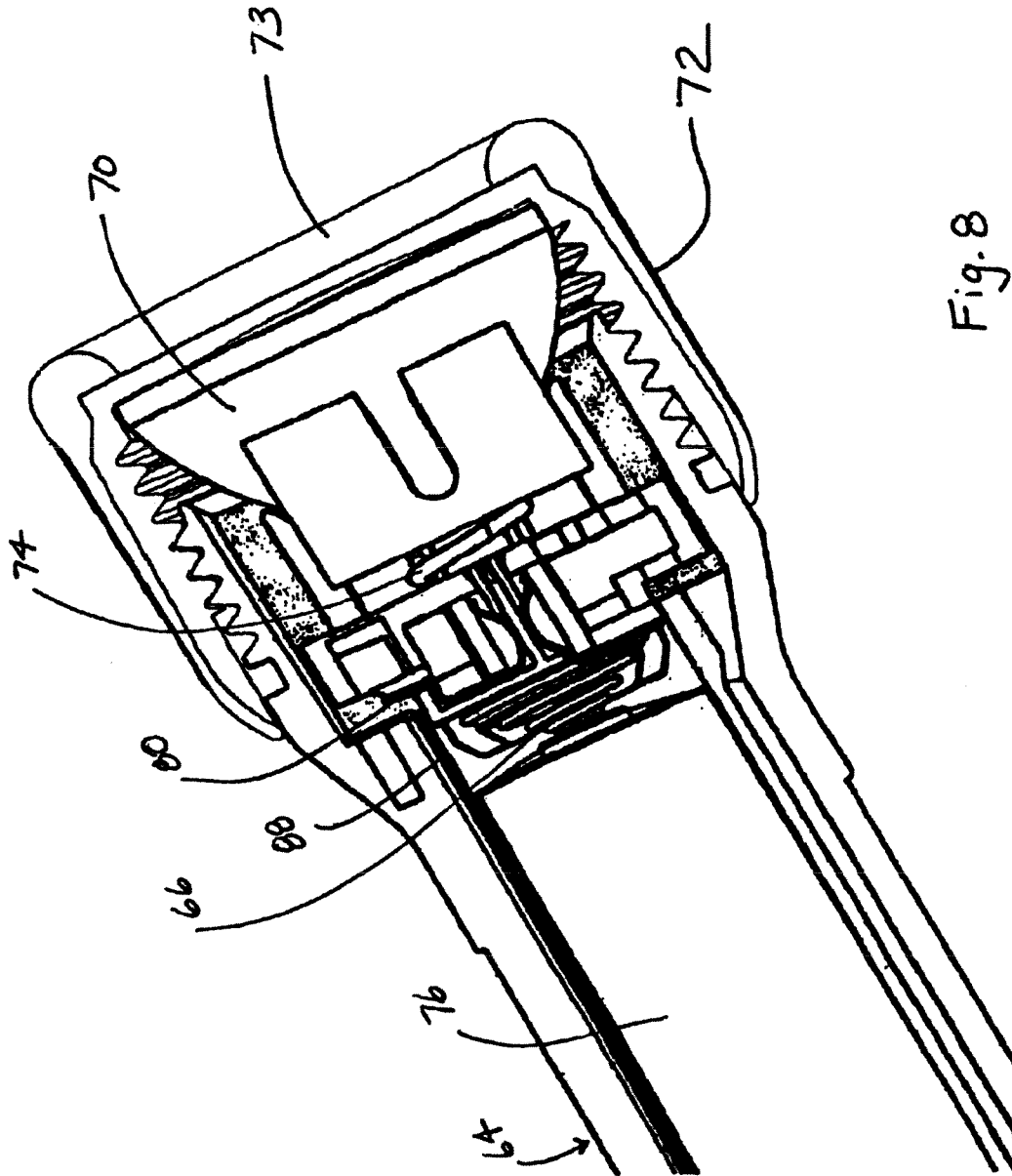

U.S. Patent

Aug. 12, 2008

Sheet 9 of 12

US 7,410,272 B2

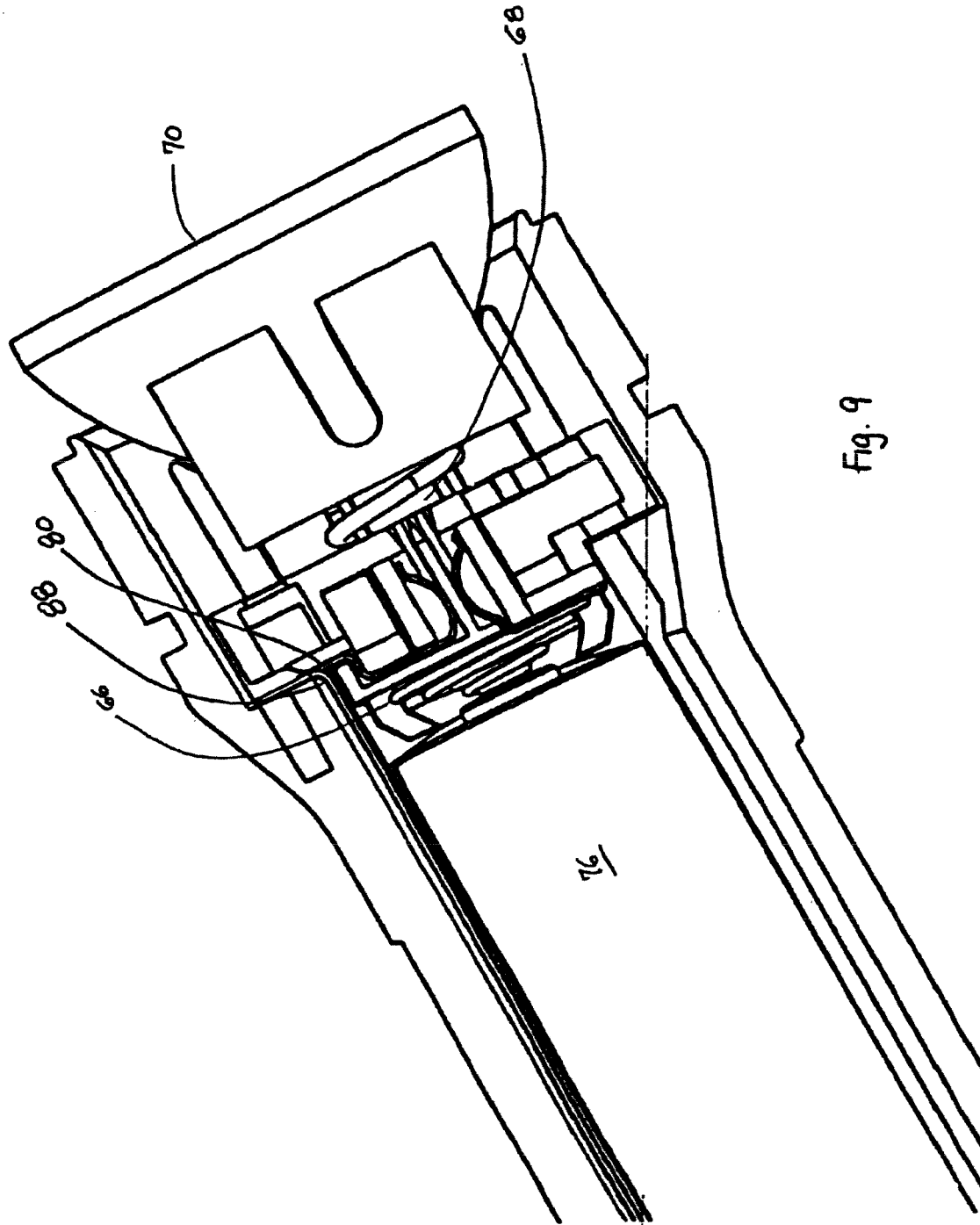

U.S. Patent

Aug. 12, 2008

Sheet 10 of 12

US 7,410,272 B2

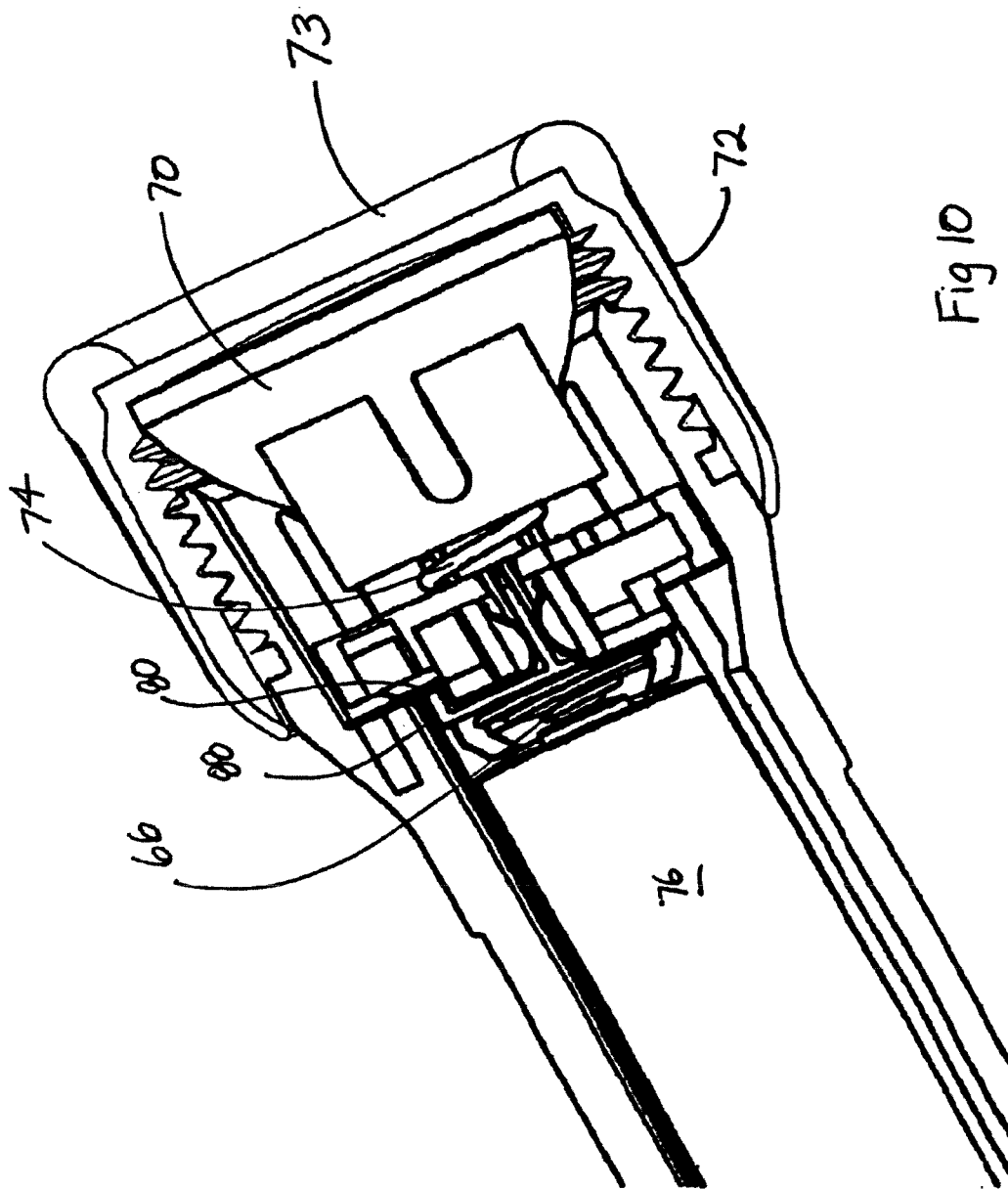

U.S. Patent

Aug. 12, 2008

Sheet 11 of 12

US 7,410,272 B2

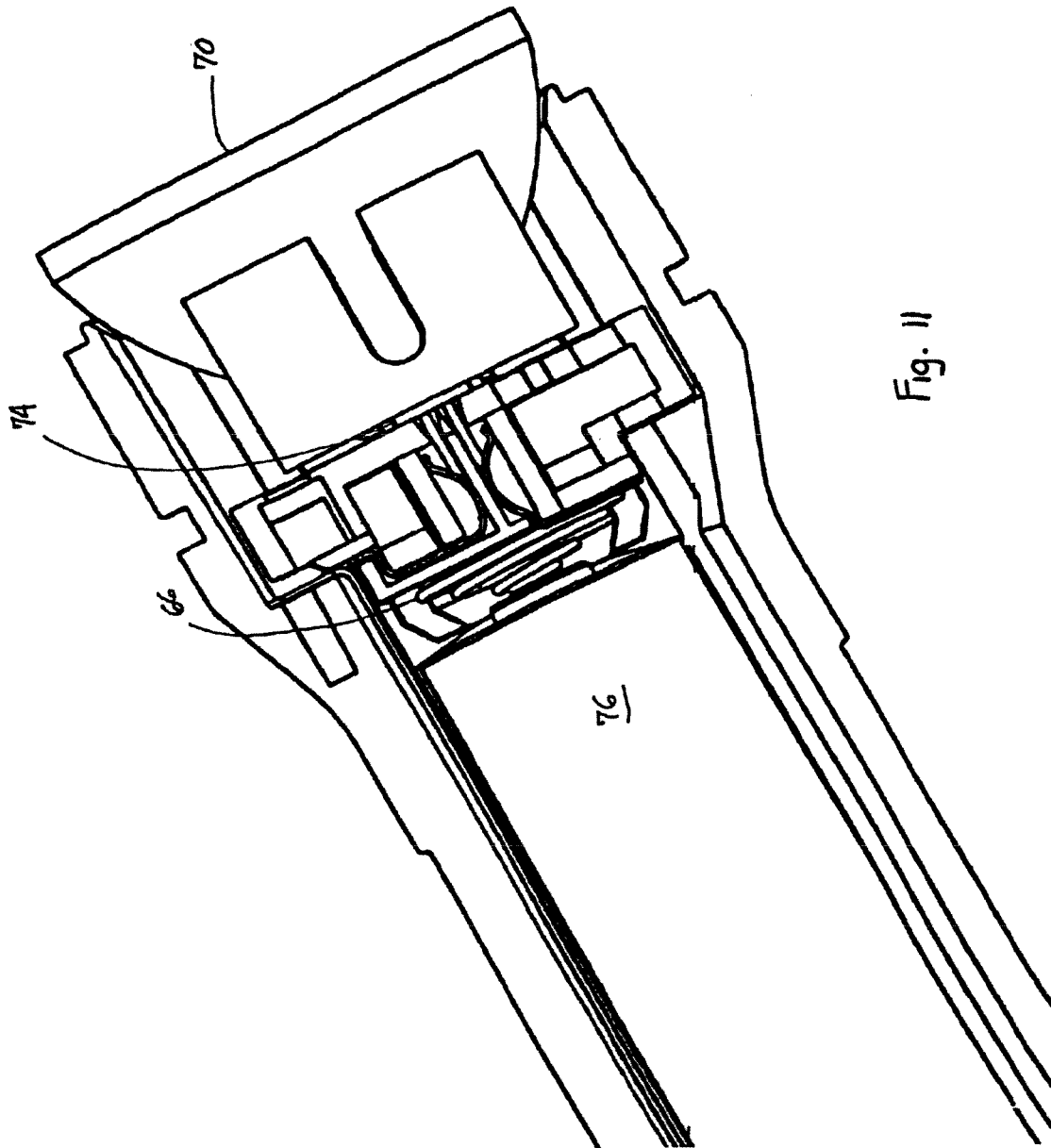

U.S. Patent

Aug. 12, 2008

Sheet 12 of 12

US 7,410,272 B2

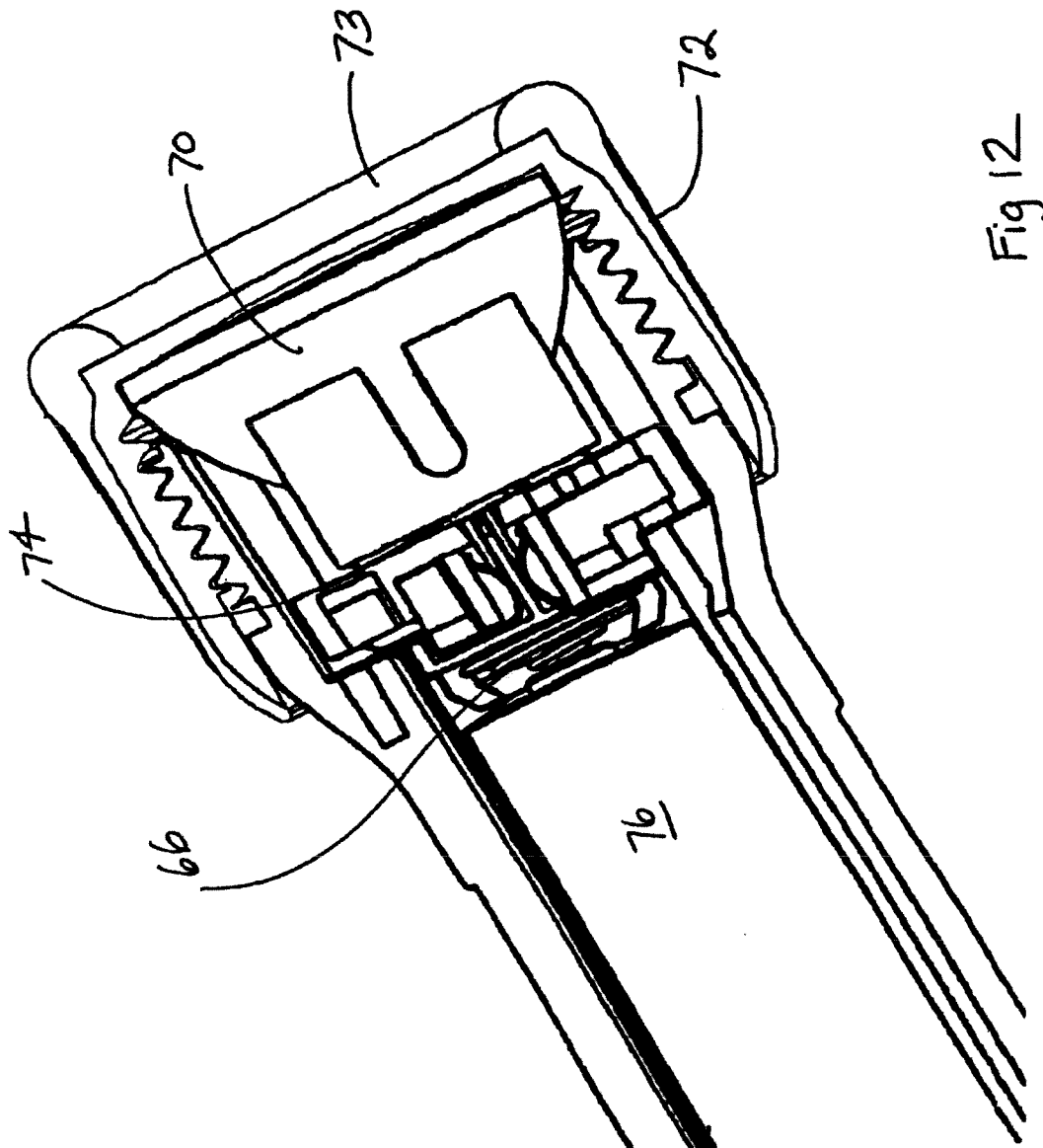

Fig 12

US 7,410,272 B2

1
LIGHTING DEVICE
PRIORITY

This application is a continuation of U.S. patent application Ser. No. 11/137,214, filed May 24, 2005 now abandoned, now pending, which is a continuation of U.S. patent application Ser. No. 09/927,484, filed Aug. 10, 2001, now U.S. Pat. No. 6,905,223, which in turn claimed priority to U.S. Patent Application Ser. No. 60/224,313, filed Aug. 10, 2000. The foregoing applications are incorporated by reference as if fully set forth herein.

FIELD OF INVENTION

The present invention relates to the field of portable, battery-operated flashlights. More particularly, the present invention relates to a portable, battery-operated flashlight having improved pivoting features such that it may be worn as a head lamp. In another aspect of the invention, the portable, battery-operated flashlight has improved switching and focusing features such that the lamp's position in the reflector may be varied to focus or defocus the light from the lamp.

BACKGROUND OF INVENTION

Flashlights generally include a battery chamber for retaining one or more batteries, a light bulb electrically connected to the one or more batteries, and a reflector for reflecting the light from the light bulb in a particular direction. The electrical connection between the batteries and the light bulb usually includes a switch mechanism for selectively providing electrical energy from the batteries to the light bulb and, therefore, enabling the flashlight to be turned on and off.

A primary function of flashlights is to provide a convenient portable, storable light source that is capable of projecting light in a particular direction. However, it is difficult in some flashlights to project light in a particular direction because of the stationary nature and fixed connectivity of flashlight parts relative to each other. In addition, the difficulty of light projection in a desired direction may be also limited by the inflexible nature of the reflector.

SUMMARY OF INVENTION

The present invention satisfies, to a great extent, the foregoing and other needs not currently satisfied by existing flashlights. This result is achieved, in an exemplary embodiment, by a portable, battery-operated flashlight having an improved pivot point for the lamp portion. In this embodiment, the flashlight takes the form of an attachment usable as a head worn lamp, which may be attached to head gear such as a safety helmet or include an elastic band to secure the flashlight to a user's head.

The flashlight comprises a body, a base portion and a lamp. The body is for retaining at least one battery, and has a serrated-like surface on an exterior surface to facilitate desired angular adjustment of the body, and thus the light. Preferably, the body comprises a top portion and a bottom portion, which contains the serrations. The base portion is pivotally connected to the body at two points, and has pivot stops therein to adjust the body angularly as desired. Preferably, the base portion is affixable to a head gear. The lamp is removably attached to the body, and selectively connected to the battery to cause the lamp to emanate light.

The pivot connection between the base portion and the body allows a low profile positioning of the lamp with respect

to a user's desired line of lighted vision. The pivot connection allows for 180 degree angular adjustment of the body and lamp with respect to the base portion. The pivot stops located on the base portion also allow for 180 degree angular adjustment of the body with respect to the base portion. This is achieved when the pivot stops mate with the serrated edges on the body.

In another aspect of the invention, a flashlight having improved switching and focusing features is disclosed. Here, the portable, battery-operated flashlight takes the form of a long-handled flashlight which construction allows variation in the ability to focus and defocus the lamp's light. The flashlight comprises a body, lamp, head assembly and switching assembly. The body retains at least one battery. The lamp, which is removably attached to the body, is selectively connected to the battery to cause the lamp to emanate light. The switching assembly is movable relative to the head assembly such that axial movement of the switching assembly causes electrical coupling of the lamp with the battery and causes a position of the lamp to vary to focus and defocus the light.

The head assembly comprises a bezel that is capable of radial movement to cause the switching assembly to move axially. In this regard, the switching assembly includes a first spring located most adjacent to the battery, and a second spring located most adjacent to the reflector. As the switching assembly moves axially, the first spring is caused to compress first to cause electrical coupling of the lamp with the battery. Once the switch assembly makes electrical contact with the battery, the second spring compresses to cause the position of the lamp to vary within the reflector to cause focusing and defocusing of the light emanating from the lamp.

With these and other advantages and features of the invention that may become hereinafter apparent, the nature of the invention may be more clearly understood by reference to the following detailed description of the invention, the appended claims and to the several drawings attached herein.

BRIEF DESCRIPTION OF THE DRAWINGS

FIG. 1 is a perspective front view of a head worn flashlight in accordance with an exemplary embodiment of the present invention.

FIG. 2 is a close up view of a preferred embodiment of the serrations on the body.

FIG. 3 is a close up view of a preferred embodiment of the pivot stop on the base.

FIG. 4 is an exploded view of the pivot connection in accordance with the present invention.

FIG. 5 is another view of the flashlight of the present invention.

FIG. 6 is a view showing the removed body of the flashlight.

FIG. 7 is cross-sectional front view of a long-handled flashlight (without bezel) showing readiness of the reflector to move in the direction towards the batteries.

FIG. 8 is cross-sectional front view of a long-handled flashlight (with bezel) showing readiness of the reflector to move in the direction towards the batteries.

FIG. 9 is a cross-sectional front view of the flashlight of FIG. 7 showing the switching assembly is in the "on" position.

FIG. 10 is a cross-sectional front view of the flashlight of FIG. 8 showing the switching assembly is in the "on" position.

FIG. 11 is a cross-sectional front view of the flashlight of FIG. 7 showing compression of the second spring.

US 7,410,272 B2

3

FIG. 12 is a cross-sectional front view of the flashlight of FIG. 8 showing compression of the second spring.

DETAILED DESCRIPTION OF PREFERRED EMBODIMENTS

Referring now to the figures, wherein like reference numerals indicate like elements, in FIG. 1 there is shown a perspective front view of a head worn flashlight 10 in accordance with an exemplary embodiment of the present invention. As depicted, flashlight 10 is shown as having a head assembly 12, a body 14 and a base 16, which may serve as an attachment portion. The head assembly 12 and body 14 generally comprise the head light 20.

The head assembly 12 comprises a bezel 13, a switch assembly (not shown), a lamp (not shown), reflector (not shown) and lens 15. In this embodiment, the bezel 13 is capable of radial movement (i.e., rotation) to cause the switch to selectively connect the lamp to the one or more batteries, and therefore cause the lamp to emanate light. Further, the bezel 13 is capable of radial movement to cause focusing and defocusing of light from the lamp. The reflector directs light from the lamp through the lens. The head light 20 of the flashlight 10 is assembled by attaching the head assembly 12 and switch assembly to the body 14, such that the lamp is positioned in the switch assembly and is in alignment with the reflector via an opening in the reflector. The head assembly 12 is removably attached to the body 14.

The body 14 serves as a chamber for holding one or more batteries in a series arrangement. The body 14 comprises a top portion 24 and a bottom portion 26. The top portion 24 is removably attached to the bottom portion 26 to selectively uncover the interior portion of the body 14 to allow, among other things, the one or more batteries to be inserted or removed. Referring to FIGS. 1 and 2, the body 14 also includes, in a mid-region of the bottom portion 26, serrations 28 on an exterior surface of the body 14 for engaging a surface 30 of the base 16. A close-up view of a preferred embodiment of serrations 28 is shown in FIG. 2. Serrations 28 facilitate desired angular adjustment of the body 14 and head assembly 12 with respect to the base 16. This is accomplished when serrations 28 mate with the pivot stop 29 located on base 16, as shown in FIG. 3.

In general, movement of the body 14 is achieved by two pivot connection points 22 at each end of the body 14 to the base 16. The substantially flat, arched undersurface (not shown) of the base 16 facilitates standing of the flashlight 10 on a flat surface. It also facilitates attachment of the base 16 to a curved surface object, such as head gear, or placement directly on a human forehead. In this regard, attachment of the flashlight 10 to a safety helmet, for example, allows desired positioning of the direction of the light emanating from the lamp while providing more stability. Another advantage of the attachment feature of base 16 is hands free use of the flashlight 10.

In the embodiment depicted, the base 16 is rectangular in shape and has an arm 32 projecting from each base end. A distal end 34 of the arm 32 is the location area of the pivot point 22 connecting the body 14 to the base 16. As shown in FIG. 4, screw 21 engages nut 23 to form pivot point 22. As shown in FIG. 5, use of the serrations 28 in conjunction with pivot point 22 allows for 180 degree angular adjustment of the body 14, and consequently the head light 12, with respect to the base 16. Additionally, when the flashlight 10 is used as a head lamp, the pivot point 22 allows the body 14 to maintain contact with the base 16.

4

Referring now to FIG. 6, there is shown a view of the flashlight showing removal of the body 14 casing, which covered the batteries 40. In the embodiment depicted, the two batteries 40 are exposed to illustrate that the pivot point 22 is spatially located at a distance 100 from the plane that intersects a center point of each battery. In this regard, the pivot point 22 is located between the batteries and the head assembly 12. Preferably, the pivot point 22 is located substantially along the tangent plane 41 of the two batteries 40. This advantageously facilitates the balanced positioning of the head assembly 12 and comfort for a user wearing the device.

Referring now to FIGS. 7-12, there is shown a long-handled flashlight having improved switching and focusing features in accordance with another embodiment of the present invention. It is important to note that the improved switching and focusing features described below and shown in FIGS. 7-12 are applicable to the head light 20 described above and shown in FIGS. 1-6. As depicted, the flashlight is shown as having a head assembly 62, a body 64 and a switching assembly 65. The head assembly 62 comprises a lamp 68, a reflector 70, a bezel 72, and a lens 73. The switching assembly 65 includes a first spring 66, a second spring 74, a first electrical contact 80 and a second electrical contact 82. The lamp 68 (partially shown) includes a first pin 84 that contacts the first electrical contact 80 and a second pin 86 that contacts the second electrical contact 82. The second pin 86 is electrically connected to the first spring 66 that is in electrical contact with one of the batteries 76. The body 64 includes a chamber contact 88 that runs the length of the body 64 and is capable of electrical connection to batteries 76 located within the body 64. A description of the switching, focusing and defocusing aspects of the flashlight is explained below with reference to FIGS. 7-12.

Referring to FIGS. 7 and 8, the flashlight is shown in the "off" position. In this position, the switching assembly 65 is permitted to move towards and away from the body 64 (i.e. axially). Axial movement of the switching assembly 65 is achieved by radial movement of the bezel 72. In this regard, the bezel 72 is capable of radial movement that causes the bezel 72 to move axially towards the battery 76. The bezel 72 is in contact with the reflector 70, and the reflector is in contact with the second spring 74. As a result of radial movement of the bezel 72, the reflector 70 moves axially towards the battery 76.

Referring now to FIGS. 9 and 10, the flashlight is shown in the "on" position. Noteworthy is the collapsed position of the first spring 66. The second spring 74 is not collapsed. This is accomplished by turning or rotating the bezel 72. As the bezel is rotated, the reflector 70 is caused to move axially towards the battery 76. The compression force of the first spring 66 and the second spring 74 are selected to allow the first spring 66 to substantially collapse before the second spring 74. As a result, as the bezel 72 is rotated, the reflector 70 exerts a downward axial compressive force, causing the first spring 66 only to collapse. At this juncture, the second spring 74 does not collapse during this movement and, as a result, the reflector 70 and the switching assembly move together towards the batteries 76. The compression of the first spring 66 causes the lamp 68 to turn on because an electrical connection is made with the batteries 76. In this regard, the first electrical contact 80 contacts the chamber contact 88 causing a completion of the electrical connection between the first pin 84 and second pin 86 and the batteries 76.

Referring now to FIGS. 11 and 12, there is shown the collapsed position of both the first spring 66 and the second spring 74. When the first electrical contact 80 contacts the chamber contact 88, and the bezel continues to rotate, further

US 7,410,272 B2

5

movement of the reflector 70 exerts additional compressive forces in the direction of the batteries 76, causing the second spring 74 to collapse. As a consequence, the reflector 70 is caused to move relative to the lamp 68 and the switching assembly. In other words, the practical effect of this condition is that the position of the lamp 68 within the reflector 70 can be varied as desired to focus or defocus the light from the lamp 68 through the lens 73, depending on where the lamp 68 is positioned within the reflector 70.

The head portion of the flashlight can be disassembled by rotating the bezel 72 from the "off" position in a direction opposite to the first rotation direction, thereby disengaging the second spring 74 and then the first spring 66 from electrical contact.

The foregoing description of the present invention has been presented for purposes of illustration and description. The description is not intended to limit the invention to the form disclosed herein. Consequently, the invention and modifications commensurate with the above teachings and skill and knowledge of the relevant art are within the scope of the present invention. It is intended that the appended claims be construed to include all alternative embodiments as permitted by the prior art.

What is claimed is:

1. A lighting apparatus, comprising:

a body for retaining at least one battery, said body having a plurality of serrations;
a base attached to said body by at least one pivot connection point, said base having a stop; and
a light source, housed within said body, and selectively electrically connected to said at least one battery to cause said light source to emanate light;
wherein said stop is capable of engaging with one or more of said serrations to facilitate desired angular adjustment of light emanating from said light source.

2. A lighting apparatus, comprising:

a power supply;
a body having a plurality of serrations;
a base attached to said body by at least one pivot connection point, said base having a stop; and
a light source, attached to said body, and selectively electrically connected to said power supply to cause said light source to emanate light;
wherein said stop is capable of engaging with one or more of said serrations to facilitate desired angular adjustment of light emanating from said light source.

3. A lighting apparatus, comprising:

a body for retaining at least one battery;
a light source;
a head capable of housing said light source, wherein said head is removably attached to said body and movement thereof selectively electrically connects said light source with said at least one battery; and

6

a base, connected to said body, wherein at least one point of connection between said base and said body is located substantially between said at least one battery and said head to facilitate the balanced position of said head.

4. A lighting apparatus, comprising:

a body for retaining at least one battery;
a light source;
a reflector;
a head for retaining said reflector and said light source;
wherein said light source is capable of being selectively electrically connected to said at least one battery to cause said light source to emit light;
wherein axial movement of said head toward said body is capable of causing axial movement of said reflector together with said light source; and
wherein further axial movement of said head toward said body is capable of causing axial movement of said reflector relative to said light source.

5. A lighting apparatus, comprising:

a body for retaining at least one battery;
a light source;
a reflector; and
a head for retaining said reflector and said light source;
wherein said light source is capable of being selectively electrically connected to said at least one battery to cause said light source to emit light;
wherein axial movement of said reflector toward said body is capable of causing axial movement of said reflector together with said light source; and
wherein further axial movement of said reflector toward said body is capable of causing axial movement of said reflector relative to said light source.

6. The lighting apparatus according to claim 5, wherein said head comprises a bezel and rotation of said bezel is capable of causing axial movement of said reflector toward said body.

7. A lighting apparatus including a switch assembly, comprising:

a reflector having a central opening;
a light source capable of protruding through the central opening of said reflector;
a first spring electrically connected to said light source, wherein compression of said first spring causes axial movement of said reflector together with said light source;
a second spring mechanically connected to said reflector, wherein compression of said second spring causes axial movement of said reflector relative to said light source; and
wherein said second spring has a greater resistance to compression than said first spring.

* * * * *

**UNITED STATES DISTRICT COURT
CENTRAL DISTRICT OF CALIFORNIA**

NOTICE OF ASSIGNMENT TO UNITED STATES MAGISTRATE JUDGE FOR DISCOVERY

This case has been assigned to District Judge Percy Anderson and the assigned discovery Magistrate Judge is Victor B. Kenton.

The case number on all documents filed with the Court should read as follows:

CV09- 1842 PA (VBKx)

Pursuant to General Order 05-07 of the United States District Court for the Central District of California, the Magistrate Judge has been designated to hear discovery related motions.

All discovery related motions should be noticed on the calendar of the Magistrate Judge

=====

NOTICE TO COUNSEL

A copy of this notice must be served with the summons and complaint on all defendants (if a removal action is filed, a copy of this notice must be served on all plaintiffs).

Subsequent documents must be filed at the following location:

☒ **Western Division**
312 N. Spring St., Rm. G-8
Los Angeles, CA 90012

☐ **Southern Division**
411 West Fourth St., Rm. 1-053
Santa Ana, CA 92701-4516

☐ **Eastern Division**
3470 Twelfth St., Rm. 134
Riverside, CA 92501

Failure to file at the proper location will result in your documents being returned to you.

UNITED STATES DISTRICT COURT
CENTRAL DISTRICT OF CALIFORNIA

MAG INSTRUMENT, INC., a California
corporation,

v.

PLAINTIFF,

THE COLEMAN COMPANY, INC., a Delaware
corporation, and DOES 1-10,

DEFENDANTS.

CASE NUMBER

CV-09-01842

PA

VBKx

SUMMONS

TO: THE ABOVE-NAMED DEFENDANT(S):

YOU ARE HEREBY SUMMONED and required to file with this court and serve upon plaintiff's attorney

Robert C. Weiss, whose address is:

JONES DAY
555 South Flower Street, 50th Floor
Los Angeles, CA 90071
(213) 489-3939

An answer to the ☒ COMPLAINT, ☐ _____ AMENDED COMPLAINT,
(1", 2", etc.)

☐ COUNTERCLAIM, ☐ CROSS-CLAIM which is herewith served upon you within 20 days after
service of this summons upon you, exclusive of the day of service. If you fail to do so, judgment by default will
be taken against you for the relief demanded in the complaint.

CLERK, U. S. DISTRICT COURT

DATE: MAR 18 2009

By _____

LA'REE HORN
Deputy Clerk
(SEAL OF THE COURT)
1192

I (a) PLAINTIFFS (Check box if you are representing yourself <input type="checkbox"/>) MAG INSTRUMENT, INC., a California corporation	DEFENDANTS THE COLEMAN COMPANY, INC., a Delaware corporation, and DOES 1-10
(b) County of Residence of First Listed Plaintiff (Except in U.S. Plaintiff Cases): San Bernardino	County of Residence of First Listed Defendant (In U.S. Plaintiff Cases Only):
(c) Attorneys (Firm Name, Address and Telephone Number. If you are representing yourself, provide same.) Robert C. Weiss JONES DAY 555 South Flower Street, 50th Floor Los Angeles, CA 90071 (213) 489-3939	Attorneys (If Known)

II. BASIS OF JURISDICTION (Place an X in one box only.) <input type="checkbox"/> 1 U.S. Government Plaintiff <input checked="" type="checkbox"/> 3 Federal Question (U.S. Government Not a Party) <input type="checkbox"/> 2 U.S. Government Defendant <input type="checkbox"/> 4 Diversity (Indicate Citizenship of Parties in Item III)	III. CITIZENSHIP OF PRINCIPAL PARTIES - For Diversity Cases Only (Place an X in one box for plaintiff and one for defendant.) <table style="width:100%; border: none;"> <tr> <td style="width:33%; border: none;">Citizen of This State</td> <td style="width:33%; border: none;"> <table style="width:100%; border: none;"> <tr> <td style="text-align: center;">PTF</td> <td style="text-align: center;">DEF</td> <td style="border: none;"></td> <td style="text-align: center;">PTF</td> <td style="text-align: center;">DEF</td> </tr> <tr> <td style="text-align: center;"><input type="checkbox"/> 1</td> <td style="text-align: center;"><input type="checkbox"/> 1</td> <td style="border: none;">Incorporated or Principal Place of Business in this State</td> <td style="text-align: center;"><input type="checkbox"/> 4</td> <td style="text-align: center;"><input type="checkbox"/> 4</td> </tr> </table> </td> <td style="width:33%; border: none;">Citizen of Another State</td> </tr> <tr> <td style="border: none;"></td> <td style="border: none;"> <table style="width:100%; border: none;"> <tr> <td style="text-align: center;"><input type="checkbox"/> 2</td> <td style="text-align: center;"><input type="checkbox"/> 2</td> <td style="border: none;">Incorporated and Principal Place of Business in Another State</td> <td style="text-align: center;"><input type="checkbox"/> 5</td> <td style="text-align: center;"><input type="checkbox"/> 5</td> </tr> </table> </td> <td style="border: none;">Citizen or Subject of a Foreign Country</td> </tr> <tr> <td style="border: none;"></td> <td style="border: none;"> <table style="width:100%; border: none;"> <tr> <td style="text-align: center;"><input type="checkbox"/> 3</td> <td style="text-align: center;"><input type="checkbox"/> 3</td> <td style="border: none;">Foreign Nation</td> <td style="text-align: center;"><input type="checkbox"/> 6</td> <td style="text-align: center;"><input type="checkbox"/> 6</td> </tr> </table> </td> <td style="border: none;"></td> </tr> </table>	Citizen of This State	<table style="width:100%; border: none;"> <tr> <td style="text-align: center;">PTF</td> <td style="text-align: center;">DEF</td> <td style="border: none;"></td> <td style="text-align: center;">PTF</td> <td style="text-align: center;">DEF</td> </tr> <tr> <td style="text-align: center;"><input type="checkbox"/> 1</td> <td style="text-align: center;"><input type="checkbox"/> 1</td> <td style="border: none;">Incorporated or Principal Place of Business in this State</td> <td style="text-align: center;"><input type="checkbox"/> 4</td> <td style="text-align: center;"><input type="checkbox"/> 4</td> </tr> </table>	PTF	DEF		PTF	DEF	<input type="checkbox"/> 1	<input type="checkbox"/> 1	Incorporated or Principal Place of Business in this State	<input type="checkbox"/> 4	<input type="checkbox"/> 4	Citizen of Another State		<table style="width:100%; border: none;"> <tr> <td style="text-align: center;"><input type="checkbox"/> 2</td> <td style="text-align: center;"><input type="checkbox"/> 2</td> <td style="border: none;">Incorporated and Principal Place of Business in Another State</td> <td style="text-align: center;"><input type="checkbox"/> 5</td> <td style="text-align: center;"><input type="checkbox"/> 5</td> </tr> </table>	<input type="checkbox"/> 2	<input type="checkbox"/> 2	Incorporated and Principal Place of Business in Another State	<input type="checkbox"/> 5	<input type="checkbox"/> 5	Citizen or Subject of a Foreign Country		<table style="width:100%; border: none;"> <tr> <td style="text-align: center;"><input type="checkbox"/> 3</td> <td style="text-align: center;"><input type="checkbox"/> 3</td> <td style="border: none;">Foreign Nation</td> <td style="text-align: center;"><input type="checkbox"/> 6</td> <td style="text-align: center;"><input type="checkbox"/> 6</td> </tr> </table>	<input type="checkbox"/> 3	<input type="checkbox"/> 3	Foreign Nation	<input type="checkbox"/> 6	<input type="checkbox"/> 6	
Citizen of This State	<table style="width:100%; border: none;"> <tr> <td style="text-align: center;">PTF</td> <td style="text-align: center;">DEF</td> <td style="border: none;"></td> <td style="text-align: center;">PTF</td> <td style="text-align: center;">DEF</td> </tr> <tr> <td style="text-align: center;"><input type="checkbox"/> 1</td> <td style="text-align: center;"><input type="checkbox"/> 1</td> <td style="border: none;">Incorporated or Principal Place of Business in this State</td> <td style="text-align: center;"><input type="checkbox"/> 4</td> <td style="text-align: center;"><input type="checkbox"/> 4</td> </tr> </table>	PTF	DEF		PTF	DEF	<input type="checkbox"/> 1	<input type="checkbox"/> 1	Incorporated or Principal Place of Business in this State	<input type="checkbox"/> 4	<input type="checkbox"/> 4	Citizen of Another State																		
PTF	DEF		PTF	DEF																										
<input type="checkbox"/> 1	<input type="checkbox"/> 1	Incorporated or Principal Place of Business in this State	<input type="checkbox"/> 4	<input type="checkbox"/> 4																										
	<table style="width:100%; border: none;"> <tr> <td style="text-align: center;"><input type="checkbox"/> 2</td> <td style="text-align: center;"><input type="checkbox"/> 2</td> <td style="border: none;">Incorporated and Principal Place of Business in Another State</td> <td style="text-align: center;"><input type="checkbox"/> 5</td> <td style="text-align: center;"><input type="checkbox"/> 5</td> </tr> </table>	<input type="checkbox"/> 2	<input type="checkbox"/> 2	Incorporated and Principal Place of Business in Another State	<input type="checkbox"/> 5	<input type="checkbox"/> 5	Citizen or Subject of a Foreign Country																							
<input type="checkbox"/> 2	<input type="checkbox"/> 2	Incorporated and Principal Place of Business in Another State	<input type="checkbox"/> 5	<input type="checkbox"/> 5																										
	<table style="width:100%; border: none;"> <tr> <td style="text-align: center;"><input type="checkbox"/> 3</td> <td style="text-align: center;"><input type="checkbox"/> 3</td> <td style="border: none;">Foreign Nation</td> <td style="text-align: center;"><input type="checkbox"/> 6</td> <td style="text-align: center;"><input type="checkbox"/> 6</td> </tr> </table>	<input type="checkbox"/> 3	<input type="checkbox"/> 3	Foreign Nation	<input type="checkbox"/> 6	<input type="checkbox"/> 6																								
<input type="checkbox"/> 3	<input type="checkbox"/> 3	Foreign Nation	<input type="checkbox"/> 6	<input type="checkbox"/> 6																										

IV. ORIGIN (Place an X in one box only.)

☒ 1 Original Proceeding
 ☐ 2 Removed from State Court
 ☐ 3 Remanded from Appellate Court
 ☐ 4 Reinstated or Reopened
 ☐ 5 Transferred from another district (specify):
 ☐ 6 Multi-District Litigation
 ☐ 7 Appeal to District Judge from Magistrate Judge

V. REQUESTED IN COMPLAINT: JURY DEMAND: ☒ Yes ☐ No (Check 'Yes' only if demanded in complaint.)

CLASS ACTION under F.R.C.P. 23: ☐ Yes ☒ No **MONEY DEMANDED IN COMPLAINT: \$** To Be Determined

VI. CAUSE OF ACTION (Cite the U.S. Civil Statute under which you are filing and write a brief statement of cause. Do not cite jurisdictional statutes unless diversity.)

Patent Infringement -- 35 United States Code, Section 271, et seq.

VII. NATURE OF SUIT (Place an X in one box only.)

OTHER STATUTES <input type="checkbox"/> 400 State Reapportionment <input type="checkbox"/> 410 Antitrust <input type="checkbox"/> 430 Banks and Banking <input type="checkbox"/> 450 Commerce/ICC Rates/etc. <input type="checkbox"/> 460 Deportation <input type="checkbox"/> 470 Racketeer Influenced and Corrupt Organizations <input type="checkbox"/> 480 Consumer Credit <input type="checkbox"/> 490 Cable/Sat TV <input type="checkbox"/> 810 Selective Service <input type="checkbox"/> 850 Securities/Commodities /Exchange <input checked="" type="checkbox"/> 875 Customer Challenge 12 USC 3410 <input type="checkbox"/> 891 Agricultural Act <input type="checkbox"/> 892 Economic Stabilization Act <input type="checkbox"/> 893 Environmental Matters <input type="checkbox"/> 894 Energy Allocation Act <input type="checkbox"/> 895 Freedom of Info. Act <input type="checkbox"/> 900 Appeal of Fee Determination Under Equal Access to Justice <input type="checkbox"/> 950 Constitutionality of State Statutes <input type="checkbox"/> 890 Other Statutory Actions	CONTRACT <input type="checkbox"/> 110 Insurance <input type="checkbox"/> 120 Marine <input type="checkbox"/> 130 Miller Act <input type="checkbox"/> 140 Negotiable Instrument <input type="checkbox"/> 150 Recovery of Overpayment & Enforcement of Judgment <input type="checkbox"/> 151 Medicare Act <input type="checkbox"/> 152 Recovery of Defaulted Student Loan (Excl. Veterans) <input type="checkbox"/> 153 Recovery of Overpayment of Veteran's Benefits <input type="checkbox"/> 160 Stockholders' Suits <input type="checkbox"/> 190 Other Contract <input type="checkbox"/> 195 Contract Product Liability <input type="checkbox"/> 196 Franchise REAL PROPERTY <input type="checkbox"/> 210 Land Condemnation <input type="checkbox"/> 220 Foreclosure <input type="checkbox"/> 230 Rent Lease & Ejectment <input type="checkbox"/> 240 Torts to Land <input type="checkbox"/> 245 Tort Product Liability <input type="checkbox"/> 290 All Other Real Property	TORTS PERSONAL INJURY <input type="checkbox"/> 310 Airplane <input type="checkbox"/> 315 Airplane Product Liability <input type="checkbox"/> 320 Assault, Libel & Slander <input type="checkbox"/> 330 Fed. Employers' Liability <input type="checkbox"/> 340 Marine <input type="checkbox"/> 345 Marine Product Liability <input type="checkbox"/> 350 Motor Vehicle <input type="checkbox"/> 355 Motor Vehicle Product Liability <input type="checkbox"/> 360 Other Personal Injury <input type="checkbox"/> 362 Personal Injury-Med Malpractice <input type="checkbox"/> 365 Personal Injury-Product Liability <input type="checkbox"/> 368 Asbestos Personal Injury Product Liability	TORTS PERSONAL PROPERTY <input type="checkbox"/> 370 Other Fraud <input type="checkbox"/> 371 Truth in Lending <input type="checkbox"/> 380 Other Personal Property Damage <input type="checkbox"/> 385 Property Damage Product Liability BANKRUPTCY <input type="checkbox"/> 422 Appeal 28 USC 158 <input type="checkbox"/> 423 Withdrawal 28 USC 157 CIVIL RIGHTS <input type="checkbox"/> 441 Voting <input type="checkbox"/> 442 Employment <input type="checkbox"/> 443 Housing/Accommodations <input type="checkbox"/> 444 Welfare <input type="checkbox"/> 445 American with Disabilities - Employment <input type="checkbox"/> 446 American with Disabilities - Other <input type="checkbox"/> 440 Other Civil Rights	PRISONER PETITIONS <input type="checkbox"/> 510 Motions to Vacate Sentence Habeas Corpus <input type="checkbox"/> 530 General <input type="checkbox"/> 535 Death Penalty <input type="checkbox"/> 540 Mandamus/Other <input type="checkbox"/> 550 Civil Rights <input type="checkbox"/> 555 Prison Condition FORFEITURE/PENALTY <input type="checkbox"/> 610 Agriculture <input type="checkbox"/> 620 Other Food & Drug <input type="checkbox"/> 625 Drug Related Seizure of Property 21 USC 881 <input type="checkbox"/> 630 Liquor Laws <input type="checkbox"/> 640 R.R. & Truck <input type="checkbox"/> 650 Airline Regs <input type="checkbox"/> 660 Occupational Safety /Health <input type="checkbox"/> 690 Other	LABOR <input type="checkbox"/> 710 Fair Labor Standards Act <input type="checkbox"/> 720 Labor/Mgmt. Relations <input type="checkbox"/> 730 Labor/Mgmt. Reporting & Disclosure Act <input type="checkbox"/> 740 Railway Labor Act <input type="checkbox"/> 790 Other Labor Litigation <input type="checkbox"/> 791 Empl. Ret. Inc. Security Act PROPERTY RIGHTS <input type="checkbox"/> 820 Copyrights <input checked="" type="checkbox"/> 830 Patent <input type="checkbox"/> 840 Trademark SOCIAL SECURITY <input type="checkbox"/> 861 HIA (1395ff) <input type="checkbox"/> 862 Black Lung (923) <input type="checkbox"/> 863 DIWC/DIWW (405(g)) <input type="checkbox"/> 864 SSID Title XVI <input type="checkbox"/> 865 RSI (405(g)) FEDERAL TAX SUITS <input type="checkbox"/> 870 Taxes (U.S. Plaintiff or Defendant) <input type="checkbox"/> 871 IRS-Third Party 26 USC 7609
---	--	--	---	--	--

VIII(a). IDENTICAL CASES: Has this action been previously filed and dismissed, remanded or closed? ☒ No ☐ Yes

If yes, list case number(s):

FOR OFFICE USE ONLY: Case Number:

AFTER COMPLETING THE FRONT SIDE OF FORM JS-44C, COMPLETE THE INFORMATION REQUESTED BELOW.

VIII(b). RELATED CASES: Have any cases been previously filed that are related to the present case? ☐ No ☒ Yes

If yes, list case number(s): See Notice Of Related Cases

CV 03-882 R (SGLX)

Civil cases are deemed related if a previously filed case and the present case:

- (Check all boxes that apply) ☐ A. Appear to arise from the same or substantially identical transactions, happenings, or events;
☒ B. Involve the same or substantially the same parties or property;
☐ C. Involve the same patent, trademark or copyright;
☐ D. Call for determination of the same or substantially identical questions of law, or
☐ E. Likely for other reasons may entail unnecessary duplication of labor if heard by different judges.

IX. VENUE: List the California County, or State if other than California, in which EACH named plaintiff resides (Use an additional sheet if necessary)
☐ Check here if the U.S. government, its agencies or employees is a named plaintiff.

San Bernardino

List the California County, or State if other than California, in which EACH named defendant resides. (Use an additional sheet if necessary).
☐ Check here if the U.S. government, its agencies or employees is a named defendant.

Los Angeles

List the California County, or State if other than California, in which EACH claim arose. (Use an additional sheet if necessary)
Note: In land condemnation cases, use the location of the tract of land involved.

Los Angeles

X. SIGNATURE OF ATTORNEY (OR PRO PER):

Charles O. Kett

Date March 18, 2009

Notice to Counsel/Parties: The CV-71 (JS-44) Civil Cover Sheet and the information contained herein neither replace nor supplement the filing and service of pleadings or other papers as required by law. This form, approved by the Judicial Conference of the United States in September 1974, is required pursuant to Local Rule 3-1 is not filed but is used by the Clerk of the Court for the purpose of statistics, venue and initiating the civil docket sheet. (For more detailed instructions, see separate instructions sheet.)

Key to Statistical codes relating to Social Security Cases:

Nature of Suit Code	Abbreviation	Substantive Statement of Cause of Action
861	HIA	All claims for health insurance benefits (Medicare) under Title 18, Part A, of the Social Security Act, as amended. Also, include claims by hospitals, skilled nursing facilities, etc., for certification as providers of services under the program. (42 U.S.C. 1935FF(b))
862	BL	All claims for "Black Lung" benefits under Title 4, Part B, of the Federal Coal Mine Health and Safety Act of 1969. (30 U.S.C. 923)
863	DIWC	All claims filed by insured workers for disability insurance benefits under Title 2 of the Social Security Act, as amended; plus all claims filed for child's insurance benefits based on disability. (42 U.S.C. 405(g))
863	DIWW	All claims filed for widows or widowers insurance benefits based on disability under Title 2 of the Social Security Act, as amended. (42 U.S.C. 405(g))
864	SSID	All claims for supplemental security income payments based upon disability filed under Title 16 of the Social Security Act, as amended.
865	RSI	All claims for retirement (old age) and survivors benefits under Title 2 of the Social Security Act, as amended. (42 U.S.C. (g))