

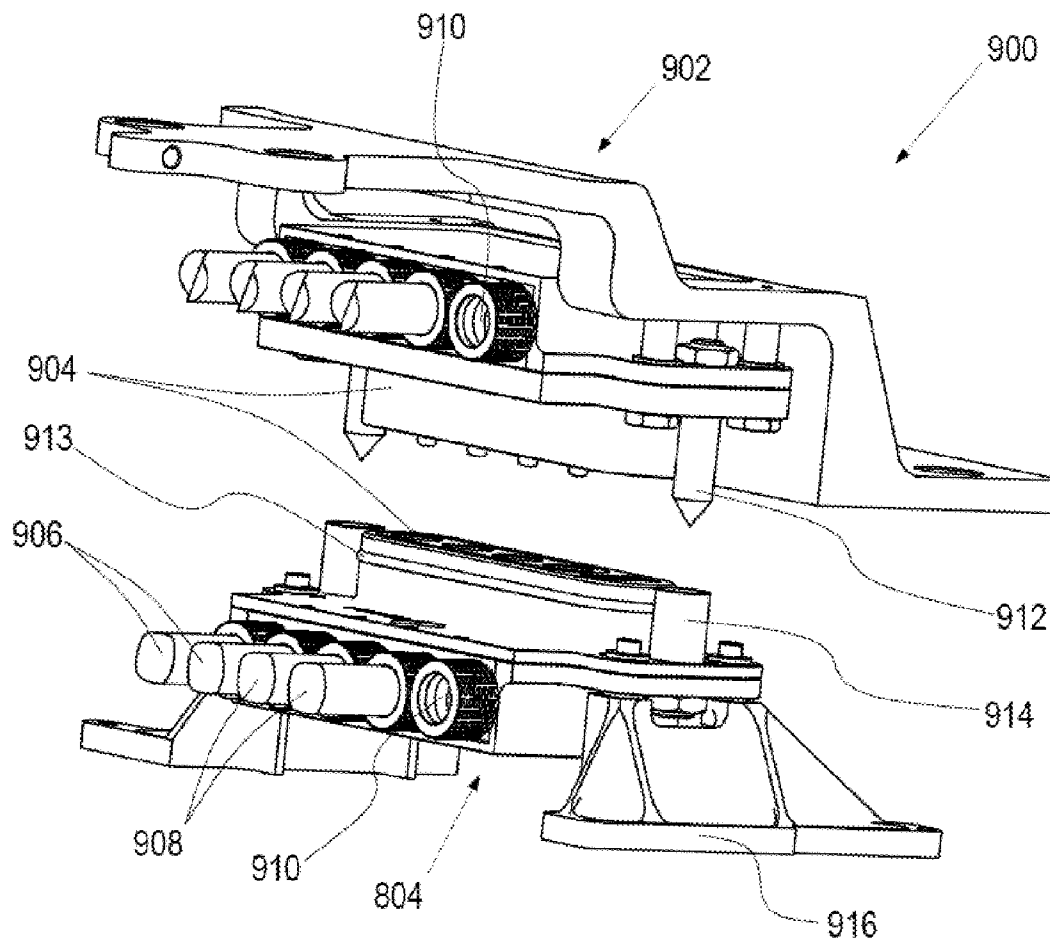

US 20100112843A1

(19) **United States**(12) **Patent Application Publication**
Heichal et al.(10) **Pub. No.: US 2010/0112843 A1**(43) **Pub. Date: May 6, 2010**(54) **SYSTEM FOR ELECTRICALLY
CONNECTING BATTERIES TO ELECTRIC
VEHICLES**61/206,913, filed on Feb. 4, 2009, provisional applica-
tion No. 61/166,239, filed on Apr. 2, 2009.(76) Inventors: **Yoav Heichal**, Ganey Yehuda (IL);
Tal Agassi, Hod Hasaron (IL); **Shai**
Agassi, Palo Alto, CA (US)Correspondence Address:
MORGAN, LEWIS & BOCKIUS, LLP. (PA)
2 PALO ALTO SQUARE, 3000 EL CAMINO
REAL, SUITE 700
PALO ALTO, CA 94306 (US)(21) Appl. No.: **12/563,107**(22) Filed: **Sep. 18, 2009****Related U.S. Application Data**(63) Continuation-in-part of application No. 12/428,932,
filed on Apr. 23, 2009.(60) Provisional application No. 61/098,724, filed on Sep.
19, 2008, provisional application No. 61/149,690,
filed on Feb. 3, 2009, provisional application No.**Publication Classification**(51) **Int. Cl.**
H01R 13/62 (2006.01)(52) **U.S. Cl.** **439/299**(57) **ABSTRACT**

The connection system is designed to facilitate electrical and data connections between the battery and the electric vehicle. The connectors are designed with alignment mechanisms to account for initial misalignment of the battery and vehicle while still ensuring positive contact between them. The alignment mechanisms also introduce compliance into the system to ensure that the mechanical components of the system are not placed under unwanted loads or stresses. The connection system houses data connectors carrying communication signals as well as power connectors carrying high voltage electricity. The data connectors are shielded to prevent interference caused by proximity to the high voltage elements. The connection system uses no mechanical latching or locking mechanisms.



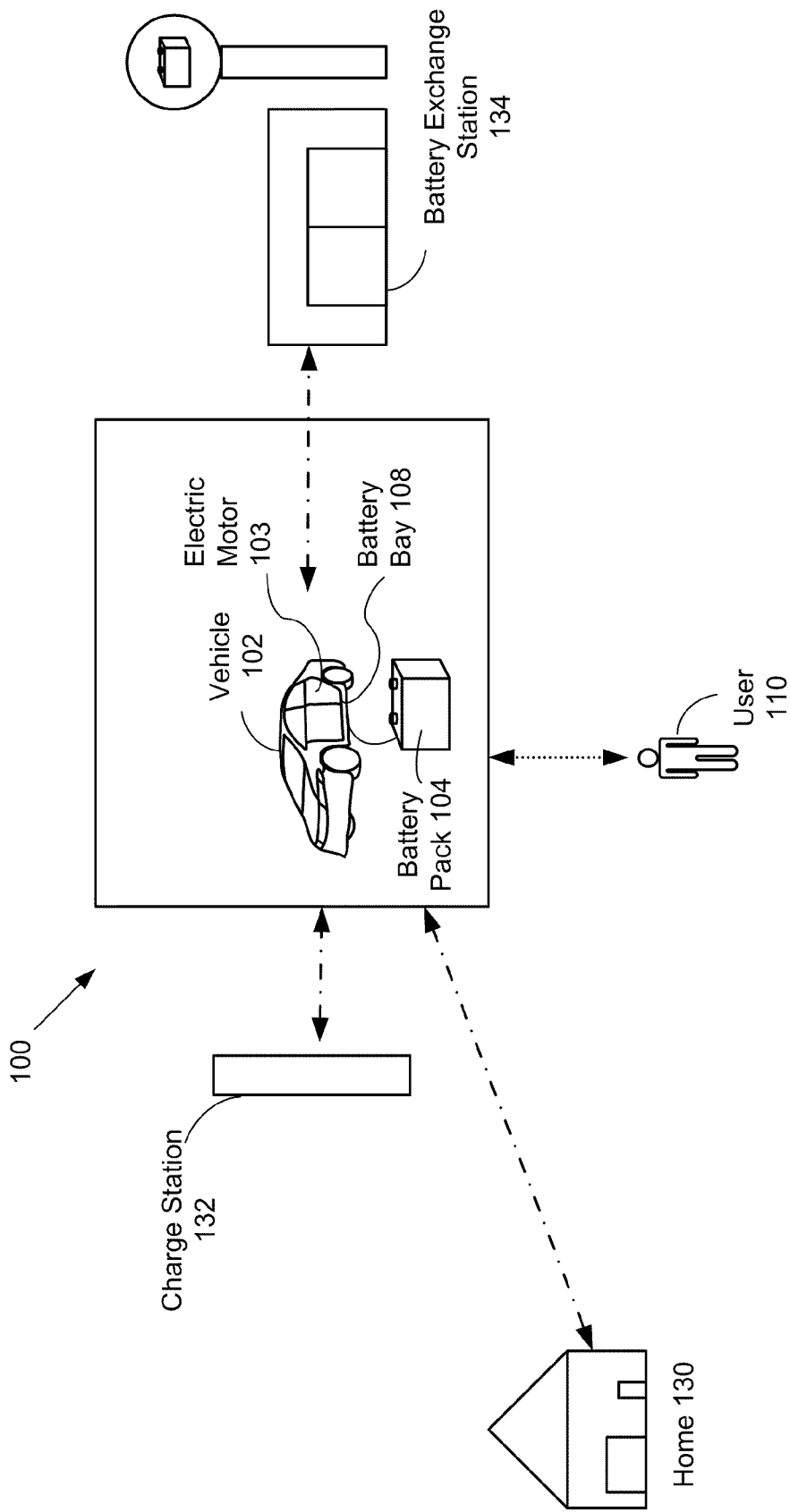

FIG. 1

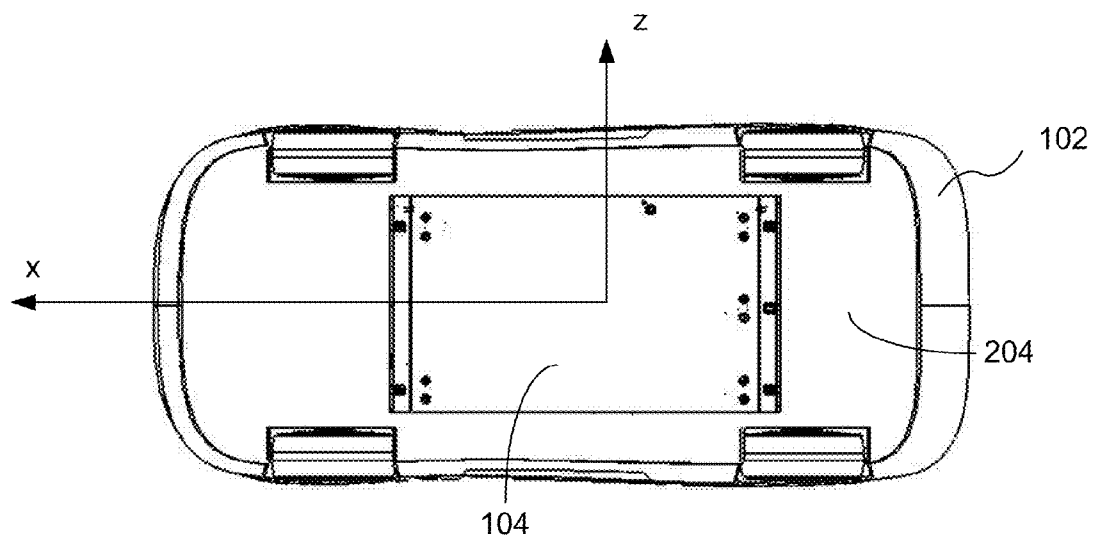

FIG. 2A

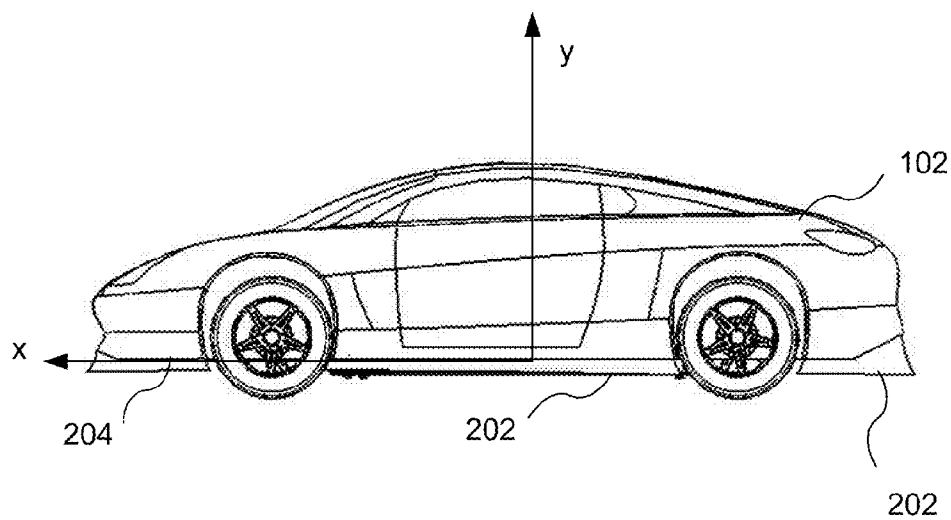

FIG. 2B

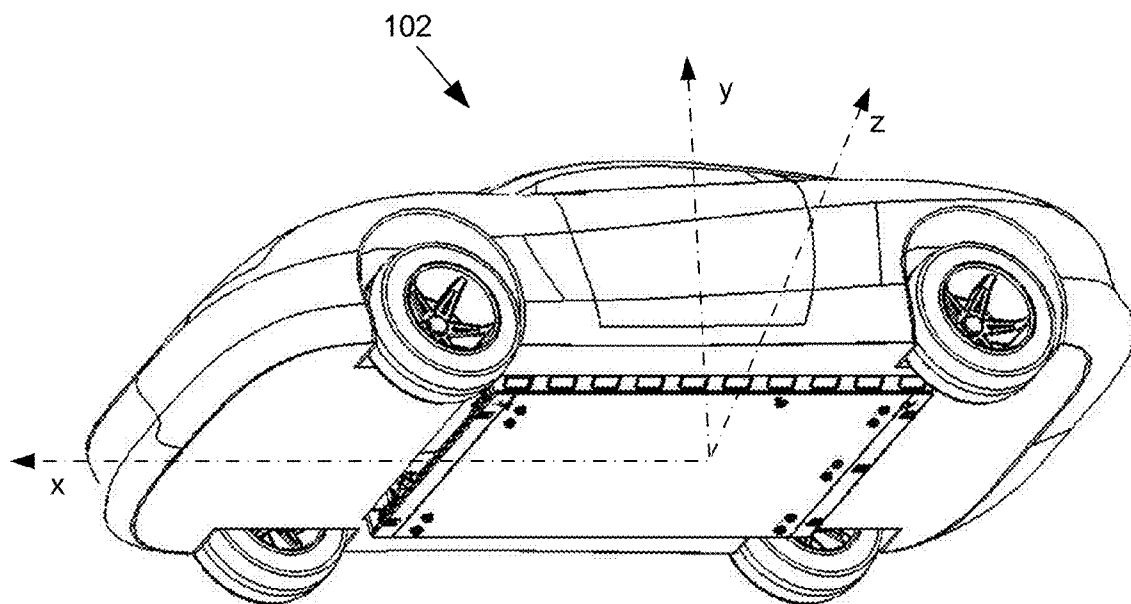

FIG. 3A

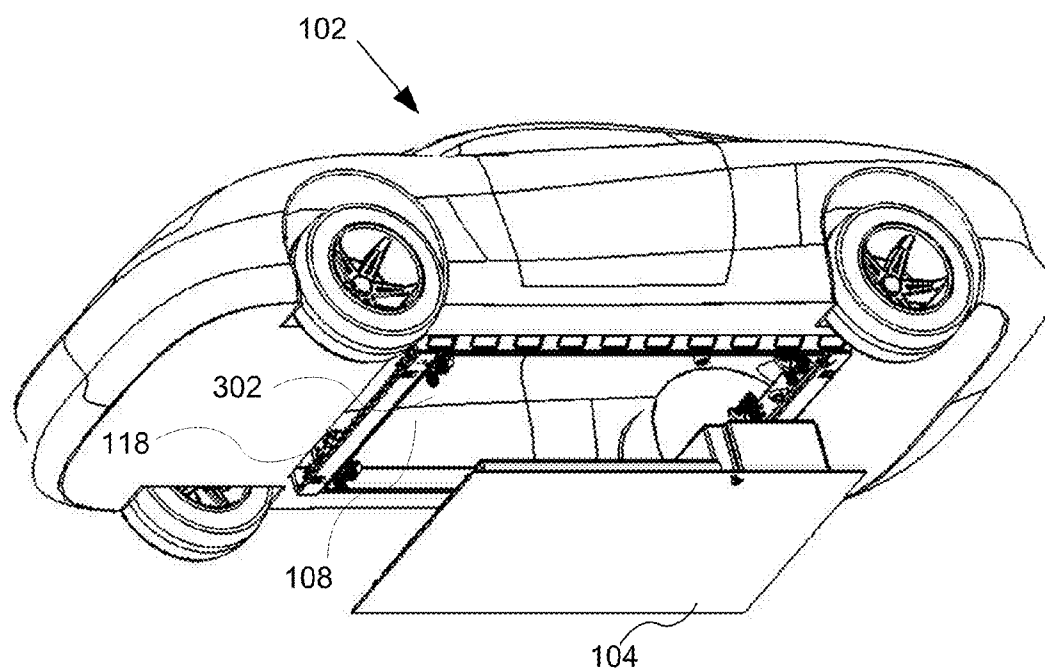

FIG. 3B

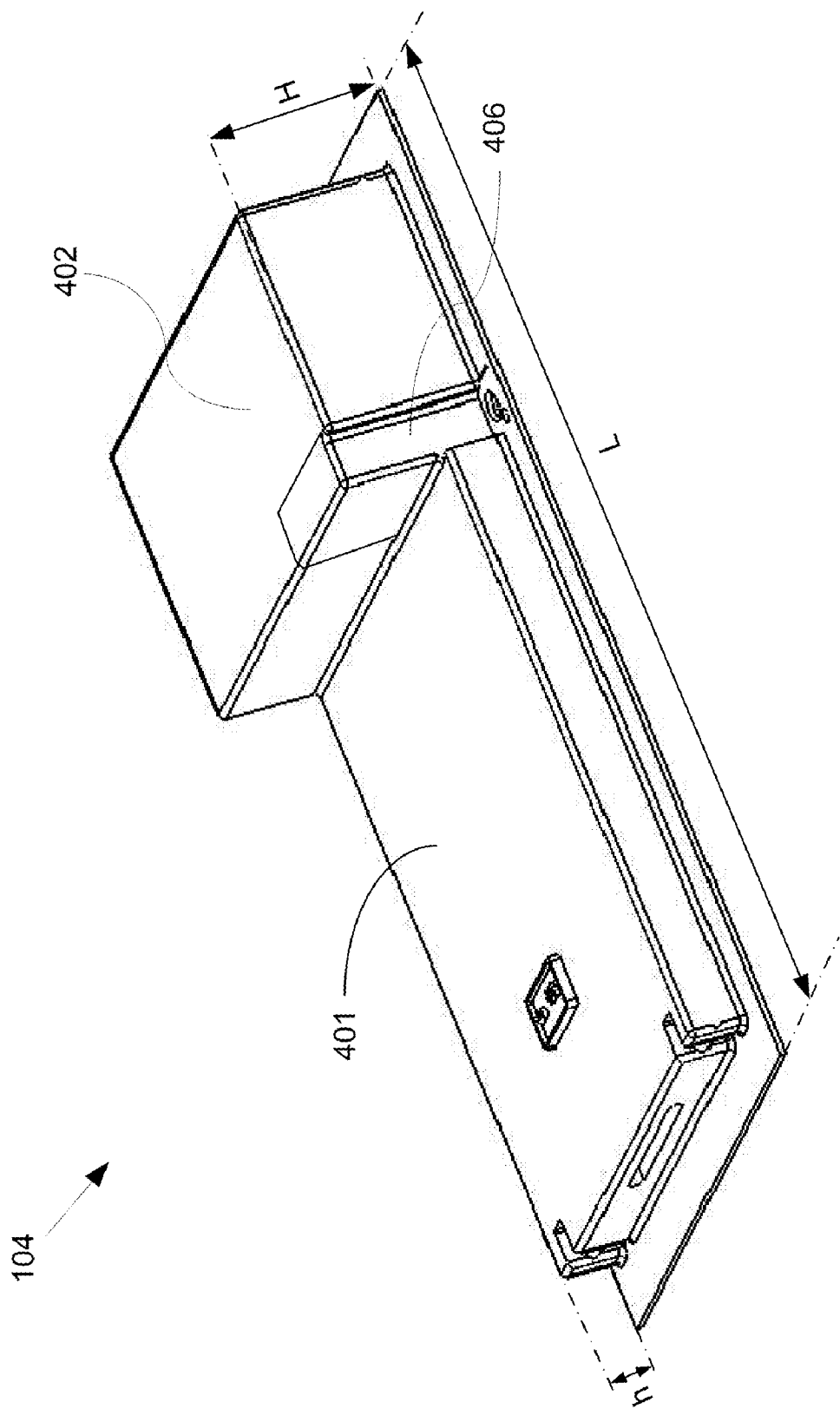

FIG. 4

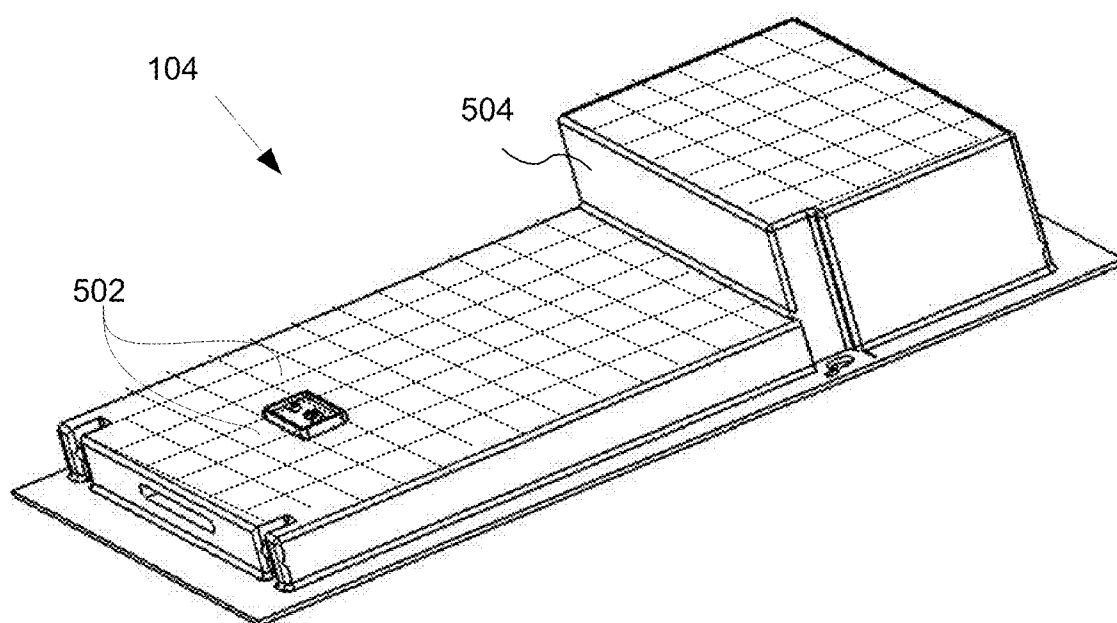

FIG. 5

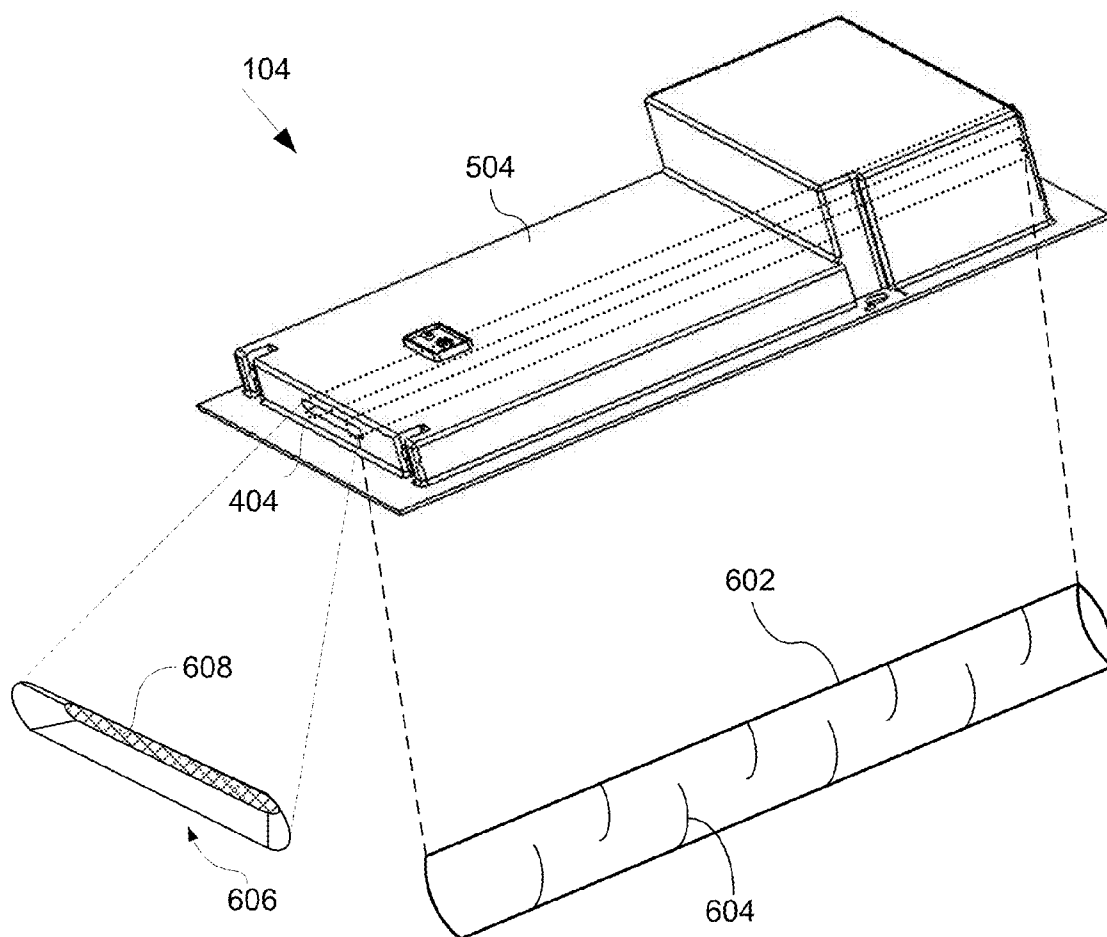

FIG. 6

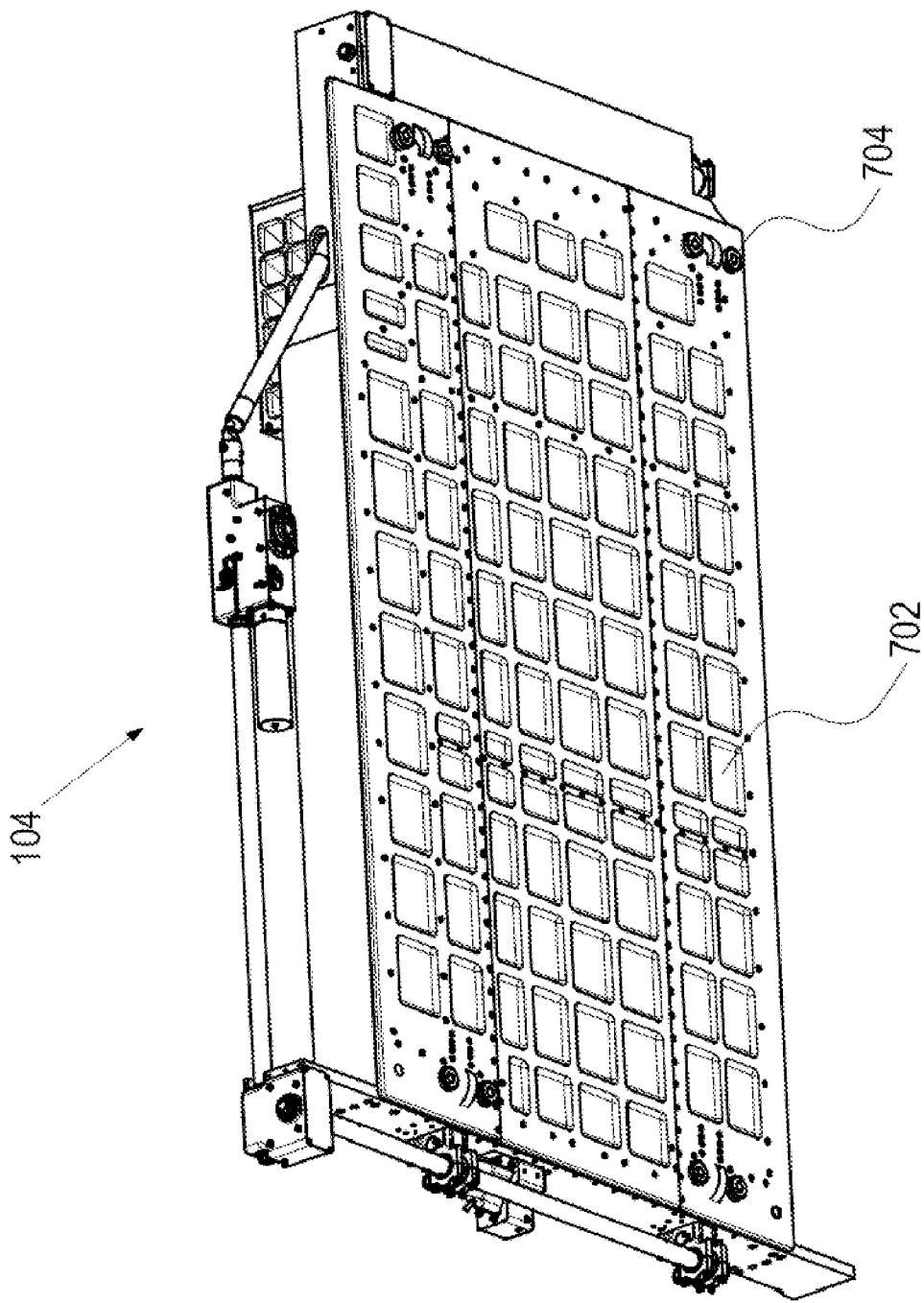

FIG. 7

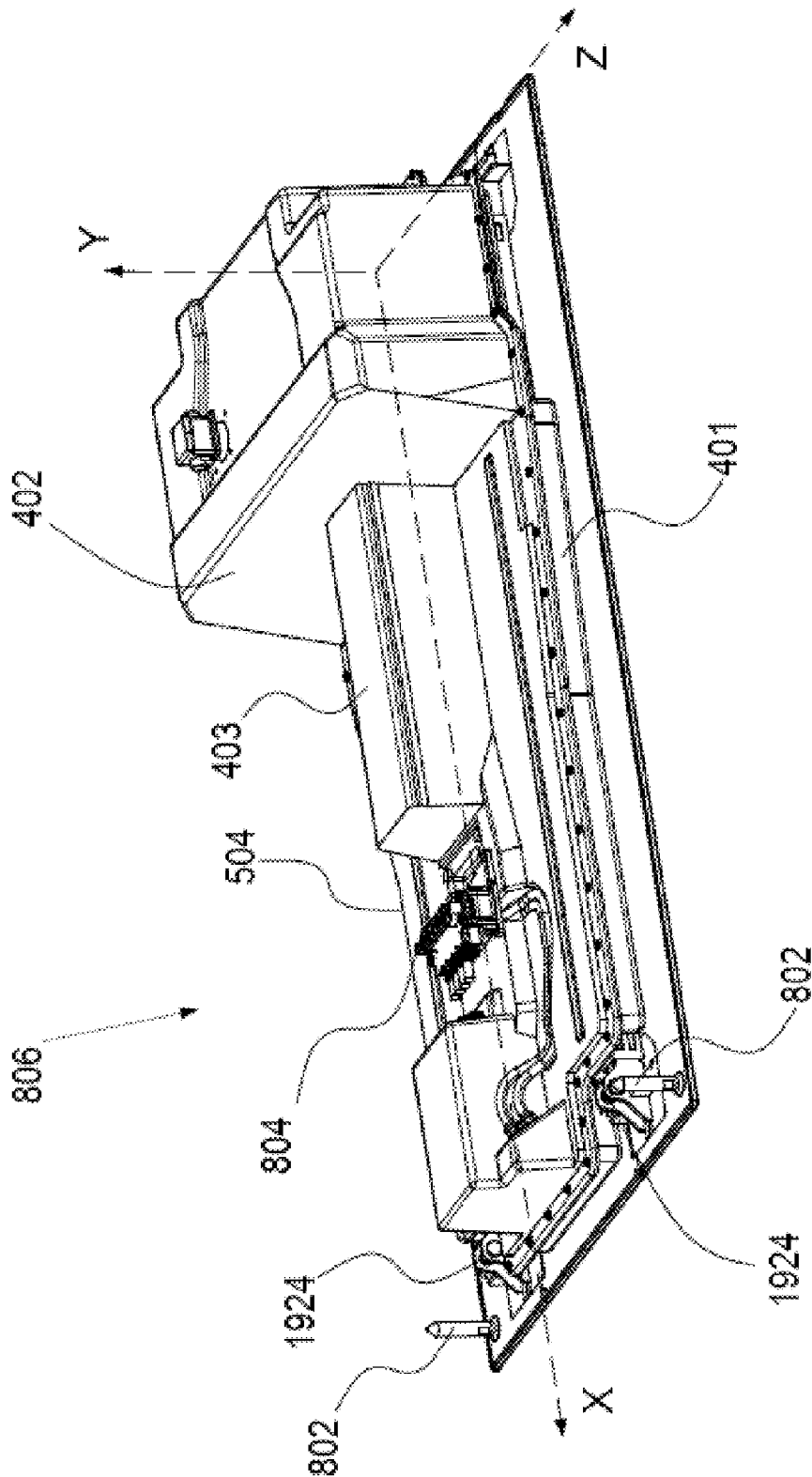

FIG. 8

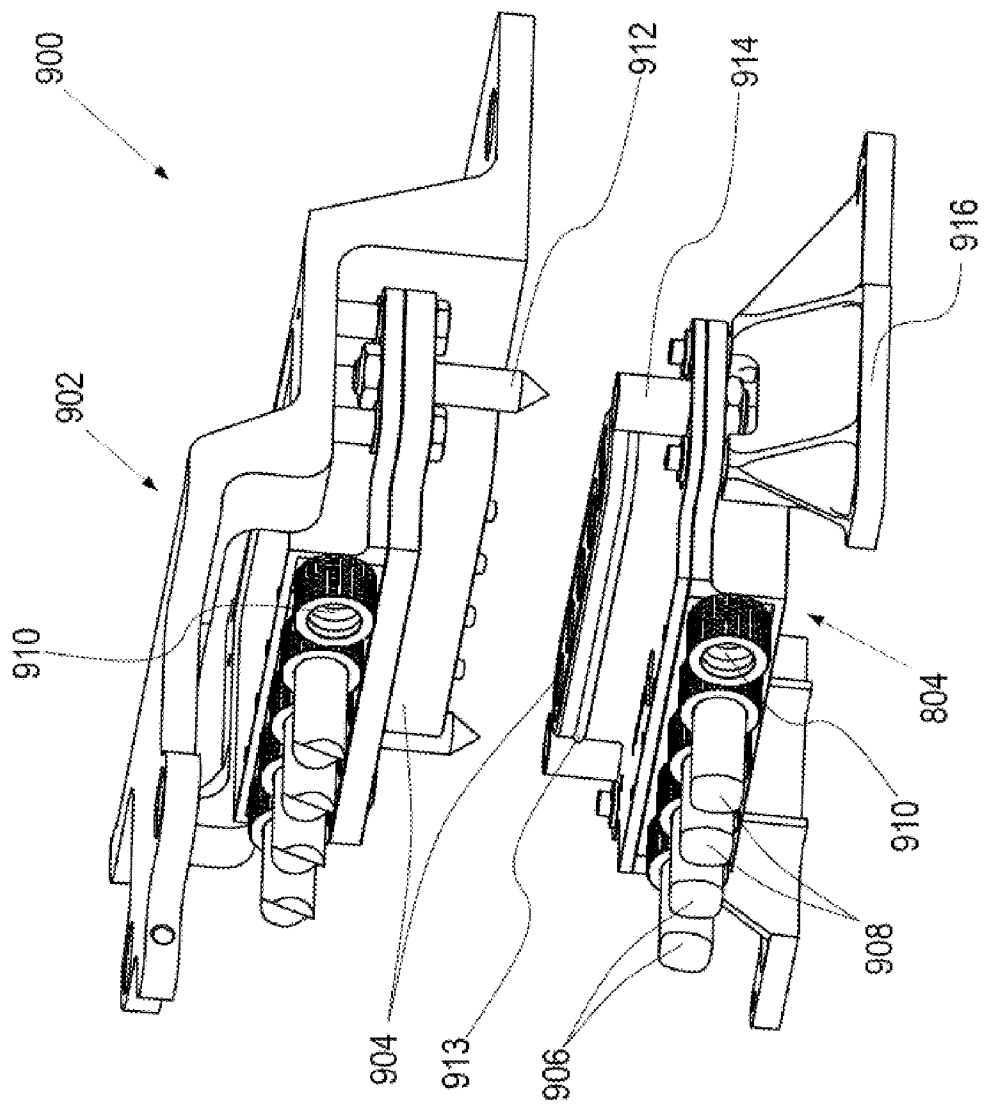

FIG. 9

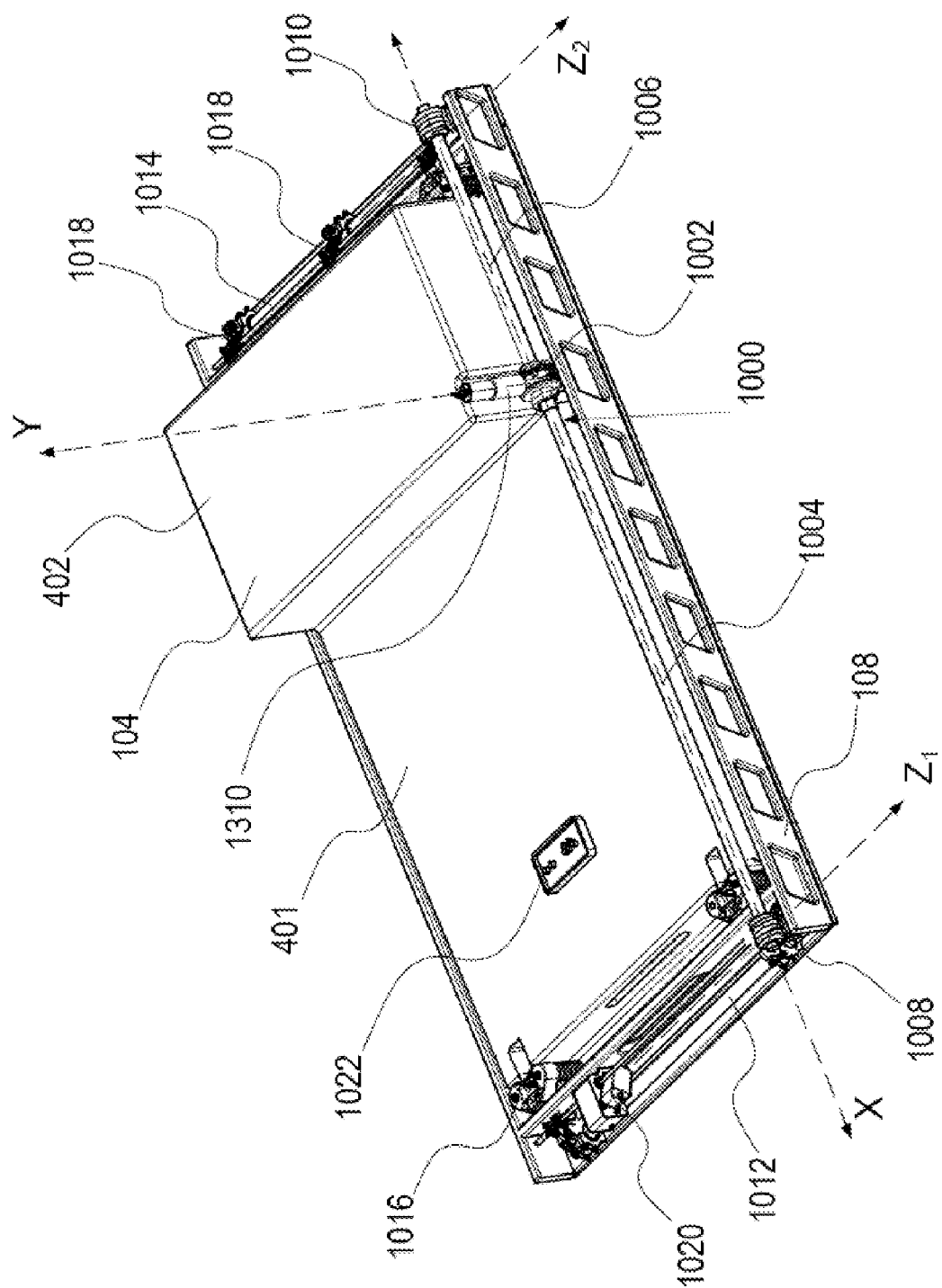

FIG. 10

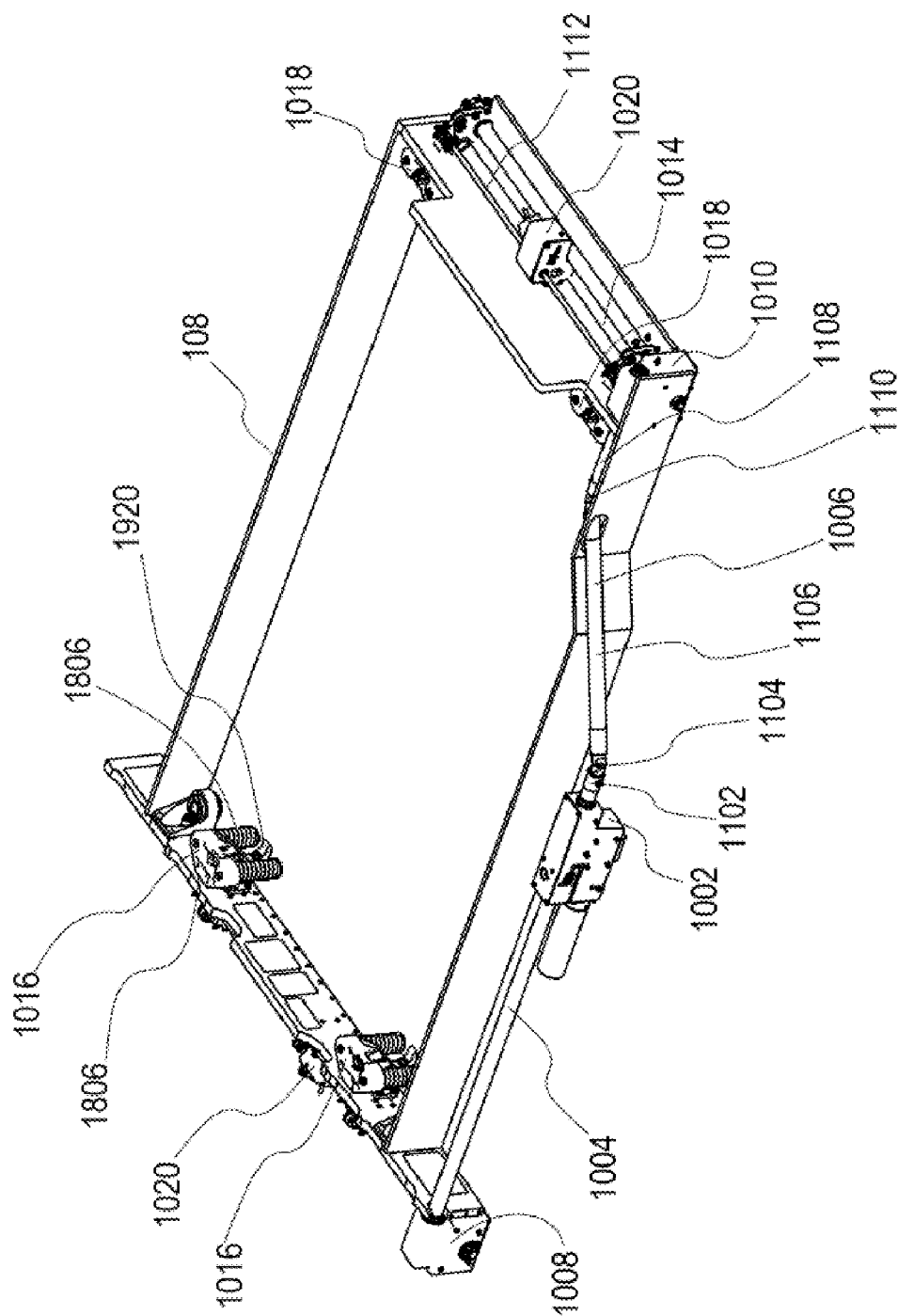

FIG. 11

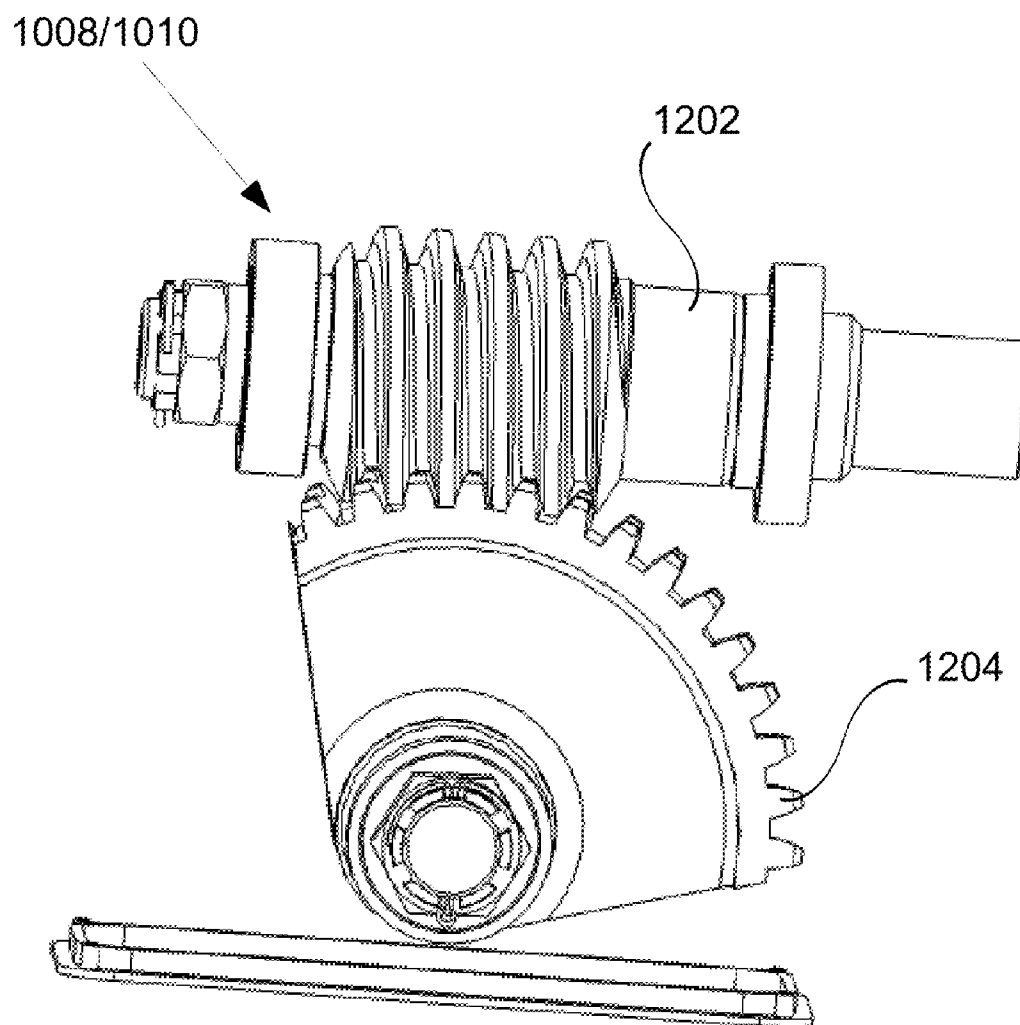

FIG. 12

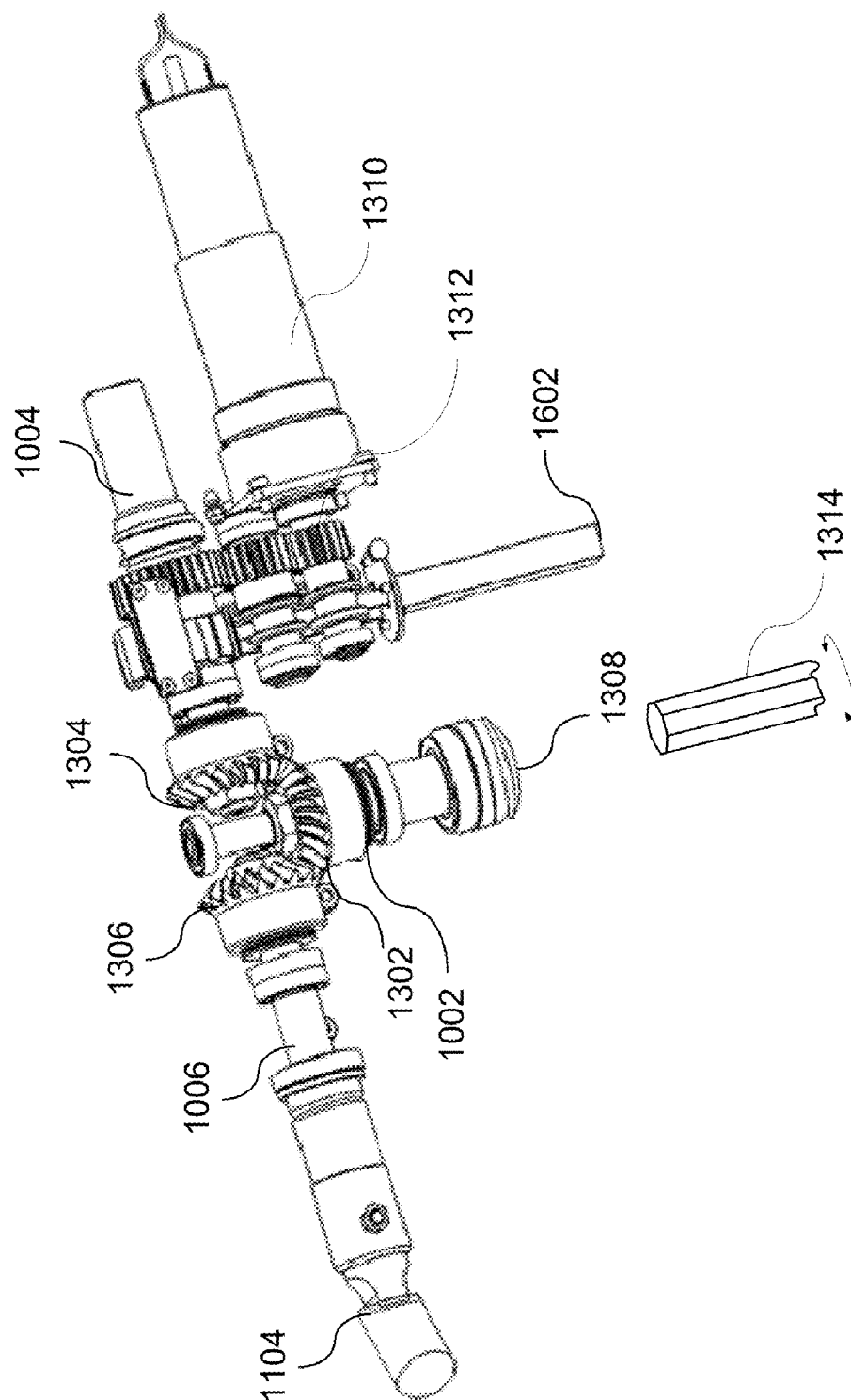

FIG. 13

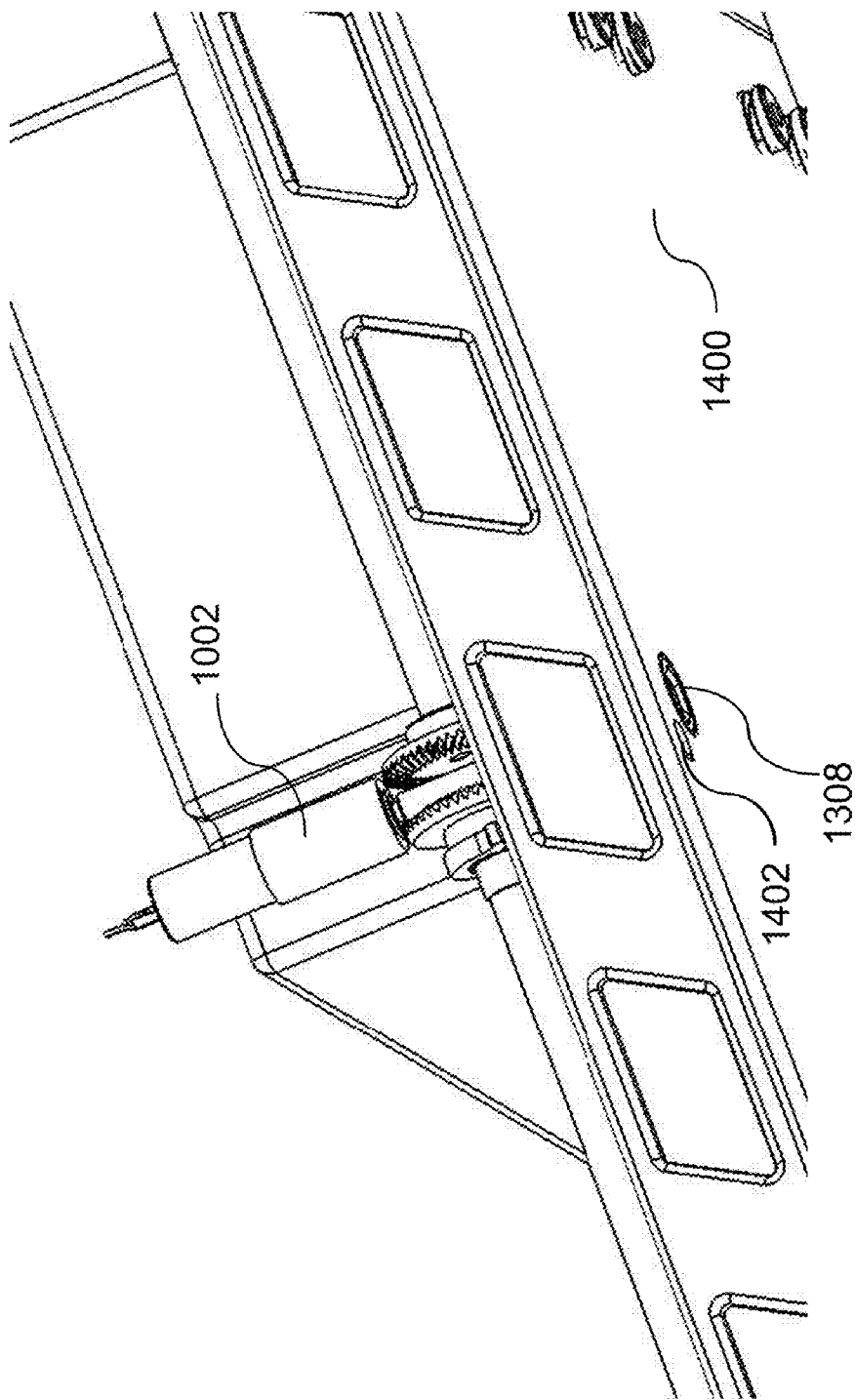

FIG. 14

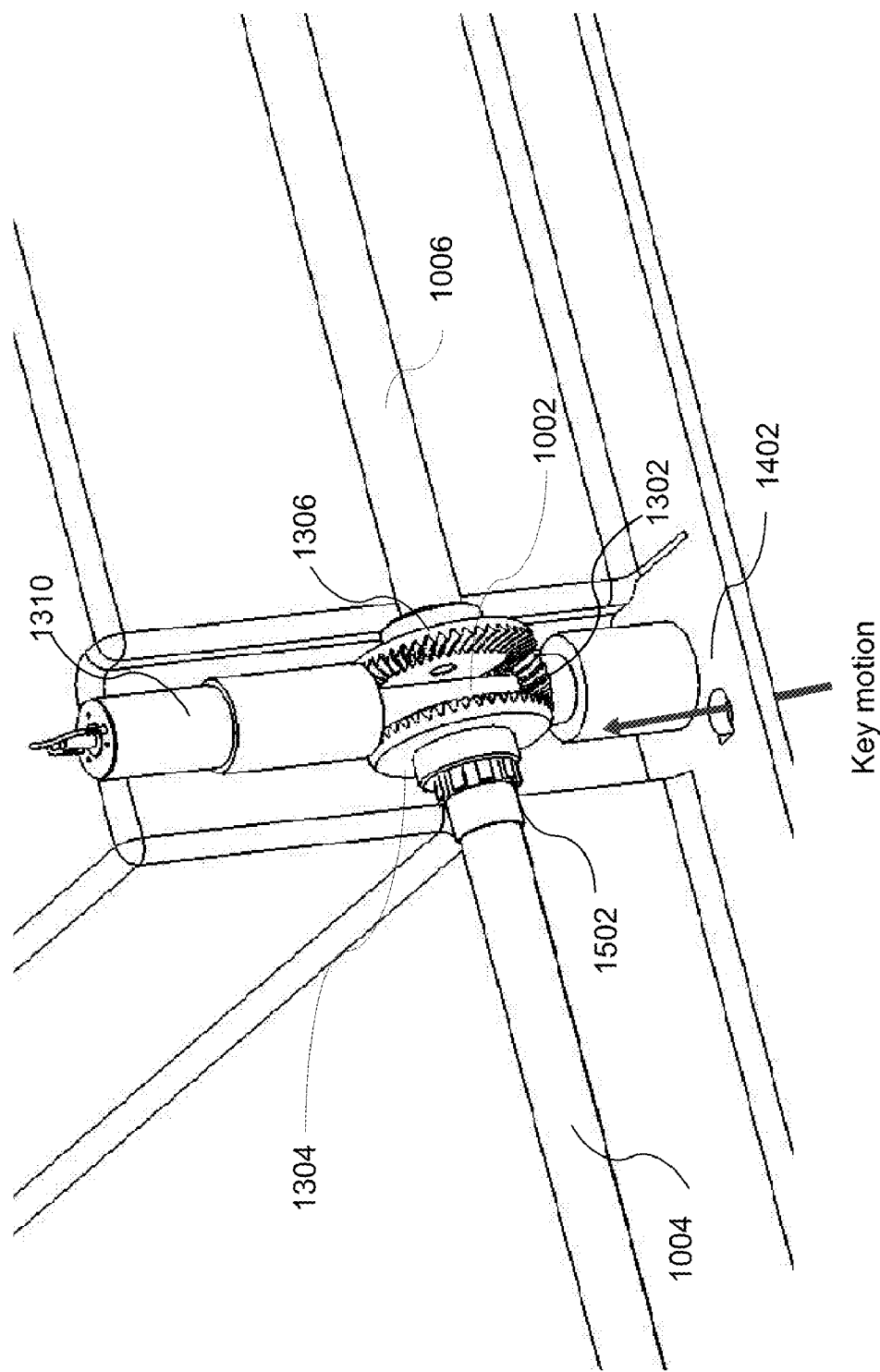

FIG. 15

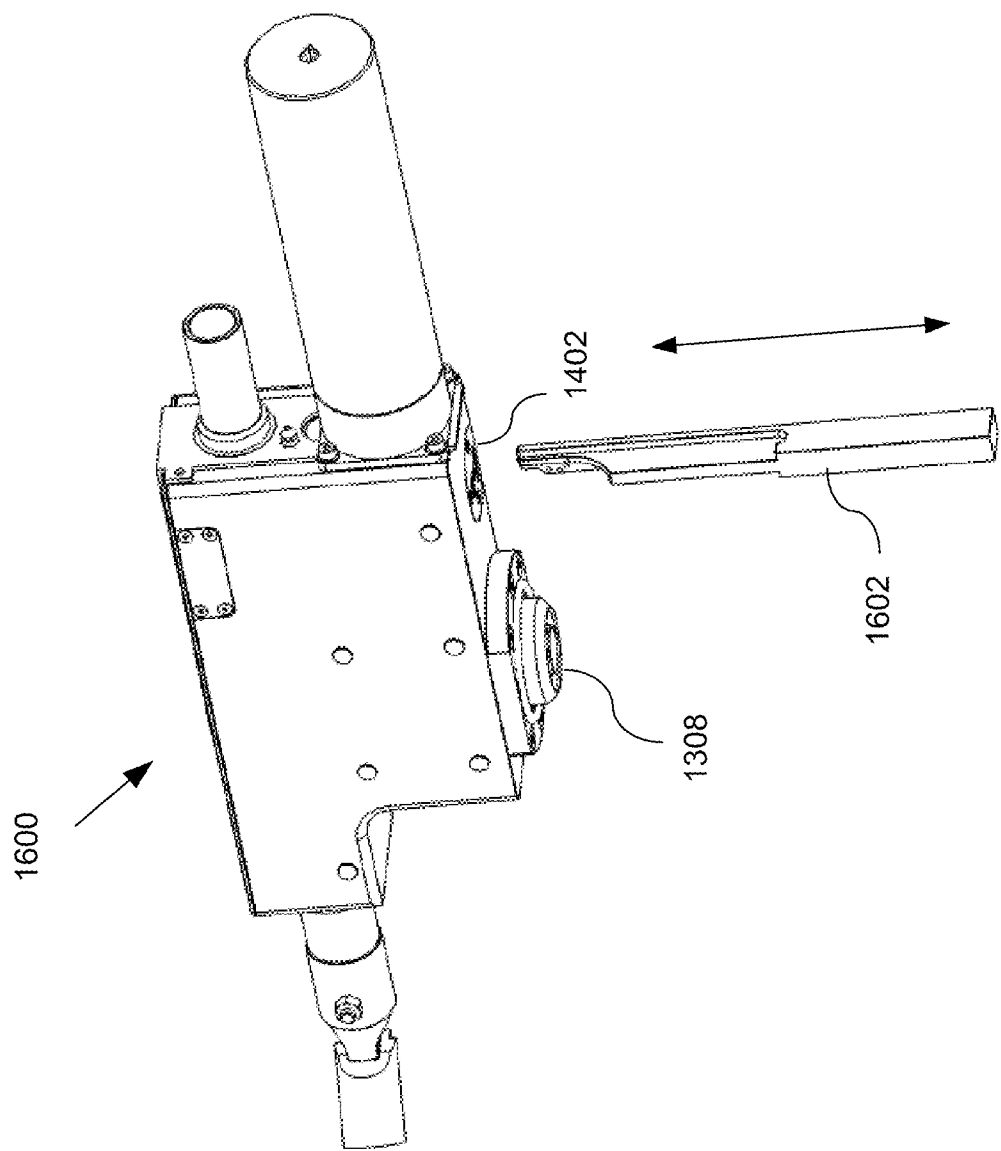

FIG. 16

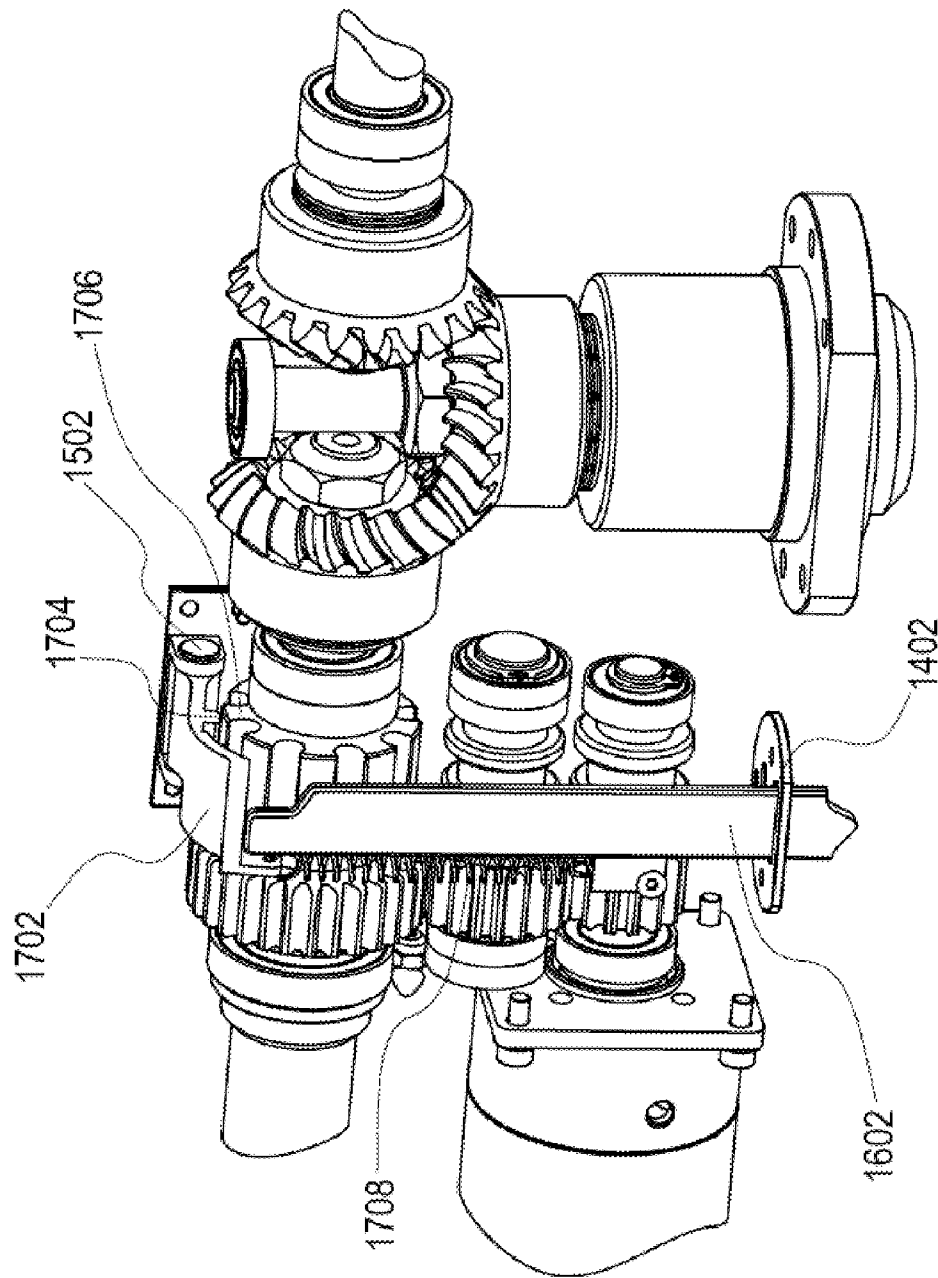

FIG. 17

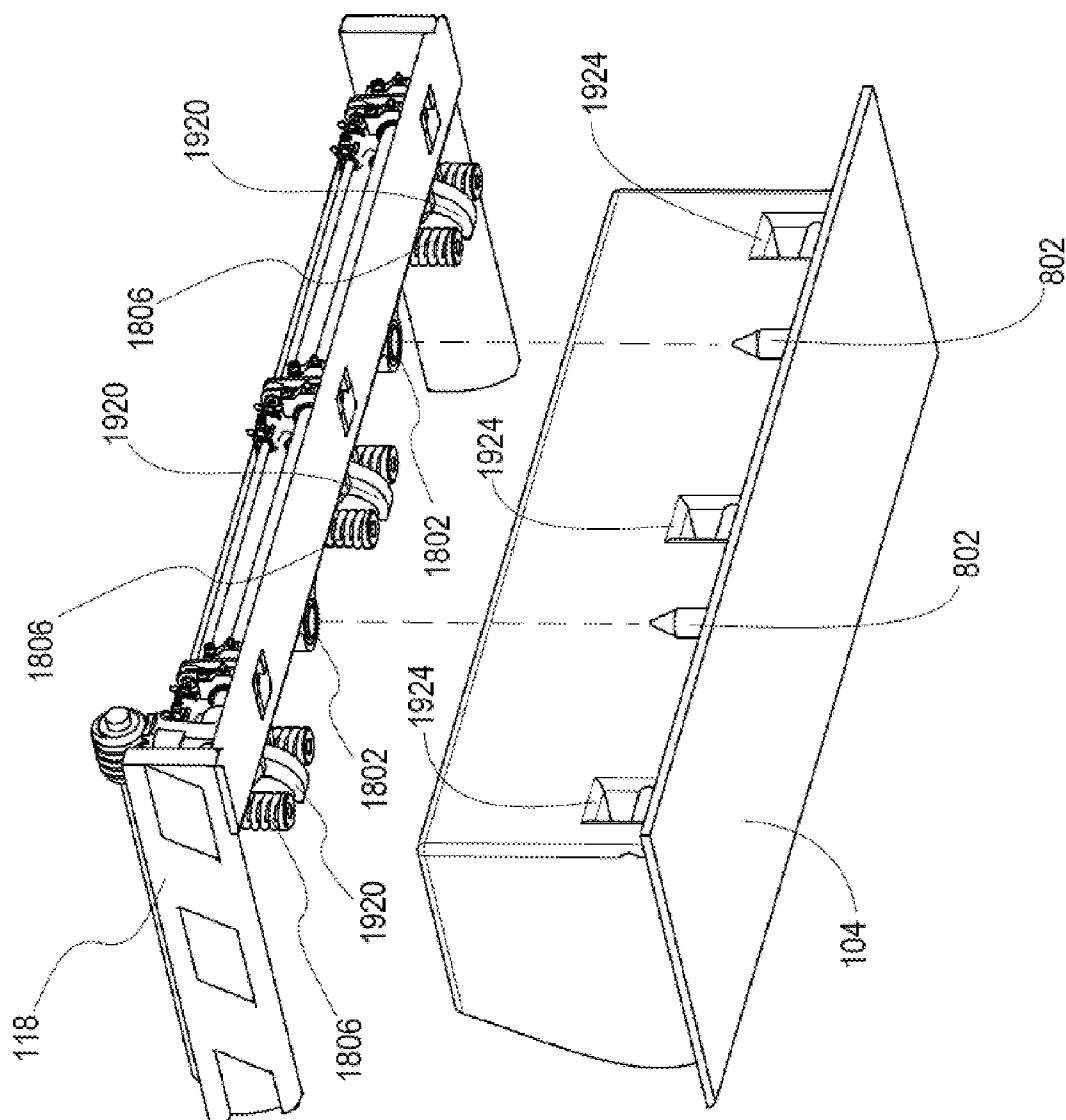

FIG. 18

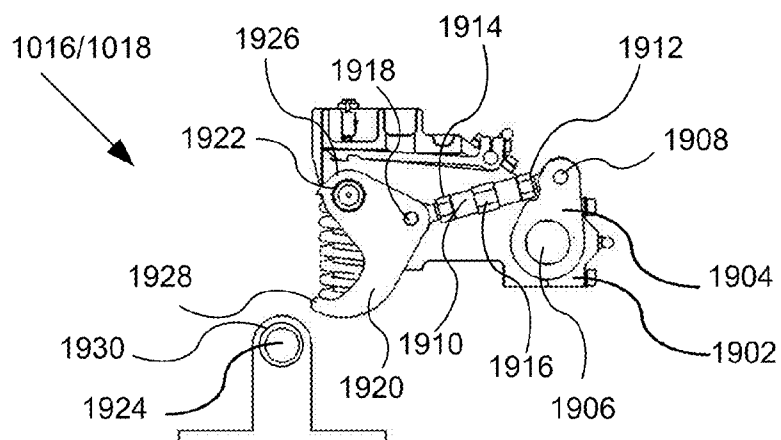
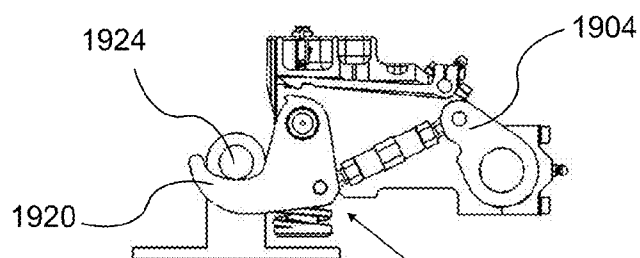
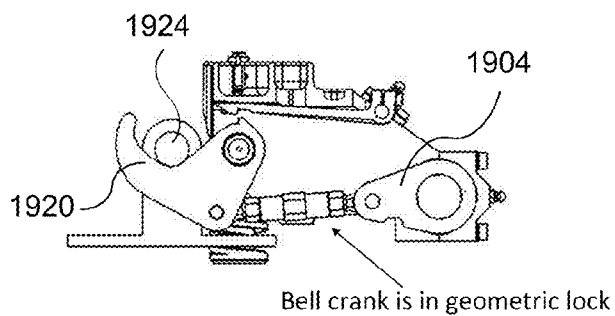

FIG. 19A



Latch grips the striker on the battery pack and pulls it up

FIG. 19B



Bell crank is in geometric lock

FIG. 19C

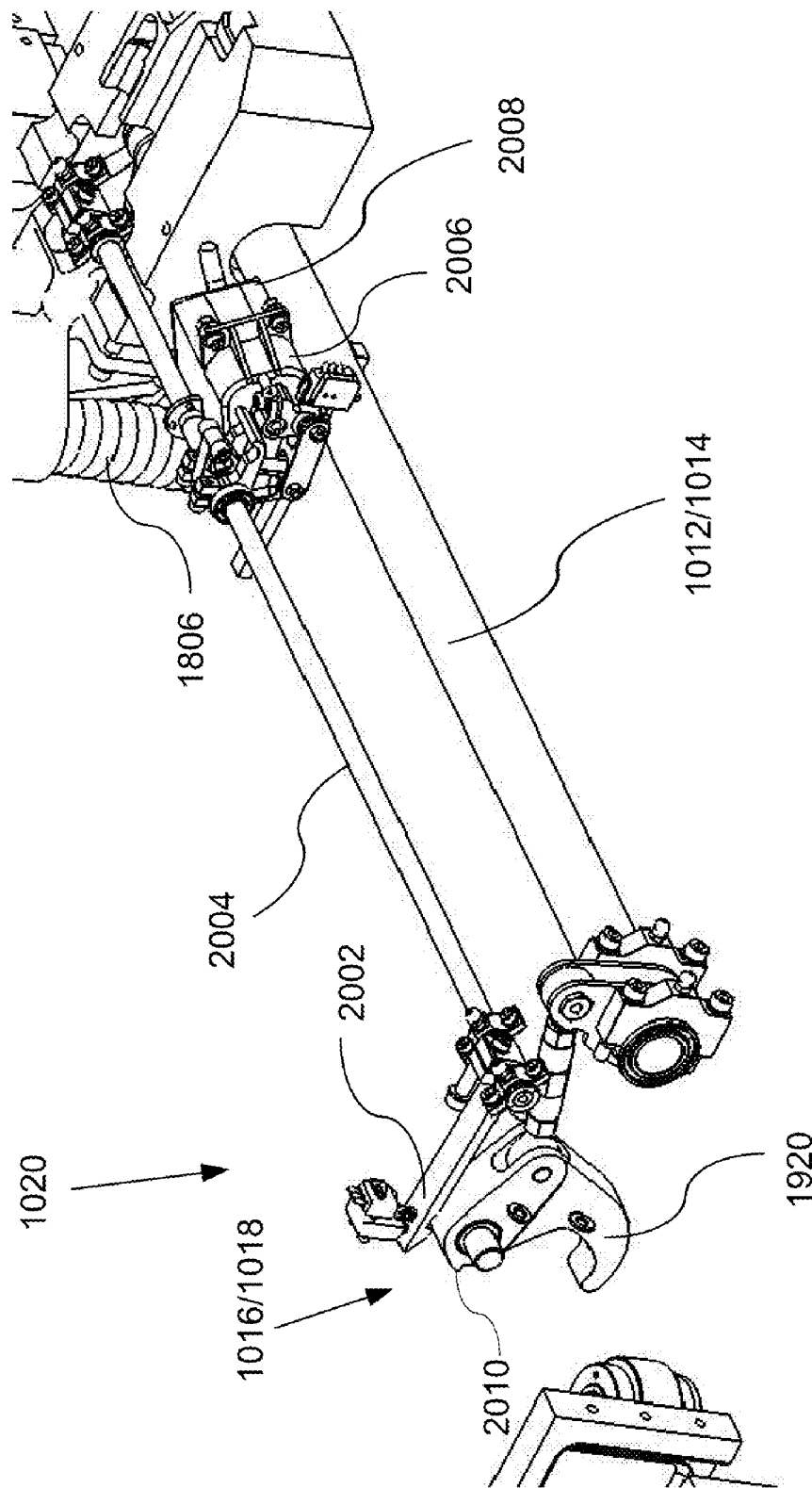
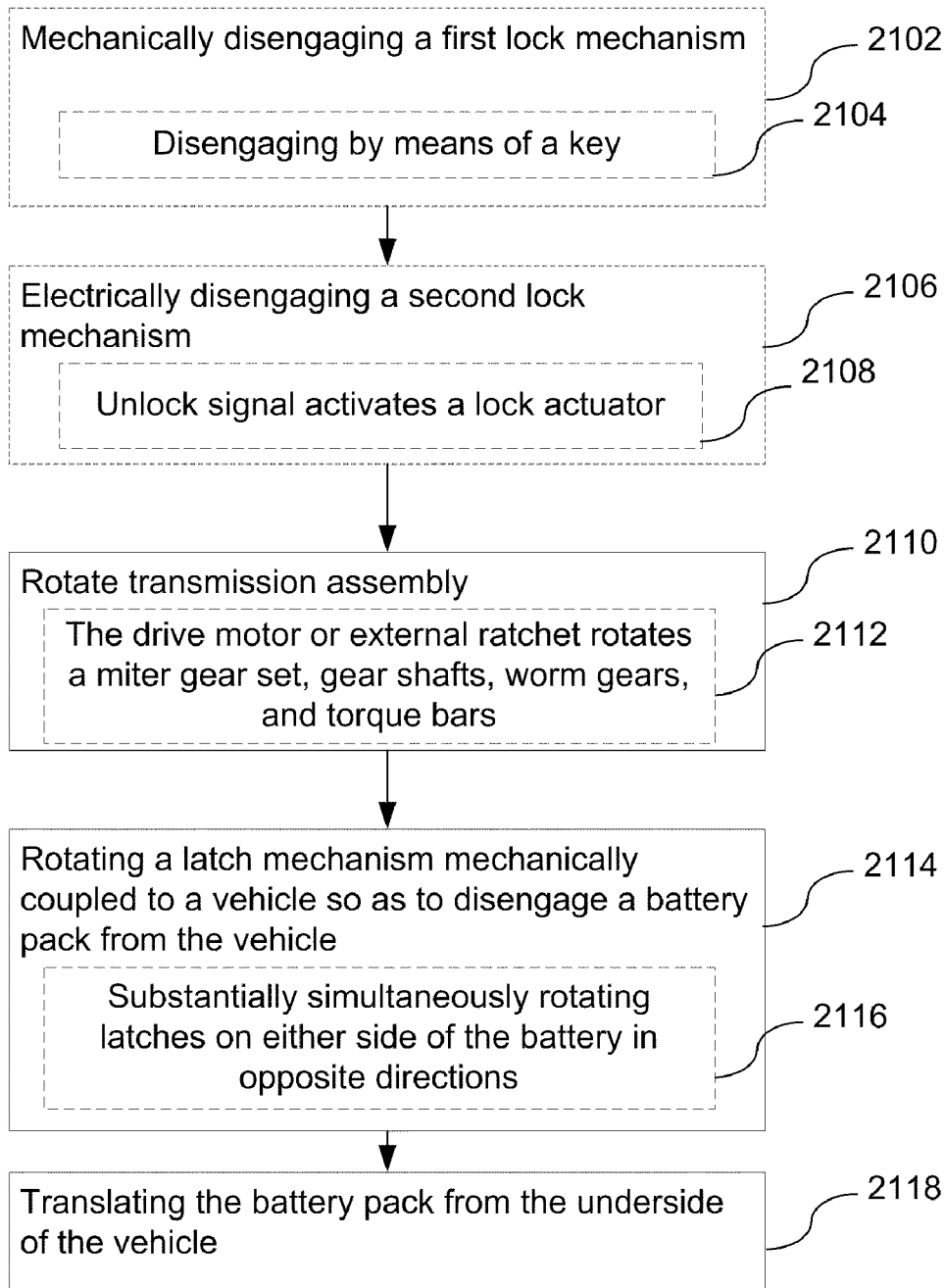

FIG. 20

**FIG. 21**

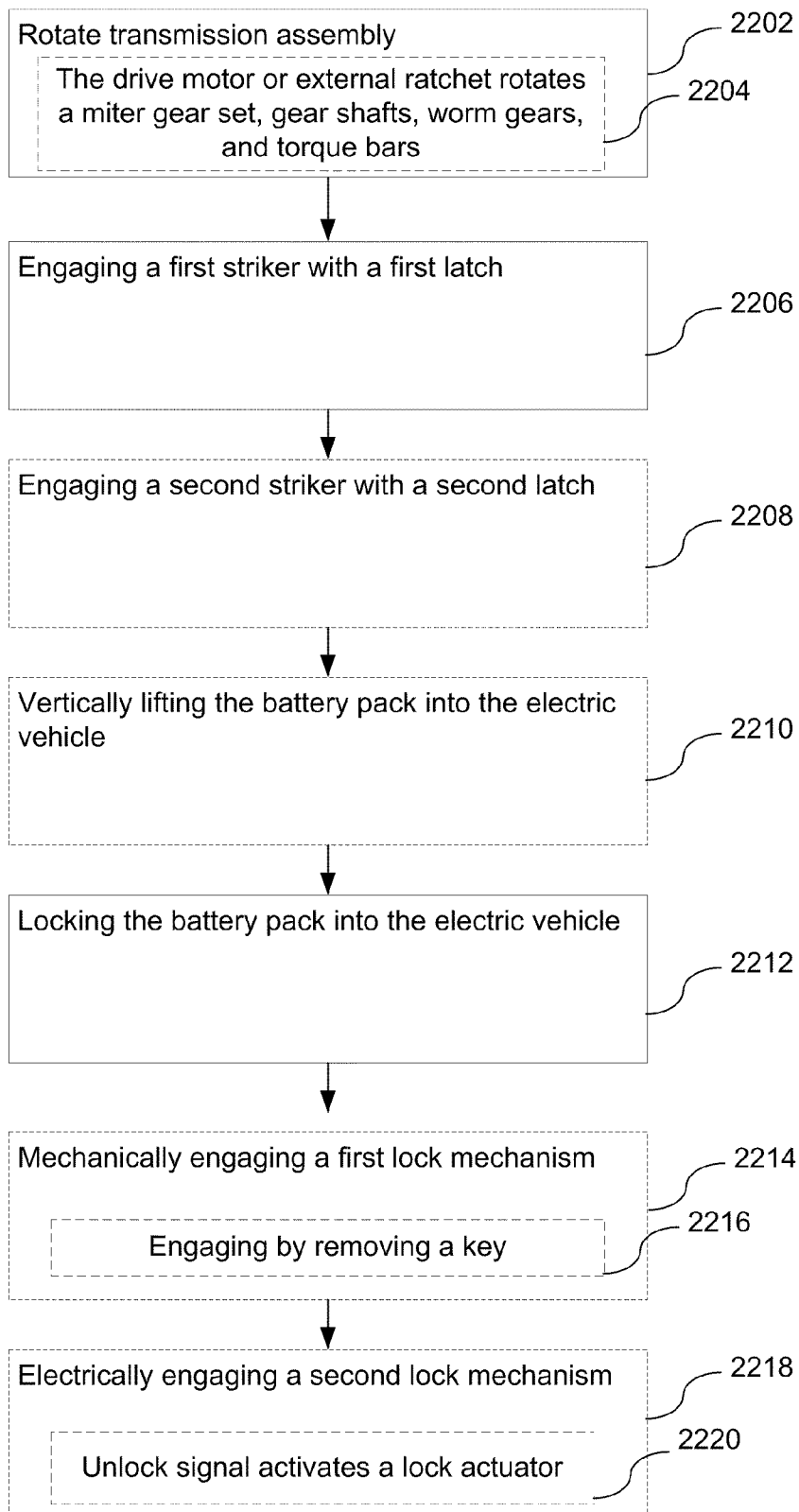

FIG. 22

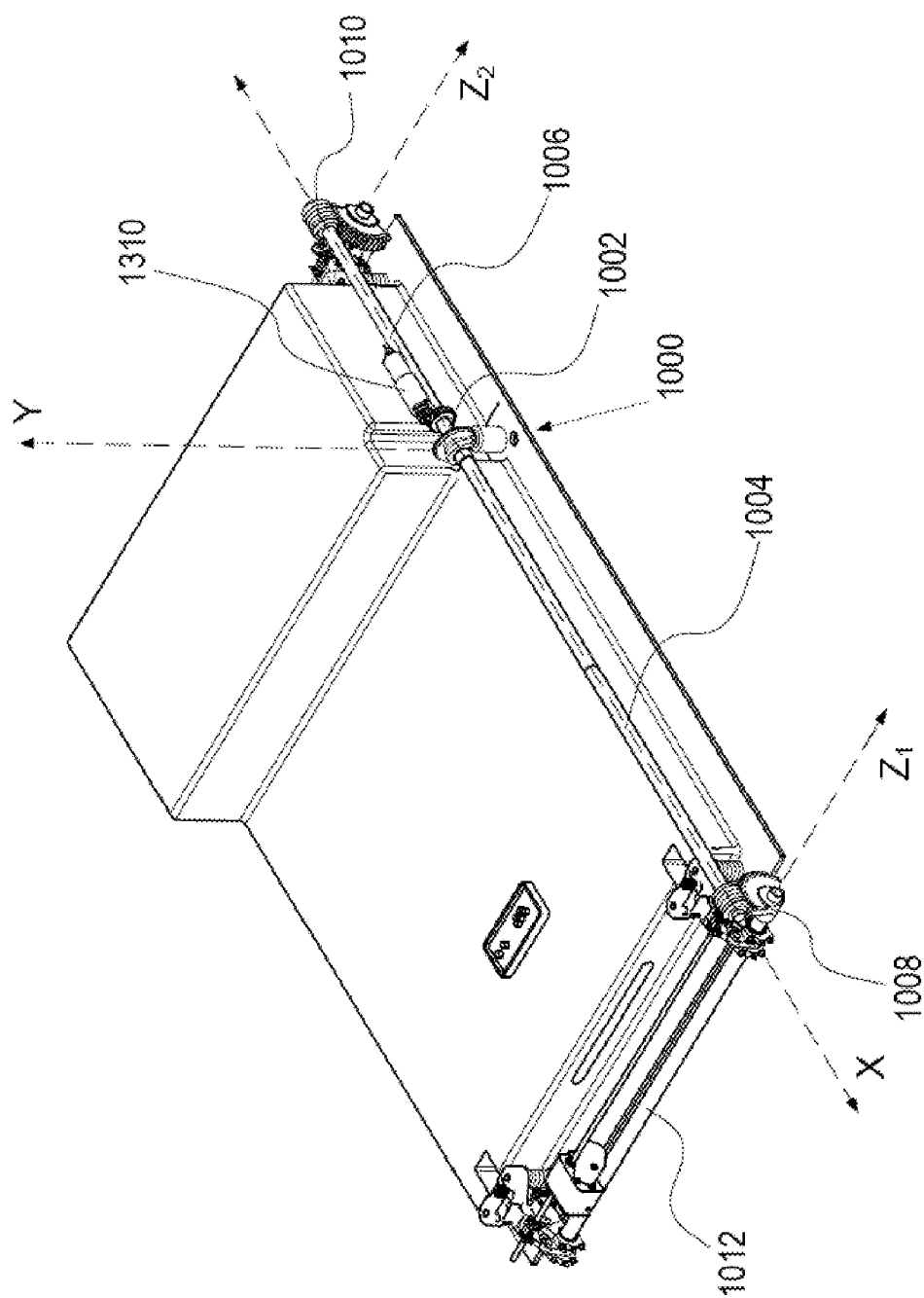

FIG. 23A

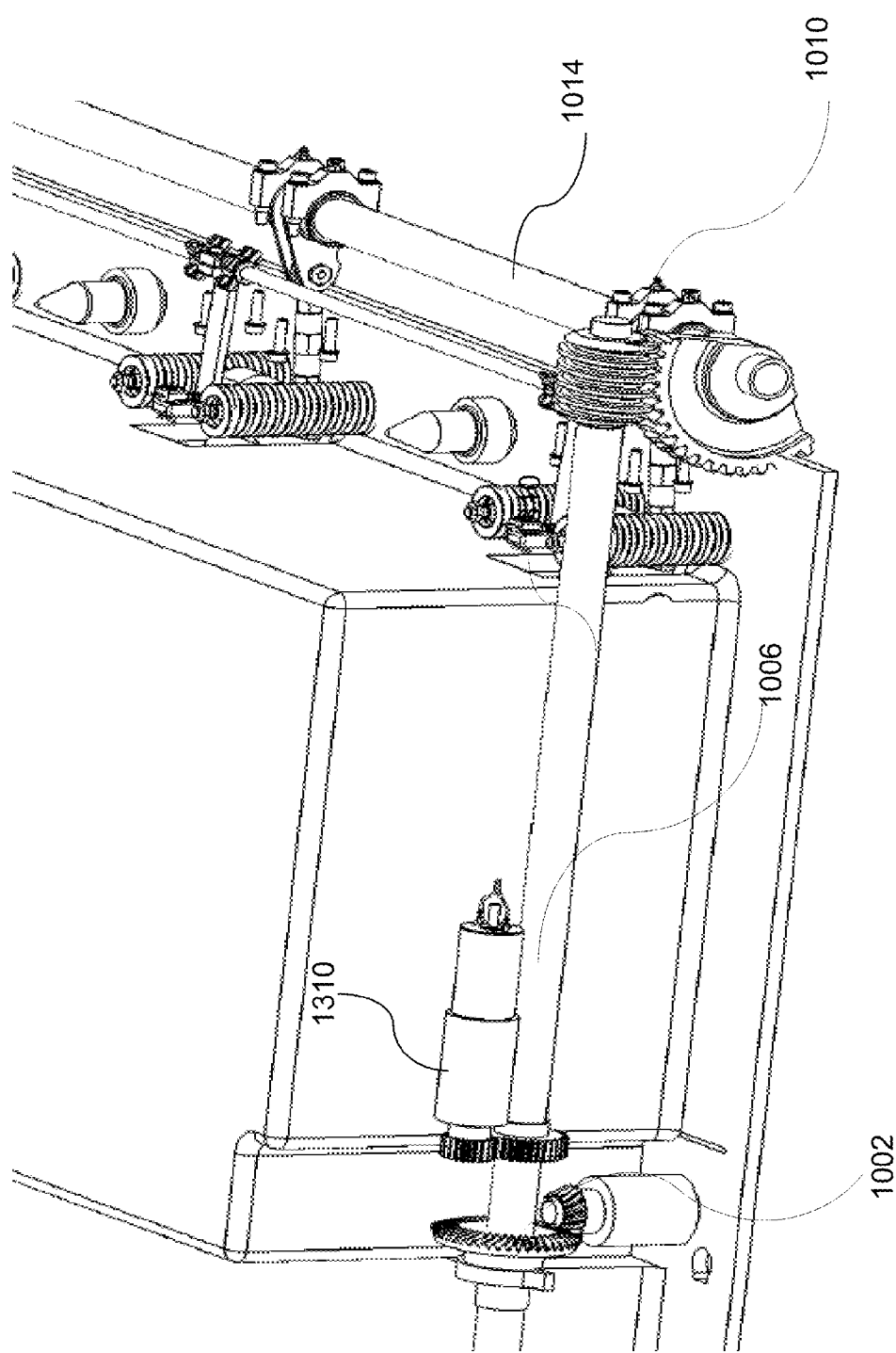

FIG. 23B

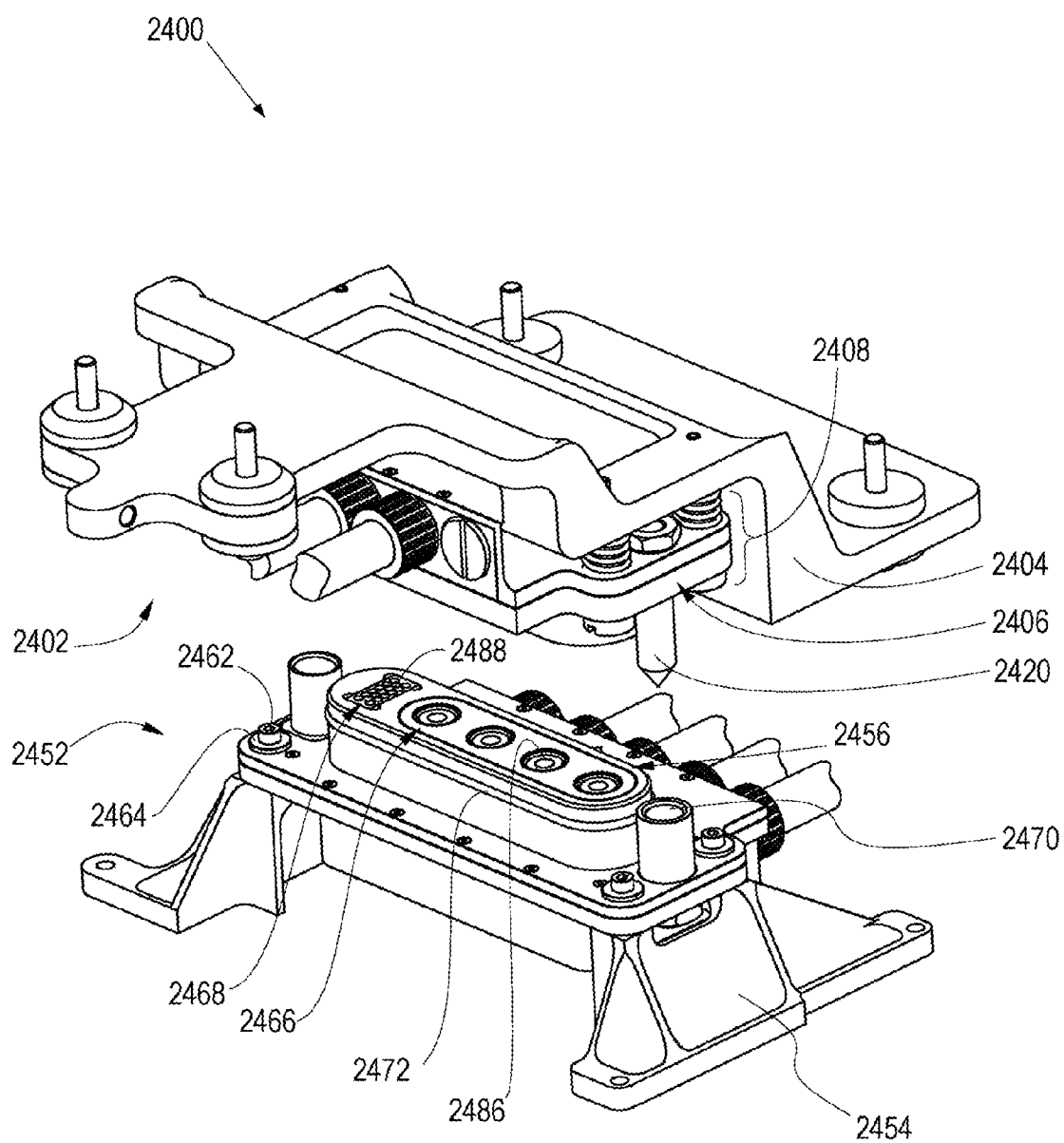

FIG. 24A

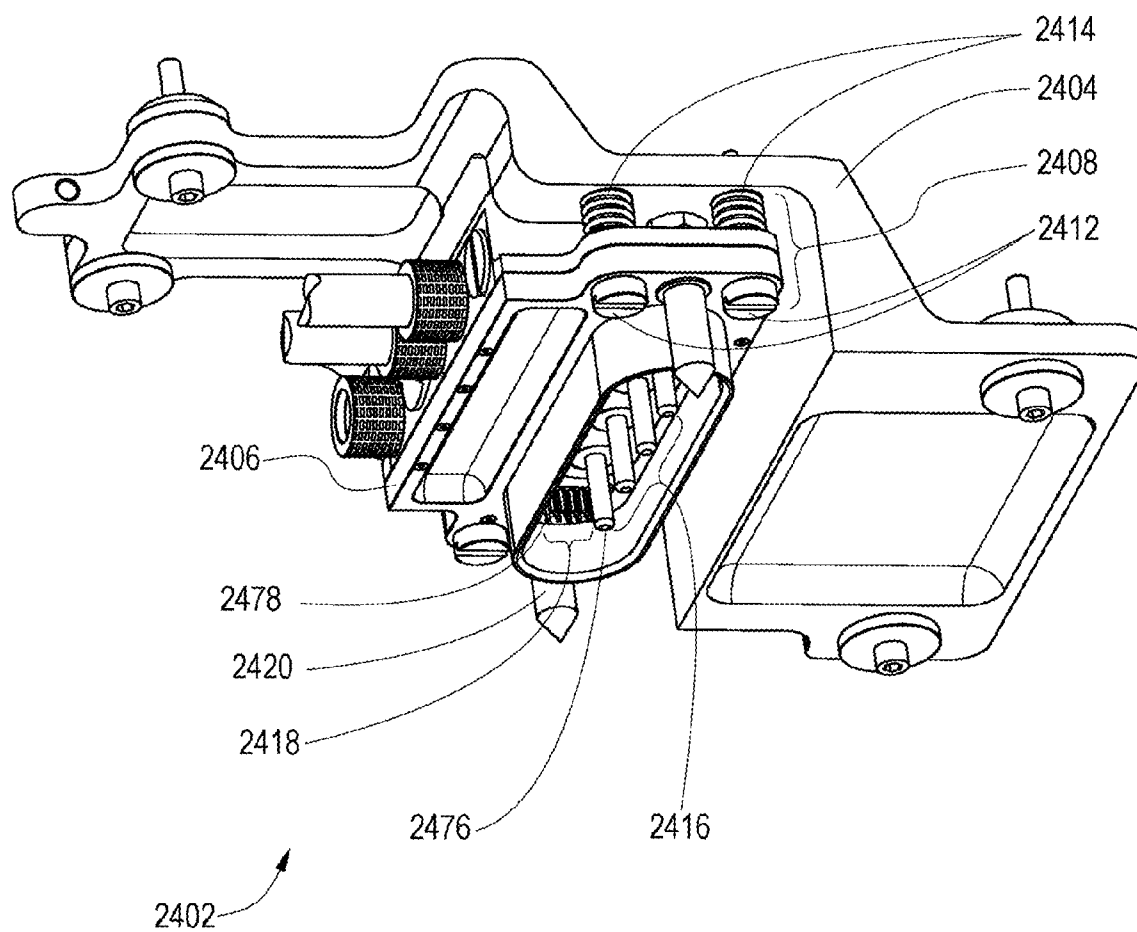

FIG. 24B

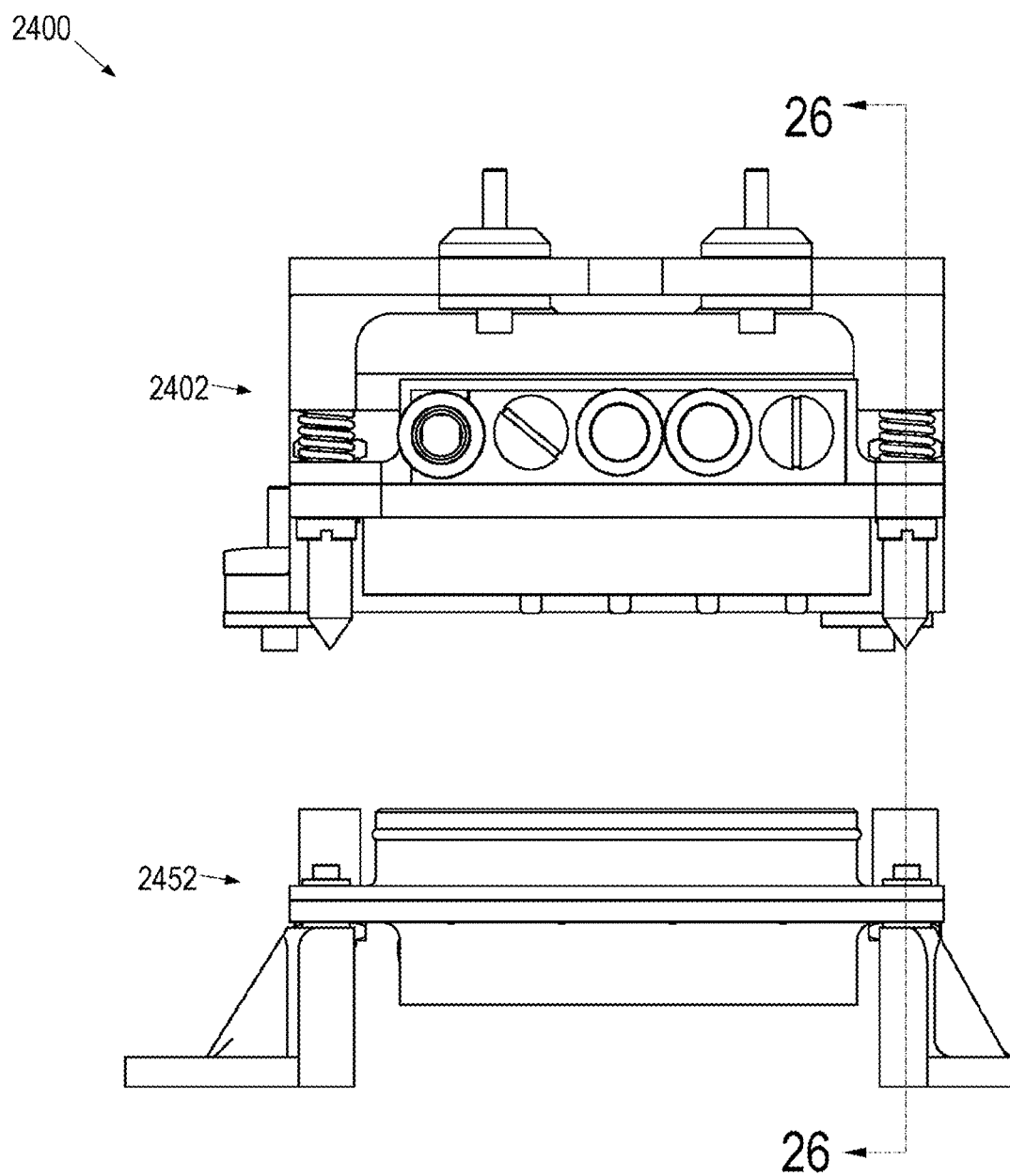

FIG. 25

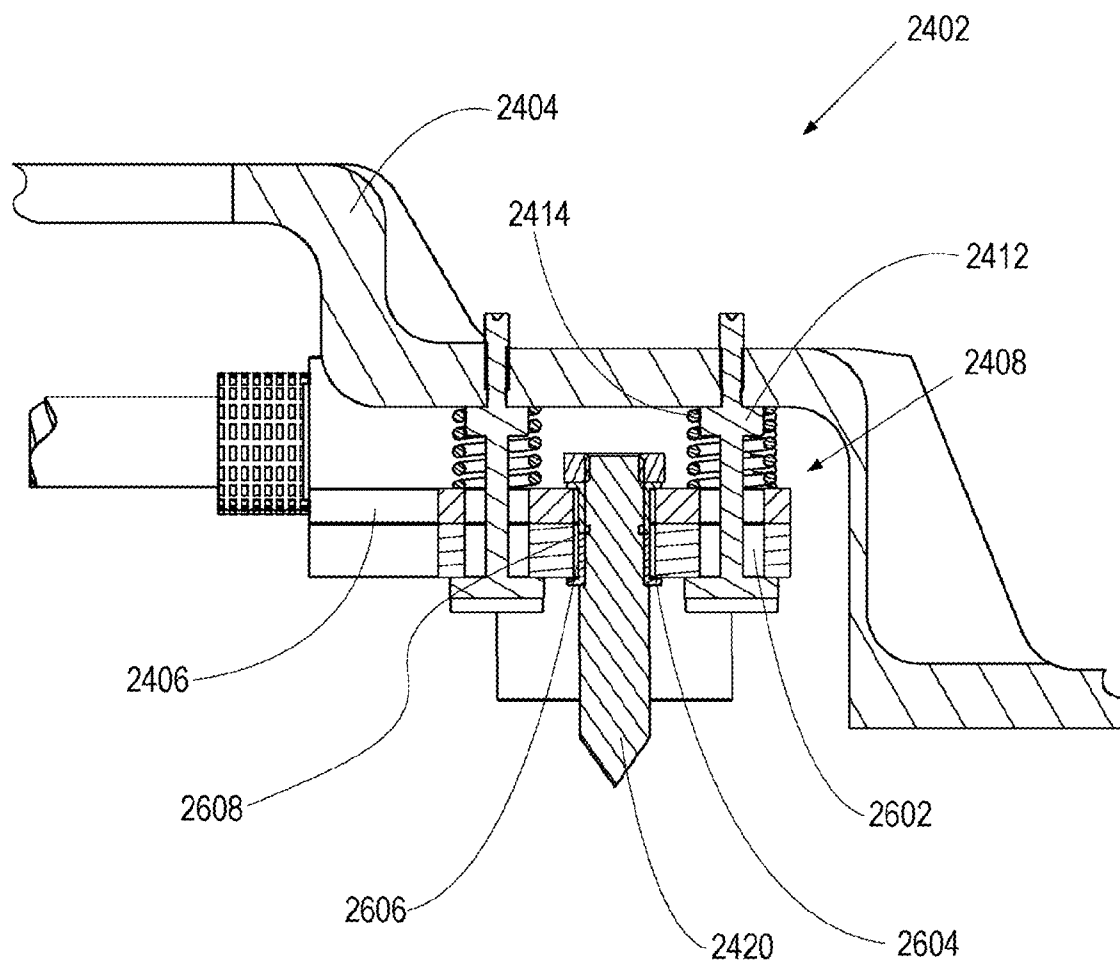

FIG. 26

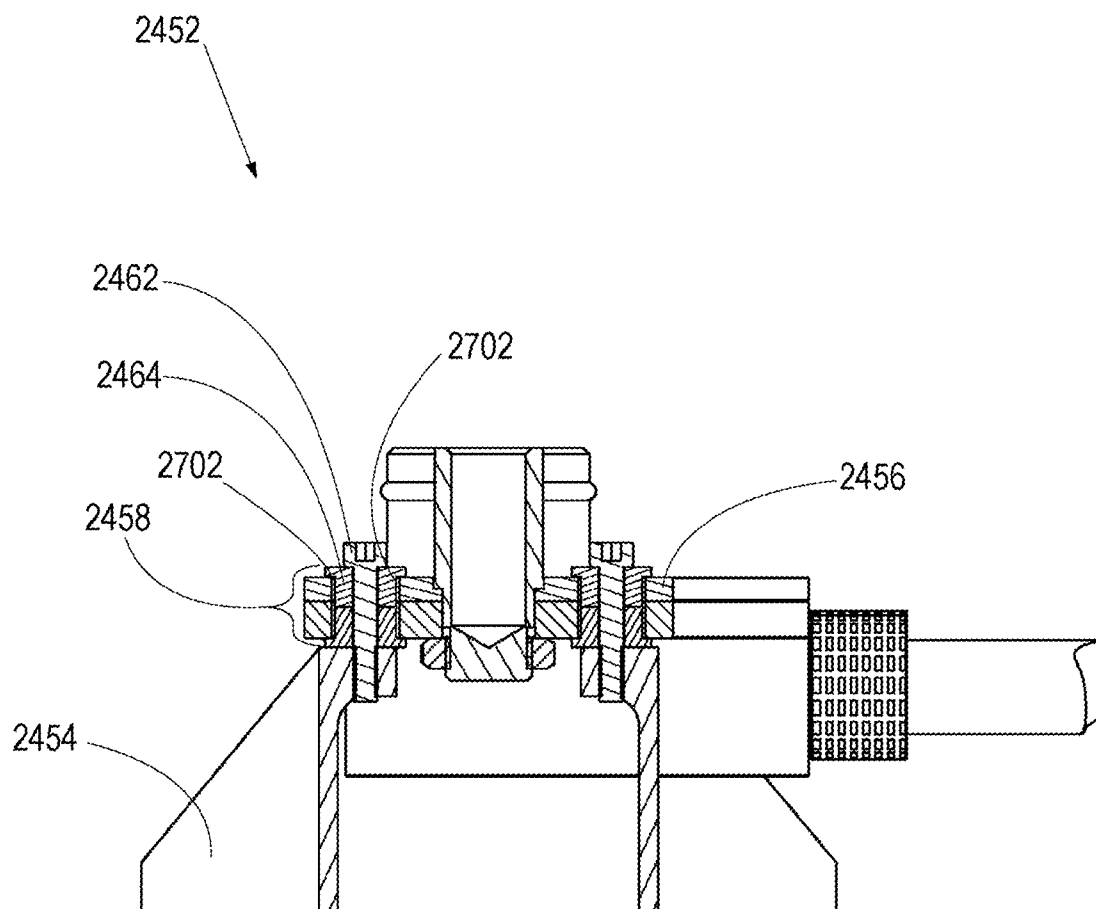

FIG. 27

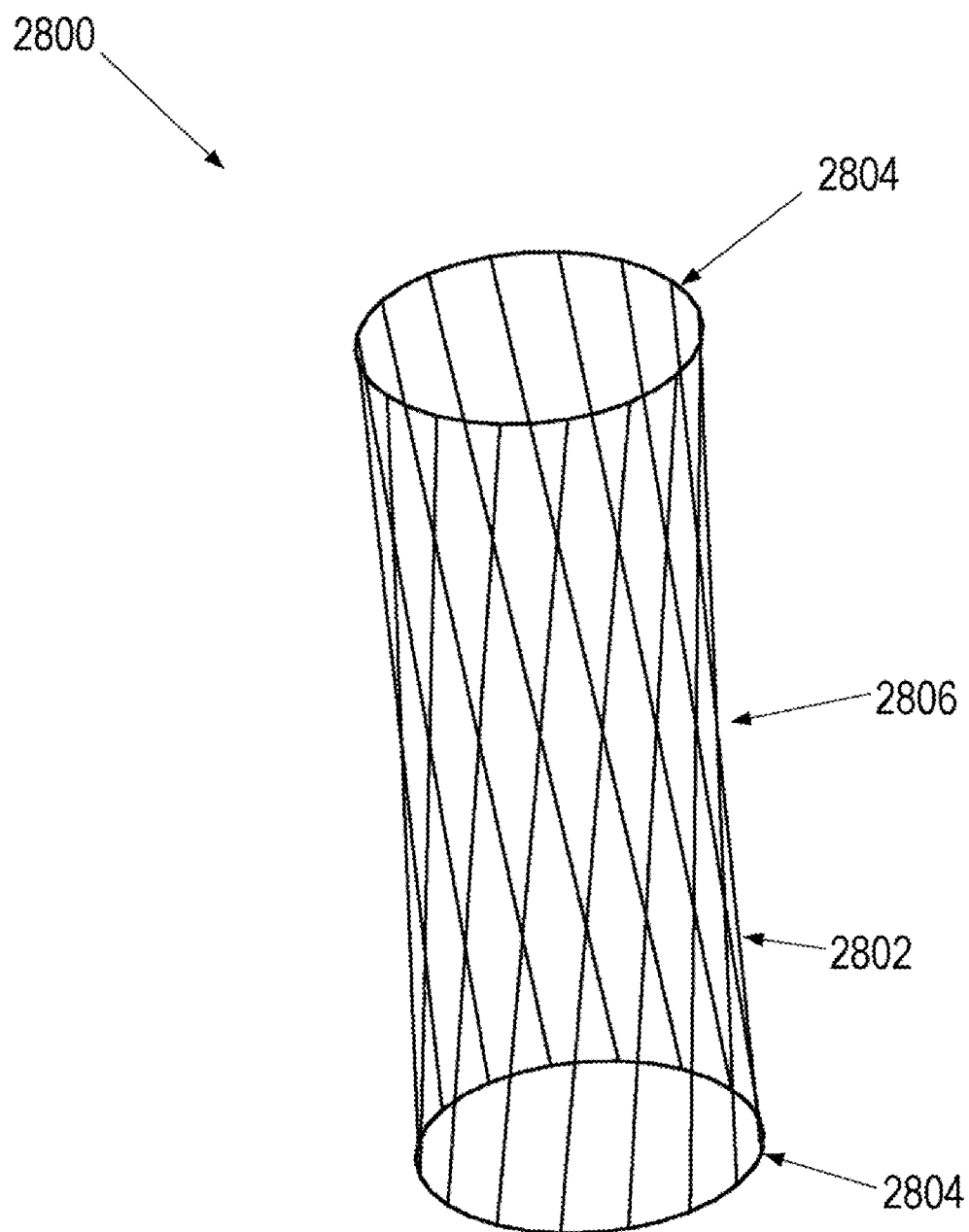

FIG. 28

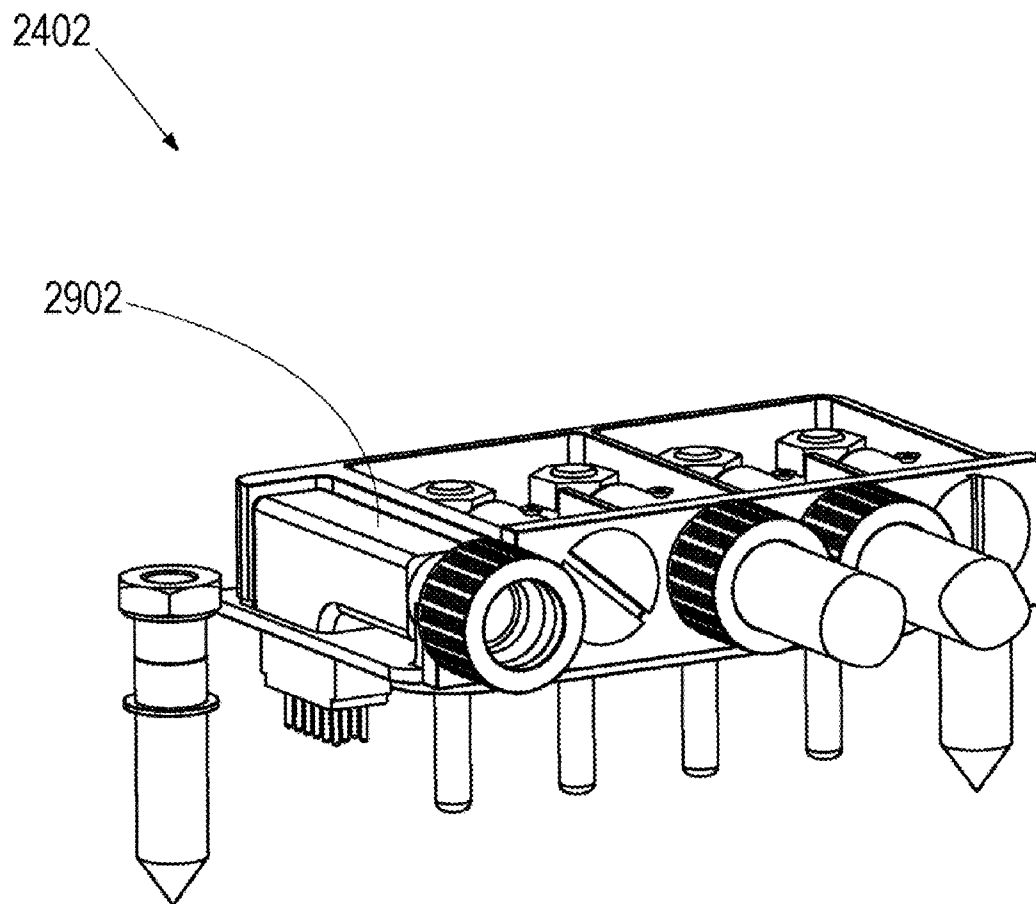

FIG. 29

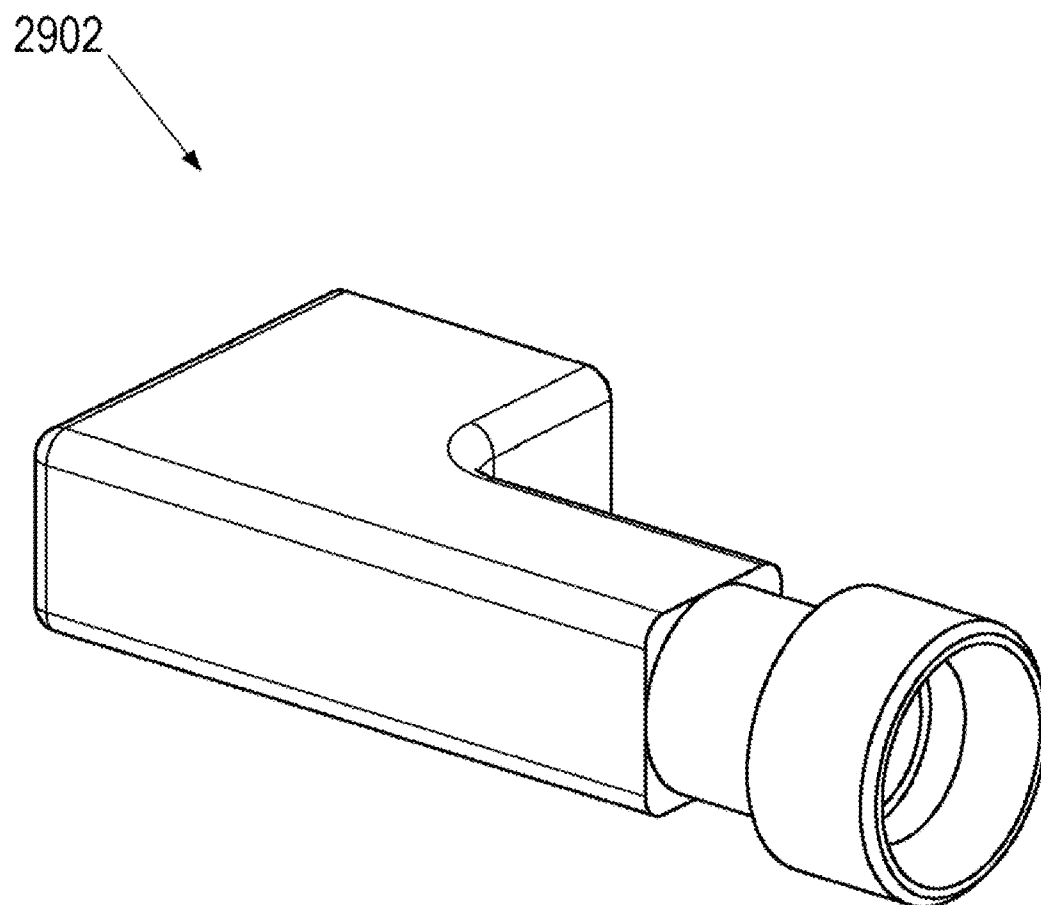

FIG. 30

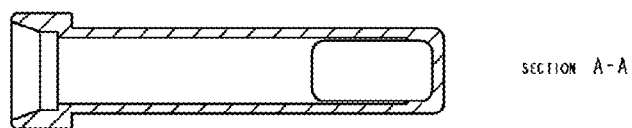

FIG. 31-1

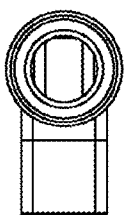

FIG. 31-2

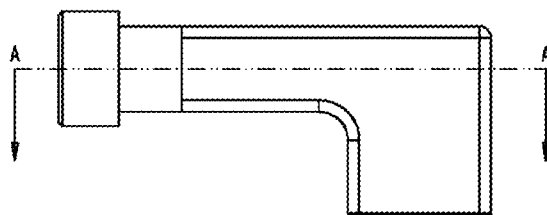

FIG. 31-3



FIG. 31-4

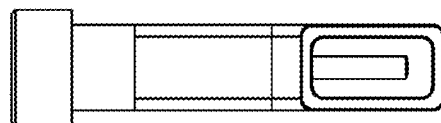

FIG. 31-5

FIG. 31

SYSTEM FOR ELECTRICALLY CONNECTING BATTERIES TO ELECTRIC VEHICLES

RELATED APPLICATIONS

[0001] This application is a continuation-in-part of U.S. patent application Ser. No. 12/428,932, filed Apr. 23, 2009, entitled "Electric Vehicle Battery System" which claims the benefit of: U.S. Provisional Patent Application No. 61/098,724, filed Sep. 19, 2008; U.S. Provisional Patent Application No. 61/149,690, filed Feb. 3, 2009; U.S. Provisional Patent Application No. 61/206,913, filed Feb. 4, 2009; and U.S. Provisional Patent Application No. 61/166,239, filed Apr. 2, 2009. All of these applications are incorporated by reference herein in their entirety.

TECHNICAL FIELD

[0002] The disclosed embodiments relate generally to electric vehicles with removable battery packs. In particular, the disclosed embodiments relate to connector mechanisms for establishing electrical and data connections between a removable battery pack and an electric vehicle.

BACKGROUND

[0003] The vehicle (e.g., cars, trucks, planes, boats, motorcycles, autonomous vehicles, robots, forklift trucks etc.) is an integral part of the modern economy. Unfortunately, fossil fuels, like oil which is typically used to power such vehicles, have numerous drawbacks including: a dependence on limited foreign sources of fossil fuels; these foreign sources are often in volatile geographic locations; and such fuels produce pollution and climate change. One way to address these problems is to increase the fuel economy of these vehicles. Recently, gasoline-electric hybrid vehicles have been introduced, which consume substantially less fuel than their traditional internal combustion counterparts, i.e., they have better fuel economy. However, gasoline-electric hybrid vehicles do not eliminate the need for fossil fuels, as they still require an internal combustion engine in addition to the electric motor.

[0004] Another way to address this problem is to use renewable resource fuels such as bio-fuels. Bio-fuels, however, are currently expensive and years away from widespread commercial use.

[0005] Yet another way to address these problems is to use clean technologies, such as electric motors powered by fuel cells or batteries. However, many of these clean technologies are not yet practical. For example, fuel cell vehicles are still under development and are expensive. Batteries are costly and may add as much as 40% to the cost of a vehicle. Similarly, rechargeable battery technology has not advanced to the point where mass-produced and cost effective batteries can power electric vehicles for long distances. Present battery technology does not provide an energy density comparable to gasoline. Therefore, even on a typical fully charged electric vehicle battery, the electric vehicle may only be able to travel about 40 miles before needing to be recharged, i.e., for a given vehicle storage, the electric vehicles travel range is limited. Furthermore, batteries can take many hours to recharge. For example, batteries may need to be recharged overnight. As the charging time of a typical electric vehicle battery can last numerous hours and recharging may not be an option on a

long journey, a viable "quick refuel" system and method for battery powered electric vehicles would be highly desirable.

[0006] The existing art utilizes permanent batteries that can be re-charged. However, in some embodiments described herein removable batteries are utilized. In these embodiments forming an electrical connection where there is an initial misalignment between the battery and the vehicle can be challenging. In the batteries described herein, both power connections and data connections are encompassed in the same electrical connection system. The high voltage power connection creates electromagnetic interference with the data connection if the connections are in close proximity. The data connection and power connection can be moved far apart from each other such that they do not interfere. However, moving these connectors away from each other requires creating two separate connection assemblies, which adds cost and complexity to the system.

[0007] Accordingly, it would be highly desirable to provide a system for addressing the above described drawbacks.

SUMMARY

[0008] In order to overcome the above described drawbacks, a network of charge spots and battery exchange stations are deployed to provide the EV (electric vehicle) user with the ability to keep his or her vehicle charged and available for use at all times. Some embodiments provide a system and method to quickly exchange, a spent depleted (or substantially discharged) battery pack for a fully charged (or substantially fully charged) battery pack at a battery exchange station. The quick exchange is performed in a period of time significantly less than that required to recharge a battery. Thus, the long battery recharge time may no longer be relevant to a user of an electric vehicle who is traveling beyond the range of the battery.

[0009] Furthermore, the cost of the electric vehicle can be substantially reduced because the battery of the electric vehicle can be separated from the initial cost of the vehicle. For example, the battery can be owned by a party other than the user of the vehicle, such as a financial institution or a service provider. These concepts are explained in more detail in U.S. patent application Ser. No. 12/234,591, filed Sep. 19, 2008, entitled Electronic Vehicle Network, incorporated herein by reference. Thus, the batteries may be treated as components of the electric recharge grid (ERG) infrastructure to be monetized over a long period of time, and not a part of the vehicle purchased by the consumer.

[0010] The following provides a detailed description of a system and method for swapping-out or replacing battery packs in electric vehicles. Some embodiments provide a description of the quick exchangeable battery packs attached to the vehicle.

[0011] Some embodiments provide a battery bay configured to be disposed at an underside of an at least partially electric vehicle. The battery bay includes a frame that defines a cavity configured to at least partially receive a battery pack therein. In some embodiments, the frame of the battery bay forms part of the structure of the vehicle body and is not a separate component. The battery bay also includes at least one latch mechanism rotatably pivoted about an axis substantially parallel with a plane formed by an underside of the vehicle (and/or the surface on which the vehicle is configured to travel, e.g., the road). The latch mechanism is configured to retain the battery pack at least partially within the cavity. In some embodiments, an additional latch is rotatably pivoted

about an additional axis substantially parallel to and distinct from the first axis. In some embodiments, the axis and the additional axis are substantially perpendicular to a length of the vehicle.

[0012] In some embodiments, a transmission assembly is mechanically coupled to the latch and the additional latch, the transmission assembly is configured to simultaneously rotate the latch and the additional latch in rotational directions opposite to one another. In some embodiments, an electric motor is mechanically coupled to the frame for driving the transmission assembly. In some embodiments, the transmission assembly is configured to be driven by a rotation mechanism external to the vehicle.

[0013] Some embodiments provide a method of removing a battery pack from an underside of an at least partially electric vehicle. The method includes rotating a latch mechanism mechanically coupled to a vehicle so as to disengage contact between the latch and a battery pack disposed at an underside of at least partially electric vehicle. The battery pack is then translated away from the underside of the vehicle. In some embodiments, the method of removal involves, prior to the rotating, mechanically disengaging a first lock mechanism. In some embodiments, the method of removal involves, prior to the rotating, electronically disengaging a second lock mechanism. In some embodiments, the method of removal involves occurs in less than one minute.

[0014] Some embodiments provide another method of coupling a battery pack to an electric vehicle. The method of coupling includes substantially simultaneously engaging a first latch located at a front end of the underside of the electric vehicle with a first striker located at a front end of a battery pack and a second latch located at a back end of the underside of the electric vehicle with a second striker located at a back end of a battery pack. Then, the battery pack is substantially simultaneously locked into the electric vehicle by rotating the first and second latches into their respective physical lock positions. In some embodiments, the method of coupling further comprises substantially simultaneously vertically lifting the battery pack into the electric vehicle by rotating the first and second latches in opposite directions, which engages with and raises the battery pack.

[0015] Some embodiments provide a battery system that includes a battery bay for receiving a battery pack. The battery bay is located at an underside of the electric vehicle. The battery bay includes a first latch configured to mechanically couple a front end of the battery pack to a front end of the underside of the electric vehicle, and a second latch configured to mechanically couple a back end of the battery pack to a back end of the underside of the electric vehicle. The first latch and the second latch mechanically couple the battery pack to the underside of the electric vehicle by engaging, vertically lifting, and locking the front and back ends of the battery pack to the electric vehicle substantially simultaneously.

[0016] Some embodiments provide a battery system that includes a battery pack configured to be mechanically coupled to an underside of an electric vehicle, a first latch configured to mechanically couple a proximate end of the battery pack to a proximate end of the underside of the electric vehicle, and a second latch configured to mechanically couple a distal end of the battery pack to a distal end of the underside of the electric vehicle. The first latch and the second latch mechanically couple the battery pack to the underside of the electric vehicle substantially simultaneously.

[0017] In some embodiments, the battery bay includes a latch that is attached to the frame at a first side of the cavity. The battery bay also includes at least one additional latch attached to the frame at a second side of the cavity opposite the first side of the cavity. The additional latch is rotatably pivoted about another axis substantially parallel with the plane formed by the underside of the vehicle. The additional latch is configured to retain the battery pack at least partially within the cavity.

[0018] In some embodiments, the battery bay's latch has a proximate end which rotates about the axis and a distal end remote from the proximate end that is configured to engage a bar shaped striker on the battery pack. In some embodiments, the distal end of the latch has a hook shape.

[0019] In some embodiments, the frame is formed integrally with a frame of the vehicle. In some embodiments, the frame is a separate unit configured to attach to the at least partially electric vehicle. In some embodiments, the frame is located between a front axle and a rear axle of the partially electric vehicle. In some embodiments, the frame defines a substantially rectangular shaped opening, having two long sides and two short sides. In some embodiments, the frame defines an opening having five, six, or more sides defining any shape configured to receive a corresponding battery pack. In some embodiments, the long sides extend along axes substantially parallel (or near parallel) with an axis extending from the front to the back of the vehicle. In some embodiments, the frame defines a substantially cuboid shaped cavity for at least partially receiving the battery pack therein.

[0020] In some embodiments, the battery bay has one or more vibration dampers that are disposed between the frame and the at least partially electric vehicle.

[0021] In some embodiments, the latch and the additional latch substantially simultaneously rotate in opposite directions about their respective axes. In some embodiments, the battery pack is engaged and locked into the at least partially electric vehicle when the latches substantially simultaneously rotate towards one another. In some embodiments, the battery pack is disengaged and unlocked from the at least partially electric vehicle when the latches substantially simultaneously rotate away from one another.

[0022] In some embodiments, the latch and the additional latch are configured to mechanically decouple the battery pack from the underside of the at least partially electric vehicle substantially simultaneously.

[0023] In some embodiments, the latch (or latch mechanism) is part of a four bar linkage mechanism. In some embodiments, the four bar linkage mechanism includes: a latch housing, an input link including a first pivot point and a second pivot point, wherein the first pivot point is pivotably coupled to a proximate end of the latch housing; a latch including a third pivot point and a fourth pivot point; and a coupler link rod including a first rod end and a second rod end. The fourth pivot point is pivotably coupled to a distal end of the latch housing. The first rod end is pivotably coupled to the second pivot point of the input link. The second rod end is also pivotably coupled to the third pivot point of the latch.

[0024] In some embodiments, the coupler link rod includes an adjustment bolt configured to adjust a length of the coupler link rod. In some embodiments, when the input link is in a first position, the latch is configured to mechanically decouple from a striker of the battery pack. In some embodiments, when the input link is in a second position, the latch is in an engaged position configured to mechanically couple to a

striker of the battery pack and the input link, the coupler link rod, and the hook are in a geometric lock configuration. In some embodiments, the latch is configured to raise the battery pack along an axis substantially perpendicular to the plane formed by the underside of the vehicle.

[0025] In some embodiments, the battery bay further comprises a battery pack, which comprises: at least one rechargeable battery cell that stores electrical energy, and a housing at least partially enclosing the at least one rechargeable battery cell. The housing further comprises at least one striker having a bar shape, that is configured to engage with the latch.

[0026] In some embodiments, the housing of the battery pack has a height substantially less than its length, wherein a portion of the housing includes a heat exchange mechanism that has at least a portion thereof exposed to ambient air at the underside of the vehicle when the battery pack is attached to the vehicle. In some embodiments, the battery pack, when attached to the vehicle, at least partially protrudes below the plane of the underside of the electric vehicle. In some embodiments, a portion of the housing includes a heat exchange mechanism that has at least a portion thereof exposed to ambient air at the underside of the vehicle, when the battery pack is attached to the vehicle. In some embodiments, the heat exchange mechanism is selected from at least one of: a heat sink; a heat exchanger; a cold plate; and a combination of the aforementioned mechanisms. In some embodiments, the heat exchange mechanism is a cooling mechanism that includes a duct running through the housing. In some embodiments, the cooling duct includes a plurality of fins. In some embodiments, the cooling duct includes a scooped inlet. In some embodiments, the scooped inlet contains a filter to prevent debris from entering the cooling duct.

[0027] In some embodiments, the battery bay further includes a battery pack. The battery pack includes a housing configured to substantially fill a cavity in a battery bay of the vehicle. The housing includes: a first side wall; a second side wall opposing the first side wall; at least one first striker disposed at the first side wall having a bar shape wherein the central axis of the first striker is parallel to the first side wall; at least one second striker disposed at the second side wall having a bar shape wherein the central axis of the second striker is parallel to the second side wall; and at least one battery cell that stores electrical energy. The battery cell is at least partially enclosed within the housing. In some embodiments the bar shaped strikers have some anti-friction attachments such as roller bearings or low friction surface treatments.

[0028] In some embodiments, the frame of the battery bay further includes at least one alignment socket configured to mate with at least one alignment pin on the battery pack.

[0029] In some embodiments, the frame of the battery bay further includes at least one compression spring coupled to the battery bay, wherein the at least one compression spring is configured to generate a force between the battery bay and the battery pack when the battery pack is held at least partially within the cavity.

[0030] In some embodiments, the transmission assembly further includes: a plurality of latches mechanically coupled to a first torque bar. The first torque bar is configured to actuate the latches. Additional latches are mechanically coupled to a second torque bar. The second torque bar is configured to actuate the additional latches. Furthermore, the first torque bar and the second torque bar are configured to substantially simultaneously rotate in opposite directions. In

some embodiments, the first torque bar is located at a side of the battery bay nearest to a front end of the vehicle. The second torque bar is located at a side of the battery bay nearest to a back end of the vehicle.

[0031] In some embodiments, the transmission assembly further includes a first gear shaft coupled to a first torque bar via a first worm gear set, and a second gear shaft coupled to a second torque bar via a second worm gear set. The first gear shaft and the second gear shaft substantially simultaneously rotate in opposite directions causing the first torque bar and the second torque bar to substantially simultaneously rotate in opposite directions via the first worm gear set and second worm gear set. In some embodiments, the first gear shaft comprises two shafts joined by a universal joint. In some embodiments the design may include left and right worm gear set, a design which does not require the gear shafts to rotate in opposite directions.

[0032] In some embodiments, the transmission assembly further includes a miter gear set coupled to the first gear shaft and a second gear shaft. The miter gear set is configured to synchronously rotate the first and second gear shafts in opposite directions.

[0033] In some embodiments, the transmission assembly further includes a drive motor coupled to the miter gear set via a gear ratio set. The drive motor is configured to rotate the first and second gear shafts in opposite directions via the gear ratio set and the miter gear set.

[0034] In some embodiments, the transmission assembly further includes a drive socket located at an underside of the electric vehicle. The socket is coupled to the central gear of the miter gear set. Rotation of the socket actuates the miter gear set. In some embodiments, the drive socket has a non-standard shape for receiving a socket wrench having a head corresponding to the non-standard shape.

[0035] In some embodiments, the transmission assembly further includes a miter gear lock configured to prevent the miter gear set from rotating. In some embodiments, the miter gear lock is configured to be released with a key. In some embodiments, the key physically unlocks the miter gear lock. In some embodiments, miter gear lock is spring loaded.

[0036] In some embodiments, the battery bay further includes one or more latch locks, which when engaged, are configured to prevent the at least one latch from rotating. In some embodiments, the latch lock further includes a lock synchronization bar coupled to the one or more latch locks and a lock actuator coupled to the lock synchronization bar. The lock synchronization bar is configured to actuate the one or more latch locks. The lock actuator is configured to actuate the lock synchronization bar. In some embodiments, the one or more latch locks are lock bolts. In some embodiments, the lock actuator is coupled to an electric motor configured to actuate the lock synchronization bar via the lock actuator. In some embodiments, the lock synchronization bar is configured to rotate the one or more latch locks in a first direction so that the one or more latch locks become engaged, and wherein the lock synchronization bar is configured to rotate the one or more latch locks in a second direction so that the one or more latch locks become disengaged.

[0037] In some embodiments, the battery bay further comprises one or more latch locks, which when engaged, are configured to prevent the at least one latch from rotating. The one or more latch locks are configured to disengage only when the miter gear lock has been released.

[0038] In some embodiments, the battery bay further comprises a latch position indicator configured to determine an engaged position and a disengaged position of the latch.

[0039] In some embodiments the latches are synchronized electronically without the presence of mechanical coupling. An individual latch unit, containing internal electric motor and transmission performs the latching operation. A control unit is utilized to synchronize and control the operation of all latches.

[0040] The engaging (coupling) and disengaging (uncoupling) of a removable battery pack may happen many times over the lifecycle of the at least partially electric vehicle. In some embodiments, the battery pack and vehicle should withstand up to 3000 cycles of engaging and disengaging. In some embodiments, the components should withstand up to 5000 cycles. Once coupled or engaged, a high electrical voltage and current may be transmitted between the battery pack and the vehicle for the battery pack to power the electric vehicle. In some embodiments, the battery pack also contains circuitry to communicate data to the vehicle. Such “smart” batteries provide information to the vehicle’s computer systems regarding battery charge, battery health, remaining range, or other pertinent information. In these embodiments, a data signal path is also formed between the battery pack and the vehicle in each engagement. In order for the power connection and the data connection to be formed, the power and data contacts on the battery pack and the electrical and data contacts on the vehicle must be properly aligned with one another. For example, the small data and power pins and sockets should be precisely aligned to form appropriate electrical connections. Furthermore, the data and power connectors must remain in contact with each other and withstand rigorous factors caused by daily driving such as vertical and horizontal shock and vibration, impact etc.

[0041] This connection system described herein provides for a quick connect/disconnect system that compensates for misalignments that may occur between the battery-side connector and the vehicle-side connector during the removal and replacement of the battery. These embodiments provide structural flexibility for the coupling portions of the battery and vehicle to be moved into proper alignment through alignment mechanisms such as pin and socket alignment mechanisms. These embodiments also provide one or more misalignment relief mechanisms. Specifically, at least one connector in connection system includes a coupler designed to allow movement between a fixed mounting portion directly attached to the battery or vehicle respectively and a free coupling portion containing the data and power interfaces of the connector. In some embodiments, the allowed movement there between is horizontal, or substantially parallel to the X-Z plane of the underside of the vehicle. In some embodiments, the allowed movement is also vertical. In some embodiments, the coupler includes a spring which in addition to aiding in compensating for misalignments also provides vertical force to keep the electrical and data components connected to one another. Some of these embodiments also employ data and power sockets with conductive mesh sleeves capable of remaining in electrical contact with their corresponding data and power pins despite the vibration and jarring of daily driving and are further capable of withstanding the 3000 or more engagement cycles.

[0042] In some embodiments, the data connection between the battery pack and the vehicle are both located in the same electrical connection system having precise alignment capa-

bilities. In other words, a single battery side connector component contains both data and power interfaces, and a single vehicle side connector component also contains both data and power interfaces. One advantage of providing a data connection and a power connection in the same electrical connection system is that one electrical connection system can be used to align both power and data interfaces simultaneously. However, data communication conductors are susceptible to electromagnetic interference caused by proximity to high voltage or high current conductors. Sometimes electromagnetic interference can be overcome by maintaining a substantial distance between any high voltage or high current conductor and any data or signal conductors. However, given the desire to minimize the number of connection points requiring precise alignment between the vehicle and the battery, in some embodiments, it is beneficial to include both power and data interfaces on the same connector system components. In these embodiments, it is impractical to maintain adequate distances between the data and the power conductors to overcome electromagnetic interference. Instead, a shielding mechanism is provided in order to allow the use of a single connector for both data and power while preventing undesirable electromagnetic effects caused by the data conductor’s proximity to power conductors. In embodiments of an electrical connection system that have both electrical connectors and data connectors on the same connector components, the electrical connection system also has shielding mechanisms that shield data interfaces from electromagnetic interference caused by high voltage electrical interfaces located near one another in the connection system. In some embodiments, the data connectors and the electrical connectors are within one inch of each other. In other embodiments the electrical and data connections are located on separate connection systems each having separate alignment mechanisms like those of the electrical connection system described below.

[0043] Another noteworthy element of the embodiments described herein is the lack of any latching mechanisms on the electrical connection system itself. These embodiments do not require additional clamping or latching mechanisms to ensure positive contact between the power and data interfaces. Instead, the components of the electrical connection system embodiments are held in contact with one another through the latch mechanisms in the battery bay. Because the alignment mechanisms employed in the connection system embodiments compensate for initial misalignments between the battery pack and the vehicle, battery packs can be quickly removed and inserted into the vehicle’s battery bay without additional concern for latching or aligning a complicated electrical connector. Additionally, the latching mechanism secures the battery with adequate force to maintain the connection between the vehicle-side and battery-side connectors. By reducing the steps and complexity of the battery swapping process, electric vehicles are more convenient for everyday use.

[0044] Some embodiments provide an electrical connection system for a battery of an at least partially electric vehicle. The electrical connection system utilizes a shielding mechanism with the vehicle-side connector and the battery-side connector as follows. The vehicle-side connector is configured to permanently attach to an underside of an at least partially electric vehicle. The battery-side connector is configured to permanently attach to a battery pack. The battery-side connector is configured to mate to the vehicle-side connector. The battery-side connector and the vehicle-side

connector also are configured to removably couple to each other, along an axis substantially perpendicular to the underside of the at least partially electric vehicle. Each electrical connector includes a high voltage interface for transmitting high voltage electricity between the electrical connectors a data interface for transmitting data between the electrical connectors. The electrical connection system also includes a shielding mechanism to counteract electromagnetic effects caused by the high voltage connection elements. In some embodiments, the shielding mechanisms separate the data interface from the high voltage interface to counteract electromagnetic effects caused by the high voltage connection elements. In some embodiments, the shielding mechanism comprises a housing that substantially covers the data interface. In some embodiments, the housing is L-shaped.

[0045] In some embodiments, the electrical connection system further comprises a sealing mechanism positioned between the first and second electrical connectors for preventing environmental contamination when the first and second electrical connectors are coupled.

[0046] In some embodiments, the high voltage interface includes conductive pins; and sockets for receiving the conductive pins. Furthermore, the sockets are made of a conductive mesh sleeve for forming an electrical connection with the conductive pins. Similarly, in some embodiments, the data interface also has pins and sockets where the sockets are made of a conductive mesh sleeve. In other embodiments the data interface comprises a fiber optic interface.

[0047] In some embodiments, the high voltage electricity is between about 100 and 1000 VDC. In other embodiments, the high voltage electricity is between about 200 and 800 VDC. In yet other embodiments, the high voltage electricity is between about 350 and 450 VDC.

[0048] Some embodiments provide an electrical connection system for a battery of an at least partially electric vehicle. The electrical connection system utilizes a coupling mechanism for compensating for misalignment between the vehicle-side connector and the battery-side connector as follows. The electrical connection system includes a first electrical connector, a second electrical connector, and a coupler for compensating for misalignment between the first and second electrical connectors. The first electrical connector is configured to mount to an underside of an at least partially electric vehicle. It includes a first coupling portion for mating with a second coupling portion of a second electrical connector. The second electrical connector is configured to mount to a battery and comprises a second coupling portion for mating with the first coupling portion of the first electrical connector. Located there between is coupler for compensating for misalignment between the first and second electrical connectors. The first and second coupling portions include a high voltage interface for transmitting high voltage electricity and a data interface for transmitting data between the first and second coupling portions. In some embodiments, the coupling portion is on the vehicle side connector. In other embodiments the coupling portion is on the battery side connector.

[0049] In some embodiments, the connection system for a battery of an at least partially electric vehicle includes one or more coupling portions for compensating for misalignment between the vehicle-side connector and the battery-side connector as follows. A first electrical connector is configured to mount to an underside of an at least partially electric vehicle. The first electrical connector includes a first coupling portion for mating with a second coupling portion of a second elec-

trical connector, a first mounting portion for attaching the first electrical connector to the at least partially electric vehicle, and a first coupler for attaching the first coupling portion to the first mounting portion. The first coupler allows relative motion between the first coupling portion and the first mounting portion. A second electrical connector is configured to mount to a battery. The second electrical connector includes a second coupling portion for mating with the first coupling portion of the first electrical connector. The first coupler compensates for misalignment between the first and second electrical connectors. The first and second coupling portions include a high voltage interface for transmitting high voltage electricity and a data interface for transmitting data between the first and second coupling portions. In some embodiments, the second electrical connector also includes a second mounting portion for attaching the second electrical connector to the battery and a second coupler for attaching the second coupling portion to the second mounting portion. The second coupler allows for relative motion between the second coupling portion and the second mounting portion. The second coupler also compensates for misalignment between the first and second electrical connectors.

[0050] In some embodiments, the first coupler is configured to allow the first coupling portion to move in vertical and horizontal planes with respect to the first mounting portion. In some embodiments, the first coupler is made of a hole in the first coupling portion and a bolt rigidly attached to the first mounting portion and extending through the hole in the first coupling portion, where the bolt has a smaller diameter than the hole. In some embodiments, the first coupler further includes a coil spring positioned between the first coupling portion and the first mounting portion. In some embodiments, the bolt extends through the center of the coil spring.

[0051] In some embodiments, the first coupling portion of the electrical connection system of claim includes a pin and a socket. The pin and socket are configured to ensure lateral alignment between the first and second coupling portions. In some embodiments, the inside surface of the socket is a channel having an oval cross section. The channel has an inside surface larger than the pin to allow for space between a portion of the inside surface of the channel and a portion of the outside surface of the pin.

[0052] The above described embodiments address one or more previously mentioned drawbacks. For example, misalignment between the electrical interface components of a battery and its corresponding bay in an electric vehicle are compensated for by the alignment and misalignment compensation mechanisms described. Furthermore, electromagnetic interference caused by high voltage power connections is overcome or alleviated by various shielding mechanisms. In some embodiments, both misalignment and electromagnetic interference are addressed using a combination of the above described features making a robust battery exchanging system capable of withstanding many exchange cycles.

BRIEF DESCRIPTION OF THE DRAWINGS

[0053] FIG. 1 illustrates an electric vehicle network.

[0054] FIGS. 2A-2B are views of the electric vehicle of FIG. 1. FIG. 2A is a bottom view of the electric vehicle and FIG. 2B is a side view of the electric vehicle.

[0055] FIGS. 3A and 3B are underside perspective views of the electric vehicle and battery pack of FIG. 1.

[0056] FIGS. 1-3.

[0057] FIG. 4 is a perspective view of one embodiment of the battery pack of FIG. 5 is a perspective view of one embodiment of the battery pack of FIGS. 1-3 showing various chemical modules or cells.

[0058] FIG. 6 is a perspective view of one embodiment of a battery pack with a first cooling system.

[0059] FIG. 7 is a bottom perspective view of another embodiment of a battery pack with a second cooling system.

[0060] FIG. 8 is a perspective view of another embodiment of a battery pack.

[0061] FIG. 9 is a perspective view of an electrical connection system.

[0062] FIG. 10 is a perspective view of an embodiment of a battery pack connected to a battery bay and the battery bay's transmission assembly.

[0063] FIG. 11 is a perspective view of another embodiment of a battery bay.

[0064] FIG. 12 is a close-up oblique view of an embodiment of the worm gear set of FIG. 11.

[0065] FIG. 13 is a close-up perspective view of an embodiment of a first gear set mechanism of FIG. 11.

[0066] FIG. 14 is a close-up perspective view of the underside of the battery and bay including a close-up view of an embodiment of a drive socket.

[0067] FIG. 15 is a perspective view of one embodiment of a gear lock.

[0068] FIG. 16 is a perspective view of another embodiment of a gear lock.

[0069] FIG. 17 is a close-up perspective view of a key inserted into a key hole and releasing the gear lock of FIG. 16.

[0070] FIG. 18 is a close-up perspective view of an embodiment a battery bay with several alignment sockets configured to mate with alignment pins on the battery pack.

[0071] FIGS. 19A-19C are side views of a latch mechanism at various positions.

[0072] FIG. 20 is a close-up perspective view of the latch lock mechanism of the battery bay.

[0073] FIG. 21 is a flow diagram of a process for releasing a battery pack from a battery bay.

[0074] FIG. 22 is a flow diagram of a process for engaging a battery pack to a battery bay.

[0075] FIGS. 23A and 23B are perspective and close-up perspective views respectively of another embodiment of a transmission assembly of a battery bay.

[0076] FIG. 24A is a top perspective view of an electrical connection system.

[0077] FIG. 24B is a bottom perspective view of the vehicle-side connector of 24A.

[0078] FIG. 25 is a side view of the electrical connection system of FIG. 24A.

[0079] FIG. 26 is a cross-sectional side view of the vehicle-side connector portion of the electrical connection system as viewed along line 26-26 of FIG. 25.

[0080] FIG. 27 is a cross-sectional side view of the battery-side connector portion of the electrical connection system as viewed along line 26-26 of FIG. 25.

[0081] FIG. 28 is a perspective view of a conductive mesh sleeve used in the female side of some embodiments of the data and power connectors shown in FIG. 24A.

[0082] FIG. 29 is a partially exploded perspective view of a portion of the vehicle-side connector shown in FIG. 24B.

[0083] FIG. 30 is a perspective view of an example of a shielding mechanism used in the vehicle-side connector of FIG. 29

[0084] FIG. 31 includes planar views of all sides of the shielding mechanism of FIG. 29.

[0085] Like reference numerals refer to corresponding parts throughout the drawings.

DESCRIPTION OF EMBODIMENTS

[0086] FIG. 1 illustrates an electric vehicle network 100, according to some embodiments. The electric vehicle network 100 includes a vehicle 102 and a battery pack 104 configured to be removably mounted to the vehicle 102. In some embodiments, the battery pack 104 includes any device capable of storing electric energy such as batteries (e.g., lithium ion batteries, lead-acid batteries, nickel-metal hydride batteries, etc.), capacitors, reaction cells (e.g., Zn-air cell), etc. In some embodiments, the battery pack 104 comprises a plurality of individual batteries or battery cells/chemical modules. In some embodiments, the battery pack 104 also comprises cooling mechanisms, as well as mechanical and electrical connectors for connecting to the vehicle 102 or to the various elements of the battery exchange station 134. These mechanical and electrical connectors will be described in further detail below.

[0087] In some embodiments, the vehicle 102 includes an electric motor 103 that drives one or more wheels of the vehicle. In these embodiments, the electric motor 103 receives energy from the battery pack 104 (shown separate from the vehicle for the ease of explanation). The battery pack 104 of the vehicle 102 may be charged at a home 130 of a user 110 or at one or more charge stations 132. For example, a charge station 132 may be located in a shopping center parking lot. Furthermore, in some embodiments, the battery pack 104 of the vehicle 102 can be exchanged for a charged battery pack at one or more battery exchange stations 134. Thus, if a user is traveling a distance beyond the range of a single charge of the battery of the vehicle, the spent (or partially spent) battery can be exchanged for a charged battery so that the user can continue with his/her travels without waiting for the battery to be recharged. The battery exchange stations 134 are service stations where a user can exchange spent (or partially spent) battery packs 104 of the vehicle 102 for charged battery packs 104. The charge stations 132 provide energy to charge the battery pack 104 while it is coupled to the vehicle 102. These components of the network 100 are connected to related power and data networks, as explained in more detail in U.S. patent application Ser. No. 12/234,591, filed Sep. 19, 2008, entitled Electronic Vehicle Network, the disclosure of which is incorporated herein by reference.

[0088] FIGS. 2A-2B are side and bottom views of an at least partially electric vehicle 102. The vehicle 102 includes a removable battery pack 104 (sometimes herein referred to just as a battery) attached to the vehicle 102 at its underside. In some embodiments, the battery pack 104 is substantially flat and runs along at least a portion of the length of the vehicle 102; i.e., along the longitudinal X-axis of the vehicle. In some embodiments, the battery 104 may protrude below the plane 204 of the underside of the vehicle 102, i.e., protruding in the negative Y-axis direction. Protruding from the underside of the vehicle is helpful for air cooling the battery pack 104, as the protruding battery pack is exposed to ambient air flow. In embodiments with air scoops, discussed below in relation to FIG. 6, at least the air scoop intake will be exposed to ambient air at the underside of the vehicle 102 to receive air flow when the vehicle 102 is moving forward. In some embodiments

where the battery pack is retrofitted to a vehicle, i.e., after-market, the battery pack may protrude from the bottom of the vehicle.

[0089] When the battery 104, or portions thereof, protrude from below the plane of the underside 204 of the vehicle 102, it may, however, be unsightly. Therefore, in some embodiments, cosmetic fairings 202 are attached to the vehicle to hide the battery pack 104. In some embodiments, the cosmetic fairings 202 also produce a smooth outline and reduce drag. These cosmetic fairings 202 may be mounted on any or all of the front, sides, and rear of the vehicle.

[0090] FIGS. 3A and 3B are underside perspective views of the electric vehicle 102 and battery pack 104 of FIG. 1. FIG. 3A shows the battery pack 104 mounted in a battery bay 108. FIG. 3B shows the battery pack 104 removed from the battery bay 108. The battery bay 108 includes a frame 118 that defines the outline of a cavity 302 disposed at the underside of the vehicle 102. The cavity 302 is configured to at least partially receive the battery pack 104 therein. In some embodiments, the bay frame 118 has a substantially rectangular shape, for at least partially receiving a substantially cuboid or rectangular parallelepiped battery pack 104 therein. In some embodiments, the frame 118 has two long sides along at least part of the length of the vehicle 102 (parallel to the X-axis) and two shorter sides along at least part of the width of the vehicle (parallel to the Z-axis) as shown. In some embodiments, the long sides of the frame 118 extend along axes substantially parallel with an axis extending from the front to the back of the vehicle 102 (parallel to the X-axis). In some embodiments, the battery bay 108 is located under the vehicle floor boards, between the rear and front axles of the vehicle 102.

[0091] In some embodiments, the cavity 302 into which the battery bay 108 is inserted uses existing volumes which are normally occupied by the fuel tank and muffler in a traditional gasoline or hybrid vehicle. In such a manner, the storage and/or passenger volume is not substantially impacted by the addition of the battery pack 104. In some embodiments, the vehicle body floor structure is shaped as a basin to accommodate the battery pack. The location of the battery bay 108 at or near the bottom of the vehicle lowers the vehicle's center of mass or gravity, when the battery pack 104 is coupled to the vehicle, which improves the cornering, road-holding, and performance of the vehicle. In some embodiments, the battery bay 108 is located within zones of the vehicle that are designed to not buckle during front or rear collisions to protect the battery pack 104.

[0092] In some embodiments, the battery bay 108 is a self-contained unit. In some embodiments, the battery bay structural connections to the vehicle frame (or unibody) are made through flexible vibration dampers (not shown). This allows the battery bay 108 to not interfere with the natural bending and torsion deflection of the vehicle frame. In some embodiments, the connections to the vehicle frame are made using removable fasteners such as bolts. In other embodiments the battery bay 104 is substantially permanently mounted to the vehicle by welding or other means.

[0093] The battery bay 108 is designed to withstand the load factors required by an original equipment manufacturer, national safety standards, or international safety standards. In some embodiments, the battery bay 108 is designed to withstand the following load factors:

[0094] Normal Operating Conditions: $\pm 1.5 G F_x$ and F_z , and $\pm 4 G F_y$, which may be substantially continu-

ously oscillating at 1-100 Hz, where F_x , F_y , and F_z are the forces in the X, Y, and Z directions respectively. In some embodiments, at this condition substantially no plastic deformation of the battery bay 108 will occur.

[0095] Exceptional Operating Conditions: $\pm 12 G F_x$ and F_z , and $\pm 8 G F_y$, which are not substantially continuously oscillating. In some embodiments, at these conditions substantially no plastic deformation of the battery bay 108 will occur.

[0096] Crash Conditions: $\pm 30 G$ in F_x and F_z , and $\pm 20 G F_y$.

[0097] In some embodiments, during Normal and Exceptional Operating Conditions, the battery pack 104 does not substantially rock, rattle, or otherwise move.

[0098] In some embodiments, the mechanical connection between the battery bay 108 and the vehicle frame is provided during the assembly of the vehicle 102. In other words, the battery bay 108 is a separate unit configured to attach to the at least partially electric vehicle 102. In some embodiments, the separate unit style battery bay 108 is retrofitted to a hybrid or internal combustion engine vehicle either before or after market. In other embodiments, the design of the battery bay 108 is formed integrally with a frame of the vehicle 102.

[0099] FIG. 4 is a perspective view of an embodiment of the battery pack 104. In some embodiments, the battery pack 104 has a height (h or H) substantially less than its length (L). In some embodiments, the battery 104 has a first portion 401 being substantially long and flat and a second portion 402 being shorter and thicker than the first portion, i.e., the first portion 401 has a height (h) significantly less than the height (H) of the second portion 402. In some embodiments, the second portion 402 has a greater height (H) as it is configured to fit under or behind the rear passenger seats or in a portion of the trunk, and as such does not significantly impact the passenger space inside the electric vehicle. In some embodiments, the volume of the battery pack 104 is 200 to 300 liters. In some embodiments, the weight of the battery pack 104 is 200-300 kg.

[0100] In some embodiments, the battery pack 104 is an at least partially sealed enclosure which is built to substantially enclose and absorb an explosion of battery cells/chemical modules (502, FIG. 5) within the battery pack. The sealed enclosure of the battery pack 104 is made of materials that are able to substantially withstand damage caused by dust, dirt, mud, water, ice, and the impact of small rigid objects. Suitable materials include some plastics, carbon fibers, metals, or polymers, etc. In some embodiments, an external cover on the battery pack 104 protects and insulates the internal components of the battery from harsh environmental conditions and penetration of moisture or fuel vapors.

[0101] In some embodiments, a battery management system (BMS) 406 in the battery pack 104 manages the charging and the discharging cycles of the battery pack. The BMS 406 communicates with the vehicle onboard computer to report on the battery's state of charge and to alert of any hazardous operating conditions. In some embodiments, during charging, the BMS 406 communicates with the battery charge station 132. In some embodiments, the BMS 406 can communicate with the vehicle onboard computer via a 9-pin connector. The number of pins in the connector varies depending on the connector design. In some embodiments, the BMS 406 is able to arm and disarm the electric power connector between the battery pack 104 and the vehicle 102 by cutting the current to the connector using a switching device located

in the battery pack **104**. In some embodiments, the BMS **406** handles substantially all aspects of battery safety issues during charging, operation and storage.

[0102] FIG. **5** is a perspective view of the battery pack **104** with the battery pack chemical modules **502** that receive, store, and discharge electric energy. The modules **502** are housed within a battery pack housing **504**. These chemical modules **502** are sometimes referred to herein as rechargeable battery cells **502**. In some embodiments, a plurality of chemical modules **502** are disposed within the battery pack **104**. In other embodiments, at least one chemical module **502** is used. In most embodiments, each chemical module **502** is rechargeable but there may be instances where a one time use emergency battery could be used. The chemical modules **502** are re-charged as a group at either a charge station **132** or at a charging portion of a battery exchange station **134**, based on parameters set and controlled by the BMS.

[0103] FIG. **6** is a perspective view of an embodiment wherein the battery pack **104** includes a cooling system which dissipates heat from the battery pack **104**. In some embodiments, a portion of the battery pack's housing **504** includes a heat exchange mechanism with at least a portion thereof exposed to ambient air at the underside of the vehicle **102** when the battery pack **104** is attached to the vehicle. In some embodiments, the heat is conducted from the modules **502** to a heat exchanger or heat sink at the bottom section of the battery pack. In some embodiments, the cooling system includes openings **404** in the external cover, which fluidly communicate with one or more cooling ducts **602** that direct ram air flow past the battery to further dissipate heat generated by the battery. In some embodiments, the cooling ducts **602** run the entire length of the battery pack **104** while in other embodiments the ducts take any appropriate path to best cool the modules **502**. In some embodiments, the cooling ducts **602** direct air through heat exchangers which dissipate heat from the battery pack modules. In some embodiments, the cooling ducts **602** also include cooling fins **604** therein. In some embodiments, air cooling is accomplished by electric fans. In some embodiments, the inlet **404** comprises a scoop **606** for directing ram air through the ducts **602** while the vehicle is in motion. In some embodiments, the scoop **606** contains a mesh cover **608** for preventing debris from entering the cooling ducts **602**.

[0104] FIG. **7** is a perspective view of the battery pack **104** and battery bay frame as viewed from the underside of the battery pack. In some embodiments, the battery pack **104** includes another cooling system made up of dimples or cavities **702**. The dimples/cavities **702** are located in the bottom surface of the battery pack **104**, which runs along the bottom of the vehicle, to be exposed to air passing over them when the vehicle **102** is in motion. Even when the vehicle is stopped, heat generated by the battery is dissipated due to its large surface area and shaded location on the underside of the vehicle. The dimples/cavities **702** increase the overall surface area of the bottom of the battery pack, which further helps to cool the modules **502**. In some embodiments, the increased surface area is sufficient for cooling, and ducts and/or heat exchangers are not necessary. In some embodiments, this increased surface area is used in conjunction with one or more of the previously described cooling mechanisms (such as the cooling ducts with fins described in FIG. **6**, or the heat sink and heat exchanger also described above.)

[0105] In some embodiments, battery pack cooling systems, such as those described above in relation to FIGS. **6** and

7, are capable of dissipating a majority of the heat generated during full power operation and/or during the charging process. In some embodiments, the cooling systems are capable of dissipating 3 KW of heat. The exact amount of heat emitted from the battery varies from one design to another. In some embodiments, the heat from the cooling systems described above is substantially emitted to the environment rather than to other parts of the vehicle **102**.

[0106] FIG. **7** also shows an embodiment with a plurality of pilot holes **704** on the underside of the battery pack **104**. These pilot holes **704** mate with locating pins on an exchange device platform discussed in application No. 61/166,239 (filed Apr. 2, 2009, entitled Battery Exchange Station and incorporated herein) to help properly align the exchange device platform with the battery pack **104**. In some embodiments, one pilot hole is present. In other embodiments, two or more pilot holes are present. The embodiment of FIG. **7** shows pilot holes on either side of every striker on the battery. In some embodiments, the pilot holes **704** exist in the frame of the battery bay rather than the battery, and function substantially the same, i.e., to facilitate proper alignment of the exchange platform during a battery exchange operation.

[0107] FIG. **8** is a perspective view of another embodiment a battery pack **806**. The battery pack **806** has a first portion **401** being substantially long and flat; a second portion **402** being shorter and thicker than the first portion; and a third portion **403** of the battery pack **104** being long and thin and running substantially the length of the first portion **401** with a height larger than the first portion **401** but smaller than or equal to the height of the second portion **402**. The third portion **403** of the battery **104** protrudes in the Y-direction from the first portion **401** along a central axis in the X-direction formed between the driver and passenger seats, as shown. Still other embodiments (not shown) have a substantially cuboid shape, without two differently shaped portions. Other embodiments may have more complex shapes. For example, some embodiments are taller than they are wide. Embodiments of this general shape are sometimes located behind a passenger space, rather than underneath it.

[0108] In some embodiments, the battery pack **104** includes one or more pins **802** to align the battery **104** with the battery bay **108** of the vehicle **102**. The pins **802** may also be used to prevent the battery pack from being inserted in the battery bay **108** in the wrong direction. For example, the pins at the battery and corresponding openings in the battery bay may be keyed to one another.

[0109] In some embodiments, the battery pack housing **504** further comprises bar shaped strikers **1924**, which are firmly attached to the battery pack housing and configured to carry the entire weight of the battery pack **104**, i.e., the battery pack can be suspended from the strikers **1924** when they are engaged with latches **1920** (FIG. **19A**) on the battery bay **108**. All versions of the battery pack **104** also contain an electrical connector **804** (discussed below in relation to FIG. **9**), for quickly and safely connecting and disconnecting the battery pack **104** to and from the vehicle **102**. In some embodiments the electrical connector **804** is located on the third portion **403** of the battery **104**, but in other embodiments, it may be located anywhere on the pack.

[0110] FIG. **9** is a detailed perspective view of the electrical connection system **900**. This figure shows both the battery electrical connector **804** as well as the corresponding battery bay electrical connector **902** which mate together to form the electrical connection system **900**. The battery electrical con-

connector **804** is attached to the battery pack **104** by means of a base unit **916**. Similar attachment mechanisms are used to attach the battery bay electrical connector **902** to the frame **118** of the battery bay **108** or to the electric vehicle **102** directly. In some embodiments, the electrical interface between the battery bay **108** and the battery pack **104** (i.e. the connection between the bay electrical connector **902** and the battery pack electrical connector **804**) allows for quick connect/disconnection between the pack and the bay or vehicle.

[0111] Both connectors also include electric shields **904** to shield the electro-magnetic forces of the connections from interfering with the chemical modules/battery cells **502**. The electric shield may be grounded. In some embodiments, the electric shield **904** also comprises an O-ring **913** to prevent moisture and debris from fouling the electrical connectors and causing electrical shorts and/or fires. The alignment between the bay electrical connector **902** and the battery pack electrical connector **804** is facilitated by one or more tapered alignment pins **912** and corresponding alignment receptacles or sockets **914**. In some embodiments, the alignment pins **912** are on the battery pack electrical connector **804** while the alignment sockets/receptacles **914** are on the bay electrical connector **902**. In other embodiments, the arrangement is transposed. In some embodiments, the pins **912** are keyed to one another to prevent inappropriate mating of the electrical connectors.

[0112] In some embodiments, the electric connections between the battery bay **108** and the battery pack **104** have two separate groups of connectors. The first group of connectors is for power (approximately 400 VDC, 200 Amp) to and from the battery pack **104**. The second group of connectors **910** is for data communications (5-12V, low current.) In some embodiments, the connector has 9 pins. In other embodiments the connector will have more or fewer pins than 9.

[0113] In some embodiments, the first group of connectors includes a first pair of connectors **906** for power to the battery pack **104** from a charging mechanism. In some embodiments, the charging mechanism is a stand alone charging station **132** that connects to the vehicle **102** and charges the battery pack **104** while it is still coupled to the vehicle (as shown in FIG. 1). In some embodiments, the charging mechanism is incorporated into a portion of the battery exchange station (**134**, FIG. 1), where the depleted/discharged battery pack **104** that has been removed from a vehicle **102** is charged again before being inserted into a vehicle. In some embodiments, the first group of connectors also includes a second pair of connectors **908** to provide power from the battery pack **104** to the electric motor **103**.

[0114] In some embodiments, the battery electrical connector **804** as well as the corresponding battery bay electrical connector **902** mate together as a result of the translation of the battery pack **104** into the battery bay **108**. Both the battery electrical connector **804** as well as the corresponding battery bay electrical connector **902** have some flotation, i.e., they can travel a few millimeters to the left and right. The male connector (battery bay electrical connector **902** in this embodiment) has alignment pins **912** which penetrate into sockets **914** in the female connector (the battery electrical connector **804** in this embodiment). The connection between the pins **912** and the sockets **914** and this aligns the two parts of the electrical connection system **900** during the translation of the battery pack **104** to its final position in the battery bay **108**. The flotation of the two parts of the electrical connection

system **900** allows some misalignments (due to production and assembly tolerances) of the two connector parts.

[0115] In some embodiments, the electrical connectors **906**, **908**, and **910** in the electrical connection system **900** align and connect themselves automatically only after the mechanical connections (i.e., the locking of the battery pack **104** into the battery bay **108** by means of the latch mechanisms **1016**, **1018** in the transmission assembly **1000**, described in FIGS. 10 and 19) have been established.

[0116] FIG. 10 is a perspective top side view of one embodiment of the battery pack **104** connected to the battery bay **108**. In this embodiment the battery pack **104** and battery bay **108** are substantially cuboid/rectangular parallelepiped in shape. This embodiment includes a battery electrical connector **1022** being on one side of the first portion **401**.

[0117] In some embodiments, the battery bay **108** includes a battery bay transmission assembly **1000**. The transmission assembly **1000** is a grouping of gears, rotating shafts, and associated parts that transmit power from a drive motor **1310** or alternatively from an external/manual rotation source (such as the wrench received within a drive socket **1308** shown in FIG. 13). The latch mechanisms **1016**, **1018** as will be explained in detail below with regard to FIG. 19.

[0118] In some embodiments, the transmission assembly **1000** includes a first gear set **1002** (such as a miter gear set) which drives a first gear shaft **1004** and a second gear shaft **1006** in opposite directions. The rotational force about the Y-axis by the drive motor **1310** or manual rotation is translated by the first gear set **1002** into equal and opposite rotational forces of the gear shafts **1004**, **1006** about the X-axis. The first gear shaft **1004** is attached to a second gear set **1008** (such as a first worm gear set). The second gear shaft **1006** is attached to a third gear set **1010** (such as a second worm gear set). The second and third gear sets **1008**, **1010**, which are discussed in more detail below with respect to FIG. 12, connect each gear shaft **1004**, **1006** to respective torque bars **1012**, **1014** which permits the power flow to turn a corner around the battery bay. In other words, the rotational force of the gear shaft **1004** about the X-axis is translated by the gear set **1008** into a rotational force of torque bar **1012** about the Z₁-axis, while at the same time the rotational force of gear shaft **1006** about the X-axis (in an equal and opposite direction to that of gear shaft **1004**) is translated by gear set **1010** into a rotational force of torque bar **1014** about the Z₂-axis (in an equal and opposite direction to the rotation of torque bar **1012**.) By this means, the transmission assembly **1000** drives the torque bars **1012**, **1014** to substantially simultaneously rotate in equal but opposite directions.

[0119] In some embodiments, the torque bars **1012**, **1014** and gear shafts **1004**, **1006** are at right angles to one another respectively. In some embodiments, the torque bars **1012**, **1014** and gear shafts **1004**, **1006** form an obtuse angle with each other, and in further embodiments they form an acute angle with one another. In this embodiment second gear set **1008** connects the first gear shaft **1004** to the first torque bar **1012**, and the third gear set **1010** connects the second gear shaft **1006** to the second torque bar **1014**. As such, in some embodiments, the first gear shaft **1004** and the second gear shaft **1006** substantially simultaneously rotate in opposite directions causing the first torque bar **1012** and the second torque bar **1014** to substantially simultaneously rotate in opposite directions via the second gear set **1008** and third gear set **1010**.

[0120] The embodiment shown in FIG. 10 shows two latch mechanisms 1016, 1018 attached to each torque bar 1012, 1014. These latches 1016, 1018 hold the battery pack 104 at least partially inside the battery bay 108 during normal operation of the vehicle.

[0121] Some embodiments include one or more first latches 1016 coupled to the first torque bar 1012 and one or more second/additional latches 1018 coupled to the second torque bar 1014. The first torque bar 1012 is configured to actuate the first latch mechanism(s) 1016, whereas the second torque bar 1014 is configured to actuate the second latch mechanism(s) 1018. When more than one of the first latches 1016 or second latches 1018 are attached to each torque bar 1012, 1014 the torque bar ensures that the plurality of latches actuated and thus rotating substantially simultaneously with each other.

[0122] At least one latch lock mechanism 1020 prevents the latches 1016, 1018 from releasing the battery 104 from the battery bay 108 until the lock is disengaged as described in more detail in relation to FIG. 20. In some embodiments, only one latch lock mechanism 1020 is used, while in other embodiments at least one latch lock mechanism 1020 is attached to each torque bar 1012, 1014. In some embodiments, the latch lock 1020 is electronically activated, while in other embodiments it is mechanically activated.

[0123] In some embodiments, the first torque bar 1012 is located at a side of the battery bay 108 nearest to the front end of the vehicle 102, and the second torque bar 1014 is located at a side of the battery bay 108 nearest to the rear of the vehicle, or the arrangement may be transposed. The gear sets and mechanisms of the transmission assembly may be located anywhere so long as the torque bars 1012, 1014 are driven in opposite directions simultaneously at the same angular velocity to actuate the latch mechanisms 1016, 1018.

[0124] FIG. 11 is a perspective view of another embodiment of a battery bay 108. This embodiment also includes a first gear set 1002 (such as miter gear set) that drives a first gear shaft 1004 and a second gear shaft 1006 in opposite directions. In this embodiment, however, the battery bay's frame is not rectangular in shape. Instead, along one side of the battery bay 108, the second gear shaft 1006 is made up of three portions, a first gear shaft link 1102 connected by a first universal joint 1104 to a second gear shaft link 1106, and a third gear shaft link 1108 connected by a second universal joint 1110 to a third gear shaft link 1112. In this manner the first gear shaft 1006 is bent to accommodate for other components of the electric vehicle 102. As such, the battery bay 108 cavity has a smaller volume than it would have were the first gear shaft 1006 a single straight component extending from the first gear set 1002.

[0125] FIG. 11 also shows a lock synchronization bar 1112 in the transmission assembly 1000 which is located near each torque bar 1012 (FIG. 10), 1014. Each lock synchronization bar 1112 is attached to a latch lock mechanism 1020 to keep its respective latch mechanisms 1016, 1018 from releasing, as will be explained in detail below with respect to FIG. 20. FIG. 11 also shows springs 1806 in the latch mechanisms 1016, 1018 which are located on either side of the latch 1920 as explained in more detail in FIG. 18.

[0126] It should be noted that while various forms of shafts and gear sets have been described above, in other embodiments the driving torque can be transmitted to the latches by using other types of drive components such as belts, pulleys, sprockets drive chains.

[0127] FIG. 12 shows one embodiment of the second and third gear sets 1008, 1010. In some embodiments the gear sets 1008, 1010 are each made up of a helical gear 1202 and a spur gear 1204. In some embodiments, the helical gear 1202 is a worm gear. In operation, the rotation of the helical gear 1202, which is connected to the gear shafts 1004, 1006, rotates the corresponding torque bar 1012, 1014 by means of interlocking teeth on the helical gears 1210 and spur gear 1204. The precise number and configuration of teeth on the helical gear 1210 and the spur gear 1204 varies depending on the particular electric vehicle 102. For example, in some embodiments the helical gear 1202 is significantly longer and has more threading, while in some embodiments, the spur gear 1204 gear has more teeth, or forms a complete circle. In other embodiments the diameter of the helical gear 1202 is larger than the proportions shown in FIG. 12. In normal operation, the helical gear 1202 turns the spur gear 1204 in one direction to engage the latch mechanisms 1016, 1018 by which the battery 104 is lifted and locked into the battery bay 108, and the helical gear 1202 turns the spur gear 1204 in the opposite direction to disengage the latch mechanisms 1016, 1018 and allow the battery 104 to be removed from the battery bay 108.

[0128] FIG. 13 shows a detailed view of one embodiment of the first gear set 1002. In some embodiments, the first gear set 1002 is a miter gear set. In some embodiments, the miter gear set 1002 comprises three helical bevel gears; including a central gear 1302 coupled to a first outer gear 1304 and a second outer gear 1306. As the central gear 1302 rotates it drives the first outer gear 1304 in a first rotational direction and the second outer gear 1306 in a second rotational direction opposite of the first rotational direction. The first outer gear 1304 drives the first gear shaft 1004, while the second outer gear 1306 drives the second gear shaft 1006. As such, the rotation of the central gear 1302 drives the first gear shaft 1004 in a first rotational direction by means of the first outer gear 1304 while simultaneously/synchronously driving the second gear shaft 1006 in a second rotational direction by means of the second outer gear 1306. In some embodiments, the first gear set 1002, specifically the central gear 1302 is driven by the rotation of a drive socket 1308 located at the underside of the electric vehicle 102. To turn the gear 1308, the shaft is mechanically rotated, such as by an Allen or socket wrench 1314 configured to mate with the drive socket 1308. In some embodiments, the female drive socket 1308 has an unusual or non-standard shape such that it can only receive a particular shaped Allen or socket wrench 1314 made to mate with the non-standard shaped drive socket 1308.

[0129] In some embodiments, the transmission assembly 1000 is driven by an electric drive motor 1310 through the drive motor gear ratio set 1312. The gear ratio set 1312 drives the first gear set 1302, which drives the first gear shaft 1004 and the second gear shaft 1006 simultaneously in opposite directions to eventually simultaneously actuate the latch mechanisms 1016, 1018 as described above with relation to FIG. 10. In some embodiments, the drive motor 1310 is used in most circumstances to rotate the shafts 1004, 1006, while the drive socket 1308 is only used for manual override situations. In some embodiments, the drive socket 1308 is the preferred means for driving the first gear set 1002.

[0130] As shown in FIGS. 23A and 23B, in some embodiments, the transmission assembly 1000 encompasses a second gear set 1008 which is a right worm gear set and third gear set 1010 which is a left worm gear set. When right gear set 1008 and the left worm gear set 1010 are used in the trans-

mission assembly **1000**, the first gear shaft **1004** and the second gear shaft **1006** need not be driven to rotate in opposite directions about the X-axis. Instead, the torque bar **1012** is driven about the Z_1 -axis and torque bar **1014** is driven about the Z_2 -axis (in an equal or opposite direction to the rotation of torque bar **1012**) by means of the opposite threading on the right and left worm gears (**1008**, **1010**). In other words, the pitch of the threading on the right worm gear **1008** is opposite to the pitch of the threading on the left worm gear **1010**. As such, the first gear set **1002** need not be a miter gear set as shown in FIG. 13, but is instead a simpler gear set shown in FIG. 23B. In other words, because the right and left worm gears **1008**, **1010** translate the motion of the first gear set **1008** in directions opposite from one another due to their opposing thread pitch, the shafts **1004**, **1006** can rotate the same direction, and a complex miter gear set is not needed at the point of actuation of the shafts **1004**, **1006**.

[0131] FIG. 14 shows a bottom perspective view of another embodiment of the drive socket **1308** as viewed from the underside of the at least partially electric vehicle **102**. In some embodiments, the drive socket **1308** is accessible through a hole in the battery pack housing **1400**. In other embodiments, the drive socket **1308** is accessible at the side of the cavity **302** in the battery bay **108**. In some embodiments, the first gear set **1002** is driven by the socket wrench **1314** only after a key **1602** has been inserted into a key hole **1402** and unlocks the first gear set **1002** as described in FIG. 17. Like the drive socket **1308**, in this embodiment, the key hole **1402** is also located at the underside of the electric vehicle **102** and requires a hole in the battery housing **1400**. In other embodiments, the key hole **1402** is in the battery bay **108**.

[0132] FIG. 15 is a perspective view of one embodiment of a first gear lock **1502** (which in some embodiments is the miter gear lock). In this embodiment, when a key is inserted into the key hole **1402**, as depicted by the arrow in the figure, the first gear lock **1502** rotates upward and disengages from a small gear on the shaft **1004** and thus is unlocked. Then, the first gear set **1002** can then perform its function of rotating the central gear **1302**, which drives the first gear shaft **1004** in a first rotational direction by means of the first outer gear **1304** while simultaneously driving the second gear shaft **1006** in a second rotational direction (opposite the first rotational direction) by means of the second outer gear **1306**. When the key is removed the first gear lock **1502** rotates downward and engages the small gear on the shaft **1004** and thus locks it. In the embodiment shown in FIG. 15, the electric drive motor **1310** of the transmission assembly **1000** is located above the first gear set **1002**, and as such does not require a drive motor gear set **1312** as described in FIG. 13.

[0133] FIG. 16 is a perspective view of a second embodiment of the gear lock **1600**. In this figure the key **1602** is shown outside of the key hole **1402**. In some embodiments, the key hole **1402** is located close to the drive socket **1308**. In some embodiments, the key **1602** has a specific and unconventional shape for mechanically releasing the second embodiment of the gear lock **1600**, explained in more detail below, while avoiding other components of the first gear set **1002**.

[0134] FIG. 17 is a detailed view of the key **1602** inserted into the key hole **1402** and releasing the first gear lock **1502**. In FIG. 17, the first gear lock **1502** is positioned in-between the motor **1310** and the gear set **1312**. In some embodiments, the key **1602** unlocks the first gear lock **1502** by pushing a locking latch **1702** with a locking tooth **1704** away from a

locking gear **1706**. In some embodiments, the locking latch **1702** is designed to be biased into its locked position, i.e., mated with the locking gear **106**, as soon as the key **1602** is removed. In some embodiments, a spring **1708** is attached to the locking latch **1702** to provide the biasing force, while in other embodiments gravity or other mechanisms for biasing the locking latch **1702** may be used. In some embodiments, the key **1602** remains in the inserted position throughout the battery exchange process. In other embodiments the key **1602** is only required to originally unlock the first gear lock **1502**, but is not required to remain in place throughout the battery exchange process.

[0135] In all of the embodiments of the key **1602** and first gear lock **1502**, like those shown in FIGS. 15-17, the first gear set **1002** is kept from rotating until the key **1602** unlocks the gear lock **1502**. As such, the shafts **1004**, **1006**, torque bars **1012**, **1014**, and their corresponding latch mechanisms **1016**, **1018** will not turn unless the gear lock **1502** has been unlocked. Furthermore, in some embodiments, a latch lock mechanism **1020** (described in relation to FIG. 20) must also be unlocked before the process to actuate the latch mechanisms **1016**, **1018** can begin. In some embodiments, the latch lock mechanism and the gear lock **1502** are independent of one another, and are individually/independently released before the transmission assembly **1000** can be actuated. In some embodiments, the latch lock mechanism **1020** is electrically actuated, and the gear lock **1502** is mechanically activated or vice versa. Activating the two different locks by two separate mechanisms (mechanical and electrical) prevents unauthorized or inadvertent removal of the battery pack **104** from the vehicle **102**. Furthermore, in some embodiments, all of the locks are equipped with indicators which indicate possible failure before, during, or after the battery exchange process.

[0136] An actuator located on board the vehicle **102** actuates one or both of the above described locks. In some embodiments, the actuator is operated by a single 5V 15 mA digital signal, which is sent from an onboard computer system on the vehicle. In some embodiments, the actuator is protected against excessive power flow by indicators. In some embodiments, other types of mechanical or electro-mechanical actuators may be used to remove the safety locks.

[0137] FIG. 18 shows a battery bay **108** with several alignment sockets/holes **1802** configured to receive tapered alignment pins **802** disposed on the battery **104**. This figure shows an embodiment with two alignment sockets **1802** and alignment pins **802**, but in some embodiments, only one alignment socket **1802** and pin **802** are used. In some embodiments, the aligned pins **802** and the alignment holes have keyed shapes different from one another to prevent backwards or incorrect alignment of the battery pack **104** with the battery bay **108**. In some embodiments, at least one compression spring **1806** is mounted to the battery bay **108**. The compression springs **1806** are configured to generate a force between the frame **118** battery bay **108** and the battery pack **104** when the battery pack **104** is held and locked at least partially within the cavity **302** of the battery bay **108**. Thus, the springs **1806** absorb vertical motion (Y-axis motion) of the battery pack **104** and bay **108** during driving or other operations. Also, the compression springs **1806** help maintain the latches **1920** in contact with the strikers **1924** on the battery locked position, and also help expel the battery **104** from the battery bay **108** when the locks are unlocked. FIG. 18 shows compression springs **1806** on either side of each latch **1920**. Matching compression

springs **1806** on either side of the latches balance each other such that the resulting force on the battery is substantially in a vertical (Y-axis) direction only. Other embodiments use greater or fewer compression springs **1806**. In some embodiments, other types of flexible mechanical parts are used to preload the latches. For example, rubber seals are used instead of the springs **1806**.

[0138] FIG. **18** shows an embodiment having three strikers **1924**. The strikers in FIG. **18** are not bar shaped, as they are shown in other figures, but instead are rounded cut away portions in the frame **118** of the battery pack **104** itself. Other embodiments employ non-bar shaped strikers as well. In some embodiments, the strikers have different forms. In some embodiments, the strikers contain low friction solutions. Examples of low friction solutions include but are not limited to roller bearings or low friction coatings, as shown in FIG. **19A**, element **1930**.

[0139] FIG. **19A** shows one embodiment of a latch mechanism **1016**, **1018** used by the battery bay transmission assembly **1000**. In this embodiment, the latch mechanism **1016**, **1018** is a four bar linkage mechanism. The latch mechanism **1016**, **1018** comprises a latch housing **1902** which is rigidly attached to the frame of the battery bay. It also comprises a cam shaped input link **1904** rigidly coupled to a respective torque bar at first a pivot point **1906** such that the input link **1904** rotates/pivots together with a torque bar **1012**, **1014** around the first pivot point **1906** with respect to the stationary latch housing **1902**. The end of the input link **1904** remote from the torque bar is rotatably coupled at second pivot point **1908** to a first rod end **1912** of a coupler link rod **1910**. The coupler link rod **1910** has a second rod end **1914** remote from the first rod end **1912** that is pivotably coupled to a latch **1920** at a third pivot point **1918**. In some embodiments, the coupler link rod **1910** is a turnbuckle which includes an adjustment bolt **1916** configured to adjust the length of the coupler link rod **1910**. The latch **1920** has a fourth pivot point **1922** pivotably connected to another portion of the latch housing **1902**. The latch **1920** pivots about an axis, running through the center of the fourth pivot point **1922**. In some embodiments, the axis about which the latch pivots at the fourth pivot point **1922** is parallel but distinct from the axis about which the torque bar **1012**, **1014** rotates at the first pivot point **1906**. The latch is substantially "V" or hook shaped with the third pivot point **1918** at the apex of the "V." The fourth pivot point **1922** is at an end of the "V" remote from the apex (this end shall be called herein the latch's proximate end **1926**). The other end of the "V" is also remote from the apex of the "V" (this other end shall be called the latch's distal end **1928**). The distal end **1928** of the latch is configured to engage the bar shaped striker **1924** on the battery pack **104**. In some embodiments, the distal end **1928** of the latch **1920** has a hook shape, as shown in FIG. **19A**, which is configured to cradle the striker **1924** when engaged with the striker (as shown in FIG. **19C**). The hook shaped distal end **1928** is also useful in engaging and lifting the battery pack **104**, at least partially, into the cavity of the battery bay **108** (FIG. **3**) when engaging/receiving the battery. The striker **1924** may have a low friction element such as a roller bearings or low friction coating **1930**.

[0140] As shown in FIG. **19A**, when the input link **1904** is in a released position, the latch **1920** is configured to mechanically disengage from a corresponding striker **1924** on the battery pack **104**. In other words, when the input link **1904** is in a released position, the latch **1920** does not contact

the striker **1924**. The input link **1904** is driven/rotated, by means of the torque bar **1012**, **1014** connected to it.

[0141] FIG. **19B** shows an intermediate position where the input link **1904** has rotated such that the latch **1920** begins to engage the striker **1924** on the battery pack **104** and begins lifting the battery pack **104**, at least slightly into the cavity of the battery bay **108** (FIG. **3**).

[0142] As shown in FIG. **19C**, when the input link **1904** is in a fully engaged position, striker **1924** is cradled in the hook shaped distal end **1928** of the latch **1920**, and the input link **1904** and coupler link rod **1910** are in a geometric lock configuration. The geometric lock is the position in which the input link **1904** and the coupler link rod **1910** are in vertical alignment with one another with the coupler link rod **1901** in its fully extended position. In other words, the input link **1904**, coupler link rod **1901**, and first **1906**, second **1908**, and third **1918** pivot points are all substantially along the same axis. As such, any movement of the battery pack **104** is converted into compression or tensile forces along the single axis to the stationary latch housing **1902** without rotating any of the pivot points. Because the input link **1904** and coupler link rod **1910** are in a geometric lock they prevent the battery **104** from being released from the battery bay **108**, such as while the vehicle **102** is driving. Furthermore, in the geometric lock position, only minimal loads are transferred from the battery pack **104** to the drive components of the vehicle **102**.

[0143] In some embodiments, (a) releasing and (b) engaging are done as follows. The (a) releasing a battery pack **104** from the battery bay **108** is performed by means of the transmission assembly **1000** by rotating the latch(s) **1920** on the battery bay **108** to disengage the striker(s) **1924** on the battery pack **104**, and (b) engaging a new battery pack **104** in the battery bay **108** is done by means of the transmission assembly **1000** rotating the latch(s) **1920** on the battery bay **108** to engage, lift, and lock the striker(s) **1924** on the battery pack **104**. In some embodiments, the (a) releasing occurs in less than one minute. In some embodiments, the (b) engaging happened in less than one minute. In some embodiments, both the (a) releasing of the first battery pack **104** from the battery bay **108** and the (b) engaging of a second battery pack **104** in the battery bay **108** occur in less than one minute.

[0144] In some embodiments, a latch position indicator is utilized to measure whether the latch **1920** is in an engaged or disengaged position. In some embodiments, the latch position indicator communicates the position of the latch **1920** to a computer system in the electric vehicle **102**. In some embodiments, other indicators are used throughout the battery pack **104** and battery bay **108** to verify the workings of any or all of the following elements: the first gear lock **1502**, the latch lock mechanism **1020**, the latch mechanism **1016**, **1018**, the miter gear set **1002**, the torque bars **1010**, **1012**, the gear shafts **1004**, **1006**, the electrical connector **804**, and the position of the battery pack **104** inside the battery bay **108**. In some embodiments, the indicators include switches, Hall sensors, and/or micro-switches. In some embodiments, the alignment devices (such as alignment pins **802** and latch mechanisms **1016**, **1018**) and position indicators allow the battery pack **104** to be precisely monitored and positioned inside the battery bay **108** in six different degrees of freedom (3 degrees of translation and 3 degrees of rotation.)

[0145] In some embodiments, the battery bay have some or all of the following internal electric indications: a) proper/improper connection of the electrical connectors between the battery bay and the battery pack; b) open/close indication on

each of the individual latches which fasten the battery pack to the battery bay; c) open/close indication on each of the safety lock devices; d) existence/non existence of the unique key like device which is mentioned in section 14; e) in-position/out-of-position of battery pack inside the battery bay in at least three different locations around the battery pack; f) excessive/in-excessive temperature measurement in two different locations within the battery bay. (Excessive temperature may be a temperature above 90° C.); and g) excessive/in-excessive power limits in the quick release actuator.

[0146] FIG. 20 is a detailed view of the latch lock mechanism 1020. When the latch mechanism 1016, 1018 is in its lock configuration, with the latch 1920 engaging the striker 1924, the latch lock mechanism 1020 will also be engaged. The latch lock mechanism 1020 is configured to prevent the latch mechanism 1016, 1018 from rotating when engaged. In some embodiments, the latch lock mechanism 1020 comprises a toothed cantilevered lock arm (2002) (also called a lock bolt) configured to engage a corresponding tooth 2010 on the latch 1920. As such, the toothed cantilevered lock arm 2002 is configured to prevent the latch 1920 from rotating when engaged. The toothed cantilevered lock arm 2002 is coupled to a lock synchronization bar 2004, which is configured to disengage the toothed cantilevered lock arm 2002 when rotated. The lock synchronization bar 2004 is also coupled to a lock actuator 2006, which is configured to rotate the synchronization bar 2004. In some embodiments, the lock actuator 2006 includes an electric motor 2008 that rotates the lock synchronization bar 2004 via a gear set or any other suitable mechanism. In some embodiments, the electric motor 2008 is activated by an electric lock or unlock signal. In other embodiments, latch lock mechanism is mechanically activated. In some embodiments, both electrical and mechanical activation is provided, the mechanical activation being useful if any electronic malfunctions occur. In some embodiments, the latch lock mechanism 1020 is configured to disengage only after the gear lock 1502 (shown in FIG. 15) has been released.

[0147] The lock synchronization bar 2004 is configured to rotate one or more latch locks 2002 in a first direction so that the one or more latch locks 1920 engage with the latch 1920. The lock synchronization bar 2004 is also configured to rotate the one or more latch locks 2002 in a second, opposite, direction to disengage the latch locks 2002 from the latch 1920. As such, after the latch locks have been rotated in a second direction, to unlock the latch 1920, the latch is allowed to disengage the striker 1924 by means of the torque bar 1012, 1014 rotation through the four bar linkage latch mechanism 1016, 1018 described above.

[0148] By means of the mechanisms described above, the miter gear set 1002, driven by the electric drive motor 1310, causes the latches 1016, 1018 to rotate opposite one another. When the latches 1016, 1018 on either side of the battery bay 108 rotate away from each other, they release the corresponding strikers 1924 on the battery 104.

[0149] FIG. 21 is a flow diagram of a process for releasing a battery pack from a battery bay. In some embodiments, the release process happens as follows. A first latch mechanism, the miter gear lock 1502, is which physically released (2102). In some embodiments, the physical release happens by means of a key 1602 inserted into the key hole 1402 (2104). A second latch mechanism, the latch lock mechanism 1020, releases the one or more latches 1016, 1018 (2106). In some embodiments, the latch lock unlocks when an electric motor 2008,

activated by an electronic unlock signal, actuates the lock actuator 2006 which rotates the latch lock 2002 and disengage its tooth from the tooth of the latch 1920 by rotating the lock synchronization bar 2004 (2108). Once both the miter gear lock and the latch lock have been released, the battery 104 is released from the battery bay 108 as follows. The drive motor 1310 actuates a transmission assembly (2110). In some embodiments, the transmission assembly is actuated as follows, the drive motor 1310 rotates the miter gear set, which rotates the gear shafts, which rotate the worm gears, which rotate the torque bars (2112). Specifically, the drive motor rotates the central gear 1302 of the miter gear set 1002 by means of a gear ratio set 1312. As the central gear 1302 rotates it drives the first outer gear 1304 in a first rotational direction and the second outer gear 1306 in a second rotational direction opposite of the first rotational direction. The first outer gear 1304 drives the first gear shaft 1004 in a first rotational direction, while the second outer gear 1306 drives the second gear shaft 1006 in a second rotational direction. The first gear shaft 1004 rotates the first torque bar 1012 by means of the first worm gear set 1008. The second gear shaft 1006 rotates the second torque bar 1014 in a direction opposite that of the first torque bar 1012 by means of the second worm gear set 1010. The rotation of the first torque bar 1012 then causes at least one latch 1920 to rotate and disengage a striker 1924 on the battery 104 (2114). Specifically, the first torque bar 1012, being coupled to the input link 1904, rotates the input link 1904, which actuates the coupler link rod 1910 such that the latch 1920 disengages the striker 1924. In some embodiments, substantially simultaneously, the rotation of the second torque bar 1014 causes the latch mechanism 1018 coupled to the second torque bar 1014 to rotate in a direction opposite that of the latch mechanism 1016 coupled to the first torque bar 1012. As such, latches on either side of the battery bay 108 rotate away from one another to release their respective strikers 1924. (2116) Then the battery pack is translated vertically downward away from the underside of the vehicle. In some embodiments, the battery pack is translated by means of first being lowered onto a platform under the battery and then being further lowered by means of the platform lowering.

[0150] FIG. 22 is a flow diagram of a process for engaging a battery pack to a battery bay. To engage a battery 104 at least partially within the battery bay 108 involves substantially the same process described above only in reverse. Specifically, the drive motor 1310 actuates a transmission assembly (2202). In some embodiments, the transmission assembly is actuated as follows, the drive motor 1310 rotates the miter gear set, which rotates the gear shafts, which rotate the worm gears, which rotate the torque bars (2204). Specifically, the drive motor 1310 rotates the central gear 1302 of the miter gear set 1002 in the opposite direction as that used for disengaging a battery 104 by means of a gear ratio set 1312. As the central gear 1302 rotates, it drives the first outer gear 1304 one rotational direction and the second outer gear 1306 in the opposite direction. The first outer gear 1304 drives the first gear shaft 1004 in one direction, while the second outer gear 1306 drives the second gear shaft 1006 in the opposite direction. The first gear shaft 1004 rotates the first torque bar 1012 by means of the first worm gear set 1008. The second gear shaft 1006 rotates the second torque bar 1014 in a direction opposite that of the first torque bar 1012 by means of the second worm gear set 1010. The rotation of the first torque bar 1012 then causes at least one first latch 1920 to rotate and

engage a striker **1924** on the battery **104** (**2206**). Specifically, the first torque bar **1012**, being coupled to the input link **1904**, rotates the input link **1904**, which actuates the coupler link rod **1910** such that the latch **1920** engages the striker **1924**. In some embodiments, the first latch is located at the front end of the underside of the vehicle. In some embodiments, substantially simultaneously a second latch located at the back end of the electronic vehicle is also rotated in the same manner (**2208**).

[0151] Once the strikers are engaged, they then vertically lift the battery at least partially into the battery bay of the electronic vehicle (**2210**). The lifting happens as follows, substantially simultaneously, the rotation of the second torque bar **1014** causes the latch mechanism **1018** coupled to the second torque bar **1014** to rotate in a direction opposite that of the latch mechanism **1016** coupled to the first torque bar **1012**. As such, latches on either side of the battery bay **108** rotate towards one another to engage their respective strikers **1924** substantially simultaneously and lift them. Then the battery is secured into the battery bay **108** (**2212**). Specifically, the latches **1920** hook onto the strikers **1924** and lift the battery until the latches are in their geometric lock (dead center) positions. Once the battery **104** is engaged, the first lock mechanism is engaged. (**2214**) Specifically, once the four bar mechanism of the latches **1016**, **1018** are in their geometric lock positions, the key **1602** is removed from the key hole **1401** and the locking latch **1702** with a locking tooth **1704** engages with the locking gear **1706** (**2216**). Also, the second lock mechanism is electrically engaged (**2218**). Specifically, the an electric motor **2008**, activated by an electronic unlock signal, actuates the lock actuator **2006** which rotates the latch lock **2002** and engages its tooth with the tooth of the latch **1920** by rotating the lock synchronization bar **2004** (**2220**).

[0152] In some embodiments, the battery bay **108** is configured to be disposed at the underside of the at least partially electric vehicle **102** such that the releasing and engaging mechanisms described can release an at least partially spent battery **104** and have it replaced by an at least partially charged battery **104** underneath the vehicle **102**.

[0153] As described above, in reference to FIGS. **21** and **22**, in some embodiments, the first latch mechanism **1016** and the second latch mechanism **1018** substantially simultaneously rotate in opposite directions about their respective axes. In some embodiments, the at least two latches rotate towards one another to engage, lift, and lock the battery **104** at least partially within the cavity of the battery bay **108**. In some embodiments, the at least two latches then rotate away from each other to disengage the battery **104**. Similarly, the battery pack **104** is disengaged and unlocked from the at least partially electric vehicle **102** when the latches **1920** of the first latch mechanism **1016** and the second latch mechanism **1018** substantially simultaneously rotate away from one another.

[0154] FIGS. **24A-31** illustrate various embodiments of an electrical connection system that provide additional detail to what was described above with relation to FIG. **9**. FIG. **9** illustrated one embodiment of an electrical connection system **900** comprising a battery electrical connector **804** connected to the battery pack **104** that was configured to mate with a battery bay electrical connector **902** connected to the electric vehicle **102**. FIGS. **24A-30B** illustrates an electrical connection system **2400**. These embodiments utilize the term vehicle-side connector **2402** to describe other embodiments of the element referred to as the battery bay electrical connector **902** in FIG. **9**, and utilize the term battery-side con-

necter **2452** to describe other embodiments of the element referred to as the battery electrical connector **804** in FIG. **9**. It should be noted that in some instances these embodiments include additional components. For example, the shielding mechanism **2902** described in relation to FIGS. **30** and **31** is an additional element that performs a different shielding function than the electric shields **904** described in relation to FIG. **9**. Furthermore, the power connectors **906** and **908** and data connectors **910** of FIG. **9** (which included the cables and connection interfaces) are described in greater detail with relation to FIGS. **24A-27** and are thus referred to by new names and numbers.

[0155] FIG. **24A** is a top perspective view of an electrical connection system **2400**, including a vehicle-side connector **2402** and a battery-side connector **2452**. FIG. **24B** is a bottom perspective view of the vehicle-side connector **2402**. The battery-side connector **2452** is attached to the battery pack **104** and electrically connects the battery pack **104** to the vehicle **102** by mating with the vehicle-side connector **2402**. In some embodiments, the battery-side connector **2452** has mechanisms for compensating for misalignment as described in detail below. Similarly, the vehicle-side connector **2402** is attached to the vehicle **102** and electrically connects the vehicle **102** to the battery pack **104** by mating with the battery-side connector **2452**. In some embodiments, the vehicle-side connector **2402** has mechanisms for compensating for misalignment as described in detail below. It should be noted that while the components described in relation to the figures below are described as being “battery-side” or “vehicle-side,” these components could be swapped. In other words, all comments described as “battery-side” in embodiments illustrated below, could be mounted to the “vehicle” in an alternative embodiment, and vice versa. As shown in FIG. **24A**, the battery-side connector **2452** comprises a battery-side mounting portion **2454** and a battery-side coupling portion **2456**. The battery-side coupling portion **2456** includes one or more alignment sockets **2470**. In some embodiments, one or more bolts **2462**, which are surrounded by sleeves **2464**, secure the battery-side coupling portion **2456** to the battery-side mounting portion **2454**. In some embodiments, the battery-side coupling portion **2456** and the battery-side mounting portion **2454** are rigidly secured to one another, such that both components are fixed with respect to the battery pack. In other embodiments, the battery-side connector **2452** also comprises a battery-side coupler **2458** (shown and described in detail with respect to FIG. **27**) which allows for relative motion between the battery-side coupling portion **2456** and the battery-side mounting portion **2454**. This relative motion between the components relieves potential misalignment between the battery-side connector **2452** and the vehicle-side connector **2402**.

[0156] The battery-side coupling portion **2456** houses a battery-side power interface **2466** with one or more power sockets **2486** and a battery-side data interface **2468** with one or more data sockets **2488**. In some embodiments, the battery-side coupling portion **2456** also includes a sealing mechanism **2472** surrounding a portion of the battery-side coupling portion **2456** including the battery side power interface **2466** and the battery-side data interface **2468** and which assists in protecting these components from dirt and debris.

[0157] As shown in FIG. **24A**, the vehicle-side connector **2402** has a vehicle-side mounting portion **2404**, a vehicle-side coupling portion **2406**, and a vehicle-side coupler **2408**. The vehicle-side coupling portion **2406** is connected to the

vehicle-side mounting portion **2404** via the vehicle-side coupler **2408**. The vehicle-side coupler **2408** is designed to allow relative motion between the vehicle-side coupling portion **2406** and the vehicle-side mounting portion **2404** to relieve potential misalignment between the battery-side connector **2452** and the vehicle-side connector **2402** and to absorb relative motion between the battery and vehicle. The vehicle-side connector **2402** also has one or more alignment pins **2420**.

[0158] FIG. 24B is a bottom perspective view of the vehicle-side connector **2402**. As shown in FIG. 24B, the vehicle-side coupling portion **2406** houses a vehicle-side power interface **2416** with one or more power pins **2476** and a vehicle-side data interface **2418** with one or more data pins **2478**. The vehicle-side coupling portion **2406** connects to the battery-side coupling portion **2456** (FIG. 24A) to electrically connect the battery pack **104** to the vehicle **102**. The vehicle-side coupler **2408** comprises one or more bolts **2412** and coil springs **2414**. In some embodiments, the vehicle-side coupler **2408** uses a combination of bolts **2412** and the coil springs **2414** to allow relative motion between the vehicle-side coupling portion **2406** and the vehicle-side mounting portion **2404**, as described in further detail below in relation to FIG. 26.

[0159] In some embodiments, the vehicle-side mounting portion **2404**, used to mount the vehicle-side connector **2402** to the vehicle **102** is shaped to conform to the specific contours of the underside of the vehicle **102**. In some embodiments, the vehicle-side mounting portion **2404** is attached directly to the underside of a vehicle, while in other embodiments the vehicle-side mounting portion **2404** is attached to any portion of the vehicle that facilitates the coupling between the vehicle-side connector **2402** and a battery-side connector **2452** of the connection system **2400**. The vehicle-side mounting portion **2402** is any suitable plate, bracket, or other mounting mechanism that is configured to attach to the vehicle **102**. In some further embodiments, the vehicle-side mounting portion **2404** forms a part of the vehicle **102**. Similarly, the battery-side mounting portion **2454** is configured to attach to or form a part of the battery **104** in a similar manner as described above for the vehicle-side mounting portion **2404**.

[0160] FIG. 24A also shows the sealing mechanism **2472** surrounding a portion of the battery-side coupling portion **2456**. When the vehicle-side connector **2402** and the battery-side connector **2452** are coupled together, the sealing mechanism **2472** is disposed between two proximate surfaces of the vehicle-side coupling portion **2406** and the battery-side coupling portion **2456**. The sealing mechanism **2472** is designed to prevent the ingress of environmental contaminants to the area between the coupling portions that contains the power **2416**, **2466** and data interfaces **2418**, **2468**. Because of the extreme environments in which vehicles often operate, the sealing mechanism **2472** is designed to protect the most sensitive elements of the connector from contaminants such as water, dust, dirt, soot, chemicals, etc. In some embodiments, the sealing mechanism **2472** is a rubber O-ring. In some embodiments, the coupling portions **2406** and **2456** utilize more than one sealing mechanism. In some embodiments, the connection system **2400** employs additional types or combinations of sealing mechanisms including other types of gaskets or scraping mechanisms designed to clean away foreign contaminants.

[0161] As shown in FIG. 24A, one or more tapered alignment pins **2420** are mounted to the vehicle-side coupling

portion **2406**. The tapered alignment pins **2420** are perpendicular to the surface of the vehicle-side coupling portion **2406** (the X-Z plane of FIG. 3A) and parallel to the axis along which the coupling portions **2406** and **2456** are connected together (the Y-axis of FIG. 3A). The one or more alignment sockets **2470** mounted to the battery-side coupling portion **2456** are configured to receive the tapered alignment pin **2420**. In some embodiments, the inside edges of the openings in the alignment sockets **2470** are chamfered in order to reduce friction and provide a smoother contact interface between the alignment pins **2420** and the alignment sockets **2470**. The alignment pins **2420** and alignment sockets **2470** are mounted such that when the alignment pins **2420** are in the alignment sockets **2470**, the coupling portions **2406** and **2456** and their respective power interfaces **2416**, **2466** and data **2418**, **2468** interfaces are aligned. FIG. 26 illustrates the alignment pins **2420** in further detail.

[0162] In some embodiments, the one or more alignment sockets **2470** each have a substantially cylindrical shaped cross-section. In some embodiments, one of the alignment sockets **2470** has an oval shaped cross-section rather than a cylindrical shaped cross-section. In this embodiment, the oval shaped alignment socket **2470** is mounted such that the long dimension of the oval is parallel to a line formed between two tapered alignment pins **2420**. Thus, the extra space between the alignment pin **2420** and the inside walls of the alignment socket channel accommodates alignment pins **2420** that may not be exactly parallel. This reduces possible mechanical stresses on the alignment pins **2420** and alignment sockets **2470**.

[0163] The alignment pins **2420** and alignment sockets **2470** are more robust and durable than the connection elements that are utilized in the power interfaces **2416**, **2466** and data **2418**, **2468** interfaces. By employing an alignment mechanism such as the illustrated alignment pins **2420** and alignment sockets **2470**, the lateral and bending loads that might otherwise be imparted to the electrical interfaces due to misalignments between the battery **104** and the vehicle **102** can be borne by structural components rather than the more fragile electrical and data components.

[0164] As shown in FIG. 24A, the vehicle-side coupling portion **2406** houses the vehicle-side power interface **2416** and the vehicle-side data interface **2418**. Likewise, the battery-side coupling portion **2456** houses a battery-side power interface **2466** and a battery-side data interface **2468**. The vehicle-side power interface **2416**, when coupled to the battery-side power interface **2466**, transmits high voltage and current electrical energy between the battery **104** and the vehicle **102**. In order to provide adequate propulsion, electric vehicles may require up to 1000 volts and up to 1000 amps of direct current electricity. In some embodiments, the vehicle requires up to 400 volts and 200 amps of direct current electricity. In some embodiments, the high voltage electricity is between about 100 and 1000 VDC. In other embodiments, the high voltage electricity is between about 200 and 800 VDC. In yet other embodiments, the high voltage electricity is between about 300 and 700 VDC. In still other embodiments, the high voltage electricity is between about 350 and 450 VDC. The particular voltage and current capacities of the vehicle-side power interfaces **2416**, **2466** will vary depending on the particular energy needs of the application. For instance, high performance vehicles may require a higher voltage or current carrying capacity than standard vehicles.

[0165] The vehicle-side power interface 2416 of the vehicle coupling portion 2406 uses conductive pins that are received by the power interface 2466 in the battery-side coupling portion 2456. In some embodiments, the vehicle-side power interface 2416 comprises two conductive power pins 2476. In other embodiments the vehicle-side power interface 2416 comprises four or more conductive power pins 2476. The inside surface of the battery side power interface 2466 is conductive in order to facilitate the transmission of electricity between the battery 104 and the vehicle 102. In some embodiments, the battery-side power interface 2466 employs power sockets 2486 that utilize a conductive mesh sleeve to make electrical contact with the power pins 2476, as described with reference to FIG. 28. In some embodiments, the battery-side power interface 2466 includes as many power sockets 2486 as there are power pins 2476.

[0166] In some embodiments, the vehicle-side data interface 2418 contains seventeen conductive data pins 2478. In some embodiments, the vehicle-side data interface 2418 has nine, fifteen, or twenty data pins 2478. In some embodiments, the battery-side data interface 2468 will utilize as many data sockets 2488 as there are data pins 2478 in the data interface 2418. In some embodiments, the vehicle-side data interface 2418 employs data sockets 2488 that utilize a conductive mesh sleeve to make electrical contact with the data pins 2478, as described with reference to FIG. 28. The data interfaces 2418 and 2468 transmit data between the battery 104 and the vehicle 102 using electronic communication signals. Many electronic communication signals can be supported over the data interfaces 2418 and 2468, including but not limited to Ethernet, Universal Serial Bus, RS-232 or any other electrical signal. Furthermore, the data interfaces 2418 and 2468 can support many communication protocols, including but not limited to TCP/IP, CAN-bus (Controller Area Network), or other proprietary protocols. In some embodiments, the data interfaces 2418 and 2468 are optical connectors. In such embodiments, the data interfaces 2418 and 2468 do not require conductive pins or sockets in order to transmit data between the battery 104 and the vehicle 102.

[0167] FIG. 25 is an elevation view of the vehicle-side connector 2402 and the battery-side connector 2452. Line 26-26 in FIG. 25 defines the sectional views shown in FIGS. 26 and 27.

[0168] FIG. 26 is a sectional view of the vehicle-side connector 2402 along axis 26-26 shown in FIG. 25. FIG. 26 shows a more detailed view of the vehicle-side coupling portion 2406 of this embodiment. In some embodiments, the vehicle-side coupler 2408 comprises bolts 2412 that are attached to the vehicle-side mounting portion 2404 and the vehicle-side coupling portion 2406, and are surrounded by the coil springs 2414. The bolts 2412 pass through holes 2602 in the vehicle-side coupling portion 2406 that are larger than the diameter of the shafts of the bolts 2412. The coil springs 2414 are positioned between the vehicle-side mounting portion 2404 and the vehicle-side coupling portion 2406. The coil springs 2414 are flexible and provide a resilient force between the vehicle-side mounting portion 2404 and the vehicle-side coupling portion 2406. This resilience provides a centering force between the vehicle-side coupling portion 2406 and the vehicle-side mounting portion 2404 to keep the vehicle-side coupling portion 2406 in a neutral position when the connectors 2402, 2452 are not coupled together. Additionally, the resilient structure of the coil springs 2414 allows the vehicle-side coupling portion 2406 to move both verti-

cally and horizontally to aid in the alignment of the vehicle-side and battery-side coupling portions, 2406 and 2456. The coil springs 2414 also absorb vertical and horizontal shock and vibration when the vehicle 102 is driven. The bolt and spring style vehicle-side coupler 2408 provides sufficient free play in the horizontal plan (the X-Z plane defined in FIG. 3A) to allow the vehicle-side connector 2402 and the battery-side coupler 2452 to align given the general geometrical tolerances of the complete battery bay assembly. In other words, if the total accuracy of the battery bay system is high, less free play in the vehicle-side coupler 2408 is required. For example, a free play of ± 3 mm will be enough. For lower accuracy battery bay systems, will require more free play. In some embodiments, the bolt and spring style vehicle-side coupler 2408 allows ± 6 mm movement in a plane that is substantially parallel to the vehicle 102 (the X-Z plane defined in FIG. 3A). In some embodiments, the bolt and spring style vehicle-side coupler 2408 allows for ± 6 mm movement along a vertical axis (the Y-axis defined in FIG. 3A.)

[0169] In some embodiments, the coil springs 2414 do not surround the bolts 2412, but are positioned elsewhere between the vehicle-side coupling portion 2406 and the vehicle-side mounting portion 2404. In some embodiments, the vehicle-side coupler 2408 utilizes a resilient mechanism other than coil springs, including but not limited to leaf springs, elastomer springs, or torsion springs. In some embodiments, the vehicle-side coupler 2408 utilizes more or fewer coil springs and bolts. Those skilled in the art will recognize that a variety of springs and configurations may be used.

[0170] FIG. 26 shows the tapered alignment pin 2420 and its mounting mechanism in greater detail. In some embodiments, the one or more tapered alignment pins 2420 are rigidly fixed to the vehicle-side coupling portion 2406. In other embodiments, the one or more tapered alignment pins 2420 are attached as shown in FIG. 26, so as to allow relative motion between the alignment pins 2420 and the vehicle-side coupling portion 2406. In some embodiments, the vehicle side coupler 2408 comprises the floating pin mechanism as well as the bolt and spring mechanism described above. The mount for the alignment pin 2420 uses a hollow flanged sleeve 2604 with an "I-shaped" cross-section between the pin 2420 and the vehicle-side coupling portion 2406. In some embodiments, the flanged sleeve 2604 is made up of two sleeves, each having a single flange or shoulder, to facilitate assembly. The shoulders, or flanges, of the flanged sleeve 2604 rest on the surface of the vehicle-side coupling portion 2406, and are wider than the opening of the hole 2608 in the vehicle-side coupling portion 2406. The flanges thus keep the tapered alignment pins 2420 captive to the surface of the coupling portion 2406 in the vertical direction. The outside cylindrical surface of the flanged sleeve 2604 is smaller than the inside diameter of the hole 2608, leaving free space 2606 between the two surfaces. The free space 2606 allows the alignment pin to have some lateral play or to "float" in the plane defined by the surface of the vehicle-side coupling portion 2406 to which the alignment pin 2420 is mounted. In some embodiments, the floating pin style vehicle-side coupler 2408 allows ± 1 mm movement in a plane that is substantially parallel to the vehicle 102 (the X-Z plane defined in FIG. 3A).

[0171] FIG. 27 is a sectional view of the battery-side connector 2452 along axis 26-26 shown in FIG. 25. The battery-

side connector **2452** including the battery-side mounting portion **2454**, a battery-side coupling portion **2456**, and a battery-side coupler **2458** is shown. The bolts **2462**, which form a part of the battery-side coupler **2458**, secure the battery-side coupling portion **2456** to the battery-side mounting portion **2454**. In some embodiments, the shafts of the bolts **2462** are surrounded by flanged sleeves **2464**. The flanged sleeves **2464** have two shoulders, or flanges, creating a hollow “I-shaped” cross-section. In some embodiments, the flanged sleeves **2464** are made up of two sleeves (as shown), each having a single flange or shoulder, to facilitate assembly. The shoulders of the flanged sleeves **2464** have a diameter larger than the opening in the battery-side coupling portion **2456** in which the sleeves **2464** sit. The shoulders of the sleeves contact the top and bottom surface of the battery-side coupling portion **2456**, thus keeping the battery-side coupling portion **2456** captive to the battery-side mounting portion **2454** (in the vertical direction).

[0172] The outer cylindrical surfaces of the sleeves **2464** have a diameter smaller than the openings in the battery-side coupling portion **2456**. This configuration leaves space **2702** between the wall of the hole in the battery-side coupling portion **2456** and the cylindrical surface of the sleeve **2464**. The space **2702** allows the battery-side coupling portion **2456** to move laterally relative to the battery-side mounting portion **2454**. In some embodiments, the space **2702** permits the battery-side coupling portion **2456** to slide or “float” freely in one plane. In some embodiments, the sliding sleeve style battery-side coupler **2458** allows ± 1 mm movement in a plane that is substantially parallel to the vehicle **102** (the X-Z plane defined in FIG. 3A). In other embodiments, planar motion will change based on the particular mounting location of the connection system **2400** and its elements.

[0173] FIG. 28 shows an example of a mesh sleeve **2800** utilized by either the power sockets **2486**, the data sockets **2488**, or both power and data sockets in the battery-side coupling portion interface **2456**. The conductive surface of the mesh sleeve is made up of a number of conductive wires **2802** positioned between two rings **2804**. The wires **2802** are attached to the rings **2804** diagonally with respect to the axis formed by the center of the rings **2804**. This configuration of wires **2802** and rings **2804** together form a semi-spiral shaped conductive mesh sleeve **2800**. The semi-spiral configuration disposes the sleeve **2800** with a narrowing bias, creating a gradual decrease in the internal diameter of the sleeve **2800** with the middle internal diameter **2806** being the smallest. A corresponding pin (such as a power pin **2476** or a data pin **2478** from the vehicle-side coupling portion **2406**) has a diameter smaller than the rings **2804**, but larger than the middle internal diameter **2806**. Thus, as the pin is inserted into the sleeve **2800**, the portion of the wires **2802** near the middle internal diameter **2806** must deform to accommodate the larger diameter of the pin. This process ensures that the conductive wires **2802** are held firmly against the surface of the pin. The mesh sleeve **2800** is designed such that the wires **2802** bend only slightly, within their elastic deformation range. The configuration of the wires **2802** is such that they resist plastic deformation when a pin of the appropriate size is inserted. The mesh sleeve **2800** and the pins are therefore able to withstand many contact cycles without damage to themselves or degradation of the electrical connections. In some embodiments, the pins and sockets can withstand 3000 or more connection cycles.

[0174] FIG. 29 is an exploded view of the vehicle-side coupling portion **2406** and shows a shielding mechanism **2902**. The shielding mechanism **2902** separates and isolates data conductors from power conductors in the connection system. Although FIG. 29 only depicts the vehicle-side coupling portion **2406**, a similar shielding mechanism is employed in the battery-side coupling portion **2456**. The shielding mechanism **2902** is particularly designed to prevent electromagnetic or other electrical interference from degrading the signals carried by the data conductors and interfaces **2418**. As mentioned, electric vehicles require high voltage and current electricity, which can disrupt nearby electrical communication signals. Due to the desire to employ data and power connections on the same connector **2400**, such interference must be prevented.

[0175] FIG. 30 is a perspective view of the shielding mechanism **2902** included in the vehicle-side connector **2402** and the battery-side connector **2452**. FIG. 31 includes planar views of all sides of the shielding mechanism **2902** of FIG. 30. The shielding mechanism **2902** surrounds the data conductors **910** and the data interfaces **2418**, **2468**. The shielding mechanism **2902** is made of a metal, preferably a conductive metal material which is designed to counteract the electromagnetic field produced by the power conductors and power interfaces **2416**, **2466**. The wall thickness of the shielding mechanism **2902** depends on the strength of the electromagnetic field and the location of the shield relative to the field. In some embodiments, the wall thickness is between 0.1 mm and 5 mm depending on the electro-magnetic interference generated by the power conductors. The general dimensions of the shielding mechanism **2902** are such that there is sufficient room for the data wires to be encased. In some embodiments, the shielding mechanism **2902** is “L” shaped, or elbow shaped. In some embodiments, the specific dimensions of the L-shaped shielding mechanism are dependant upon the constraints and frequencies of the electro-magnetic interference generated by the power conductors. When designed with the dimensions discussed above, the material of the shielding mechanism **2902** establishes an internal electromagnetic force that substantially counteracts the external field generated by the nearby high voltage conductors. This counteracting field is created simply by the interaction of the specially designed shield wall and the nature of the material. It does not require additional power or grounding systems in order to function properly. This is especially beneficial given the desire to employ as simple and robust a connection system as possible.

[0176] The foregoing description, for purpose of explanation, has been described with reference to specific embodiments. However, the illustrative discussions above are not intended to be exhaustive or to limit the invention to the precise forms disclosed. Many modifications and variations are possible in view of the above teachings. For example, the above described embodiments are described in relation to an at least partially electric vehicle, but the mechanisms described herein could be used in any at least partially electric machine employing a removable battery. The embodiments were chosen and described in order to best explain the principles of the invention and its practical applications, to thereby enable others skilled in the art to best utilize the invention and various embodiments with various modifications as are suited to the particular use contemplated.

What is claimed is:

1. An electrical connection system for a battery of an at least partially electric vehicle, the electrical connection system comprising:

- a first electrical connector configured to permanently attach to an underside of an at least partially electric vehicle;

- a second electrical connector configured to permanently attach to a battery, wherein the first and second electrical connectors are configured to be removably coupled to each other, along an axis substantially perpendicular to the underside of the at least partially electric vehicle;

wherein each of the first and second electrical connectors further comprise:

- a high voltage interface for transmitting high voltage electricity between the first and second electrical connectors;

- a data interface for transmitting data between the first and second electrical connectors; and

- a shielding mechanism to counteract electromagnetic effects caused by the one or more high voltage connection elements.

2. The electrical connection system of claim 1, wherein the shielding mechanism separates the data interface from the high voltage interface to protect the data interface from electromagnetic effects caused by the one or more high voltage connection elements.

3. The electrical connection system of claim 1, wherein the shielding mechanism comprises a housing that substantially covers the data interface.

4. The electrical connection system of claim 3, wherein the housing is L-shaped.

5. The electrical connection system of claim 1, wherein at least one of the electrical connectors further comprises a sealing mechanism positioned between the first and second electrical connectors for preventing environmental contamination when the first and second electrical connectors are coupled.

6. The electrical connection system of claim 1, wherein the high voltage interface comprises:

- conductive pins; and

- sockets for receiving the conductive pins, wherein the sockets have a conductive mesh sleeve for forming an electrical connection with the conductive pins.

7. The electrical connection system of claim 1, wherein the data interface comprises:

- conductive pins; and

- sockets for receiving the conductive pins, wherein the sockets have a conductive mesh sleeve for forming an electrical connection with the conductive pins.

8. The electrical connection system of claim 1, wherein the data interface comprises a fiber optic interface.

9. The electrical connection system of claim 1, wherein high voltage electricity is between about 100 and 1000 VDC.

10. The electrical connection system of claim 1, wherein high voltage electricity is between about 200 and 800 VDC.

11. The electrical connection system of claim 1, wherein high voltage electricity is between about 350 and 450 VDC.

12. An electrical connection system for a battery of an at least partially electric vehicle, the electrical connection system comprising:

- a first electrical connector configured to mount to an underside of an at least partially electric vehicle, comprising:

- a first coupling portion for mating with a second coupling portion of a second electrical connector;

- the second electrical connector configured to mount to a battery, comprising:

- the second coupling portion for mating with the first coupling portion of the first electrical connector; and

- a first coupler for compensating for misalignment between the first and second electrical connectors;

wherein the first and second coupling portions include:

- a high voltage interface for transmitting high voltage electricity between the first and second coupling portions; and

- a data interface for transmitting data between the first and second coupling portions.

13. An electrical connection system for a battery of an at least partially electric vehicle, the electrical connection system comprising:

- a first electrical connector configured to mount to an underside of an at least partially electric vehicle, comprising:

- a first coupling portion for mating with a second coupling portion of a second electrical connector;

- a first mounting portion for attaching the first electrical connector to the at least partially electric vehicle; and
- a first coupler for attaching the first coupling portion to the first mounting portion, the first coupler allowing relative motion between the first coupling portion and the first mounting portion;

- the second electrical connector configured to mount to a battery, comprising:

- the second coupling portion for mating with the first coupling portion of the first electrical connector;

- wherein the first coupler compensates for misalignment between the first and second electrical connectors; and
- wherein the first and second coupling portions include:

- a high voltage interface for transmitting high voltage electricity between the first and second coupling portions; and

- a data interface for transmitting data between the first and second coupling portions.

14. The electrical connection system of claim 13, wherein the second electrical connector further comprises:

- a second mounting portion for attaching the second electrical connector to the battery; and

- a second coupler for attaching the second coupling portion to the second mounting portion, the second coupler allowing for relative motion between the second coupling portion and the second mounting portion; wherein the second coupler further compensates for misalignment between the first and second electrical connectors.

15. The electrical connection system of claim 13, wherein the first coupler is configured to allow the first coupling portion to move in vertical and horizontal planes with respect to the first mounting portion.

16. The electrical connection system of claim 13, wherein the first coupler comprises:

- a hole in the first coupling portion; and

- a bolt rigidly attached to the first mounting portion and extending through the hole in the first coupling portion, the bolt having a smaller diameter than the hole.

17. The electrical connection system of claim 16, wherein the first coupler further comprises a coil spring positioned between the first coupling portion and the first mounting portion.

18. The electrical connection system of claim 17, wherein the bolt extends through the center of the coil spring.

19. The electrical connection system of claim 13, wherein

the first coupling portion further includes a pin having an outside surface;

the second coupling portion further includes a socket with an inside surface for receiving the pin; and

the pin and socket are configured to ensure lateral alignment between the first and second coupling portions.

20. The electrical connection system of claim **19**, wherein the inside surface of the socket is a channel, the channel having an inside surface larger than the pin to allow for space between a portion of the inside surface of the channel and a portion of the outside surface of the pin.

* * * * *