



US010029623B2

(12) **United States Patent**
Rawlings et al.

(10) **Patent No.:** **US 10,029,623 B2**
(45) **Date of Patent:** ***Jul. 24, 2018**

(54) **CAMERA MOUNTING SYSTEM FOR A VEHICLE**

(71) Applicant: **MAGNA MIRRORS OF AMERICA, INC.**, Holland, MI (US)

(72) Inventors: **Donald S. Rawlings**, Caledonia, MI (US); **Carol L. DeBoer**, Zeeland, MI (US); **Darryl P. De Wind**, West Olive, MI (US)

(73) Assignee: **MAGNA MIRRORS OF AMERICA, INC.**, Holland, MI (US)

(*) Notice: Subject to any disclaimer, the term of this patent is extended or adjusted under 35 U.S.C. 154(b) by 0 days.

This patent is subject to a terminal disclaimer.

(21) Appl. No.: **15/651,384**

(22) Filed: **Jul. 17, 2017**

(65) **Prior Publication Data**

US 2017/0313261 A1 Nov. 2, 2017

Related U.S. Application Data

(63) Continuation of application No. 15/344,858, filed on Nov. 7, 2016, now Pat. No. 9,707,903, which is a (Continued)

(51) **Int. Cl.**
B60R 11/04 (2006.01)
B60R 1/12 (2006.01)
(Continued)

(52) **U.S. Cl.**
CPC **B60R 11/04** (2013.01); **B60R 1/12** (2013.01); **H04N 5/2257** (2013.01);
(Continued)

(58) **Field of Classification Search**

CPC B60R 2001/1223; B60R 2001/1253; B60R 11/04; B60R 2011/0026

See application file for complete search history.

(56) **References Cited**

U.S. PATENT DOCUMENTS

5,550,677 A 8/1996 Schofield et al.
5,670,935 A 9/1997 Schofield et al.

(Continued)

FOREIGN PATENT DOCUMENTS

DE 10355205 7/2005
WO WO2013/019795 2/2013

(Continued)

Primary Examiner — Justin Larson

(74) *Attorney, Agent, or Firm* — Honigman Miller Schwartz and Cohn, LLP

(57) **ABSTRACT**

A method of mounting a camera module at a vehicle windshield includes attaching an attaching portion of a bracket at an in-cabin surface of a vehicle windshield and attaching a mirror mounting base at the bracket, and attaching a mirror head at the mirror mounting base. With the attaching portion of the bracket attached at the in-cabin surface of the windshield, camera attaching structure of the bracket extends downward along the in-cabin surface of the vehicle windshield below the attaching portion. With the attaching portion of the bracket attached at the in-cabin surface of the vehicle windshield, the camera module is attached at the camera attaching structure of the bracket, whereby the lens of the camera module is below the attaching portion of the bracket and the camera module has a field of view through a portion of the vehicle windshield below the attaching portion.

18 Claims, 5 Drawing Sheets

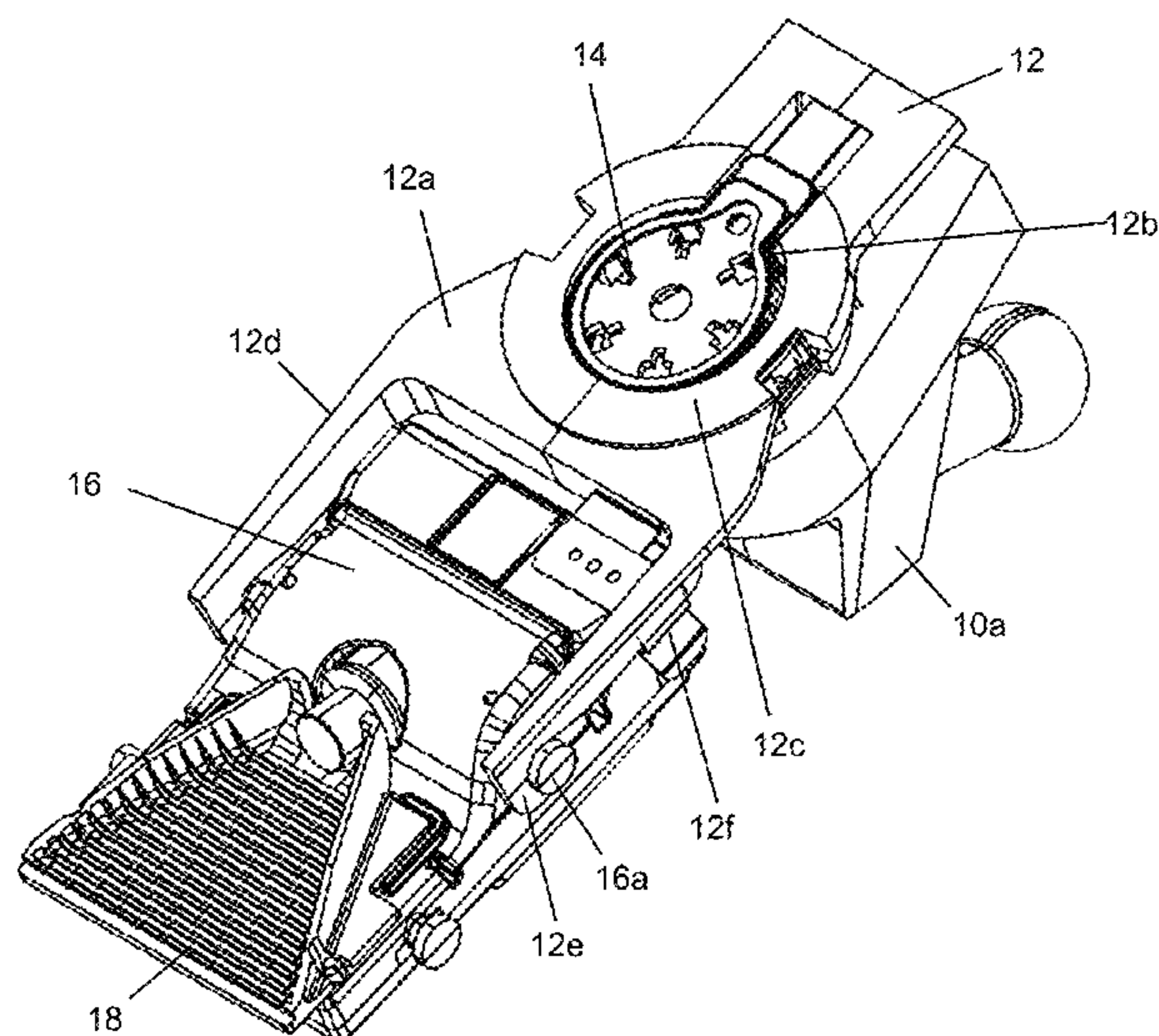

Related U.S. Application Data

continuation of application No. 14/504,667, filed on Oct. 2, 2014, now Pat. No. 9,487,161.

(60) Provisional application No. 61/886,882, filed on Oct. 4, 2013.

(51) **Int. Cl.**
B60R 11/00 (2006.01)
H04N 5/225 (2006.01)

(52) **U.S. Cl.**
CPC *B60R 2001/1223* (2013.01); *B60R 2001/1253* (2013.01); *B60R 2011/0026* (2013.01)

(56) **References Cited**

U.S. PATENT DOCUMENTS

5,949,331	A	9/1999	Schofield et al.
6,087,953	A	7/2000	DeLine et al.
6,097,023	A	8/2000	Schofield et al.
6,124,886	A	9/2000	DeLine et al.
6,172,613	B1	1/2001	DeLine et al.
6,243,003	B1	6/2001	DeLine et al.
6,250,148	B1	6/2001	Lynam
6,278,377	B1	8/2001	DeLine et al.
6,326,613	B1	12/2001	Heslin et al.
6,329,925	B1	12/2001	Skiver et al.
6,333,759	B1	12/2001	Mazzilli
6,341,523	B2	1/2002	Lynam
6,420,975	B1	7/2002	DeLine et al.
6,428,172	B1	8/2002	Hutzel et al.
6,445,287	B1	9/2002	Schofield et al.
6,501,387	B2	12/2002	Skiver et al.
6,593,565	B2	7/2003	Heslin et al.
6,690,268	B2	2/2004	Schofield et al.
6,774,356	B2	8/2004	Heslin
6,824,281	B2	11/2004	Schofield et al.
6,946,978	B2	9/2005	Schofield
6,968,736	B2	11/2005	Lynam
7,004,593	B2	2/2006	Weller et al.
7,188,963	B2	3/2007	Schofield et al.
7,262,406	B2	8/2007	Heslin et al.
7,265,342	B2	9/2007	Heslin et al.
7,289,037	B2	10/2007	Uken et al.
7,344,261	B2	3/2008	Schofield et al.
7,420,159	B2	9/2008	Heslin et al.
7,423,248	B2	9/2008	Schofield et al.
7,480,149	B2	1/2009	DeWard et al.
7,533,998	B2	5/2009	Schofield et al.
7,538,316	B2	5/2009	Heslin et al.
7,889,086	B2	2/2011	Schafer et al.
7,916,009	B2	3/2011	Schofield et al.

7,946,505	B2	5/2011	Lynam et al.
7,994,462	B2	8/2011	Schofield et al.
8,179,437	B2	5/2012	Schofield et al.
8,203,440	B2	6/2012	Schofield et al.
8,222,588	B2	7/2012	Schofield et al.
8,239,086	B2	8/2012	Higgins-Luthman
8,256,821	B2	9/2012	Lawlor et al.
8,289,142	B2	10/2012	Pawlicki et al.
8,314,689	B2	11/2012	Schofield et al.
8,324,552	B2	12/2012	Schofield et al.
8,405,726	B2	3/2013	Schofield et al.
8,451,332	B2	5/2013	Rawlings
8,534,887	B2	9/2013	DeLine
8,585,302	B2	11/2013	Totani
8,743,203	B2	6/2014	Karner
8,818,042	B2	8/2014	Schofield et al.
8,851,690	B2	10/2014	Uken
8,922,867	B2	12/2014	De Wind et al.
8,944,655	B2	2/2015	Verrat-Debailleul
8,944,705	B1	2/2015	Matori
9,090,213	B2	7/2015	Lawlor et al.
9,150,165	B1	10/2015	Fortin
9,156,403	B2	10/2015	Rawlings et al.
9,193,308	B2	11/2015	Okuda
9,225,884	B2	12/2015	Blake, III et al.
9,272,665	B2	3/2016	Minikey, Jr. et al.
9,487,159	B2 *	11/2016	Achenbach B60R 11/04
9,487,161	B2	11/2016	Rawlings et al.
9,573,525	B2 *	2/2017	Minikey, Jr. B60R 1/04
9,707,903	B2	7/2017	Rawlings et al.
2003/0210328	A1	11/2003	Mazzilli
2006/0050018	A1	3/2006	Hutzel et al.
2009/0295181	A1	12/2009	Lawlor et al.
2010/0065707	A1	3/2010	Hansel
2011/0168866	A9	7/2011	Gruener et al.
2012/0181315	A1	7/2012	Lai
2012/0310519	A1	12/2012	Lawlor et al.
2013/0076905	A1	3/2013	Blake, III et al.
2014/0055617	A1	2/2014	Minikey, Jr. et al.
2014/0226012	A1	8/2014	Achenbach et al.
2015/0041510	A1	2/2015	Frenzel et al.
2015/0042798	A1	2/2015	Takeda
2015/0097013	A1	4/2015	Rawlings et al.
2015/0109447	A1	4/2015	Okuda
2015/0251605	A1	9/2015	Uken et al.
2015/0256729	A1	9/2015	Wato
2015/0329063	A1	11/2015	Lawlor et al.
2016/0009230	A1	1/2016	Miyado et al.
2016/0023620	A1	1/2016	Matori

FOREIGN PATENT DOCUMENTS

WO	WO2013/081984	6/2013
WO	WO2013/081985	6/2013
WO	WO2013/123161	8/2013

* cited by examiner

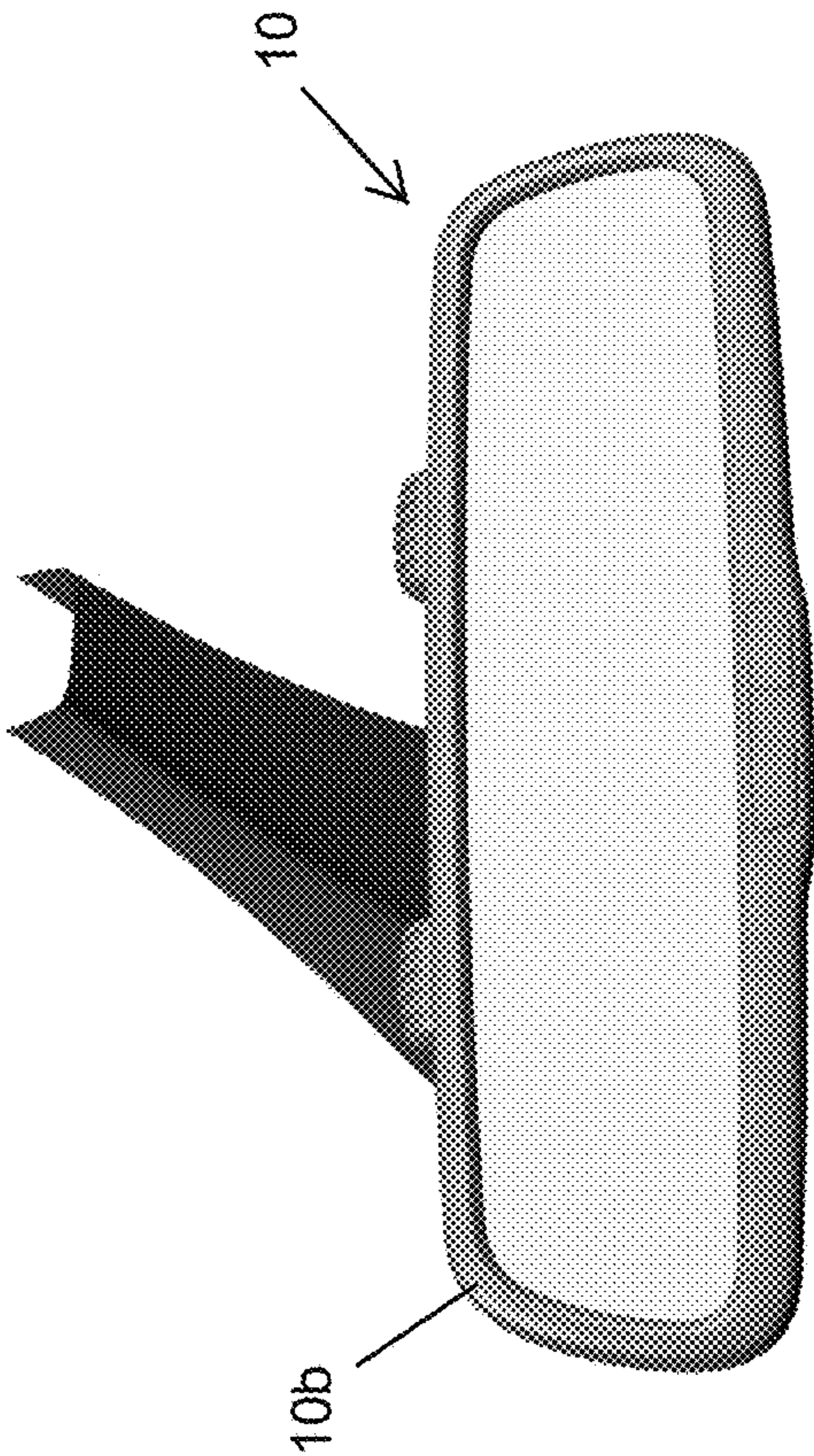

FIG. 1

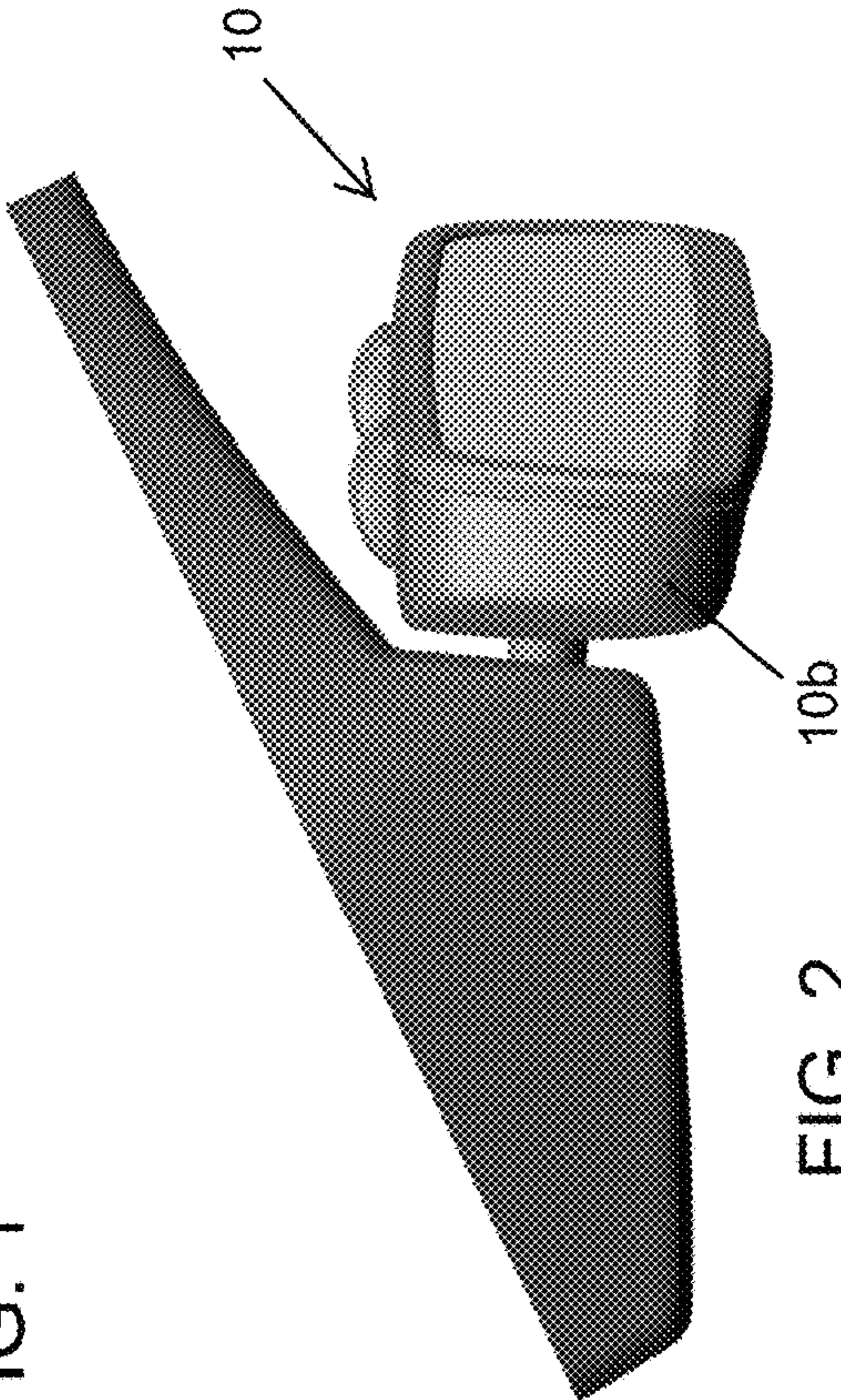

FIG. 2

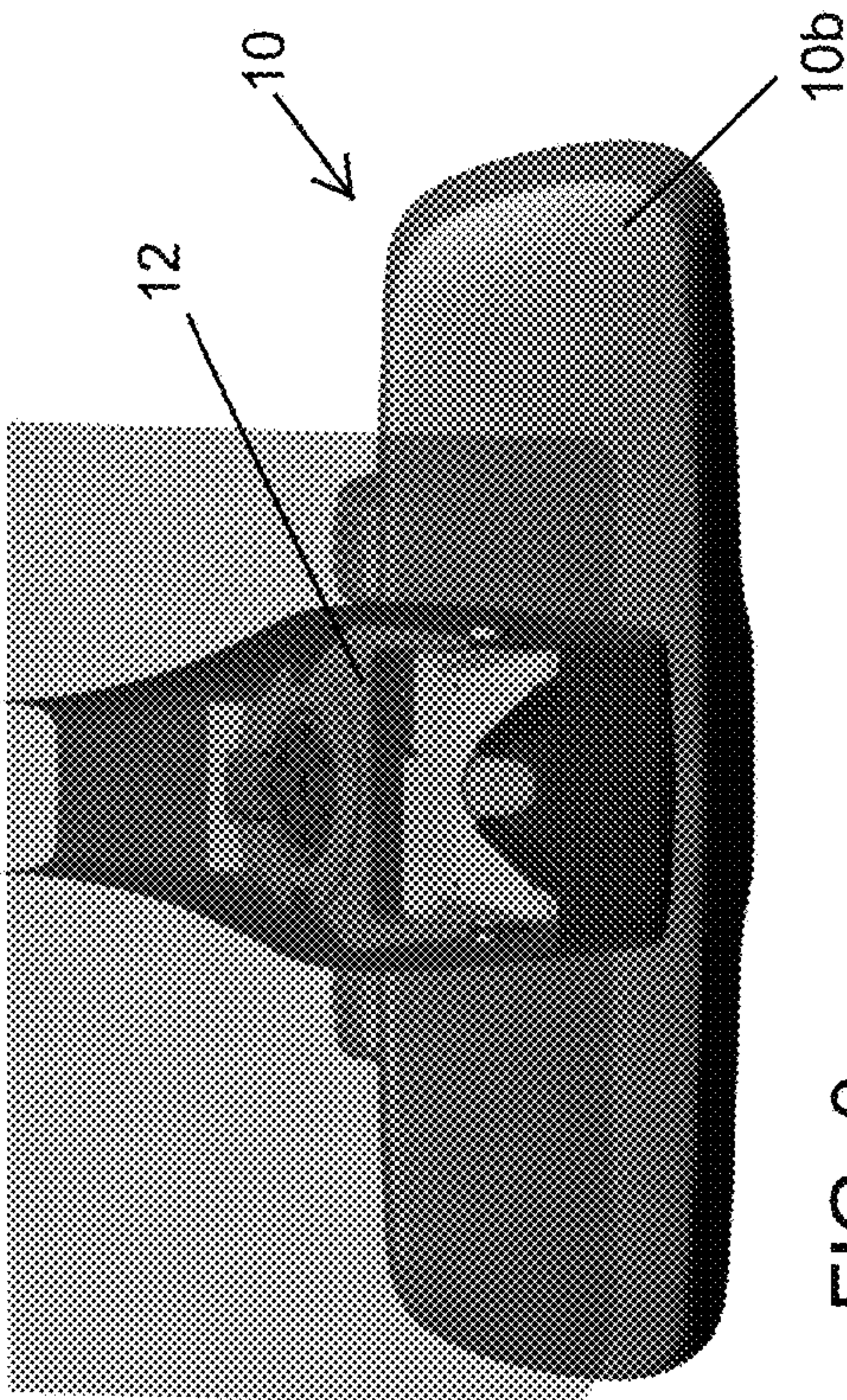

FIG. 3

- A single windshield bracket that holds all three devices
- Each device attached to the bracket at the assembly plant

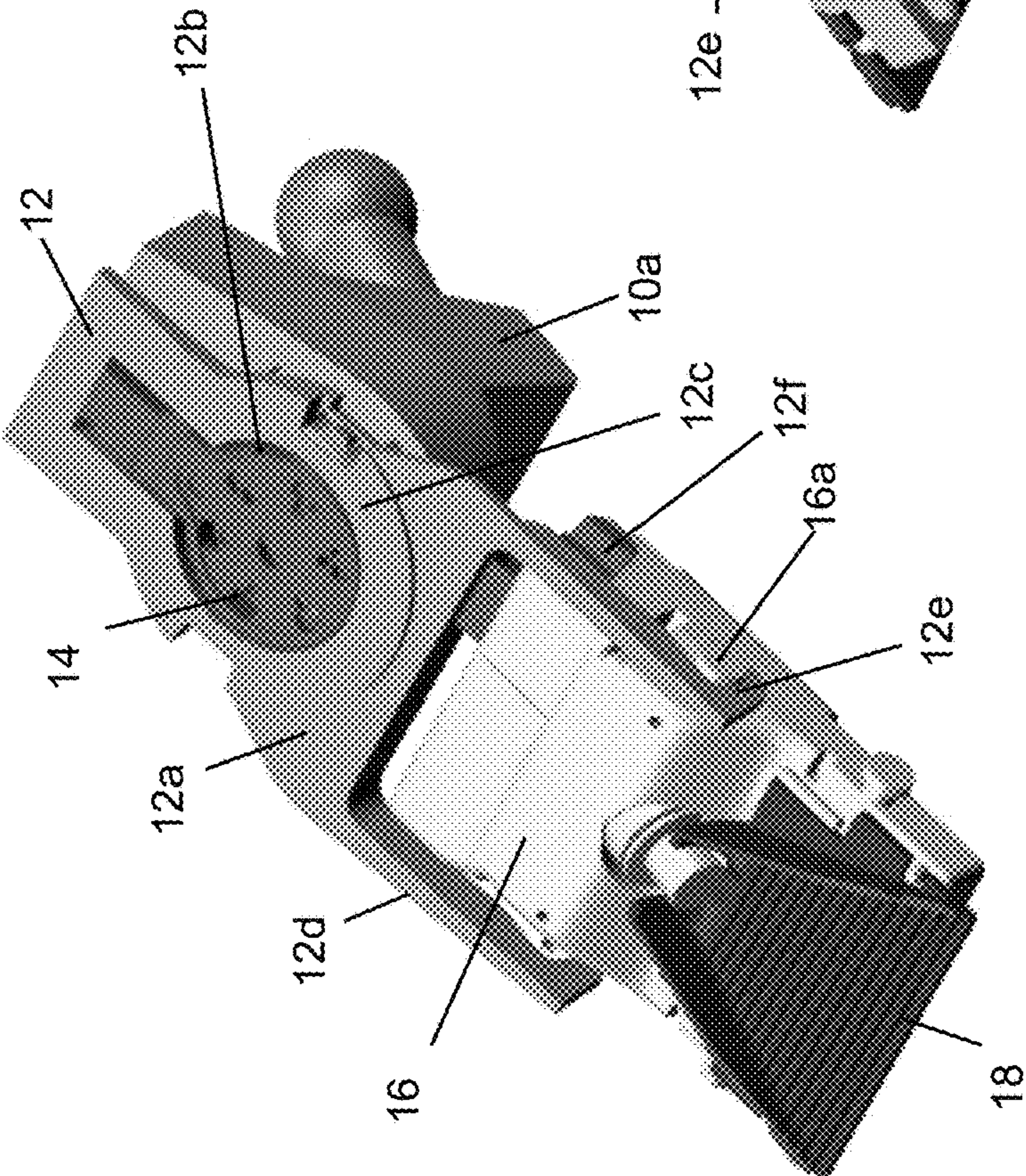

FIG. 4

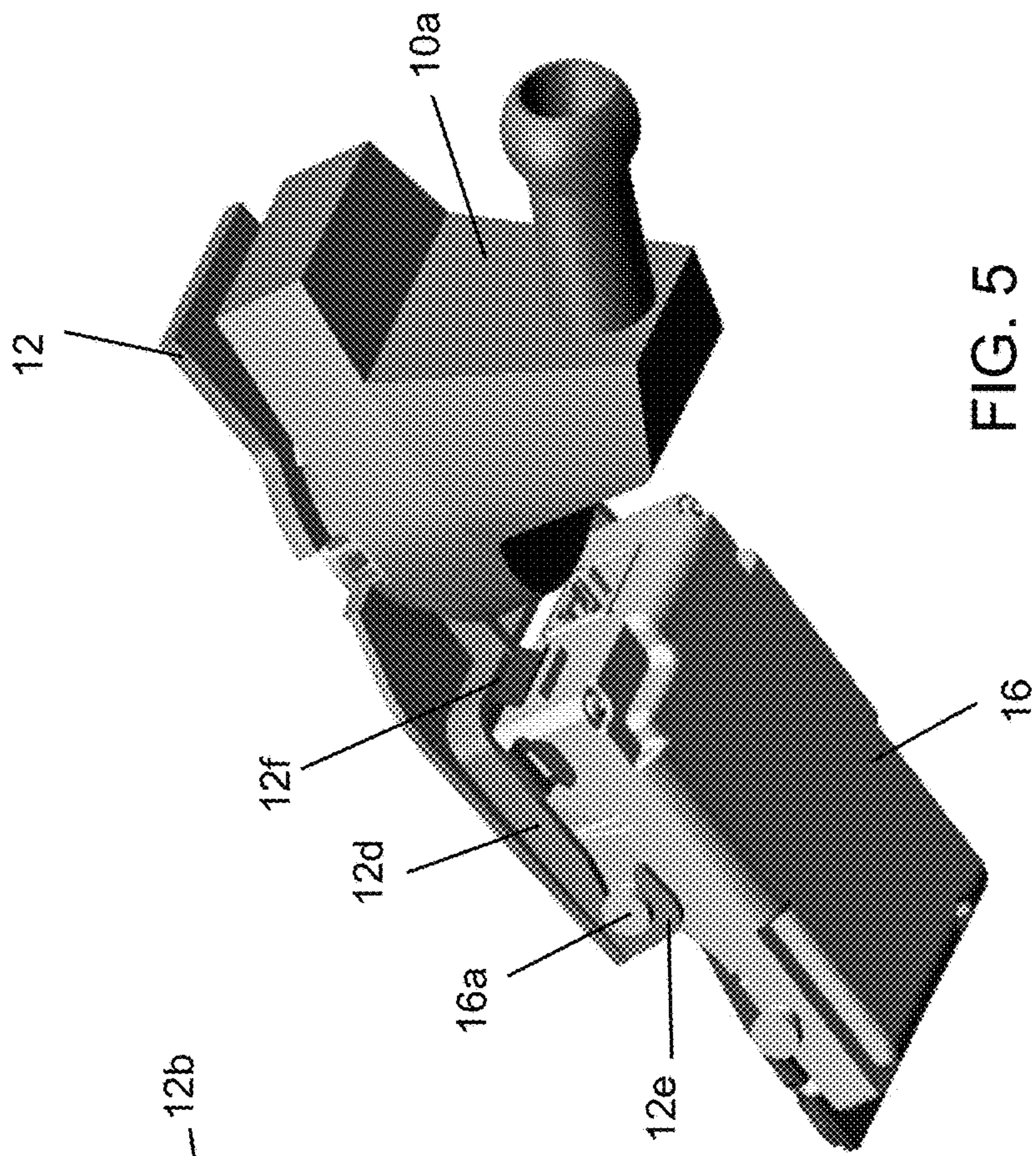
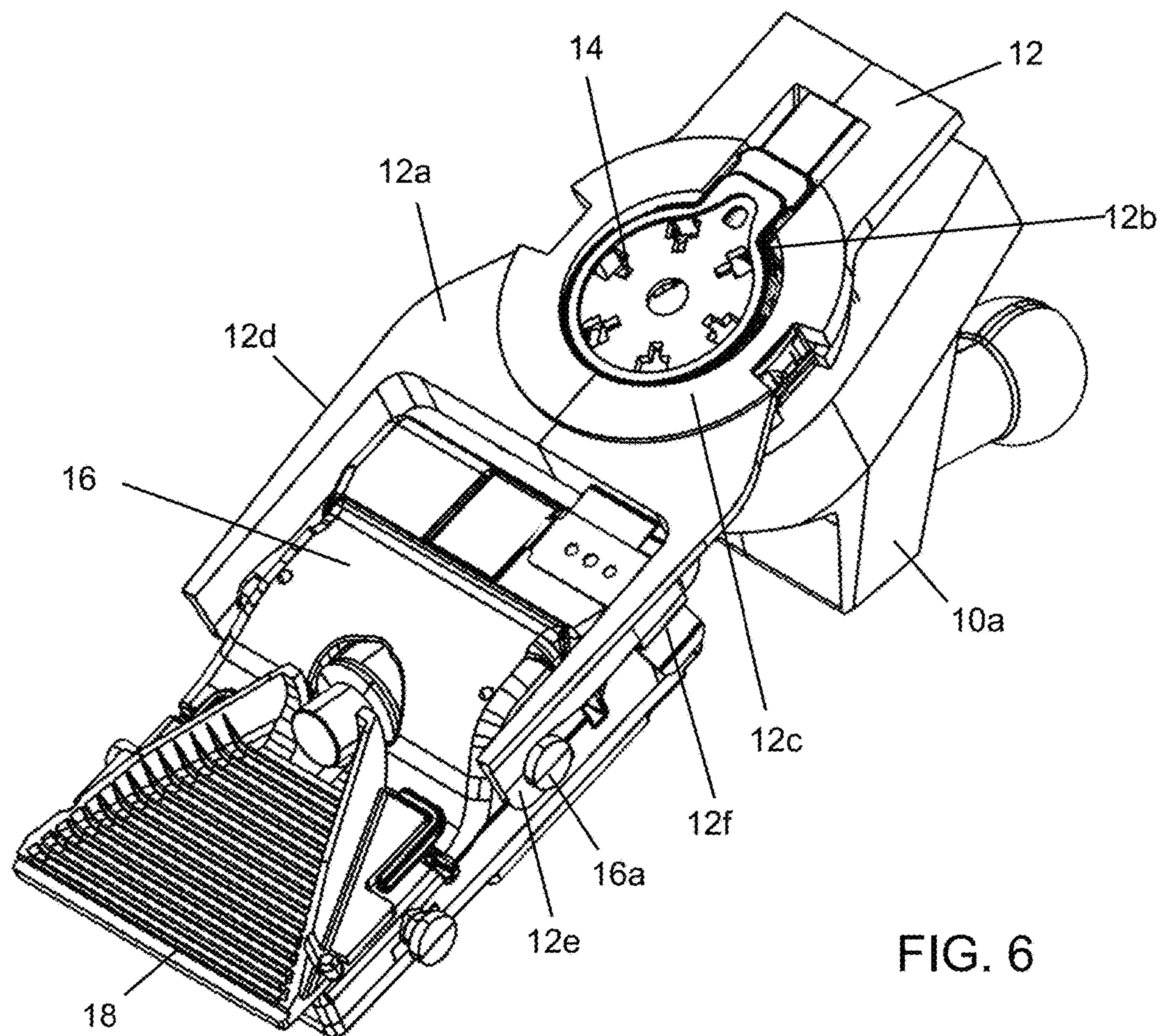

FIG. 5



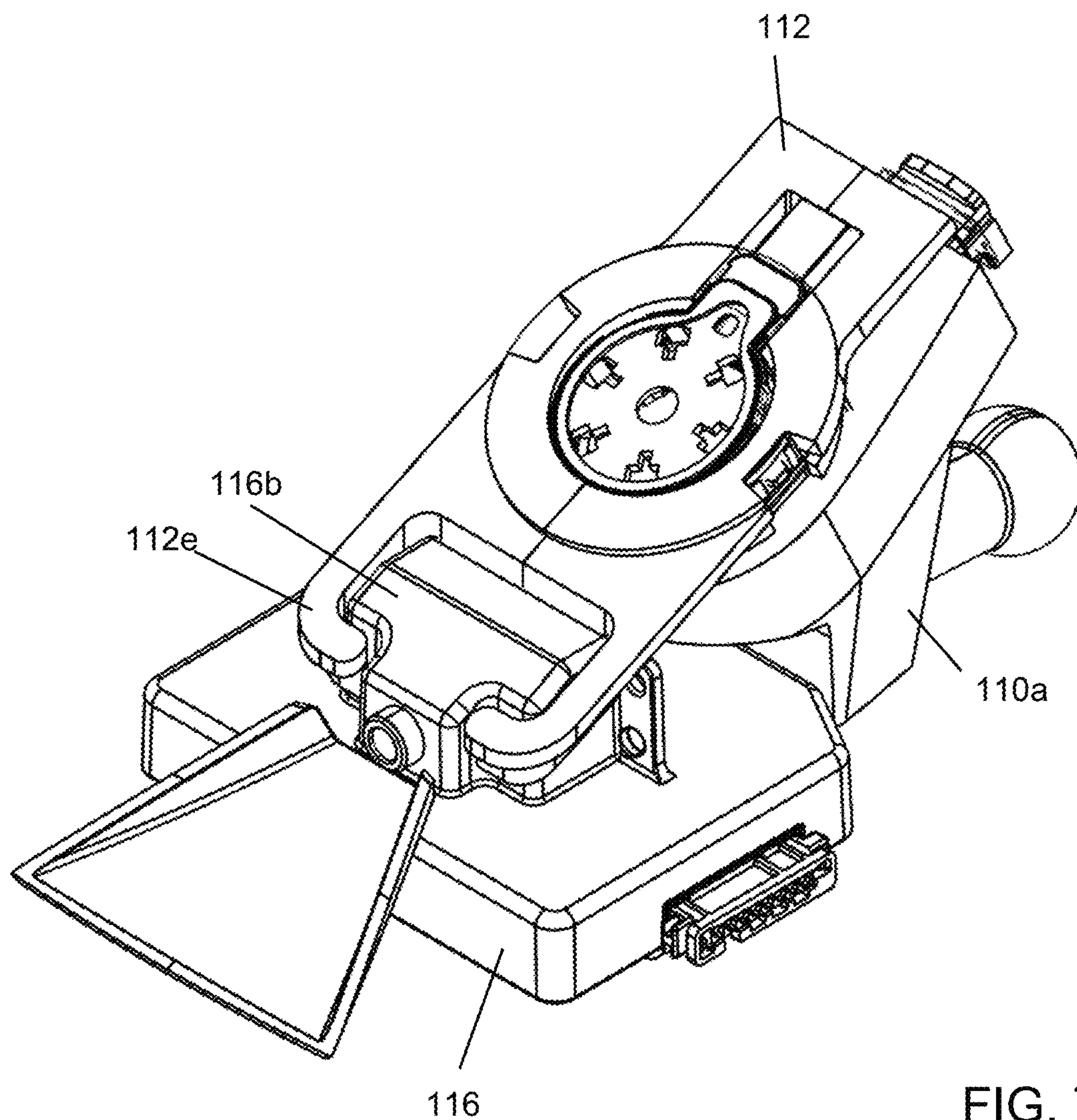

FIG. 7

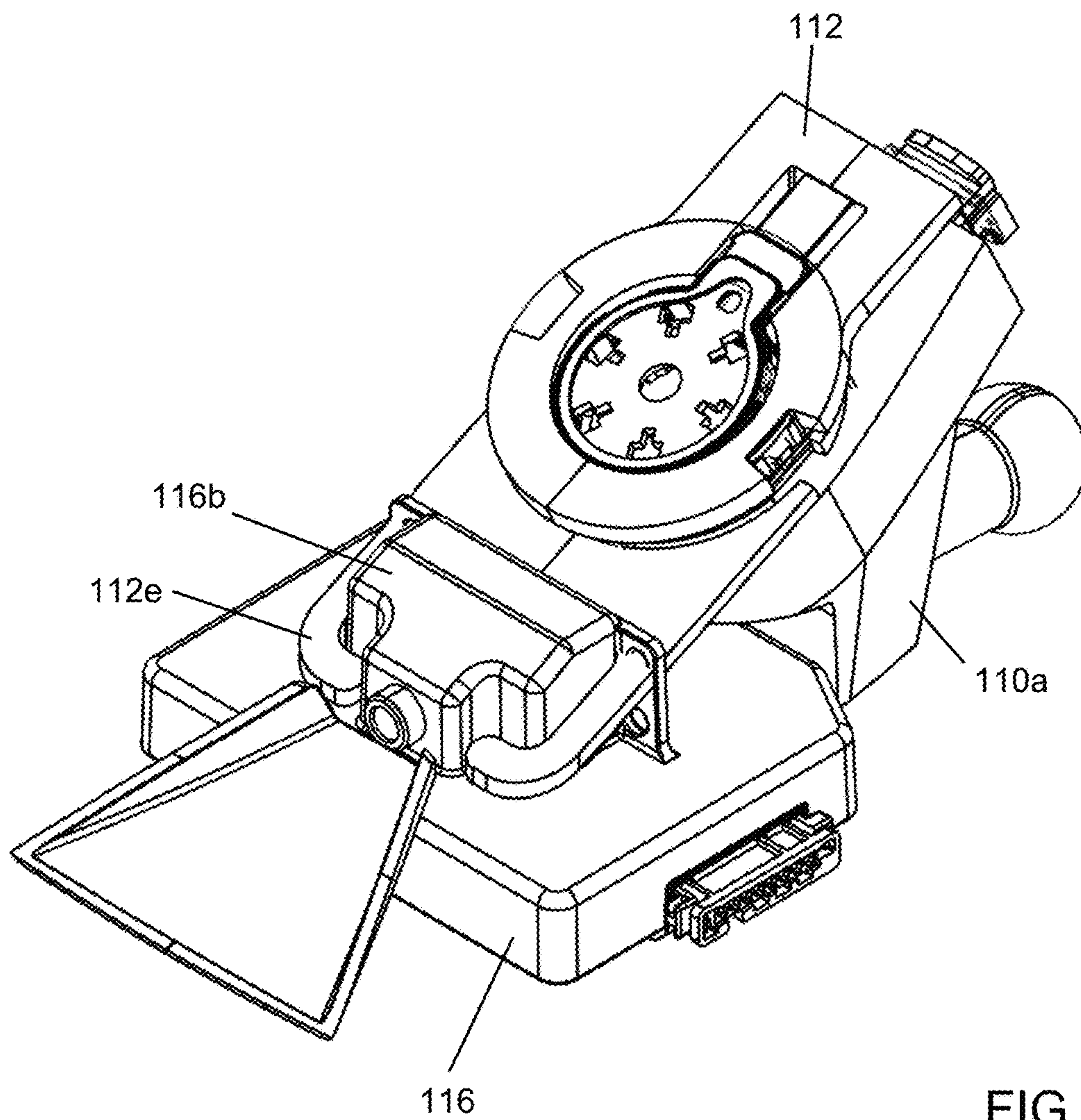

FIG. 8

1

CAMERA MOUNTING SYSTEM FOR A
VEHICLECROSS REFERENCE TO RELATED
APPLICATIONS

The present application is a continuation of U.S. patent application Ser. No. 15/344,858, filed Nov. 7, 2016, now U.S. Pat. No. 9,707,903, which is a continuation of U.S. patent application Ser. No. 14/504,667, filed Oct. 2, 2014, now U.S. Pat. No. 9,487,161, which claims the filing benefits of U.S. provisional application Ser. No. 61/886,882, filed Oct. 4, 2013, which is hereby incorporated herein by reference in its entirety.

FIELD OF THE INVENTION

The present invention relates generally to the field of vehicle accessories and, more particular to accessories, including interior rearview mirror assemblies, mounted at an in-cabin surface of a vehicle windshield.

BACKGROUND OF THE INVENTION

It is known to provide a mirror assembly that is adjustably mounted to an interior portion of a vehicle, such as via a single or double ball pivot or joint mounting configuration where the mirror casing and reflective element are adjusted relative to the interior portion of a vehicle by pivotal movement about the single or double ball pivot configuration. The mirror casing and reflective element are pivotable about one or more ball pivot joints by a user that is adjusting a rearward field of view of the reflective element. It is also known to provide a forward facing camera module at the vehicle windshield and separate from the mirror assembly.

SUMMARY OF THE INVENTION

The present invention provides an interior rearview mirror system or accessory mounting system that includes a bracket attached (such as adhesively attached or bonded) at the in-cabin surface of a vehicle windshield, with the bracket supporting or mounting a mirror assembly, a rain sensor and a forward camera module (FCM) at the windshield. The bracket is configured such that the three components or devices can be readily attached at or snapped onto the bracket with the bracket already attached at the windshield surface. Thus, the bracket may be attached at the windshield surface at the windshield supplier plant or facility and shipped to a vehicle assembly plant, where the accessories or components or devices may be attached at the bracket at the windshield after the windshield is installed on a vehicle and as the vehicle moves along the vehicle assembly line.

These and other objects, advantages, purposes and features of the present invention will become apparent upon review of the following specification in conjunction with the drawings.

BRIEF DESCRIPTION OF THE DRAWINGS

FIG. 1 is a perspective view of an accessory mounting system in accordance with the present invention;

FIG. 2 is a side elevation of the accessory mounting system of FIG. 1;

FIG. 3 is a front view of the accessory mounting system of FIG. 1, shown as viewed through the windshield of the vehicle;

2

FIGS. 4 and 5 are perspective views of the accessory mounting system of the present invention;

FIG. 6 is another perspective view of the accessory mounting system of FIGS. 4 and 5;

FIG. 7 is a perspective view of another accessory mounting system of the present invention; and

FIG. 8 is another perspective view of the accessory mounting system of FIG. 7.

DESCRIPTION OF THE PREFERRED
EMBODIMENTS

A vehicular accessory system or accessory mounting system (for mounting a mirror assembly and camera) can be installed on the inside of the front windshield of a vehicle, such as a car, truck, bus or van or the like. The camera may comprise a forward facing camera having a field of view through the windshield of the vehicle and may be used for a variety of functions, such as object detection, lane keeping, traffic sign recognition and/or headlamp control and/or the like. As shown in FIGS. 1-3, the accessory system includes a bracket 12, which mounts the mirror assembly 10 and a rain sensor 14 and a camera module 16 at the windshield of a vehicle.

The bracket 12 is attached to the windshield, as shown, such as adhesively attached at the windshield or the like. The camera system or camera module and bracket of the present invention may utilize aspects of the systems and/or modules described in International Publication Nos. WO 2013/123161 and/or WO 2013/019795, and/or U.S. Pat. Nos. 8,256,821; 7,480,149; 7,289,037; 7,004,593; 6,824,281; 6,690,268; 6,445,287; 6,428,172; 6,420,975; 6,326,613; 6,278,377; 6,243,003; 6,250,148; 6,172,613 and/or 6,087,953, and/or U.S. Publication No. US-2009-0295181, which are all hereby incorporated herein by reference in their entireties.

The system of the present invention includes a bracket 12 that holds or supports or mounts all three devices (mirror assembly, rain sensor and forward facing camera module) at the windshield. In the illustrated embodiment, the bracket 12 comprises a generally flat or planar attachment surface 12a (which is adhesively attachable at an inner surface of the vehicle windshield), with an aperture 12b at a generally central region 12c of the bracket for the rain sensor to view through when the rain sensor 14 is received at the bracket and the bracket is mounted at the windshield. A pair of tabs or legs or arms 12d extend from the central region 12c and downward along the windshield and include hooks or attaching portions 12e that are configured to hook around respective tabs or protrusions 16a of the camera module 16.

The generally central region 12c of the bracket is configured for attachment of the mirror assembly 10. For example, the central region 12c may be configured for attachment of a mirror mounting base or mounting structure 10a for pivotally mounting the mirror head 10b of the mirror assembly thereat. The mounting base 10a may snap attach at the generally central region of the bracket 12 with the bracket adhesively attached at the windshield (and optionally with the rain sensor disposed at the aperture of the generally central region of the bracket or with the rain sensor disposed at the mirror mounting base so that the mirror mounting base and rain sensor construction or assembly are snap attached at the bracket).

Each of the devices or accessories may be readily attached at the bracket at the vehicle assembly plant and after the bracket is adhesively attached at the vehicle windshield. The bracket may be adhesively attached at the windshield at the

windshield supplier and before the windshield is shipped to the vehicle assembly plant. The bracket is slim enough for enhanced windshield shipping density.

The mounting system or configuration or structure of the present invention mounts all of the devices at or on the vehicle center line. The overall packaging of the devices and bracket meets the wiper and frit requirements of the vehicle manufacturer. Optionally, a wire cover or housing (FIGS. 1-3) may be attached at the bracket to house or encase the devices and any wiring that may be routed along the windshield to a vehicle wiring at the headliner of the vehicle.

The accessory system or mounting system of the present invention thus provides enhanced mounting for a forward camera module and mirror assembly via a common bracket attached at the vehicle windshield. By mounting the camera at the bracket and spaced from the mirror mount, the camera performance is not affected by mirror position tolerances, and the camera and mirror vibration inputs are decoupled. The single windshield bracket of the system of the present invention thus replaces three independent or separate brackets, with the single bracket providing centerline packaging that meets LHD RHD requirements. A wire cover may firmly attach to the windshield bracket to substantially encase or house or guide wiring from the accessories and bracket, along the windshield and to a headliner of the vehicle.

In the illustrated embodiment, the camera module **16** includes a light shield **18** and may include other aspects of the camera modules and systems described in International Publication No. WO 2013/123161, which is hereby incorporated herein by reference in its entirety. After the light shield is attached or adhered at the camera module, the camera module and light shield construction or assembly may be attached at the bracket (which may already be attached at the vehicle windshield). The bracket and light shield may be selected for a particular vehicle windshield application to adapt or configure the camera module for that particular vehicle windshield application.

In the illustrated embodiment, the bracket **12** (such as a metallic bracket formed by stamping or die casting or the like, and can be formed of a metal, such as zinc, aluminum, magnesium or the like, or can be formed as an engineered plastic or the like) comprises the generally planar portion **12a** and a pair of spaced apart forward tabs or arms **12d** and a rearward side tabs **12f**. The hooks **12e** of the forward tabs or arms **12d** are configured to receive respective posts or protrusions **16a** at the rear of the camera module as the camera module is moved or pivoted towards the bracket **12**. When the posts **16a** are received in the hooks **12e** of the bracket **12**, the camera module **16** is pivoted upward until the rearward tabs **12f** engage the camera module at the upper rear region of the camera module. The rearward tabs **12f** may flex to receive and retain the tabs or protrusions or structure at the rear of the camera module to secure or retain or mount or attach the camera module **16** at the bracket **12**. The bracket **12** is formed so that, when the camera module and light shield assembly is attached at the bracket, the bracket does not interfere with the forward field of view of the imager.

The bracket is formed such that it at least partially circumscribes the light shield, with the roof or upper boundary of the light shield (when disposed at the windshield-attached bracket) comprising the windshield. Optionally, a sealing element may be disposed at and along the upper edge region of the light shield for sealing against the in-cabin surface of the windshield or against a portion of the bracket (where the bracket may overlap the side walls of the light

shield, and where the bracket may include a sealing element to seal against the in-cabin surface of the windshield). Thus, when the light shield and camera module are disposed at the windshield-attached bracket, the roof of the pocket (the upper boundary of the pocket of the stray light shield) is formed by the windshield and optionally a portion of the bracket and windshield. For example, the stray light shield, when disposed at the windshield-attached bracket, is aligned with an aperture or opening of the bracket, and a perimeter portion of the bracket that circumscribes or partially circumscribes the bracket aperture or opening may overlap the side walls and may extend over the stray light shield such that a small portion of the "roof" of the stray light shield comprises the circumscribing portion of the bracket (and optionally the circumscribing portion of the bracket may have light traps or ribs or columns thereat). The field of view of the camera, when the camera module and stray light shield are disposed at the windshield-attached bracket, preferably views through the aperture of the bracket (and may also view through an aperture of an opaque layer or frit layer at the windshield) and preferably does not encompass the circumscribing portion of the bracket (or any portion of the opaque layer at the windshield that circumscribes the aperture at the opaque layer).

Optionally, and such as shown in FIGS. 7 and 8, the bracket **112** may otherwise attach at a camera module **116**, such as via arms or tabs or hooks **112e** that engage or wrap around a portion **116b** of the camera module **116** to hold the camera module at the bracket **112**. The rear portion of the camera module may engage the mirror mount **110a** or may engage a tab or the like of the bracket to retain the module at the bracket.

The imager or photosensor array of the camera module may comprise a plurality of photosensor elements arranged in a photosensor array having rows and columns. The logic and control circuit of the imaging sensor may function in any known manner, and the image processing and algorithmic processing may comprise any suitable means for processing the images and/or image data. For example, the vision system and/or processing and/or camera and/or circuitry may utilize aspects described in U.S. Pat. Nos. 7,005,974; 5,760,962; 5,877,897; 5,796,094; 5,949,331; 6,222,447; 6,302,545; 6,396,397; 6,498,620; 6,523,964; 6,611,202; 6,201,642; 6,690,268; 6,717,610; 6,757,109; 6,802,617; 6,806,452; 6,822,563; 6,891,563; 6,946,978; 7,859,565; 5,550,677; 5,670,935; 6,636,258; 7,145,519; 7,161,616; 7,230,640; 7,248,283; 7,295,229; 7,301,466; 7,592,928; 7,881,496; 7,720,580; 7,038,577; 6,882,287; 5,929,786 and/or 5,786,772, and/or International Publication Nos. WO 2013/123161; WO 2013/019795; WO 2011/028686 and/or WO 2010/099416, and/or U.S. patent application Ser. No. 13/681,963, filed Nov. 20, 2012, now U.S. Pat. No. 9,264,673; Ser. No. 13/660,306, filed Oct. 25, 2012, now U.S. Pat. No. 9,146,898; Ser. No. 13/653,577, filed Oct. 17, 2012, now U.S. Pat. No. 9,174,574; and/or Ser. No. 13/534,657, filed Jun. 27, 2012 and published Jan. 3, 2013 as U.S. Publication No. US-2013-0002873, which are all hereby incorporated herein by reference in their entireties. The system may communicate with other communication systems via any suitable means, such as by utilizing aspects of the systems described in U.S. patent application Ser. No. 13/377,673, filed May 11, 2012, now U.S. Pat. No. 9,036,026, and/or Ser. No. 13/202,005, filed Aug. 17, 2011, now U.S. Pat. No. 9,126,525, which are hereby incorporated herein by reference in their entireties.

The imaging device and control and image processor and any associated illumination source, if applicable, may com-

prise any suitable components, and may utilize aspects of the cameras and vision systems described in U.S. Pat. Nos. 5,550,677; 5,877,897; 6,498,620; 5,670,935; 5,796,094; 6,396,397; 6,806,452; 6,690,268; 7,005,974; 7,123,168; 7,004,606; 6,946,978; 7,038,577; 6,353,392; 6,320,176; 6,313,454 and/or 6,824,281, and/or International Publication Nos. WO 2013/016408; WO 2010/099416 and/or WO 2011/028686, and/or U.S. Publication No. US 2010-0020170, which are all hereby incorporated herein by reference in their entirety. The camera or cameras may comprise any suitable cameras or imaging sensors or camera modules, and may utilize aspects of the cameras or sensors described in U.S. Publication No. US-2009-0244361, and/or Ser. No. 13/260,400, filed Sep. 26, 2011, now U.S. Pat. No. 8,542,451, and/or U.S. Pat. Nos. 7,965,336 and/or 7,480,149, which are hereby incorporated herein by reference in their entirety. The imaging array sensor may comprise any suitable sensor, and may utilize various imaging sensors or imaging array sensors or cameras or the like, such as a CMOS imaging array sensor, a CCD sensor or other sensors or the like, such as the types described in U.S. Pat. Nos. 5,550,677; 5,670,935; 5,760,962; 5,715,093; 5,877,897; 6,922,292; 6,757,109; 6,717,610; 6,590,719; 6,201,642; 6,498,620; 5,796,094; 6,097,023; 6,320,176; 6,559,435; 6,831,261; 6,806,452; 6,396,397; 6,822,563; 6,946,978; 7,339,149; 7,038,577; 7,004,606; 7,720,580 and/or 7,965,336, and/or International Publication Nos. WO 2009/036176 and/or WO 2009/046268, which are all hereby incorporated herein by reference in their entirety.

The mirror head (including the reflective element and mirror casing) is adjustable relative to a base portion or mounting assembly to adjust the driver's rearward field of view when the mirror assembly is normally mounted at or in the vehicle. The mounting base or structure may be part of a single-ball or single-pivot mounting assembly, whereby the mirror head is adjustable relative to the vehicle windshield about a single pivot joint, or the mounting assembly may comprise other types of mounting configurations, such as a double-ball or double-pivot mounting configuration or the like, while remaining within the spirit and scope of the present invention. The socket or pivot element is configured to receive a ball member of the base portion, such as for a single pivot or single ball mounting structure or a double pivot or double ball mounting structure or the like (such as pivot mounting assemblies of the types described in U.S. Pat. Nos. 8,451,332; 6,318,870; 6,593,565; 6,690,268; 6,540,193; 4,936,533; 5,820,097; 5,100,095; 7,249,860; 6,877,709; 6,329,925; 7,289,037; 7,249,860 and/or 6,483,438, and/or U.S. Pat. Pub. No. US-2006-0061008, which are hereby incorporated herein by reference in their entirety). The mounting base may comprise a metallic ball portion or may comprise a molded (such as injection molded) polymeric mounting base or may be otherwise formed, depending on the particular application of the mirror assembly.

The mirror head of the mirror assembly may comprise any suitable construction, such as, for example, a mirror assembly with the reflective element being nested in the mirror casing and with a bezel portion that circumscribes a perimeter region of the front surface of the reflective element, or with the mirror casing having a curved or beveled perimeter edge around the reflective element and with no overlap onto the front surface of the reflective element (such as by utilizing aspects of the mirror assemblies described in U.S. Pat. Nos. 7,255,451; 7,289,037; 7,360,932; 8,049,640; 8,277,059 and/or 8,529,108, which are hereby incorporated herein by reference in their entirety), or such as a mirror assembly having a rear substrate of an electro-optic or

electrochromic reflective element nested in the mirror casing, and with the front substrate having curved or beveled perimeter edges, or such as a mirror assembly having a prismatic reflective element that is disposed at an outer perimeter edge of the mirror casing and with the prismatic substrate having curved or beveled perimeter edges, such as described in U.S. Des. Pat. Nos. D633,423; D633,019; D638,761 and/or D647,017, and/or International Publication Nos. WO 2010/124064; WO 2011/044312; WO 2013/071070; WO 2012/051500 and/or WO 2013/126719, which are all hereby incorporated herein by reference in their entirety (and with electrochromic and prismatic mirrors of such construction are commercially available from the assignee of this application under the trade name INFINITY™ mirror).

The mirror assembly may comprise an electro-optic or electrochromic mirror assembly that includes an electro-optic or electrochromic reflective element. The perimeter edges of the reflective element may be encased or encompassed by the perimeter element or portion of the bezel portion to conceal and contain and envelop the perimeter edges of the substrates and the perimeter seal disposed therebetween. The electrochromic mirror element of the electrochromic mirror assembly may utilize the principles disclosed in commonly assigned U.S. Pat. Nos. 7,274,501; 7,255,451; 7,195,381; 7,184,190; 6,690,268; 5,140,455; 5,151,816; 6,178,034; 6,154,306; 6,002,544; 5,567,360; 5,525,264; 5,610,756; 5,406,414; 5,253,109; 5,076,673; 5,073,012; 5,117,346; 5,724,187; 5,668,663; 5,910,854; 5,142,407 and/or 4,712,879, which are hereby incorporated herein by reference in their entirety, and/or as disclosed in the following publications: N. R. Lynam, "Electrochromic Automotive Day/Night Mirrors", SAE Technical Paper Series 870636 (1987); N. R. Lynam, "Smart Windows for Automobiles", SAE Technical Paper Series 900419 (1990); N. R. Lynam and A. Agrawal, "Automotive Applications of Chromogenic Materials", Large Area Chromogenics: Materials and Devices for Transmittance Control, C. M. Lampert and C. G. Granquist, EDS., Optical Engineering Press, Wash. (1990), which are hereby incorporated by reference herein in their entirety.

Optionally, the mirror assembly may comprise a prismatic reflective element. The prismatic mirror assembly may be mounted or attached at an interior portion of a vehicle (such as at an interior surface of a vehicle windshield) via the mounting means described above, and the reflective element may be toggled or flipped or adjusted between its daytime reflectivity position and its nighttime reflectivity position via any suitable toggle means, such as by utilizing aspects of the mirror assemblies described in U.S. Pat. Nos. 6,318,870 and/or 7,249,860, and/or U.S. Publication No. US-2010-0085653, published Apr. 8, 2010, which are hereby incorporated herein by reference in their entirety. Optionally, for example, the interior rearview mirror assembly may comprise a prismatic mirror assembly, such as the types described in U.S. Pat. Nos. 7,289,037; 7,249,860; 6,318,870; 6,598,980; 5,327,288; 4,948,242; 4,826,289; 4,436,371 and/or 4,435,042, which are hereby incorporated herein by reference in their entirety. Optionally, the prismatic reflective element may comprise a conventional prismatic reflective element or prism or may comprise a prismatic reflective element of the types described in U.S. Pat. Nos. 7,420,756; 7,289,037; 7,274,501; 7,249,860; 7,338,177 and/or 7,255,451, which are all hereby incorporated herein by reference in their entirety, without affecting the scope of the present invention. A variety of mirror accessories and constructions are known in the art, such as those disclosed in U.S. Pat.

Nos. 5,555,136; 5,582,383; 5,680,263; 5,984,482; 6,227,675; 6,229,319 and/or 6,315,421 (which are hereby incorporated herein by reference in their entirety), that can benefit from the present invention.

Optionally, the reflective element may include an opaque or substantially opaque or hiding perimeter layer or coating or band disposed around a perimeter edge region of the front substrate (such as at a perimeter region of the rear or second surface of the front substrate) to conceal or hide or the perimeter seal from viewing by the driver of the vehicle when the mirror assembly is normally mounted in the vehicle. Such a hiding layer or perimeter band may be reflective or not reflective and may utilize aspects of the perimeter bands and mirror assemblies described in U.S. Pat. Nos. 5,066,112; 7,626,749; 7,274,501; 7,184,190 and/or 7,255,451, and/or International Publication Nos. WO 2010/124064 and/or WO 2011/044312, and/or U.S. Pat. Pub. No. US-2006-0061008, which are all hereby incorporated herein by reference in their entirety. Optionally, the perimeter band may comprise a chrome/chromium coating or metallic coating and/or may comprise a chrome/chromium or metallic coating that has a reduced reflectance, such as by using an oxidized chrome coating or chromium oxide coating or "black chrome" coating or the like (such as by utilizing aspects of the mirror assemblies described in U.S. Pat. Nos. 7,184,190 and/or 7,255,451, which are hereby incorporated herein by reference in their entirety). Optionally, other opaque or substantially opaque coatings or bands may be implemented while remaining within the spirit and scope of the present invention.

Optionally, the mirror assembly may include one or more other displays, such as the types disclosed in U.S. Pat. Nos. 5,530,240 and/or 6,329,925, which are hereby incorporated herein by reference in their entirety, and/or display-on-demand transfective type displays, and/or video displays or display screens, such as the types disclosed in U.S. Pat. Nos. 7,855,755; 7,338,177; 7,274,501; 7,255,451; 7,195,381; 7,184,190; 7,046,448; 5,668,663; 5,724,187; 5,530,240; 6,329,925; 6,690,268; 7,734,392; 7,370,983; 6,902,284; 6,428,172; 6,420,975; 5,416,313; 5,285,060; 5,193,029 and/or 4,793,690, and/or in U.S. patent application Ser. No. 13/023,750, filed Feb. 9, 2011, now U.S. Pat. No. 8,890,955; Ser. No. 09/585,379, filed Jun. 1, 2000, now abandoned; and/or Ser. No. 10/207,291, filed Jul. 29, 2002, now abandoned, and/or U.S. Pat. Pub. Nos. US-2006-0061008; US-2006-0050018; US-2009-0015736; US-2009-0015736 and/or US-2010-0097469, and/or International Publication No. WO 2011/028686, which are all hereby incorporated herein by reference in their entirety.

The video display screen may be controlled or operable in response to an input or signal, such as a signal received from one or more cameras or image sensors of the vehicle, such as a video camera or sensor, such as the forward facing camera or a rearward facing camera or other exterior facing camera of the vehicle or such as an interior monitoring camera of the vehicle, with the camera comprising any suitable imager or image sensor, such as a CMOS imaging array sensor, a CCD sensor or the like, and image processors or image processing techniques, such as utilizing aspects of the cameras and image processors described U.S. Pat. Nos. 5,550,677; 5,670,935; 5,760,962; 6,498,620; 6,396,397; 6,222,447; 6,201,642; 6,097,023; 5,877,897; 5,796,094; 5,715,093; 6,922,292; 6,757,109; 6,717,610; 6,590,719; 6,320,176; 6,559,435; 6,831,261; 6,806,452; 6,822,563; 6,946,978; 7,038,577; 7,004,606 and/or 7,720,580, and/or U.S. Pat. Pub. Nos. US-2006-0171704; US-2009-0244361 and/or US-2010-0214791, and/or International Publication

Nos. WO 2009/046268 and/or WO 2009/036176, which are all hereby incorporated herein by reference in their entirety, or from one or more imaging systems of the vehicle, such as a reverse or backup aid system, such as a rearwardly directed vehicle vision system utilizing principles disclosed in U.S. Pat. Nos. 5,550,677; 5,760,962; 5,670,935; 6,201,642; 6,396,397; 6,498,620; 6,717,610 and/or 6,757,109, which are hereby incorporated herein by reference in their entirety, a trailer hitching aid or tow check system, such as the type disclosed in U.S. Pat. No. 7,005,974, which is hereby incorporated herein by reference in its entirety, a cabin viewing or monitoring device or system, such as a baby viewing or rear seat viewing camera or device or system or the like, such as disclosed in U.S. Pat. Nos. 5,877,897 and/or 6,690,268, which are hereby incorporated herein by reference in their entirety, a video communication device or system, such as disclosed in U.S. Pat. No. 6,690,268, which is hereby incorporated herein by reference in its entirety, and/or the like. The imaging sensor or camera may be activated and the display screen may be activated in response to the vehicle shifting into reverse, such that the display screen is viewable by the driver and is displaying an image of the rearward scene while the driver is reversing the vehicle. It is envisioned that an image processor or controller (such as an EyeQ™ image processing chip available from Mobileye Vision Technologies Ltd. of Jerusalem, Israel, and such as an image processor of the types described in International Publication No. WO 2010/099416, which is hereby incorporated herein by reference in its entirety) may process image data captured by the rearward facing camera to assess glare lighting conditions (such as to detect headlights of following vehicles that may cause glare at the interior and/or exterior rearview mirror assemblies of the equipped vehicle), and the controller may adjust or control the dimming of the electro-optic mirror assembly or assemblies of the equipped vehicle responsive to such image processing.

Changes and modifications in the specifically described embodiments may be carried out without departing from the principles of the present invention, which is intended to be limited only by the scope of the appended claims as interpreted according to the principles of patent law.

The invention claimed is:

1. A method of mounting a camera module at a windshield of a vehicle, said method comprising:
 - providing a bracket comprising an attaching portion and camera attaching structure;
 - providing a mirror mounting base comprising a first pivot element;
 - providing a mirror head comprising a mirror reflective element and a second pivot element;
 - providing a camera module having an imager and a lens;
 - attaching the attaching portion of the bracket at an in-cabin surface of a vehicle windshield;
 - attaching the mirror mounting base at the bracket;
 - attaching the second pivot element of the mirror head at the first pivot element of the mirror mounting base to form a pivot joint;
 - wherein, with the attaching portion of the bracket attached at the in-cabin surface of the vehicle windshield, the camera attaching structure of the bracket extends downward along the in-cabin surface of the vehicle windshield below the attaching portion;
 - with the attaching portion of the bracket attached at the in-cabin surface of the vehicle windshield, attaching the camera module at the camera attaching structure of the bracket, whereby the lens of the camera module is

9

below the attaching portion of the bracket and whereby the camera module has a field of view through a portion of the vehicle windshield below the attaching portion; with the attaching portion of the bracket attached at the in-cabin surface of the vehicle windshield and with the mirror mounting base attached at the attaching portion and with the camera module attached at the camera attaching structure, attaching a housing that at least partially encases the bracket and the camera module, wherein the housing encases a portion of the mirror mounting base;

wherein the camera attaching structure of the bracket comprises a pair of spaced apart camera attaching arms; and

wherein, with the attaching portion of the bracket attached at the in-cabin surface of the vehicle windshield, the camera attaching arms extend downward along the in-cabin surface of the vehicle windshield below the attaching portion, and wherein attaching the camera module at the camera attaching structure comprises engaging respective portions of the camera module with lower ends of the camera attaching arms.

2. The method of claim 1, wherein, with the attaching portion of the bracket attached at the in-cabin surface of the vehicle windshield and with the mirror mounting base attached at the attaching portion and with the camera module attached at the camera attaching structure, the camera module is located at the in-cabin surface of the vehicle windshield below the attaching portion and is at least partially disposed between the vehicle windshield and the mirror head that is pivotally attached at the first pivot element of the mirror mounting base.

3. The method of claim 1, wherein attaching the attaching portion of the bracket at the in-cabin surface of the vehicle windshield comprises adhesively attaching the attaching portion of the bracket at the in-cabin surface of the vehicle windshield.

4. The method of claim 1, wherein the lower ends of the camera attaching arms comprise hooks and the respective portions of the camera module comprises protrusions, and wherein attaching the camera module at the camera attaching structure comprises receiving the protrusions of the camera module at the hooks of the camera attaching arms.

5. The method of claim 4, wherein attaching the camera module at the camera attaching structure further comprises pivoting the camera module with the protrusions received at the hooks and snap-attaching an upper portion of the camera module at the bracket.

6. The method of claim 1, wherein attaching the mirror mounting base at the bracket comprises snap-attaching the mirror mounting base at the attaching portion of the bracket.

7. The method of claim 1, comprising disposing a rain sensor at the in-cabin surface of the vehicle windshield at an aperture of the attaching portion such that the attaching portion circumscribes the rain sensor.

8. The method of claim 7, wherein the rain sensor is disposed at the in-cabin surface of the vehicle windshield before the step of attaching the mirror mounting base at the attaching portion of the bracket.

9. The method of claim 7, wherein the rain sensor is attached at the mirror mounting base before the step of attaching the mirror mounting base at the attaching portion of the bracket.

10. The method of claim 1, wherein the first pivot element of the mirror mounting base comprises a ball member and wherein the second pivot element of the mirror head comprises a socket that pivotally receives the ball member.

10

11. The method of claim 10, wherein providing the mirror mounting base comprises forming the ball member as part of the mirror mounting base.

12. The method of claim 1, wherein, with the housing encasing the portion of the mirror mounting base, the first pivot element of the mirror mounting base extends through the housing.

13. A method of mounting a camera module at a windshield of a vehicle, said method comprising:

providing a bracket comprising an attaching portion and a pair of spaced apart camera attaching arms; providing a mirror mounting base comprising a first pivot element;

providing a mirror head comprising a mirror reflective element and a second pivot element;

providing a camera module having an imager and a lens; attaching the attaching portion of the bracket at an in-cabin surface of a vehicle windshield;

attaching the mirror mounting base at the bracket;

attaching the second pivot element of the mirror head at the first pivot element of the mirror mounting base to form a pivot joint;

wherein, with the attaching portion of the bracket attached at the in-cabin surface of the vehicle windshield, the camera attaching arms of the bracket extend downward along the in-cabin surface of the vehicle windshield below the attaching portion;

with the attaching portion of the bracket attached at the in-cabin surface of the vehicle windshield, attaching the camera module at the camera attaching arms of the bracket, whereby the lens of the camera module is below the attaching portion of the bracket and whereby the camera module has a field of view through a portion of the vehicle windshield below the attaching portion;

wherein attaching the camera module at the camera attaching arms comprises (i) engaging respective portions of the camera module with lower ends of the camera attaching arms, (ii) pivoting the camera module about the interface between the respective portions of the camera module and the lower ends of the camera attaching arms and (iii) snap-attaching the camera module at the bracket at a portion of the bracket above the lower ends of the camera attaching arms; and

with the attaching portion of the bracket attached at the in-cabin surface of the vehicle windshield and with the mirror mounting base attached at the attaching portion and with the camera module attached at the camera attaching arms, attaching a housing that at least partially encases the bracket and the camera module, wherein the housing encases a portion of the mirror mounting base.

14. The method of claim 13, wherein attaching the attaching portion of the bracket at the in-cabin surface of the vehicle windshield comprises adhesively attaching the attaching portion of the bracket at the in-cabin surface of the vehicle windshield.

15. The method of claim 13, wherein the lower ends of the camera attaching arms comprise hooks and the respective portions of the camera module comprises protrusions, and wherein attaching the camera module at the camera attaching arms comprises receiving the protrusions of the camera module at the hooks of the camera attaching arms.

16. A method of mounting a camera module at a windshield of a vehicle, said method comprising:

providing a bracket comprising an attaching portion and camera attaching structure;

11

providing a mirror mounting base comprising a first pivot
 element;
 providing a mirror head comprising a mirror reflective
 element and a second pivot element;
 providing a camera module having an imager and a lens; 5
 attaching the attaching portion of the bracket at an in-
 cabin surface of a vehicle windshield;
 attaching the mirror mounting base at the bracket;
 attaching the second pivot element of the mirror head at 10
 the first pivot element of the mirror mounting base to
 form a pivot joint;
 wherein, with the attaching portion of the bracket attached
 at the in-cabin surface of the vehicle windshield, the
 camera attaching structure of the bracket extends 15
 downward along the in-cabin surface of the vehicle
 windshield below the attaching portion;
 with the attaching portion of the bracket attached at the
 in-cabin surface of the vehicle windshield, attaching
 the camera module at the camera attaching structure of 20
 the bracket, whereby the lens of the camera module is
 below the attaching portion of the bracket and whereby
 the camera module has a field of view through a portion
 of the vehicle windshield below the attaching portion;
 wherein attaching the camera module at the camera 25
 attaching structure comprises (i) engaging respective
 portions of the camera module with the camera attach-
 ing structure, (ii) pivoting the camera module about the
 interface between the respective portions of the camera
 module and the camera attaching structure and (iii)
 snap-attaching the camera module at the bracket at a

12

portion of the bracket above the interface between the
 respective portions of the camera module and the
 camera attaching structure;
 wherein, with the attaching portion of the bracket attached
 at the in-cabin surface of the vehicle windshield and
 with the mirror mounting base attached at the attaching
 portion and with the camera module attached at the
 camera attaching structure, the camera module is
 located at the in-cabin surface of the vehicle windshield
 below the attaching portion and is at least partially
 disposed between the vehicle windshield and the mirror
 head that is pivotally attached at the first pivot element
 of the mirror mounting base; and
 with the attaching portion of the bracket attached at the
 in-cabin surface of the vehicle windshield and with the
 mirror mounting base attached at the attaching portion
 and with the camera module attached at the camera
 attaching structure, attaching a housing that at least
 partially encases the bracket and the camera module,
 wherein the housing encases a portion of the mirror
 mounting base.

17. The method of claim **16**, wherein attaching the attach-
 ing portion of the bracket at the in-cabin surface of the
 vehicle windshield comprises adhesively attaching the
 attaching portion of the bracket at the in-cabin surface of the
 vehicle windshield.

18. The method of claim **16**, wherein attaching the mirror
 mounting base at the bracket comprises snap-attaching the
 mirror mounting base at the attaching portion of the bracket.

* * * * *