



US008561524B2

(12) **United States Patent**
DeMiglio et al.

(10) **Patent No.:** **US 8,561,524 B2**
(45) **Date of Patent:** **Oct. 22, 2013**

(54) **BEVERAGE BREWING DEVICE**

(71) Applicant: **Eko Brands, LLC**, Mukilteo, WA (US)

(72) Inventors: **Ronald R. DeMiglio**, Snohomish, WA (US); **Mark J. Staudacher**, Snohomish, WA (US); **Randall C. Anderson**, Stanwood, WA (US)

(73) Assignee: **Eko Brands, LLC**, Woodinville, WA (US)

(*) Notice: Subject to any disclaimer, the term of this patent is extended or adjusted under 35 U.S.C. 154(b) by 0 days.

(21) Appl. No.: **13/666,693**

(22) Filed: **Nov. 1, 2012**

(65) **Prior Publication Data**

US 2013/0055904 A1 Mar. 7, 2013

Related U.S. Application Data

(63) Continuation of application No. 13/467,792, filed on May 9, 2012, which is a continuation-in-part of application No. 13/236,549, filed on Sep. 19, 2011.

(60) Provisional application No. 61/484,150, filed on May 9, 2011.

(51) **Int. Cl.**

A47J 31/057 (2006.01)

A23L 1/00 (2006.01)

A47J 31/44 (2006.01)

A47J 31/00 (2006.01)

(52) **U.S. Cl.**

USPC **99/300**; 99/290; 99/304; 99/305; 99/306; 99/315; 99/323; 99/279; 99/280; 99/295; 99/302 R; 210/232; 210/474; 210/477; 210/482; 210/497.1; 210/497.2; 210/497.3

(58) **Field of Classification Search**

CPC A47J 31/46; A47J 31/0689; A47J 31/06

USPC 99/290, 300, 304, 305, 306, 307, 315,

99/323, 279, 280, 295, 302 R; 210/232,

210/474, 477, 482, 497.1, 497.2, 497.3

See application file for complete search history.

(56) **References Cited**

U.S. PATENT DOCUMENTS

481,547 A * 8/1892 Boice 210/238

747,290 A * 12/1903 Yantie et al. 210/542

846,473 A * 3/1907 Holman 99/300

865,776 A * 9/1907 Georg 99/303

(Continued)

Primary Examiner — Henry Yuen

Assistant Examiner — Brett Spurlock

(74) *Attorney, Agent, or Firm* — Christensen O'Connor Johnson Kindness PLLC

(57) **ABSTRACT**

The beverage brewing device is configured for use with a beverage brewer having an inlet probe for dispensing water and an outlet probe. The beverage brewing device includes a body defining a brew chamber configured to contain a dry beverage medium and at least one outlet probe receptacle defined in the body and extending upwardly from a bottom surface of the body. The at least one outlet probe receptacle is sized and configured to receive an outlet probe of a beverage brewer. A lid is removably securable to the body and is engageable with the body to selectively enclose a top opening of the body. An inlet probe opening is defined in the lid for receiving an inlet probe of the beverage brewer. At least one filter is defined within in the body, wherein the filter is configured to retain a dry beverage medium within the brew chamber while allowing a brewed beverage to pass through the brew chamber.

9 Claims, 7 Drawing Sheets

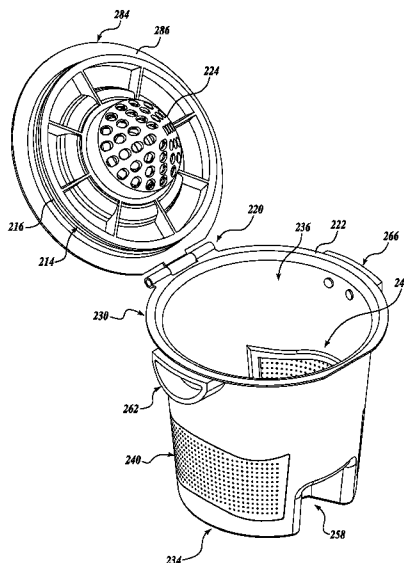

(56)

References Cited

U.S. PATENT DOCUMENTS

1,134,661	A *	4/1915	McGerry	99/323	7,231,870	B2 *	6/2007	Lowe et al.	99/299
2,464,722	A *	3/1949	Sacker	99/292	D560,097	S *	1/2008	Shen	D7/510
2,570,997	A *	10/1951	Willman	99/303	7,464,637	B1 *	12/2008	Lin	99/322
3,592,126	A *	7/1971	Dombrowik	99/312	7,836,820	B2 *	11/2010	Hammad	99/299
4,080,299	A *	3/1978	Bartolome	210/479	7,870,821	B2 *	1/2011	Kwon et al.	99/483
4,374,026	A *	2/1983	Greutert	210/493.5	7,891,286	B2 *	2/2011	Scarchilli et al.	99/295
4,882,055	A *	11/1989	Stamstad	210/483	8,033,212	B2 *	10/2011	Liu	99/306
5,266,194	A *	11/1993	Chiodo	210/232	2001/0032822	A1 *	10/2001	Koslow et al.	210/767
5,853,581	A *	12/1998	Rayborn et al.	210/241	2002/0148358	A1 *	10/2002	Sweeney et al.	99/306
5,902,620	A *	5/1999	Nolan	426/241	2003/0000887	A1 *	1/2003	Zaske	210/464
5,910,205	A *	6/1999	Patel	99/315	2003/0209151	A1 *	11/2003	Mordini et al.	99/323
5,988,190	A *	11/1999	Borges	134/117	2003/0226449	A1 *	12/2003	Carasso et al.	99/279
6,026,733	A *	2/2000	Orrico et al.	99/302 R	2004/0094039	A1 *	5/2004	Brizio	99/279
6,079,315	A *	6/2000	Beaulieu et al.	99/289 R	2005/0236323	A1 *	10/2005	Oliver et al.	210/464
6,192,786	B1 *	2/2001	Gasser et al.	99/319	2007/0186784	A1 *	8/2007	Liverani et al.	99/295
6,202,541	B1 *	3/2001	Cai	99/286	2007/0221069	A1 *	9/2007	Rahn et al.	99/323
6,244,162	B1 *	6/2001	Dahmen	99/315	2007/0259074	A1 *	11/2007	Searchilli et al.	426/78
6,260,476	B1 *	7/2001	Pope	99/323	2008/0196593	A1 *	8/2008	Shrader et al.	99/300
6,453,800	B1 *	9/2002	Chen	99/289 R	2009/0241344	A1 *	10/2009	Mastroianni	30/114
6,880,454	B2 *	4/2005	Kollep	99/295	2010/0154651	A1 *	6/2010	Skalski et al.	99/302 R
6,912,949	B2 *	7/2005	Brizio	99/303	2010/0176037	A1 *	7/2010	Namespetra et al.	210/85
6,960,295	B2 *	11/2005	Chaouachi et al.	210/232	2010/0178392	A1 *	7/2010	Yoakim et al.	426/80
7,150,219	B2 *	12/2006	De'Longhi	99/299	2010/0212509	A1 *	8/2010	Tien et al.	99/305
7,219,600	B1 *	5/2007	Haven et al.	99/318	2010/0224078	A1 *	9/2010	Khalifa	99/323
					2010/0263548	A1 *	10/2010	Kokatsu et al.	99/306
					2012/0285330	A1 *	11/2012	Demiglio et al.	99/279
					2012/0285334	A1 *	11/2012	DeMiglio et al.	99/300

* cited by examiner

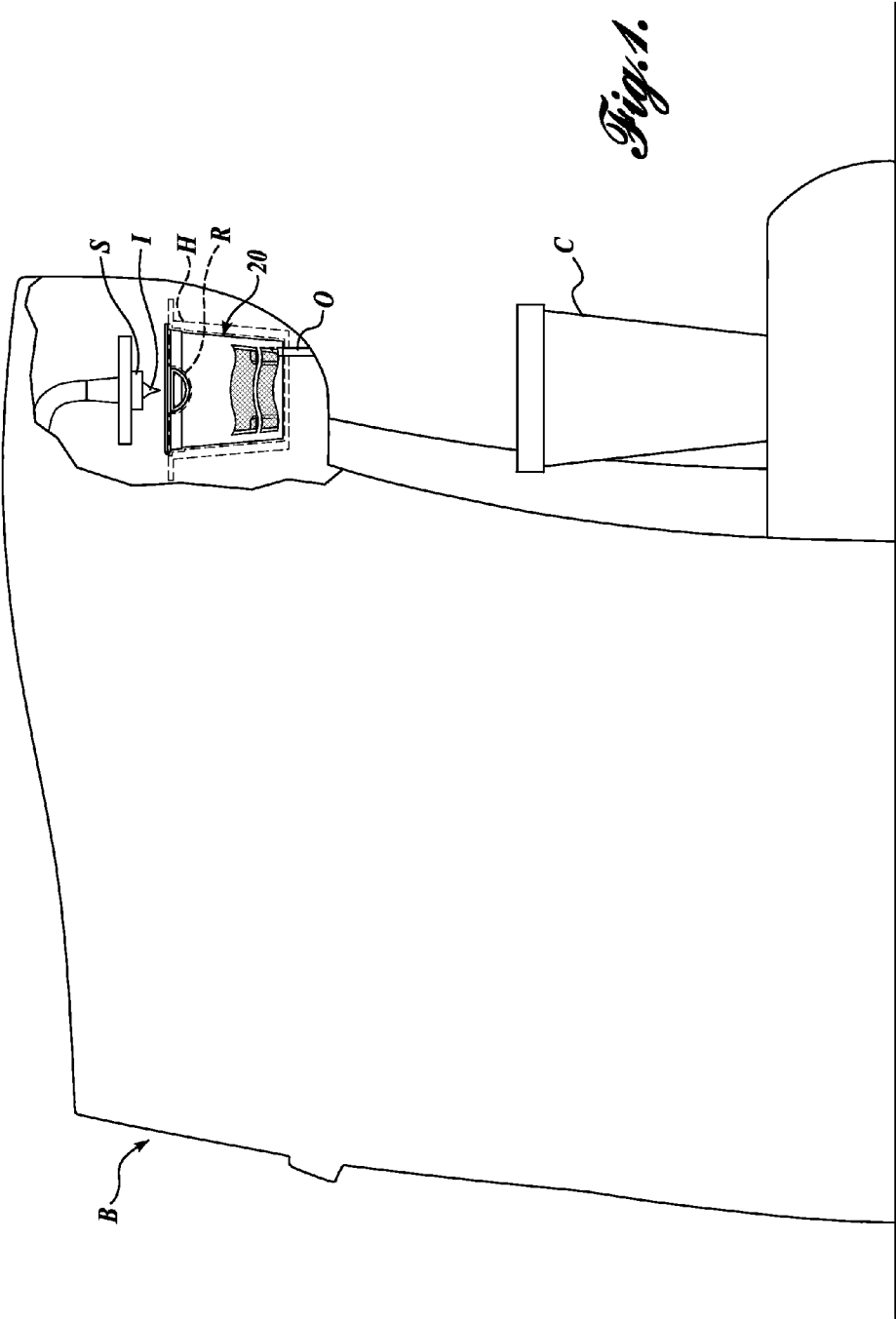

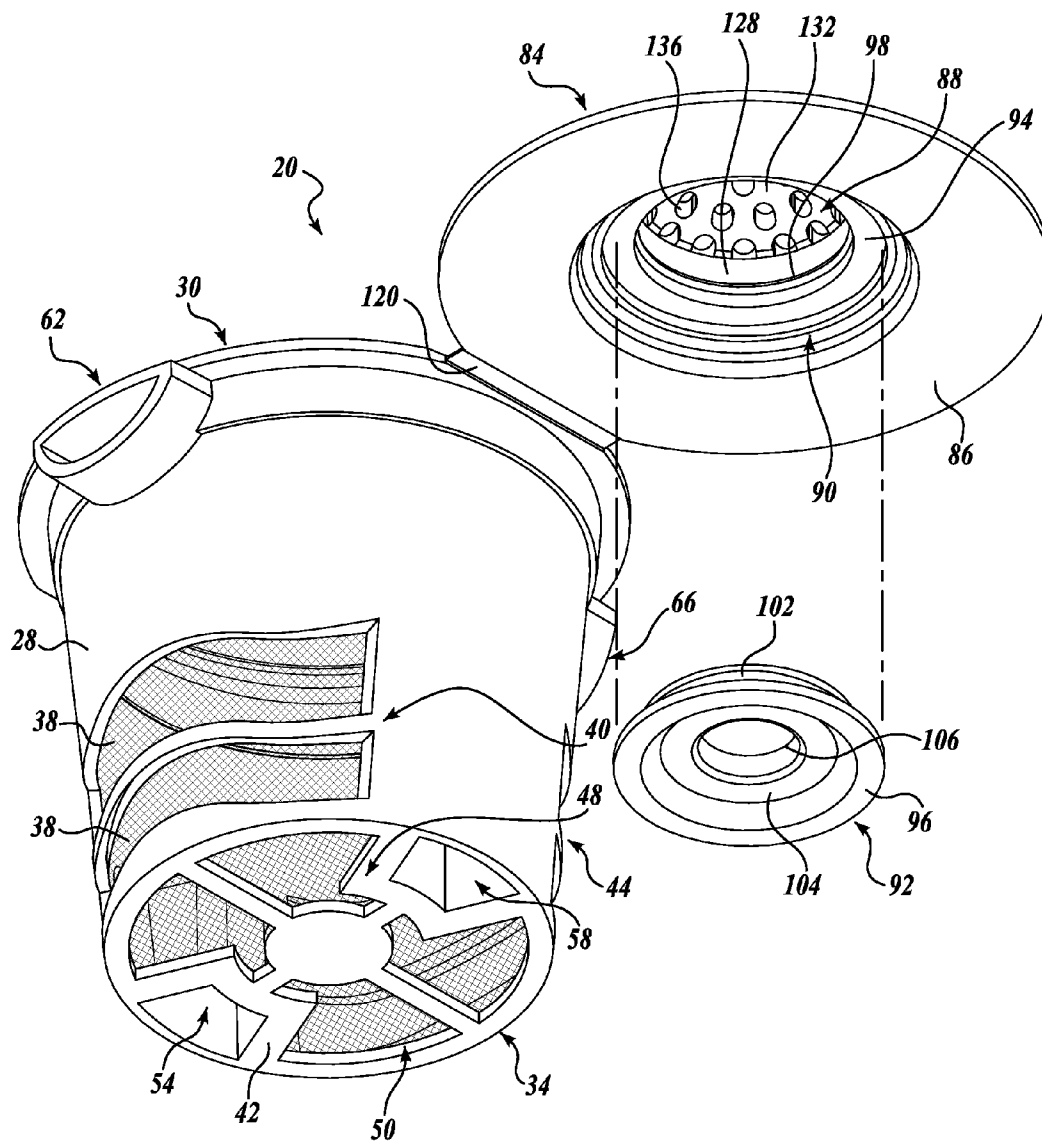

Fig. 2.

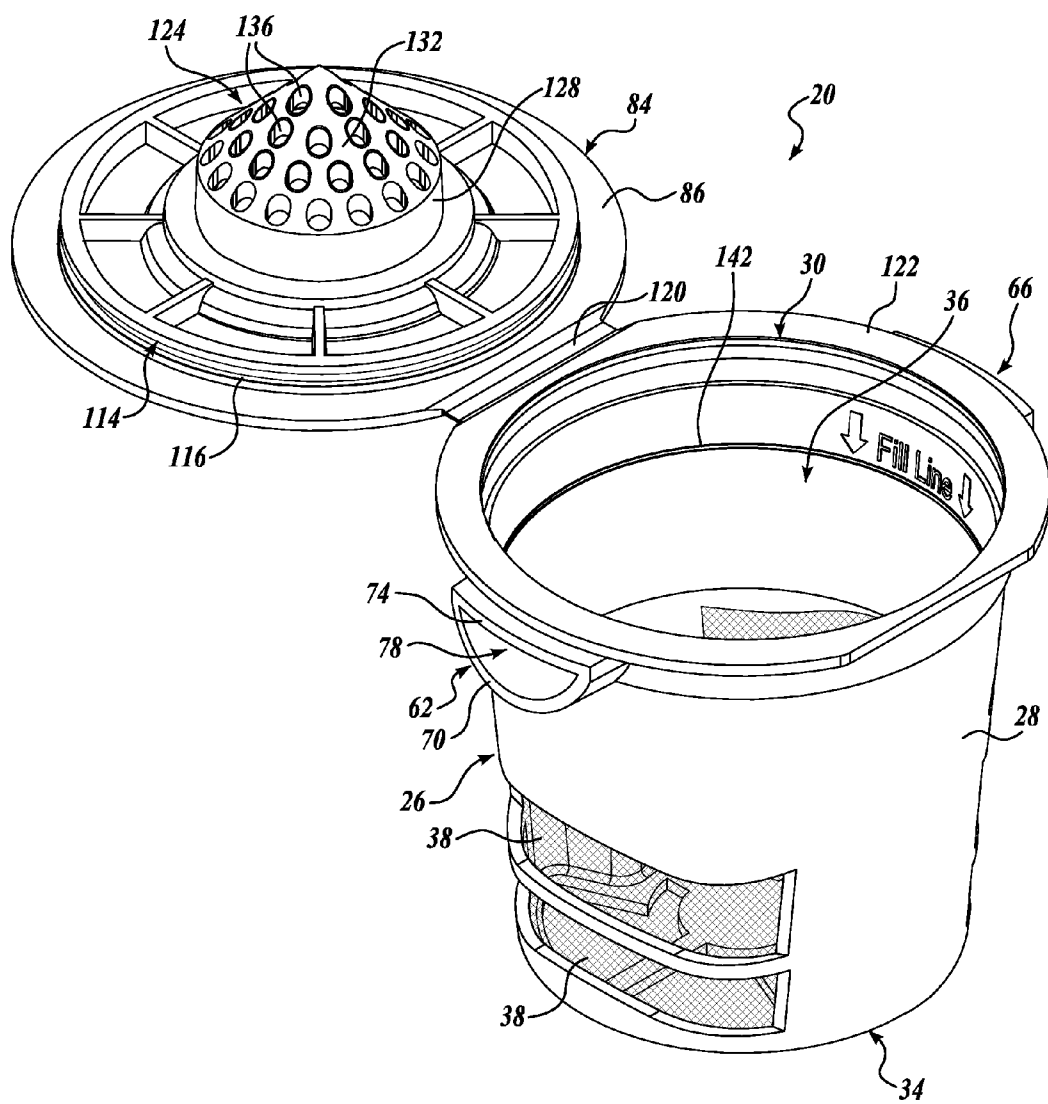
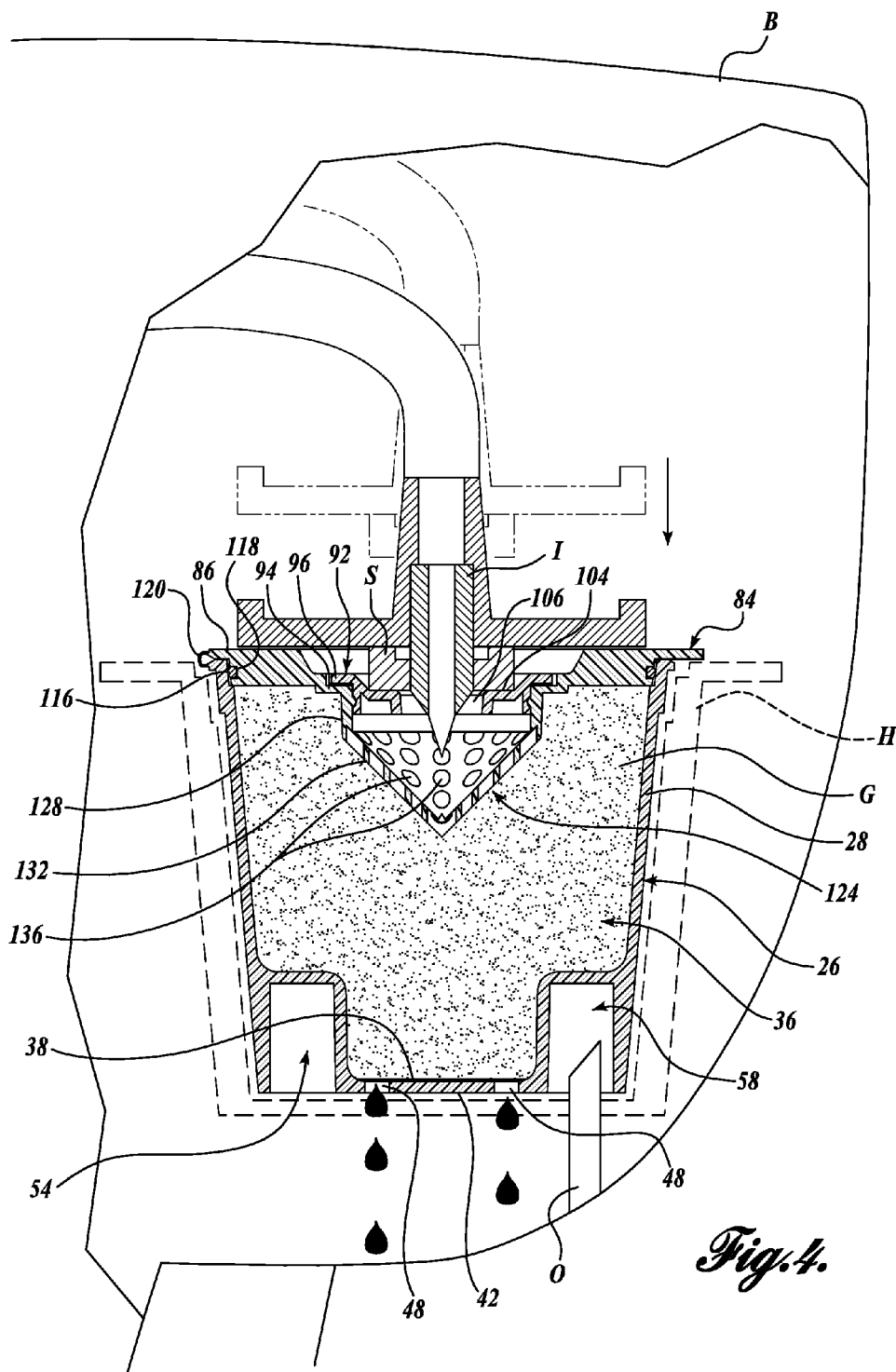

Fig. 3.



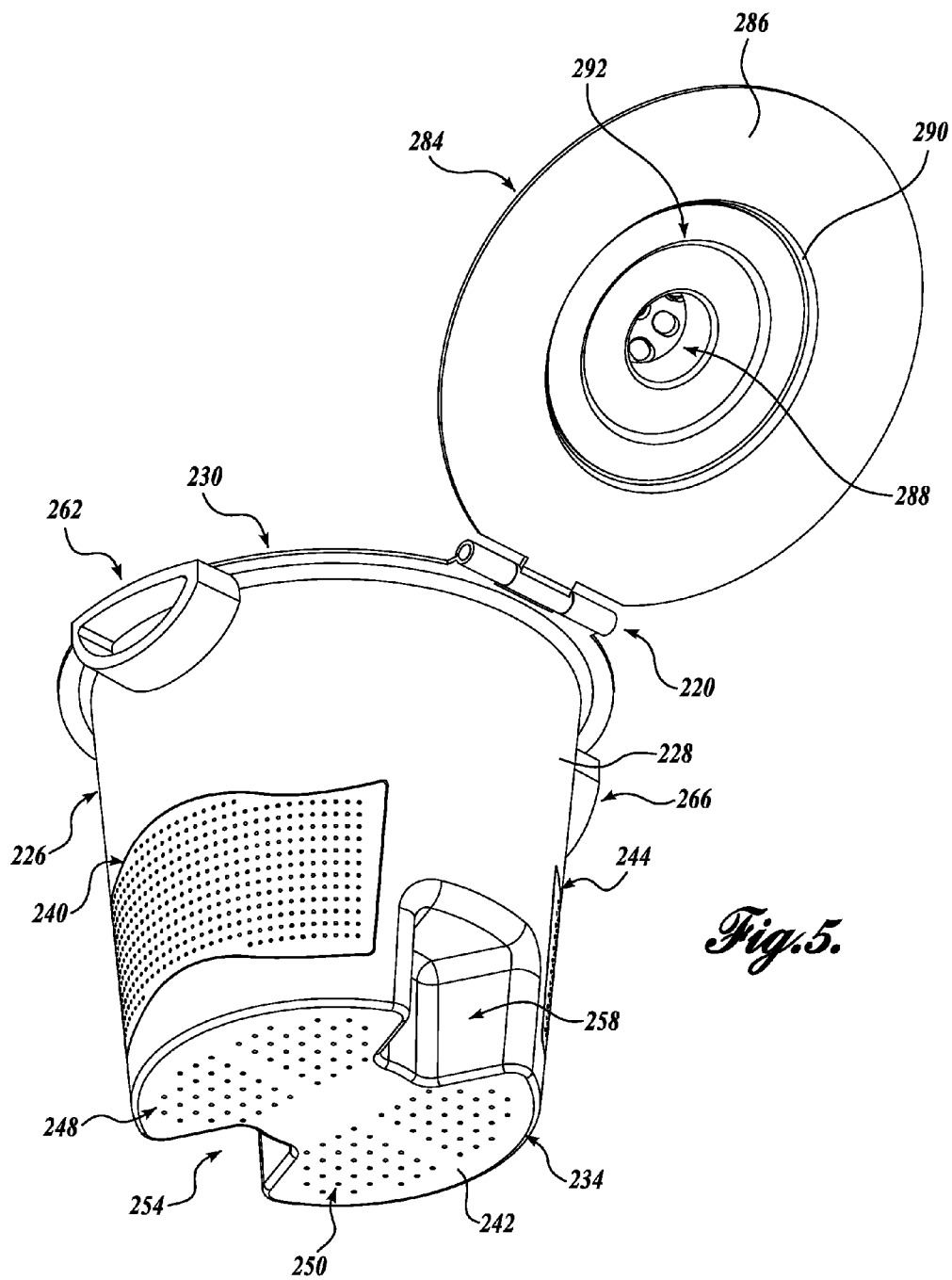
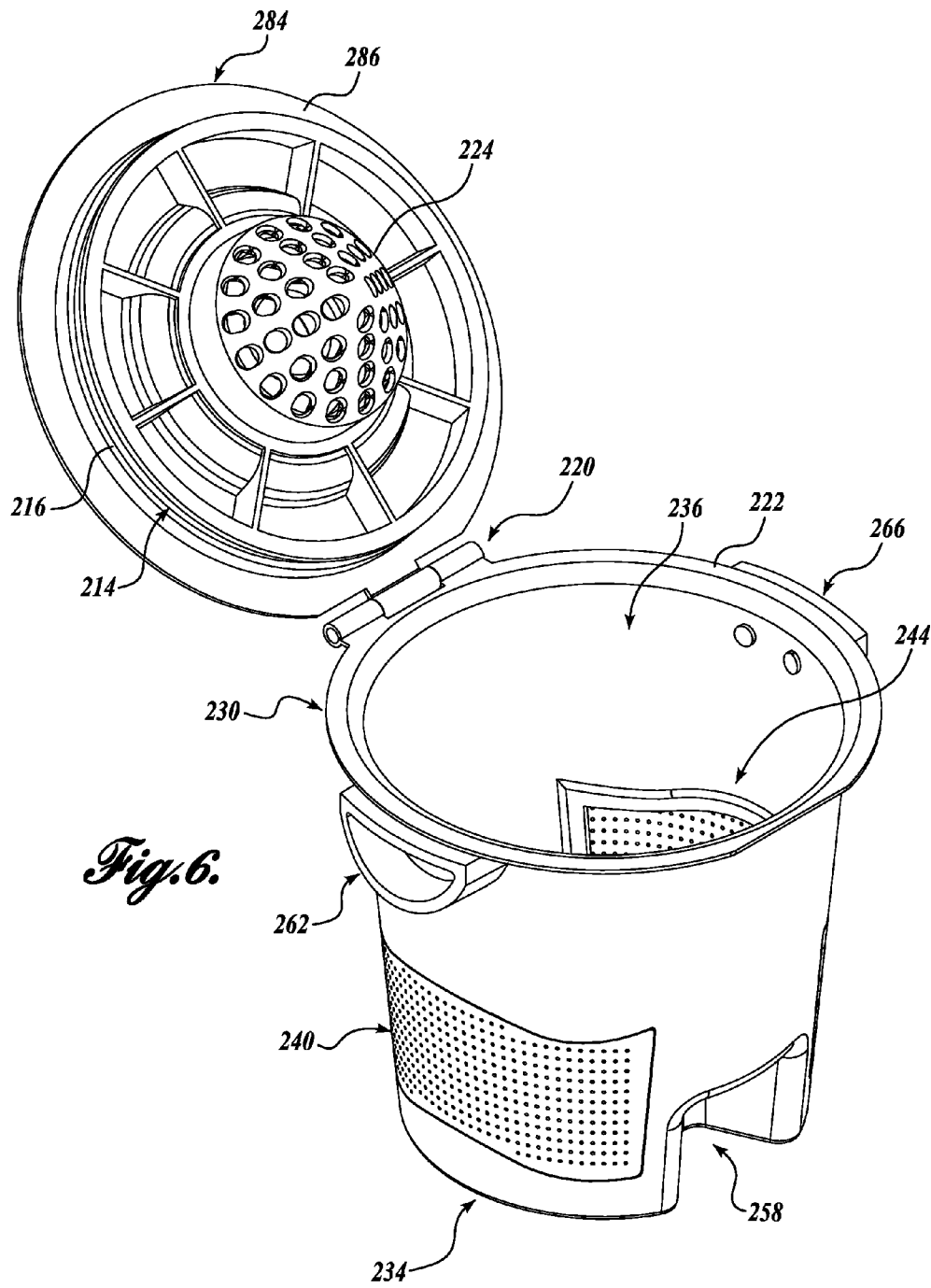
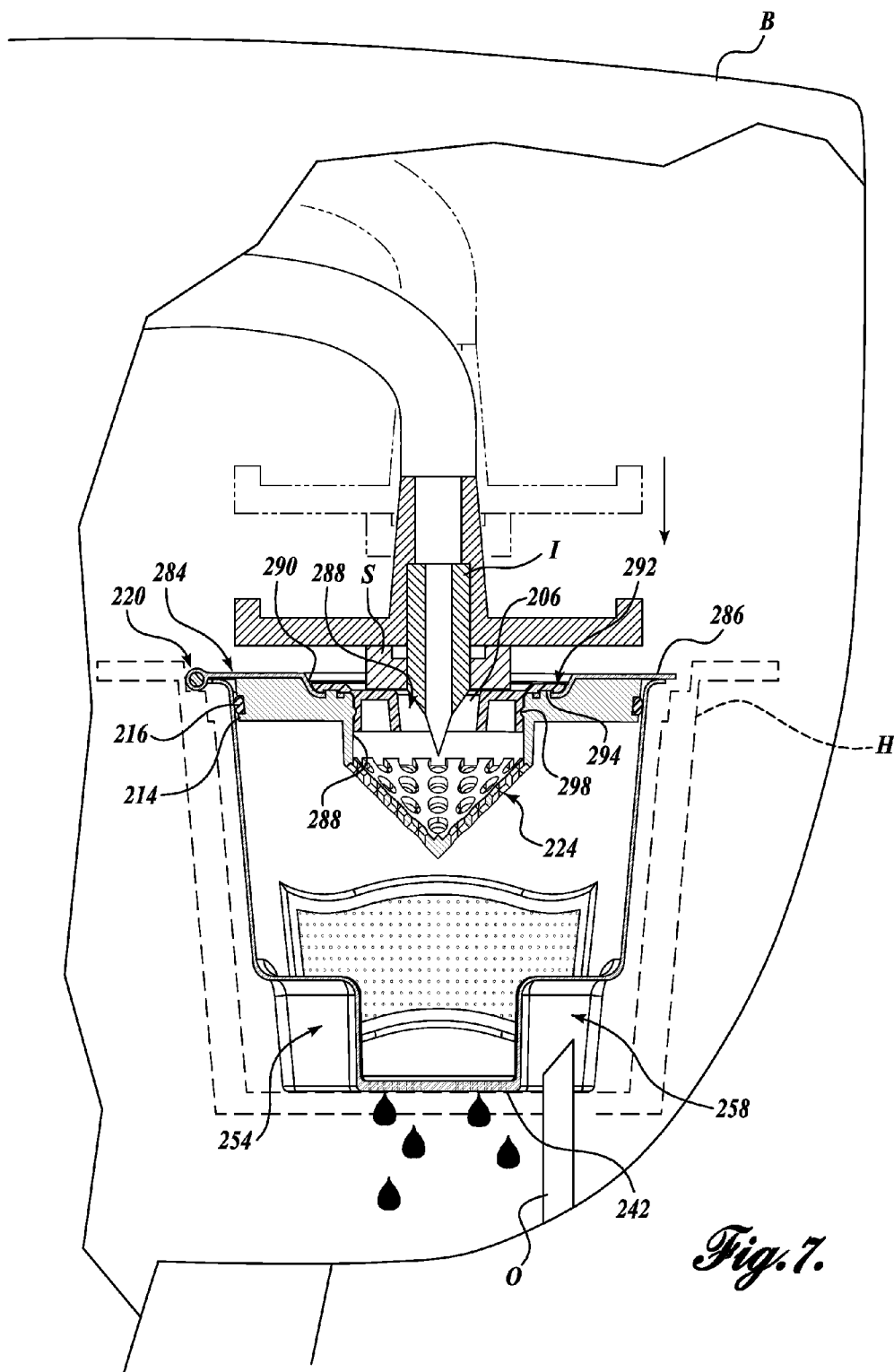

Fig. 5.





1

BEVERAGE BREWING DEVICE**CROSS-REFERENCES TO RELATED APPLICATIONS**

This application is a continuation of U.S. patent application Ser. No. 13/467,792, filed May 9, 2012, which is a continuation-in-part of U.S. patent application Ser. No. 13/236,549, filed Sep. 19, 2011, and claims the benefit of U.S. Provisional Patent Application No. 61/484,150, filed May 9, 2011, the disclosures of which are hereby incorporated by reference herein.

BACKGROUND

There are numerous devices available today for making a single-serve brewed beverage, such as the single-server brewers shown and described in, for example, U.S. Pat. Nos. 6,708,600, and 6,079,315, the disclosures of which are hereby expressly incorporated by reference herein.

In a typical single-serve beverage brewer, a disposable beverage filter cartridge containing a dry beverage medium (such as tea or coffee) is disposed within a filter cartridge holder or brewing holster. To brew the beverage, the filter cartridge is pierced by inlet and outlet probes to accommodate a through-flow of metered hot water. The hot water infuses the dry beverage medium contained in the cartridge to thereby produce a single serving of the beverage. After the beverage is brewed, the cartridge is removed from the cartridge holder and it is discarded.

By requiring the use of the disposable cartridges, the consumer is limited to the beverage selection of the cartridges on hand. Moreover, with each cartridge being disposed of after use, there is much needless waste. Thus there is a need for a reusable cartridge filter suitable for use with a beverage brewer described above that can be used with any desired dry beverage medium (coffee, tea, etc.).

SUMMARY

The beverage brewing device is configured for use with a beverage brewer having an inlet probe for dispensing water and an outlet probe. The beverage brewing device includes a body defining a brew chamber configured to contain a dry beverage medium and at least one outlet probe receptacle defined in the body and extending upwardly from a bottom surface of the body. The at least one outlet probe receptacle is sized and configured to receive an outlet probe of a beverage brewer. A lid is removably securable to the body and is engageable with the body to selectively enclose a top opening of the body. An inlet probe opening is defined in the lid for receiving an inlet probe of the beverage brewer. At least one filter is defined within in the body, wherein the filter is configured to retain a dry beverage medium within the brew chamber while allowing a brewed beverage to pass through the brew chamber.

This summary is provided to introduce a selection of concepts in a simplified form that are further described below in the Detailed Description. This summary is not intended to identify key features of the claimed subject matter, nor is it intended to be used as an aid in determining the scope of the claimed subject matter.

DESCRIPTION OF THE DRAWINGS

The foregoing aspects and many of the attendant advantages of the present disclosure will become more readily

2

appreciated by reference to the following detailed description when taken in conjunction with the accompanying drawings, wherein:

FIG. 1 is an isometric view of a beverage brewing device formed in accordance with a first exemplary embodiment of the present disclosure, wherein the beverage brewing device is shown in use with a beverage brewer;

FIG. 2 is a bottom, partially exploded isometric view of the beverage brewing device of FIG. 1;

FIG. 3 is a top isometric view of the beverage brewing device of FIG. 1;

FIG. 4 is cross-sectional view of the beverage brewing device of FIG. 1 shown in use with the beverage brewer;

FIG. 5 is a bottom isometric view of a beverage brewing device formed in accordance with a second exemplary embodiment of the present disclosure;

FIG. 6 is a top isometric view of the beverage brewing device of FIG. 5; and

FIG. 7 is cross-sectional view of the beverage brewing device of FIG. 5 shown in use with a beverage brewer.

DETAILED DESCRIPTION

A reusable beverage brewing device 20 formed in accordance with a first exemplary embodiment of the present disclosure may best be seen by referring to FIG. 1. The beverage brewing device 20 is suitable for use with a multi-use, single-cup beverage brewer, such as a coffee brewer B. More specifically, the beverage brewing device 20 is configured to contain a preselected dry beverage medium, such as coffee grounds, and interface with inlet and outlet probes I and O of a beverage brewer B when received within a brewing holster H (shown in hidden lines only) of the beverage brewer B to brew a beverage for dispensing into a cup C. For instance, the beverage brewing device 20 is designed to work with most Keurig™ single-cup beverage brewers, which is similar to the beverage brewer B depicted in FIG. 1. However, it should be appreciated that the beverage brewing device 20 may instead be used with any suitable beverage brewer. Accordingly, the illustrations and depictions set forth herein shall not be seen as limiting the scope of the claimed subject matter.

Referring to FIGS. 2 and 3, the beverage brewing device 20 will now be described in detail. The beverage brewing device 20 has an overall shape and configuration to be removably received within the brewing holster H of the beverage brewer B. More specifically, the beverage brewing device 20 has a substantially cup-shaped, cylindrical body 26 that corresponds in shape and size to the interior of the brewing holster H of the beverage brewer B.

The cup-shaped body 26 has a curved, substantially vertical sidewall 28 extending between an open top end 30 and a closed bottom end 34 defined by a substantially flat bottom surface 42. The sidewall 28 and closed bottom end 34 define a brew chamber 36 within the interior of the cup-shaped body 26. The brew chamber 36 is sized and shaped to receive the dry beverage medium, such as coffee grounds.

A filter 38 is disposed within openings in the body 26 for filtering water as it passes through the brew chamber 36. More specifically, the filter 38 allows a brewed beverage to pass therethrough while retaining the dry beverage medium within the body 26. In that regard, any suitable reusable, durable filter may be used, such as a micro-screen mesh filter made from metal (such as gold or stainless steel, gold-tone filters), plastic, or fabric. In this manner, the brewed beverage, such as coffee, flows through the dry beverage medium contained

3

within the body 26 and ultimately through the filter 38 and into a cup C positioned below the brewing holster H of a beverage brewer B.

Although the filter 38 may be disposed in any suitable openings within the body 26, in the depicted embodiment, the filter 38 is disposed within openings in the sidewall 28 and the bottom surface 42 of the body 26. Specifically, the sidewall 28 includes a first pair of openings 40 disposed opposite a second pair of substantially identical openings 44 (only partially shown for ease of illustration). The bottom surface 42 similarly includes a first pair of openings 48 disposed opposite a second pair of substantially identical openings 50. The brewed beverage may flow through the openings 40 and 44 in the sidewall and through the openings 48 and 50 in the bottom surface 42 into the brewing holster H. The brewing holster H and/or the beverage brewer B may include suitable structure (not shown) to funnel or otherwise direct the brewed beverage down into the cup C for consumption.

The filter 38 may be secured within the body 26 in any suitable manner such that the edges of the filter 38 do not form an abrupt edge within the interior of the brew chamber 36. For instance, the filter 38 may be molded within the body 26 or otherwise fused into the sidewall 28 and the bottom surface 42 of the body 26. In this manner, a smooth, substantially seamless transition is defined between the filter 38 and the body 26. With this substantially seamless transition, the filter 38 has no exposed edges or frayed wires. As such, any dry beverage medium, such as coffee grounds, will not become lodged within crevices that would otherwise be created by any exposed or frayed edges.

As noted above, the closed bottom end 34 is defined by a substantially flat bottom surface 42. With a substantially flat bottom surface 42, the beverage brewing device 20 can be easily set onto a surface, such as a counter, and the brew chamber 36 can be filled with the desired dry beverage medium. In other words, the substantially flat bottom surface 42 allows for hands-free filling and less mess when filling the brew chamber 36 with, for instance, coffee grounds.

With the brew chamber 36 filled with, for instance, coffee grounds, the beverage brewing device 20 may be disposed within a brewing holster H of a beverage brewer B to brew a beverage. As discussed briefly above, the beverage brewing device 20 is configured for use within a brewing holster H of a beverage brewer having an outlet probe O that extends upwardly into the brewing holster compartment of the beverage brewer B. In that regard, the body 26 includes first and second opposing outlet probe receptacles 54 and 58 extending upwardly from the bottom surface 42 of the body 26. Each outlet probe receptacle 54 and 58 defines an opening of a sufficient size and is of a sufficient depth to receive the outlet probe O so that the beverage brewing device 20 may be fully received within the brewing holster H. Moreover, the receptacles 54 and 58 define a continuous extension of the bottom surface 42 to fluidly isolate the outlet probe O from the brew chamber 36 when the outlet probe O is received within one of the first and second outlet probe receptacles 54 or 58.

The first and second outlet probe receptacles 54 and 58 are disposed on opposite sides of the bottom surface 42 of the body 26 such that the beverage brewer 20 may be configured in one of two positions to seat within the brewing holster H (i.e., with one of the first and second opposing outlet probe receptacles 54 and 58 receiving the outlet probe O). It should be appreciated that the body 26 may instead include only one outlet probe receptacle such that the beverage brewer 20 is positionable in only one position within the brewing holster H. As yet another alternative, three or more outlet probe receptacles may instead be formed within the body 26 such

4

that the beverage brewer 20 may be configured in three or more positions within the brewing holster. Even further, it should be appreciated that the outlet probe receptacle may instead be defined as a single annular receptacle extending along the circumferential edge of the bottom surface 42 of the body 26. In this regard, the beverage brewing device 20 could be seated within the brewing holster H in an unlimited number of positions with the outlet probe O received anywhere in the annular receptacle. Thus, the descriptions and illustrations provided herein should not be seen as limiting.

Each of the first and second opposing outlet probe receptacles 54 and 58 extend upwardly from the bottom surface 42 of the body 26 to receive the outlet probe O when the beverage brewing device 20 is received within the brewing holster H. In this manner, the bottom surface 42 of the body 26 can remain substantially flat to provide at least the benefits noted above, with the receptacles 54 and 58 extending upwardly therefrom into the brew chamber of the body 26 to receive the outlet probe O.

Moreover, by forming the outlet probe receptacles 54 and 58 within the bottom surface 42 and positioning the outlet probe receptacles 54 and 58 to engage the outlet probe O in one of two positions (rather than, for instance, having an entire bottom cavity suitable to accept the outlet probe in any number of positions), the body 26 can effectively have a deeper, larger interior brew chamber capacity. A larger brew chamber 36, as can be appreciated by one of ordinary skill in the art, can hold more dry beverage medium, such as coffee grounds, and can help create more turbulence during brewing for a more uniform, more efficient, and more thorough beverage extraction. The increased internal volume of the brew chamber 36 therefore accommodates consumers that prefer a stronger brew or more ounces of brewed coffee.

The body 26 is also formed such that its interior surface, including the surface defined by the outlet probe receptacles 54 and 58, has substantially rounded edges. As a result, the interior surface of the body 26 includes no hard-edged transitions and no crevices or corners where coffee grounds or other dry beverage mediums can get stuck. This helps ensure an easier cleanup for the consumer after the use of the beverage brewing device 20. In this manner, after each use, the beverage brewing device 20 may be quickly cleaned and reused for brewing another beverage.

To help align the beverage brewing device 20 within the brewing holster H such that the one of the first and second opposing outlet probe receptacles 54 and 58 receives the outlet probe O, the beverage brewing device 20 may include first and second opposing grips 62 and 66 that are receivable within correspondingly shaped cavities R (only one cavity R shown in hidden lines in FIG. 1 for clarity) in the brewing holster H when the beverage brewer 20 is disposed in the brewing position. The first and second grips 62 and 66 protrude from an exterior surface of the curved sidewall 28 of the body 26. The grips 62 and 66 may be any suitable shape and size such that they are receivable within correspondingly shaped first and second cavities in the brewing holster H. In the depicted embodiment, each of the first and second grips 62 and 66 include a curved lower grip portion 70 that is somewhat semi-circular in shape. The curved lower grip portion 70 is receivable within the correspondingly shaped curved cavity R defined within the brewing holster H.

With the curved lower grip portion 70 of each of the first and second grips 62 and 66 received within the correspondingly shaped curved cavity R of the brewing holster H, the beverage brewing device 20 is aligned within the brewing holster H such that one of the first and second opposing outlet probe receptacles 54 and 58 receives the outlet probe O. Thus,

5

the positioning of the grips **62** and **66** within the cavities **R** ensures that the body **26** is positioned within the brewing holster **H** in only in one of two positions, separated by one hundred eighty degrees (180°).

In addition to positioning the beverage brewing device **20** within the brewing holster **H**, the first and second grips **62** and **66** are sized and configured to be graspable by a user for helping to insert and remove the beverage brewing device **20** from within the brewing holster **H**. In that regard, a substantially flat upper grip portion **74** extends across the diameter of the semi-circular shape of the curved lower grip portion **70**. Moreover, the first and second grips **62** and **66** are formed near the upper open end of the body **26** such that the upper grip portion **74** is sufficiently graspable by a user to remove the brew device **20** from within the brew holster **H**. For instance, the first and second grips **62** and **66** may be formed on the body **26** such that at least the upper grip portion **74** protrudes from an upper open end of the brewing holster **H** when the beverage brewing device **20** is received within the brewing holster **H** in the brewing position.

To aid in grasping the first and second grips **62** and **66**, the upper grip portion **74** and lower grip portion **70** define a gripping cavity **78** that beverage brewing device **20** extends from the outer edge of the lower and upper grip portions **70** and **74** to the body **26** (or near the body **26**). The gripping cavity **78** may be sized, for instance, to accommodate a user's fingertip when gripping the upper grip portion **74** to insert and remove the beverage brewing device **20** from within the brewing holster **H**.

The first and second grips **62** and **66** are also designed to help dissipate heat generated within the brew chamber **36** of the body **26** when brewing a beverage. The lower grip portion **70** and upper grip portion **74** extend from the outer surface of the sidewall **28** of the body **26** with a cavity **78** defined by the lower and upper grip portions **70** and **74**. As such, the surface area of the lower and upper grip portions **70** and **74** are maximized to help dissipate heat. The heat-dissipating design of the first and second grips **62** and **66** helps insulate the user from the post-brewing temperature of the beverage brewing device **20**. Accordingly, the beverage brewing device **20** can be safely and more quickly removed from the brewing holster **H** after the beverage is brewed.

Referring additionally to FIG. 4, before positioning the body **26** within the brewing holster **H** for brewing a beverage, the brewing chamber **36** is first enclosed by a removable lid **84**. The lid **84** is sized and configured on an exterior side to mate with the inlet probe **I** of a beverage brewer **B** when the beverage brewing device **20** is received within a brewing holster **H**. (See FIG. 2.) Moreover, the lid **84** is sized and configured on an interior side to seat within the top opening defined by the body **26** and distribute water received from the inlet probe **I** for brewing. (See FIG. 3.)

Referring to FIGS. 2 and 4, the exterior side of the lid **84** suitable for mating with the inlet probe **I** of a beverage brewer **B** will first be described in detail. The lid **84** includes a lid body **86** that is substantially circular in overall shape to match the circular top opening defined by the cylindrical or cup-shaped body **26** of the beverage brewing device **20**. The lid body **86** defines a substantially flat upper surface such that when the lid **84** is closed, the upper surface of the lid body **86** is suitable to mate with a flat portion of an inlet probe assembly of the beverage brewer **B** (see FIG. 4.)

When closed, the lid **84** is suitable for receiving the inlet probe **I** of the beverage brewer **B** and then distributing the water from the inlet probe **I** into brew chamber **36** of the beverage brewing device **20** for brewing a beverage. In that regard, a dispersion cone opening **88** is defined in substan-

6

tially the center of the lid body **86**. The dispersion cone opening **88** is configured to place the inlet probe **I** into fluid communication with a dispersion cone **124** suitable for maximizing the water volume intake capacity of water from the inlet probe **I**.

The dispersion cone opening **88** is in fluid communication with a stepped receptacle **90** formed within the lid body **86** that is sized and configured to sealingly receive an elastomeric receptacle plug **92** therein. The stepped receptacle **90** is substantially circular in overall shape and extends downwardly from the substantially flat upper surface of the lid body **86**. The stepped receptacle **90** includes a transverse plug shoulder **94** surrounding the dispersion cone opening **88** that is configured to abut against a receptacle shoulder portion **96** of the receptacle plug **92** when the plug **92** is received therein.

The stepped receptacle **90** further defines an annular protrusion **98** formed inwardly of the transverse plug shoulder **94** (i.e., toward the dispersion cone assembly **110**) that is configured to releasably receive an annular recess **102** of the receptacle plug **92**. The interface of the annular protrusion **98** and the annular recess **102** defines a seal-tight fit between the stepped receptacle **90** and the receptacle plug **92**. Moreover, when the annular recess **102** is received on the annular protrusion **98**, a snap-fit is defined therebetween to indicate to the user that the receptacle plug **92** is fully received within the stepped receptacle **90**.

When received within the stepped receptacle **90**, the receptacle plug **92** is sized and configured to sealingly engage the inlet probe **I** or its surrounding inlet probe assembly. More specifically, the receptacle plug **92** defines a transverse inlet probe shoulder **104** surrounding an inlet probe opening **106**. The inlet probe shoulder **104** is sized to engage an inlet probe shoulder **S** surrounding the inlet probe **I** of the beverage brewer **B**. In that regard, the inlet probe opening **106** is smaller in diameter than the opening defined by the stepped receptacle **90** and the dispersion cone opening **88**.

When the inlet probe assembly is lowered for brewing, the inlet probe shoulder **S** is lowered into sealing engagement with the inlet probe shoulder **104** and the inlet probe **I** protrudes through the inlet probe opening **106**. The inlet probe **I** is also held in substantial fixed relation relative to the beverage brewing device **20** when the inlet probe shoulder **S** is sealed against the receptacle plug **92** for brewing. It should be appreciated that the receptacle plug **92** may instead be configured to seal against the inlet probe **I** or another portion of the inlet probe assembly in another manner without departing from the scope of the present disclosure. The inlet probe **I** protrudes through the inlet probe opening **106** and down through the dispersion cone opening **88** toward the interior side of the lid **84** to distribute water for brewing.

Referring to FIGS. 3 and 4, the interior side of the lid **84** suitable for enclosing the brew chamber **36** within the body **26** and for distributing water received from the inlet probe **I** for brewing will now be described in detail. The interior of the lid **84** is sized and configured to sealingly mate with the top open end of the body **26**. In that regard, a circular or annular protrusion **114** is concentrically formed on the interior surface of the lid **84** that is sized and shaped to seat within the top opening defined by the body **26** of the beverage brewing device **20**.

An annular seal **116** is disposed within an annular recess **118** extending around the annular protrusion **114**. The annular seal **116** is configured to seal against the interior surface of the body **26** when the annular protrusion **114** is received within the top opening of the body **26**. Any suitable seal may be used, such as a silicone seal that is heat resistant for withstanding the temperatures of brewing. The annular seal

116 defines a watertight seal between the annular protrusion 114 and the body 26 when the annular protrusion 114 is seated within the top opening defined by the body 26. In this manner, when the lid 84 is moved into the closed position, the lid 84 sealingly encloses the brew chamber 36 of the beverage brewing device 20 for brewing.

The lid 84 is hingedly secured to the body 26 such that the lid 84 may be moved between open and closed positions. The lid 84 may be hingedly secured to the body 26 in any suitable manner, such as through an integrated flexible hinge 120 extending between the lid body 86 and a flanged rim 122 formed substantially transversely around the top open end of the body 26. The flexible hinge 120 defines a hinge axis that is substantially tangent to the outer circumference of the lid 84 and the flanged rim 122. In this manner, the flexible hinge 120 allows the lid 84 to move between an open position, wherein the interior surface of the lid body 86 can be positioned substantially co-planar with the upper surface of the flanged rim 122 (see FIG. 3), and a closed position, wherein the interior surface of the lid body 86 is adjacent to or abutted against the upper surface of the flanged rim 122 (see FIG. 4).

When the lid 84 is in the closed position, as shown in FIG. 4, the inlet probe I is positioned to extend through the inlet probe opening 106 in the receptacle plug 92 to release water into a dispersion cone 124 formed on the interior surface of the lid body 86. The dispersion cone 124 is configured to help distribute water released from the inlet probe I.

More specifically, the dispersion cone 124 substantially encloses the dispersion cone opening 88 to place the dispersion cone opening 88 into fluid communication with the brew chamber 36. In that regard, the dispersion cone 124 includes a dispersion cone body having a hollow cylindrical portion 128 extending from the interior surface of the lid body 86 and surrounding the dispersion cone opening 88. The dispersion cone body further includes a hollow conical portion 132 extending from the cylindrical portion 128 to enclose the dispersion cone opening 88. A plurality of openings 136 is formed within the conical portion 132 to place the dispersion cone 124 into fluid communication with the brew chamber 36 and transfer fluid from the inlet probe I into the brew chamber 36.

When the lid 84 is in the closed position, as depicted in FIG. 4, the dispersion cone 124 extends downwardly at least partially into the brew chamber 36. In this manner, when a dry beverage medium, such as coffee grounds G, is disposed within the brew chamber 36, the dispersion cone 124 can help tamp, or pack the coffee grounds G into the brew chamber 36 for a better brew. As is well known in the coffee brewing industry, tamping coffee grounds firmly and uniformly within a brew chamber forces water to flow through the grounds in a manner that extracts the best of the coffee ground's flavors. With firm and even tamping, the water has no choice but to flow through all of the coffee grounds uniformly. The same can be appreciated with other types of dry beverage mediums, such as tea.

When the brew chamber 36 is filled with coffee grounds G up to a certain minimum or maximum level, which can be indicated to the user by a fill line indicator 142, the dispersion cone 124 is forced downwardly into the coffee grounds G when the lid 84 is closed, thereby occupying space within the brew chamber 36 and tamping the coffee grounds G within the brew chamber 36. In that regard, the overall size or height of the cylindrical portion 128 of the dispersion cone 124 may be varied to change the depth of the dispersion cone 124 within brew chamber 36. Thus, for a user who prefers, for instance, brewed coffee that is less strong in flavor, the dispersion cone 124 could extend much deeper within the brew

chamber 36 to reach and tamp coffee grounds at a lower fill line level (which would therefore produce a less strong brew). Thus, it should be appreciated that the embodiment described and illustrated herein is exemplary only and is not intended to limit the scope of the claimed subject matter.

In addition to tamping the coffee grounds G within the brew chamber 36, the dispersion cone 124 helps distribute the water from the inlet probe I to the coffee grounds G to aid in driving water flow uniformly through the coffee grounds G. Referring to FIG. 4, with the inlet probe I sealingly received within the receptacle plug 92, the water is first directed into a small, well-defined, sealed inlet probe opening 106 defined by the receptacle plug 92 and then expanded into the dispersion cone 124 for greater water dispersion capacity.

The dispersion cone 124 defines a water chamber for receiving and pressurizing water released from the inlet probe I. The water from the inlet probe I fills the chamber defined by the dispersion cone 124 and then slowly exits the dispersion cone 124 through the smaller openings 136. The gradual flow of water through the openings 136 in the dispersion cone 124 helps prevent the coffee grounds G from being soaked all at once. The shape and configuration of the dispersion cone 124 also positions the openings 136 within the brew chamber 36 in an even, distributed manner to help direct water in a substantially even, uniform manner throughout the coffee grounds G. This allows for a better extraction of the brewed beverage from the coffee grounds G and, as a result, a better cup of brewed coffee.

The sealed inlet probe opening 106 defined by the receptacle plug 92 also helps maximize the pressure of the water flowing through the dispersion cone 124 during the brewing process. Referring to FIG. 4, with the inlet probe I sealingly received within the inlet probe opening 106 of the receptacle plug 92, water from the inlet probe I flowing at a first flow rate is forced into the sealed area defined by the inlet probe I, the inlet probe shoulder S, the receptacle plug 92, and the dispersion cone 124. The water flows out of the small dispersion cone openings 136 at a second, slower flow rate due to the smaller opening 136 in the dispersion cone 124. In this manner, the water pressure is maximized as it flows out of the dispersion cone openings 136 into the coffee grounds G for extraction of the brewed beverage. This helps ensure that the water exiting the dispersion cone 124 reaches the coffee grounds packed near the interior sidewall 28 of the beverage brewing device 20 rather than merely dripping down just below the dispersion cone 124. In this manner, a more uniform, even brew will result.

The body 26 and lid 84 of the beverage brewing device 20 may be made from any suitable material, such as plastic. For instance, the body 26 and lid 84 may be made from a plastic that is free of Bisphenol A (BPA) and that is dishwasher-safe and durable. The body 26 and lid 84 may also be manufactured in any suitable manner. As a nonlimiting example, the body 26 and lid 84 may be made through plastic injection molding as a single unit with the flexible hinge 120 connecting the body 26 and lid 84.

In reference to FIGS. 1-4, the manner in which the beverage brewing device 20 may be used will now be described. Upon selecting a dry beverage medium to be brewed, such as coffee grounds, tea, etc., the beverage brewing device 20 may be set on a counter or other device such that the lid 84 may be moved into the open position. The lid 84 is moved about the axis defined by the flexible hinge 120 into the open position, and the brew chamber 36 is filled with a desired amount of dry beverage medium, such as coffee grounds G, as shown in FIG. 4. For the strongest brew, the brew chamber 36 is filled up to

the fill line 142 (see FIG. 3) such that the coffee grounds G will be tamped by the dispersion cone 124 when the lid 84 is closed.

With the coffee grounds G or another dry beverage medium added to the brew chamber 36, the lid 84 may be moved into the closed position, as shown in FIG. 4. With the lid 84 in the closed position, the annular protrusion 114 is received within the open top end 30 of the body 26, and the annular seal 116 is sealed against the interior surface of the body 26. Moreover, if the coffee grounds G have been filled up to the fill line 142, the dispersion cone 124, upon closing the lid 84, will tamp the coffee grounds G within the brew chamber 36.

With the coffee grounds G or other dry beverage medium disposed within the beverage brewing device 20, the beverage brewing device 20 may be inserted into the beverage brewer B for brewing a beverage. In that regard, the beverage brewing device 20 is disposed within a brewing holster H of a beverage brewer B such that the first and second grips 62 and 66 are received within correspondingly shaped cavities R in the brewing holster H. With each of the first and second grips 62 and 66 received within a correspondingly shaped curved cavity R of the brewing holster H, the beverage brewing device 20 is aligned within the brewing holster H such that one of the first and second opposing outlet probe receptacles 54 and 58 in the beverage brewing device 20 receives an outlet probe O of the beverage brewer B.

With the beverage brewing device 20 received within the brewing holster H, the inlet probe assembly is lowered into engagement with the beverage brewing device 20, either manually or automatically (depending on the configuration of the beverage brewer B). The inlet probe assembly is lowered until the inlet probe shoulder S abuts against the inlet probe shoulder 104 of the receptacle plug 92 and the inlet probe I is disposed within the inlet probe opening 106 of the receptacle plug 92, as shown in FIG. 4.

With the inlet probe I in the brewing position, a beverage may be brewed according to the beverage brewer instructions. As can be appreciated by one of ordinary skill, to brew a beverage, the beverage brewer B dispenses heated water through the inlet probe I, which passes through the inlet probe opening 106 of the receptacle plug 92 and into the dispersion cone 124. The heated water, which becomes at least somewhat pressurized within the dispersion cone 124, passes through the dispersion cone openings 136 to substantially evenly and uniformly soak the coffee grounds G within the brew chamber 36. The brewed beverage passes through the coffee grounds G and out of the openings 40, 44, 48, and/or 50 in the body 26 of the beverage brewing device 20 and into a cup C or other container positioned below the brewing holster H in the beverage brewer B. After brewing a beverage, the beverage brewing device 20 can be removed from the brewing holster H and cleaned for subsequent use.

It can be appreciated from the foregoing that the beverage brewing device 20 can be used with a typical single-server beverage brewer B, such as that shown and described with reference to FIGS. 1 and 4, without retrofitting or modifying the beverage brewer B. With the exception of the need to add a dry beverage medium to the brew chamber 36 of the beverage brewing device 20, the beverage brewing device 20 functions based on substantially the same beverage brewing extraction principles for which the single-server beverage brewer was originally made.

Referring to FIGS. 5-7, a reusable beverage brewing device 220 formed in accordance with a second exemplary embodiment of the present disclosure will now be described. The reusable beverage brewing device 220 is substantially similar to the reusable beverage brewing device 20 described above;

and thus, the description will be primarily based on the differences between the first and second embodiments. In that regard, many of the same or similar features have been labeled with the same reference number, with the features for the reusable beverage brewing device 220 labeled in the 200 series.

The beverage brewing device 220 has a substantially cup-shaped, cylindrical body 226 and a lid 284 hingedly secured thereto that is moveable between open and closed positions. The body 226 and lid 284 of the beverage brewing device 220 are made from a suitable metal, such as stainless steel. Other suitable durable metals may also be used, such as aluminum, brass, etc.

The body 226 and lid 284 may be manufactured using any suitable or well-known techniques for forming, metal, including extruding, punching, welding, riveting, etc. It should be appreciated that although the beverage brewing device 220 is described as being made from a suitable metal, other materials, such as plastic, may instead be used without departing from the scope of the present disclosure.

The substantially cup-shaped, cylindrical body 226 corresponds in shape and size to the interior of the brewing holster H of the beverage brewer B. The cup-shaped body 226 has a curved, substantially vertical sidewall 228 extending between an open top end 230 and a closed bottom end 234 defined by a substantially flat bottom surface 242. The sidewall 228 and closed bottom end 234 define a brew chamber 236 within the interior of the cup-shaped body 226.

At least one filter is defined within the body 226 of the brewing device 220 for filtering water as it passes through the brew chamber 236. More specifically, first and second opposing filter areas 240 and 244 are defined within the sidewall 228, and first and second opposing filter areas 248 and 250 are defined within the bottom surface 242. The filter areas may be defined by a pattern of micro perforations sized to allow a brewed beverage to pass therethrough while retaining the dry medium within the body 226. The micro perforations may be formed in any suitable manner, such as by laser cutting.

A micro perforated plate may be used to define the sidewall 228 or bottom surface 242, with the micro perforations formed within the filter areas 240, 244, 248, or 250. In the alternative, a micro perforated plate may first be formed and then integrated within the sidewall 228 or bottom surface 242. For instance, to define the sidewall filter areas 240 and 244, micro perforated plates may be welded within openings in the first and second opposing filter areas 240 and 244.

By forming the micro perforations with a micro perforated plate that defines the sidewall 228 or bottom surface 242, or a plate that is otherwise welded within an opening, within the brewing device 220, the edges of the micro perforated plate do not form an abrupt edge within the interior of the brew chamber 36. In this manner, a smooth, substantially seamless transition is defined between the filter area 240, 244 and the body 226. As such, any dry beverage medium, such as coffee grounds, will not become lodged within crevices that would otherwise be created by any exposed or frayed edges.

The brewed beverage may flow through the micro perforations in the filter areas 240 and 244 in the sidewall 228 and through the micro perforations in the filter areas 248 and 250 in the bottom surface 242 into the brewing holster H. The brewing holster H and/or the beverage brewer B may include suitable structure (not shown) to funnel or otherwise direct the brewed beverage down into the cup C for consumption.

Before disposing the beverage brewing device 220 within the brewing holster H for brewing, the brew chamber 236 must first be filled with a desired dry beverage medium, such as coffee grounds. As noted above, the closed bottom end 234

11

is defined by a substantially flat bottom surface **242**. With a substantially flat bottom surface **242**, the beverage brewing device **220** can be easily set onto a surface, such as a counter, and the brew chamber **236** can be filled with the desired dry beverage medium. In other words, the substantially flat bottom surface **242** allows for hands-free filling and less mess when filling the brew chamber **236** with, for instance, coffee grounds.

With the brew chamber **236** filled with, for instance, coffee grounds, the beverage brewing device **220** may be disposed within a brewing holster H of a beverage brewer B to brew a beverage. As discussed briefly above, the beverage brewing device **220** is configured for use within a brewing holster H of a beverage brewer having an outlet probe O that extends upwardly into the brewing holster compartment of the beverage brewer B. In that regard, the body **226** includes first and second opposing outlet probe receptacles **254** and **258** extending upwardly from the bottom surface **242** of the body **226** and inwardly from the sidewall **228**.

Each outlet probe receptacle **254** and **258** is of a sufficient depth and width to receive the outlet probe O so that the beverage brewing device **220** may be fully received within the brewing holster H. Moreover, the interior wall of the receptacles **254** and **258** fluidly isolates the outlet probe O from the brew chamber **236** when the outlet probe O is received within one of the first and second outlet probe receptacles **254** or **258**.

The first and second outlet probe receptacles **254** and **258** are defined within opposite sides of the bottom surface **242** of the body **226** such that the beverage brewer **220** may be configured in one of two positions to seat within the brewing holster H (i.e., with one of the first and second opposing outlet probe receptacles **254** and **258** receiving the outlet probe O). It should be appreciated that the body **226** may instead include only one outlet probe receptacle such that the beverage brewer **220** is positionable in only one position within the brewing holster H. As yet another alternative, three or more outlet probe receptacles may instead be formed within the body **226** such that the beverage brewer **220** may be configured in three or more positions within the brewing holster.

It can be appreciated that however many number of outlet probe receptacles used (e.g., one, two, three, etc.) the remaining portion of the bottom surface **242** defines a flat surface upon which the beverage brewing device **220** may rest when being filled with a dry beverage medium. In that regard, the beverage brewing device **220** may optimally include only two outlet probe receptacles **254** and **258** to ensure the bottom surface **242** is sufficiently large for resting on a surface and supporting the beverage brewing device **220** in an upright position during the fill process.

Moreover, by including no more than, for instance, two outlet probe receptacles **254** and **258**, the body **226** can effectively have a deeper, larger interior brew chamber capacity. A larger brew chamber **236**, as can be appreciated by one of ordinary skill in the art, can hold more dry beverage medium, such as coffee grounds, and can help create more turbulence during brewing for a more uniform, more efficient, and more thorough beverage extraction. The increased internal volume of the brew chamber **236** therefore accommodates consumers that prefer a stronger brew or more ounces of brewed coffee.

The body **226** is also formed such that its interior surface, including the surface defined by the outlet probe receptacles **254** and **258**, has substantially rounded edges. As a result, the interior surface of the body **226** includes no hard-edged transitions and no crevices or corners where coffee grounds or other dry beverage mediums can get stuck. This helps ensure an easier cleanup for the consumer after the use of the beverage brewing device **220**. In this manner, after each use, the

12

beverage brewing device **220** may be quickly cleaned and reused for brewing another beverage.

To help align the beverage brewing device **220** within the brewing holster H such that the one of the first and second opposing outlet probe receptacles **254** and **258** receives the outlet probe O, the beverage brewing device **220** may include first and second opposing grips **262** and **266** that are receivable within correspondingly shaped cavities R (only one cavity R shown in hidden lines in FIG. 1 for clarity) in the brewing holster H when the beverage brewer **220** is disposed in the brewing position.

The first and second grips **262** and **266** are also graspable by a user for helping to insert and remove the beverage brewing device **220** from within the brewing holster H. In that regard, the first and second grips **262** and **266** may be coated with or otherwise formed with a heat-resistance, non-slip material, such as rubber. Other aspects of the first and second grips **262** and **266** are substantially similar to first and second grips **62** and **66** described above; and therefore, the first and second grips **262** and **266** will not be further described in detail.

Before positioning the body **226** within the brewing holster H for brewing a beverage, the brewing chamber **236** is first enclosed by the removable lid **284**. The lid **284** is sized and configured on an exterior side to mate with the inlet probe I of the beverage brewer B when the beverage brewing device **220** is received within a brewing holster H. (See FIG. 5.) Moreover, the lid **284** is sized and configured on an interior side to seat within the top opening defined by the body **226** and distribute water received from the inlet probe I for brewing. (See FIG. 6.)

The lid **284** is substantially similar to the lid **84** described above. In other words, the exterior side of the lid **84** is suitable for mating with the inlet probe I of a beverage brewer B and distributing the water from the inlet probe I into the brew chamber **36** of the beverage brewing device **220** for brewing a beverage. The lid **284** includes a lid body **286** having a substantially flat upper surface suitable to mate with a flat portion of an inlet probe assembly of the beverage brewer B (see FIG. 7).

A dispersion cone opening **288** is defined in substantially the center of the lid body **286** that opens into a dispersion cone **224**. The dispersion cone opening **288** is in fluid communication with a receptacle **290** formed within the lid body **286**. A receptacle plug **292** is disposed within the receptacle **290** to define an inlet probe opening **206** that is in fluid communication with the dispersion cone **224**. However, the lid **284** differs from lid **84** in that the elastomeric receptacle plug **292** is overmolded within the receptacle **290** rather than being removably received therein.

The receptacle plug **292** is overmolded within the receptacle **290** of the lid **284** in a manner well known in the industry. For instance, a primer or adhesive may first be applied to the surface of the lid **284** before the receptacle plug **292** is overmolded onto the lid **284**. In the depicted embodiment, the lid **284** includes a plurality of mechanical protrusions **294** formed within the bottom interior surface of the receptacle **290**. The mechanical protrusions **294** protrude upwardly from the bottom of the receptacle **290** to mechanical interlock with the overmolded receptacle plug **292**. Similarly, an annular protrusion **298** is defined within the dispersion cone opening **288** to interlock with the overmolded receptacle plug **292**.

When disposed within the receptacle **290**, the receptacle plug **292** is sized and configured to sealingly engage the inlet probe I or its surrounding inlet probe assembly, similar to receptacle plug **92** described above. By overmolding the

13

receptacle plug 292 within the receptacle 290 of the lid 284, the receptacle plug 292 may be formed from an elastomeric, sealing material. However, the receptacle plug 292 is securely formed within the metal receptacle 290 of the lid 284. Thus, overmolding provides the flexibility of using multiple materials in a one piece design.

Referring to FIGS. 5 and 6, the interior side of the lid 284 suitable for enclosing the brew chamber 236 within the body 226 and for distributing water received from the inlet probe I for brewing will now be described. The interior side of the lid 284 is substantially similar to lid 84 described above. In that regard, the lid 284 includes a circular or annular protrusion 214 concentrically formed on the interior surface of the lid 284 that is sized and shaped to seat within the top opening defined by the body 226 of the beverage brewing device 220. An annular seal 216 is disposed within an annular recess extending around the annular protrusion 214 for mating with the top open end of the body 226 and forming a water-tight seal therebetween.

The lid 284 is hingedly secured to the body 226 such that the lid 284 may be moved between open and closed positions, substantially similar to lid 284 described above. Although any suitable hinge may be used, in the depicted embodiment, a piano hinge 220 is defined between the lid body 286 and a flanged rim 222 formed substantially transversely around the top open end of the body 226.

When the lid 284 is in the closed position, as shown in FIG. 7, the inlet probe I is positioned to extend through the inlet probe opening 206 in the receptacle plug 292 to release water into the dispersion cone 224, which is configured to help distribute water released from the inlet probe I. The dispersion cone 224 is substantially identical in structure and operation to the dispersion cone 124 described above; and therefore, it will not be further described.

In reference to FIGS. 5-7, the manner in which the beverage brewing device 220 may be used will now be described. Upon selecting a dry beverage medium to be brewed, such as coffee grounds, tea, etc., the beverage brewing device 220 may be set on a counter or other device such that the lid 284 may be moved into the open position. The lid 284 is moved about the axis defined by the hinge 220 into the open position, and the brew chamber 236 is filled with a desired amount of dry beverage medium, such as coffee grounds. For the strongest brew, the brew chamber 236 may be filled up to a fill line (not shown) near the upper open end of the brew chamber 236 such that the coffee grounds will be tamped by the dispersion cone 224 when the lid 284 is closed.

With the coffee grounds or another dry beverage medium added to the brew chamber 236, the lid 284 may be moved into the closed position, as shown in FIG. 7. With the lid 284 in the closed position, the annular protrusion 214 is received within the open top end 230 of the body 226, and the annular seal 216 is sealed against the interior surface of the body 226. Moreover, if the coffee grounds have been filled up to a fill line, the dispersion cone 224, upon closing the lid 284, will tamp the coffee grounds within the brew chamber 236.

With the coffee grounds or other dry beverage medium disposed within the beverage brewing device 220, the beverage brewing device 220 may be inserted into the beverage brewer B for brewing a beverage. In that regard, the beverage brewing device 220 is disposed within a brewing holster H of a beverage brewer B such that the first and second grips 262 and 266 are received within correspondingly shaped cavities R in the brewing holster H. With each of the first and second grips 262 and 266 received within a correspondingly shaped curved cavity R of the brewing holster H, the beverage brewing device 220 is aligned within the brewing holster H such

14

that one of the first and second opposing outlet probe receptacles 254 and 258 in the beverage brewing device 220 receives an outlet probe O of the beverage brewer B.

With the beverage brewing device 220 received within the brewing holster H, the inlet probe assembly is lowered into engagement with the beverage brewing device 220, either manually or automatically (depending on the configuration of the beverage brewer B). The inlet probe assembly is lowered until the inlet probe abuts against the receptacle plug 292 and the inlet probe I is disposed within the inlet probe opening 206, as shown in FIG. 7.

With the inlet probe I in the brewing position, a beverage may be brewed according to the beverage brewer instructions. As can be appreciated by one of ordinary skill, to brew a beverage, the beverage brewer B dispenses heated water through the inlet probe I, which passes through the inlet probe opening 206 of the receptacle plug 292 and into the dispersion cone 224. The heated water, which becomes at least somewhat pressurized within the dispersion cone 224, passes through the openings in the dispersion cone 224 to substantially evenly and uniformly soak the coffee grounds within the brew chamber 236. The brewed beverage passes through the coffee grounds and out of the openings in filter areas 240, 244, 248, and/or 250 in the beverage brewing device 220 and into a cup C or other container positioned below the brewing holster H in the beverage brewer B.

While illustrative embodiments have been illustrated and described, it will be appreciated that various changes can be made therein without departing from the spirit and scope of the invention.

The embodiments of the present disclosure in which an exclusive property or privilege is claimed are defined as follows:

1. A single-serve beverage brewer system comprising:
 - (a) a beverage brewer comprising:
 - (i) a brewing holster;
 - (ii) an inlet probe for dispensing water, the inlet probe moveable between a non-brewing position and a brewing position; and
 - (iii) an outlet probe extending upwardly into the brewing holster for outleting a brewed beverage; and
 - (b) a beverage brewing device comprising:
 - (i) a body removably receivable within the brewing holster, the body defining a brew chamber configured to contain a dry beverage medium;
 - (ii) at least one outlet probe receptacle defined in the body and configured to receive the outlet probe when the body is received within the brewing holster;
 - (iii) a lid removably securable to the body, the lid engageable with the body to selectively enclose a top opening of the body;
 - (iv) a dispersion cone assembly for distributing water into the brew chamber, comprising:
 - a dispersion cone opening defined in the lid having a dispersion cone opening diameter, the dispersion cone opening defining a dispersion cone opening edge within the lid;
 - a dispersion cone body integrally formed within the lid and extending from an interior surface of the lid into the brew chamber when the lid is in the closed position and from the dispersion cone opening edge, wherein the dispersion cone body is defined at least in part by a substantially conical portion, wherein the dispersion cone body includes a plurality of substantially uniformly distributed openings defined in the substantially conical portion that

15

- are in fluid communication with the dispersion cone opening and the brew chamber;
- (v) a receptacle plug disposed within the dispersion cone opening in the lid and sealed against the edge of the dispersion cone opening, the receptacle plug defining an inlet probe opening in fluid communication with the dispersion cone body, the inlet probe opening having an inlet probe opening diameter smaller than the dispersion cone opening diameter, the inlet probe receivable within the inlet probe opening in the brewing position, wherein the inlet probe is configured to seal against the receptacle plug in the brewing position such that the inlet probe, the receptacle plug, and the dispersion cone body cooperatively define a sealed water chamber for receiving and pressurizing water, and wherein each of the plurality of openings formed within the dispersion cone body is smaller in diameter than the inlet probe opening diameter; and
- (vi) a filter defined in the body, the filter configured to retain the dry beverage medium within the brew chamber while allowing the brewed beverage to pass through the brew chamber.
2. The system of claim 1, wherein the receptacle plug is overmolded on the lid.
3. The system of claim 1, wherein the filter is integrally formed within the body.
4. The system of claim 1, wherein the body and the lid are formed from metal.
5. The system of claim 1, wherein first and second outlet probe receptacles are defined in the body and extend from a bottom surface of the body, and wherein the first and second outlet probe receptacles are positioned substantially 180° apart on the bottom surface of the body.
6. The system of claim 5, further comprising first and second grips defined at an upper end of the body, wherein the first and second grips are positioned substantially 180° apart on the upper end of the body.
7. The system of claim 6, wherein the first and second grips are located on the body in a position that is offset 90° from the position of the first and the second outlet probe receptacles on the bottom surface of the body.
8. A single-serve beverage brewer system comprising:
- (a) a beverage brewer comprising:
- (i) a brewing holster;
- (ii) an inlet probe for dispensing water, the inlet probe moveable between a non-brewing position and a brewing position; and

16

- (iii) an outlet probe extending upwardly into the brewing holster for outletting a brewed beverage; and
- (b) a beverage brewing device comprising:
- (i) a body removably receivable within the brewing holster, the body having at least one substantially vertical sidewall, a top opening, and a bottom surface intersecting the at least one substantially vertical sidewall, wherein at least a portion of the body defines a brew chamber configured to contain a dry beverage medium;
- (ii) first and second outlet probe receptacles defined in the body and extending from the bottom surface of the body, wherein the outlet probe is receivable within one of the first and second outlet probe receptacles when the body is received within the brewing holster, wherein the first and the second outlet probe receptacles are positioned substantially 180° apart on the bottom surface of the body;
- (iii) first and second grips defined at an upper end of the body that are receivable within first and second cavities of the brewing holster, wherein the first and second grips are positioned substantially 180° apart on the upper end of the body, and wherein the first and second grips are located on the body in a position that is offset 90° from the position of the first and the second outlet probe receptacles on the bottom surface of the body;
- (iv) a lid removably securable to the body, the lid engageable with the body to selectively enclose the top opening of the body;
- (v) an inlet probe opening defined in the lid, the inlet probe opening configured to receive the inlet probe in the brewing position for placing the inlet probe into fluid communication with the brew chamber; and
- (vi) at least one filter defined within the body, the at least one filter configured to retain the dry beverage medium within the brew chamber while allowing the brewed beverage to exit the brew chamber.
9. The system of claim 8, wherein the first and second outlet probe receptacles are fluidly isolated from the brew chamber to prevent the outlet probe from penetrating the brew chamber when the outlet probe is received within one of the first and second outlet probe receptacles, thereby preventing fluid from exiting the brew chamber through the outlet probe.

* * * * *